

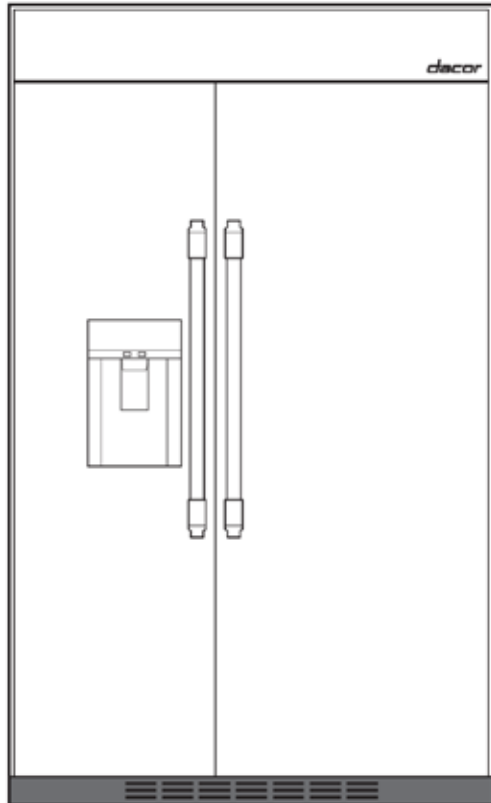

# Installation Instructions

## Discovery<sup>®</sup> 42" Stainless Built-in Refrigerator

*Model DYF42SBIWS*





# TABLE OF CONTENTS

|                                      |   |   |    |
|--------------------------------------|---|---|----|
| BEFORE YOU BEGIN .....               | 1 | INSTALLATION INSTRUCTIONS.....            | 11 |
| REFRIGERATOR SAFETY .....            | 2 | Removing the Packaging.....               | 11 |
| LOCATION & INSTALLATION SAFETY ..... | 4 | Connecting the Water-Supply Line.....     | 11 |
| INSTALLATION REQUIREMENTS .....      | 5 | Setting Up the Ice Maker .....            | 13 |
| Tools and Parts .....                | 6 | Attaching the Kickplate .....             | 13 |
| Grounding the Refrigerator .....     | 6 | Installing the Anti-Tip Brackets.....     | 14 |
| Water-Pressure Requirements .....    | 6 | Installing the Refrigerator .....         | 14 |
| Water-Line Requirements .....        | 7 | Aligning the Refrigerator Doors .....     | 15 |
| Installing the Water Filter .....    | 7 | Anchoring the Refrig. to Its Cabinet..... | 15 |
| Cabinet Cutout Dimensions .....      | 8 |   |    |
| PRODUCT SPECIFICATIONS .....         | 9 |   |    |
| Refrigerator Dimensions .....        | 9 |   |    |

## BEFORE YOU BEGIN

### Important

#### Installer

- For safety and to minimize any installation-related issues, read this manual thoroughly before you begin the installation.
- Leave this manual with the user.
- Write the model and serial numbers of the appliance below for the owner's reference. (Find these numbers on the data label on the right-hand wall of the refrigerator compartment between the top drawer and the bottom shelf; see the graphic.)

#### User

Keep this manual for your own and for the local inspector's reference.

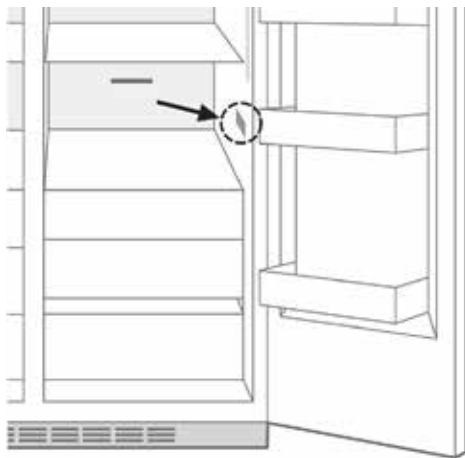

# REFRIGERATOR SAFETY

## Important Safety Instructions

The warnings in this section cannot cover every issue and situation. Use common sense and caution when installing/maintaining/operating this appliance.

Always contact the Dacor Customer Service Team about problems and conditions that you don't understand.

### About Safety Alerts

DANGER, WARNING, AND CAUTION alerts call attention to important/critical information in the manual. Always read the message that accompanies the alert.

#### DANGER

Immediate hazards that **WILL** result in severe personal injury or death.

#### WARNING

Hazards or unsafe practices that **COULD** result in severe personal injury or death.

#### CAUTION

Hazards or unsafe practices that **MIGHT** result in minor personal injury or property damage.

#### DANGER

**To avoid a possible explosion/fire:** Do not store or use combustible/flammable/explosive vapors and liquids inside or near this (or any other) appliance.

#### WARNING

##### STATE OF CALIF. PROPOSITION 65 WARNINGS

This product contains one or more chemicals known to the State of California to cause cancer, and birth defects or other reproductive harm.

#### WARNING

##### TO REDUCE RISK OF FIRE, ELECTRIC SHOCK, OR PERSONAL INJURY:

- Use the refrigerator only as the manufacturer instructs. If you have questions/concerns, contact Dacor.
- Before service/cleaning the appliance, turn off power at the circuit-breaker panel, and lock the panel. If locking is not possible, securely fasten a prominent warning to the panel not to turn the power on.

### Disposing of the Old Refrigerator

Junked refrigerators are suffocation hazards. **Before you discard your old refrigerator:**

- remove the doors.
- leave the shelves in place so children may not easily climb inside.

#### WARNING

##### **Suffocation Hazard**

**Remove doors from the old refrigerator.**

With doors attached, children may be trapped inside, resulting in death or brain damage from oxygen starvation.



#### **IMPORTANT: Refrigerant Disposal**

Dispose of the refrigerator according to federal and local regulations. Refrigerants must be evacuated by a licensed, EPA-certified refrigerant technician according to established procedures.

**SAVE THESE INSTRUCTIONS**

## Sécurité du réfrigérateur

Nous donnons de nombreux messages de sécurité importants dans ce manuel et sur votre appareil ménager. Assurez-vous de toujours lire tous les messages de sécurité et de vous y conformer.

Ce guide contient plusieurs **messages de sécurité très importants**. Lisez-les tous et obéissez-les alertes.

### Ce symbole d'alerte de sécurité

Tous les messages de sécurité identifieront le risque, vous diront comment diminuer les possibilités de blessure et vous expliqueront ce qui peut arriver en cas de non respecter les instructions.

Tous les messages de sécurité seront précédés de ce symbole d'avertissement pour votre sécurité et de mots qui signalent DANGER, PRUDENCE ou AVERTISSEMENT. Ces mots signifient :

#### **DANGER**

Vous serez mort ou sérieusement blessé si vous ne suivez pas ces instructions.

#### **PRUDENCE**

Vous risquez la mort ou des blessures sérieuses si vous ne suivez pas ces instructions.

#### **AVERTISSEMENT**

Indique une situation de risque imminent qui, en cas d'accomplissement, peut aboutir à des blessures secondaires ou modérées, ou simplement endommager l'appareil.

## Mise au rebut du réfrigérateur – méthode appropriée

**IMPORTANT:** L'emprisonnement et l'étouffement des enfants ne sont pas un problème du passé. Les réfrigérateurs jetés ou abandonnés sont encore dangereux, même s'ils sont abandonnés pendant «quelques jours seulement». Si vous vous débarrassez de votre vieux réfrigérateur, veuillez suivre les instructions ci-dessous pour aider à éviter les accidents.

### Avant de jeter votre vieux réfrigérateur ou congélateur :

- Enlever les portes.
- Laisser les tablettes en place de sorte que les enfants ne puissent pas y pénétrer facilement.

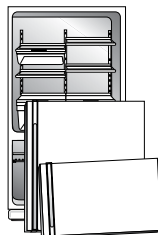

#### **DANGER**

**Risque d'explosion:** Garder les matériaux et les vapeurs inflammables, telle que l'essence, loin du réfrigérateur. Le non-respect de cette instruction peut causer un décès, une explosion ou un incendie.

#### **DANGER**

**Risque de choc électrique:** Brancher sur une prise à 3 alvéoles reliée à la terre. Ne pas enlever la broche de liaison à la terre. Ne pas utiliser un adaptateur. Ne pas utiliser un câble de rallonge. Le non-respect de ces instructions peut causer un décès, un incendie ou un choc électrique.

#### **PRUDENCE**

##### DE LA PROPOSITION 65 DE L'ÉTAT DE CALIFORNIE:

**AVERTISSEMENT:** Ce produit contient au moins un produit chimique connu par l'État de Californie pour être à l'origine de cancers.

**AVERTISSEMENT:** Ce produit contient au moins un produit chimique connu par l'État de Californie pour être à l'origine de malformations et autres déficiences de naissance.

#### **AVERTISSEMENT**

##### *Risque de suffoquer*

##### **Enlever les portes de votre vieux réfrigérateur:**

Le non-respect de cette instruction peut causer un décès ou des lésions cérébrales.

### Renseignements importants à propos de la mise au rebut des fluides réfrigérants

Mettre le réfrigérateur au rebut conformément à la réglementation fédérale et locale. Les fluides réfrigérants doivent être évacués par un technicien certifié et agréé par l'EPA conformément aux procédures établies.

**CONSERVEZ CES INSTRUCTIONS**

# LOCATION & INSTALLATION SAFETY

## WARNING

Observe all applicable codes and regulations.

- Before installation, plug in and turn the refrig. ON to verify that it works.
- Do not install the refrigerator near an oven, radiator, or other heat source (incl. direct sunlight).
- The refrigerator cabinet should be well-ventilated. (Review the cabinet dimensions to verify adequate air flow.)
- Installation should not impede air flow through the front grill.
- Installation should keep rodents from chewing through the power cord and causing a fire hazard.
- Construct the cabinet of strong material (e.g., wood, melamine) so it will not collapse or be easily damaged.
- Use cabinetry that will not warp from heat (motor) or humidity (open/close doors) emitted by the refrigerator.
- The floor surface in the refrigerator cabinet must be level within .04 in. (1 mm).
- The floor beneath the refrigerator must be strong enough to support 600 lb (272 kg) without sagging.
- Keep children out of the area during installation; do not let children play with packaging material (plastic sheeting/bags).
- Remove screws from the parts bag one-by-one to avoid loss and personal injury from sharp parts.
- Plug the refrigerator directly into a wall outlet. (Do not use an extension cord or power strip.)

## IMPORTANT

If needed, the refrigerator doors can be removed for passage through tight doorways.

- The DYF42SBIWS is a “built-in” refrig. (installed in a recess in the kitchen cabinetry).
- The refrigerator’s unfinished sides are hidden within the cabinet after installation.
- Check product dimensions and side-tipping radius with doorways, halls, stairs, corners, etc., to ascertain the most practical path for the refrigerator, then clear the path before moving the refrigerator.

## WARNING: Tip Hazard

- At least two people are needed to move/install the refrigerator
- The refrigerator tips easily when not securely installed.
- Tape doors shut until the refrigerator is in its cabinet ready to be secured.

## DANGER: Explosion Risk

To prevent explosion/fire and personal injury or death, keep flammable materials and vapors (e.g., gasoline, alcohol, paint thinner) away from the refrigerator.

# FRANÇAIS — SECURITE D'EMPLACEMENT — FRANÇAIS

## PRUDENCE

Observer les dispositions de tous les codes et règlements en vigueur.

- On recommande de ne pas installer le réfrigérateur près d'un four, d'un radiateur ou de toute autre source de chaleur.
- Ne pas installer l'appareil là où la température pourrait baisser au-dessous de 55°F (13°C).
- Le plancher doit pouvoir supporter le poids du réfrigérateur, soit plus de 600 lb (272 kg), en plus des panneaux de porte et du contenu du réfrigérateur.
- La hauteur sous plafond doit être suffisante pour permettre le basculement latéral du réfrigérateur.
- L'emplacement doit permettre l'ouverture complète des portes.
- L'emplacement d'installation doit permettre la dépose de la grille supérieure. Voir Dimensions de l'ouverture.
- Brancher l'appareil sur une prise à 3 alvéoles reliée à la terre.
- Ne pas enlever la broche de liaison à la terre.
- Ne pas utiliser un adaptateur.
- Ne pas utiliser un câble de rallonge.
- Débrancher la source de courant électrique avant l'entretien.
- Replacer pièces et panneaux avant de faire la remise en marche.
- Enlever les portes de votre vieux réfrigérateur.
- Utiliser un produit de nettoyage ininflammable.
- Garder les matériaux et les vapeurs inflammables, telle que l'essence, loin du réfrigérateur.
- Utiliser deux ou plus de personnes pour déplacer et installer le réfrigérateur.
- Débrancher le réfrigérateur avant l'installation de la machine à glaçons (seulement pour modèles prêts à recevoir une machine à glaçons).
- Utiliser un verre robuste pour prendre des glaçons (sur certains modèles).

## REMARQUE

Si toutes les portes sont trop petites pour le réfrigérateur de passer à travers, les portes du réfrigérateur peuvent être enlevées.

- Installer le réfrigérateur de façon à pouvoir le dégager facilement du mur pour entretien ou réparation.
- Une prise de courant à 3 alvéoles reliée à la terre doit être installée tel qu'illustré ci-dessous.
- Le robinet d'arrêt doit se trouver dans le placard inférieur, d'un côté ou de l'autre du réfrigérateur ou à un autre droit facilement accessible.

**REMARQUE :** Le plancher sous le réfrigérateur doit être au même niveau (affleurement) que le plancher de la pièce. Le devant du placard doit être droit.

Si le robinet d'arrêt de la canalisation d'eau n'est pas installé dans un placard adjacent, la canalisation d'eau peut parvenir au réfrigérateur à travers le plancher ou le mur arrière.

## AVERTISSEMENT: Risque de Basculement

- Le réfrigérateur est lourd au sommet et bascule facilement lorsqu'il n'est pas complètement installé.
- Garder les portes fermées avec un ruban adhésif jusqu'à l'installation complète du réfrigérateur.
- Utiliser deux ou plus de personnes pour déplacer et installer le réfrigérateur.
- Le non-respect de ces instructions peut causer un décès ou une blessure grave.

## DANGER: Risque d'Explosion

- Garder les matériaux et les vapeurs inflammables, telle que l'essence, loin du réfrigérateur.
- Le non-respect de cette instruction peut causer un décès, une explosion ou un incendie.

# INSTALLATION REQUIREMENTS

The top-heavy refrigerator should be anchored to its cabinet to prevent tipping. (Instructions on securing the refrigerator to the cabinet are on Page 15 under **Anchoring the Refrig. to Its Cabinet.**)

Knowing the side-tipping radius will help determine the refrigerator's path through doorways, etc. on the way to its cabinet enclosure. (The graphics on this page show back- and side-tipping radii.)

## Back-Tipping Radius: 86 in. (218.7 cm)

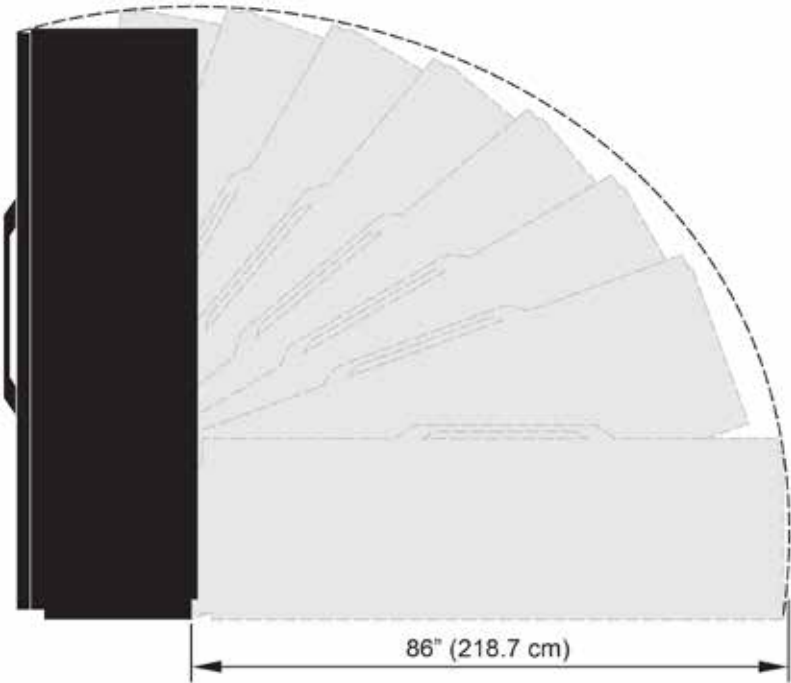

## Side-Tipping Radius: 92 13/16 in. (235.7 cm)

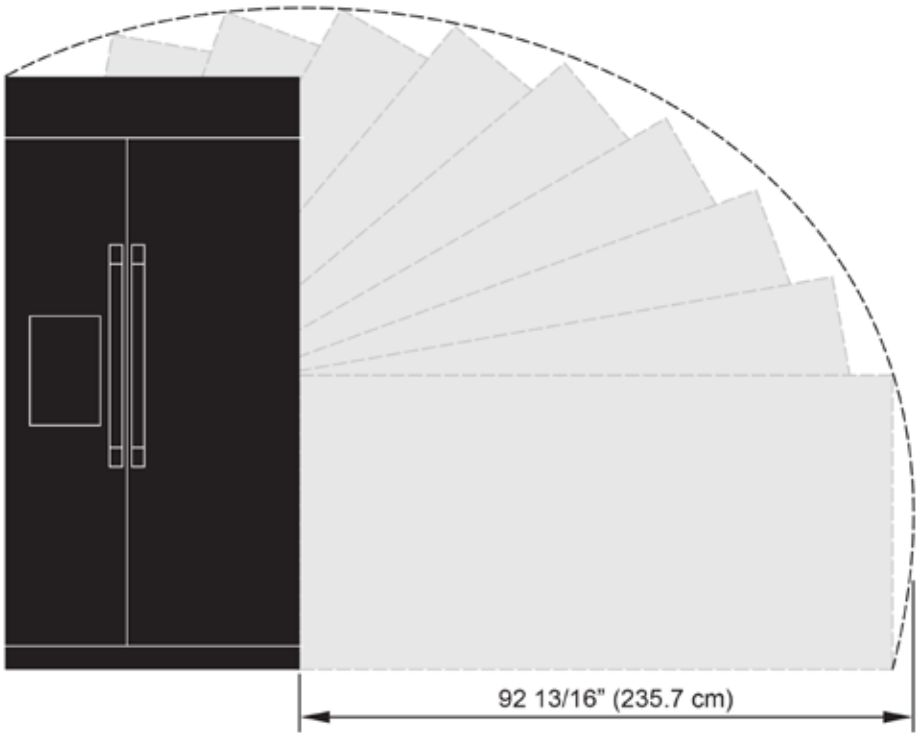

# INSTALLATION REQUIREMENTS

## Tools and Parts

This section describes the refrigerator's supplied hardware, and the tools and accessories needed for installation.

### Supplied Hardware/Accessories

- Water filter
- Anti-tip brackets
- Kickplate (and attaching screws)
- Front leveling legs (packed with kickplate)
- Tapping screws (12 qty.)
- Installation Instructions
- Use and Care Guide

### Required Tools

Have these items available to help with the installation:

- Safety glasses
- Drill and bits
- Socket wrench and sockets (6mm, 12mm)
- Open-end wrenches (11mm, 12mm)
- Screwdrivers (blade and Phillips)
- Tubing cutter
- Pliers
- Tin snips
- Level
- Bucket
- Appliance dolly
- Stepladder

## Grounding the Refrigerator

### CAUTION

**FOR YOUR SAFETY, THIS APPLIANCE MUST BE PROPERLY GROUNDED.**

- This refrigerator's power cord has a 3-prong (grounding) plug, which inserts into a standard 3-prong (grounding) wall outlet to minimize the risk of electric shock.
- Ensure a qualified electrician verifies that the wall outlet and circuit are properly grounded.
- It is the homeowner's responsibility to have the proper outlet installed. (Do not use a GFI outlet.)



### WARNING

**FAILURE TO FOLLOW THESE INSTRUCTIONS MAY RESULT IN ELECTRICAL SHOCK/FIRE/DEATH:**

- Never cut/remove the power cord ground (third) prong.
- Do not use an adapter plug to connect the refrigerator to a 2-prong outlet.
- Do not use an extension plug with this appliance.

## Water-Pressure Requirements

The water dispenser and icemaker need a cold-water supply with 30–120 psi (207–827 kPa) water pressure.

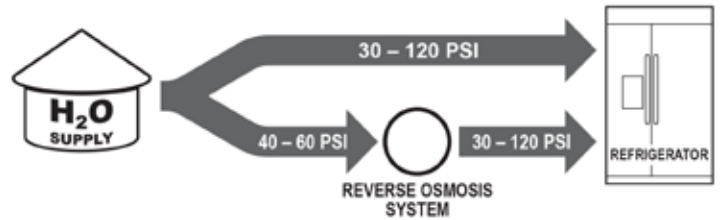

If you install a reverse-osmosis system *between* the water supply and refrigerator, the water pressure from the supply to the osmosis system must be 40–60 psi and from there to the refrigerator, 30–120 psi.

A licensed plumber can answer questions about water pressure.



# INSTALLATION REQUIREMENTS

## Water-Line Requirements

Before connecting the refrigerator water line to the home's line, familiarize yourself with the home's plumbing layout, then decide how best to use it, and tap into the home's line minding these requirements:

- The installer shall provide the 5/16" (0.8 cm) water line and all fittings.
- The water line must be long enough that the refrigerator can be pulled forward for service and cleaning without disconnecting/damaging the line.
- All installations must meet local plumbing codes.
- The water shut-off valve should be in the base cabinet on either side of the refrigerator (right-hand side recommended) or other easily accessible location.
- If the water shut-off valve comes through the wall behind the refrigerator, it must be angled so the line does not kink when the refrigerator is in place.
- If not in a side cabinet, ensure the water-supply pipe is within the area shown in the graphic.

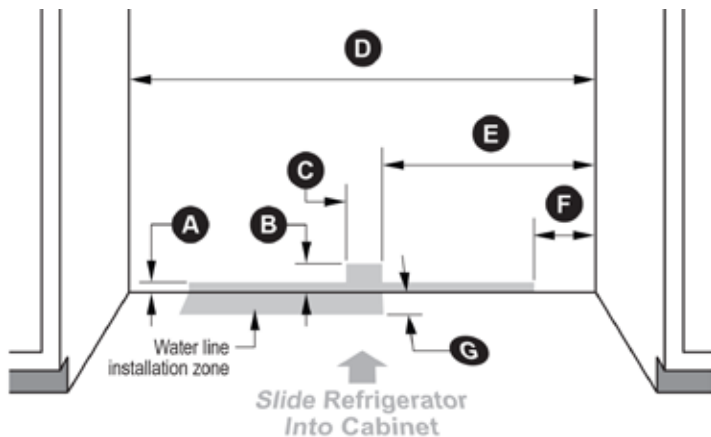

| Callout | Dimension         | Description   |
|---------|-------------------|---|
| A       | 1" (2.5 cm)       | Floor level up the rear wall  |
| B       | 2 3/4" (7.0 cm)   | Floor level up to top of rear-wall entry area for water line                                |
| C       | 3 3/16" (8.1 cm)  | Width of rear-wall entry area for water line  |
| D       | 42" (106.7 cm)    | Overall width of refrigerator cabinet   |
| E       | 19 1/4" (49.0 cm) | Distance from right-side cabinet wall to right-side edge of floor entry area for water line |
| F       | 5 3/4" (14.6 cm)  | Distance from right-side cabinet wall to right-side edge of water-line install zone         |
| G       | 6 1/8" (15.6 cm)  | Distance from rear wall to back of refrig. (allowing for water-line coil)                   |

## Installing the Water Filter

The refrigerator is bypassed automatically until the water filter is installed.

### ⚠ CAUTION

- The water-filter installation is not covered by the refrigerator or icemaker manufacturer warranty.
  - Follow the instructions in this section carefully to minimize the risk of water damage.
  - The water-supply line must be connected to the *cold*-water pipe; otherwise, the filter may malfunction.
- If the coupler does not fit on the current tap, purchase the proper fittings from an authorized service dealer.

### ⚠ WARNING

- Use only Dacor-provided/-approved filters. (For details, call Dacor customer service or a local Dacor dealer.)
- Unapproved filters may leak and damage the refrigerator, causing electric shock. Dacor is not responsible for personal injury/appliance damage caused by third-party water filters.

To install the water filter:

1. Turn off the water supply to the refrigerator.
2. Open the grill cover at the top of the refrigerator.
3. Set the filter in place, and turn it clockwise until it stops snugly, and close the grill cover.
4. Press-hold **Water** on the control panel for 3 seconds. *The water-filter life-cycle detector sets itself; the filter indicator goes out.*
5. Re-open the water valve, and run water through the dispenser for 7 minutes (to remove impurities and air from the water line.)

# INSTALLATION REQUIREMENTS

## Cabinet Cutout Dimensions

To accommodate the refrigerator, the cabinet “cutout” must conform to these details:

- Cutout dimensions: 42”W x 84”H x 24”D (1067mm x 2134mm x 610mm).
- Install the refrigerator so it can be pulled from the cutout for service/cleaning without detaching the water line.
- The cutout’s floor must be at the same level as the kitchen floor. (The refrigerator cannot be on a raised platform/flooring or sub-floor.)
- The refrigerator’s face (excl. handles) must be flush with the cabinetry on either side.
- The water line can enter the cutout through the floor, lower rear wall, or lower cabinetry side wall. (The graphic shows the floor and side walls.) The shut-off valve must be easily accessible for service/emergencies.
- The water line connects the house’s cold-water line with the refrigerator’s water-line connector. (The line should be long enough to reach the front of the refrigerator.)
- Dacor recommends that while preparing the refrigerator for installation, you place a mat under the refrigerator to prevent damage to the flooring.

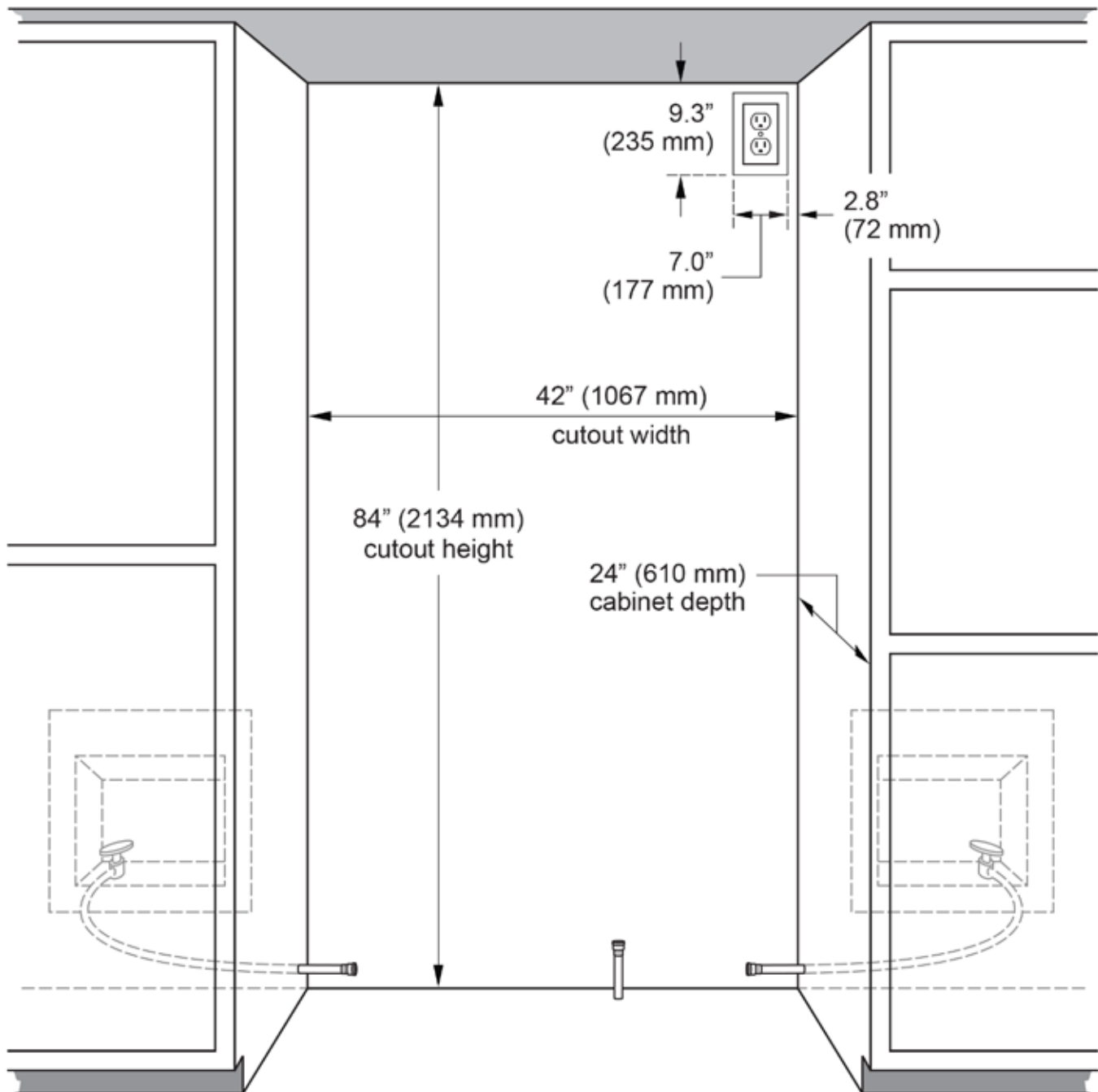

# PRODUCT SPECIFICATIONS

## Refrigerator Dimensions

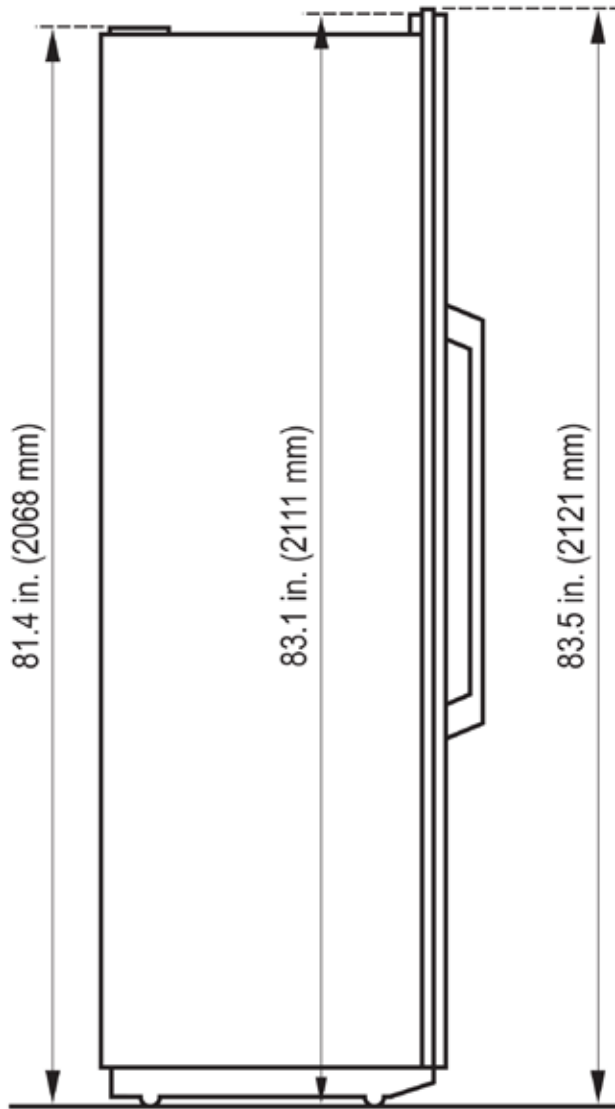

**Left View**

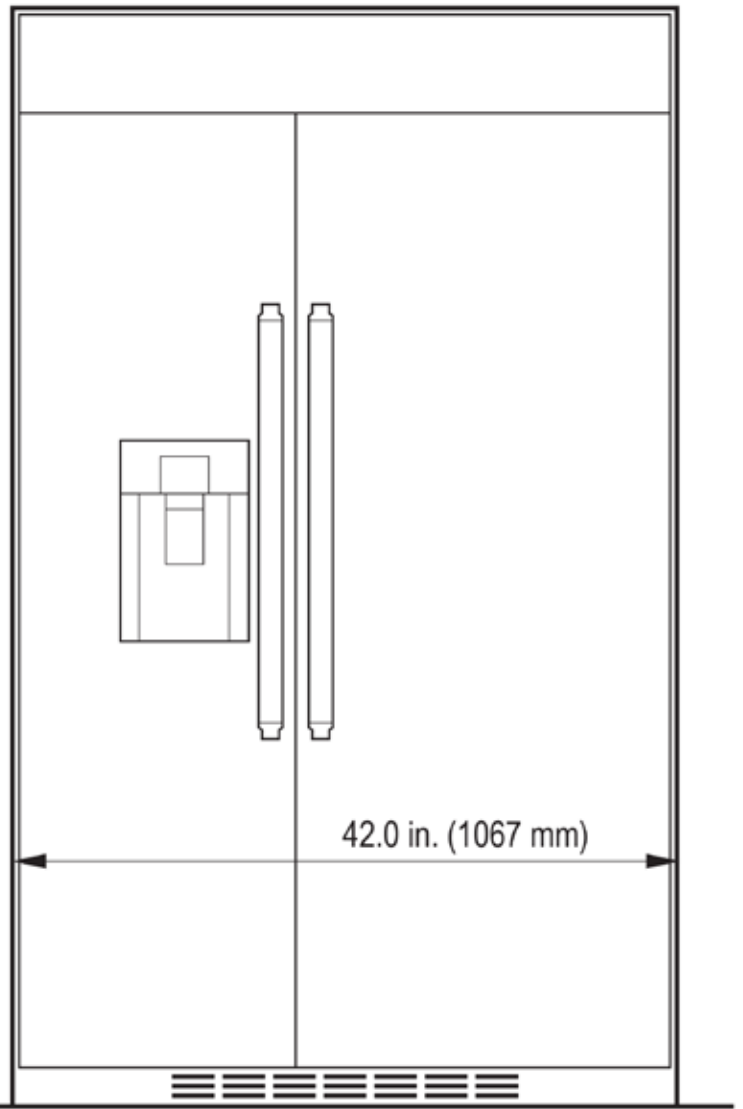

**Front View**

# PRODUCT SPECIFICATIONS

## Refrigerator Dimensions, cont.

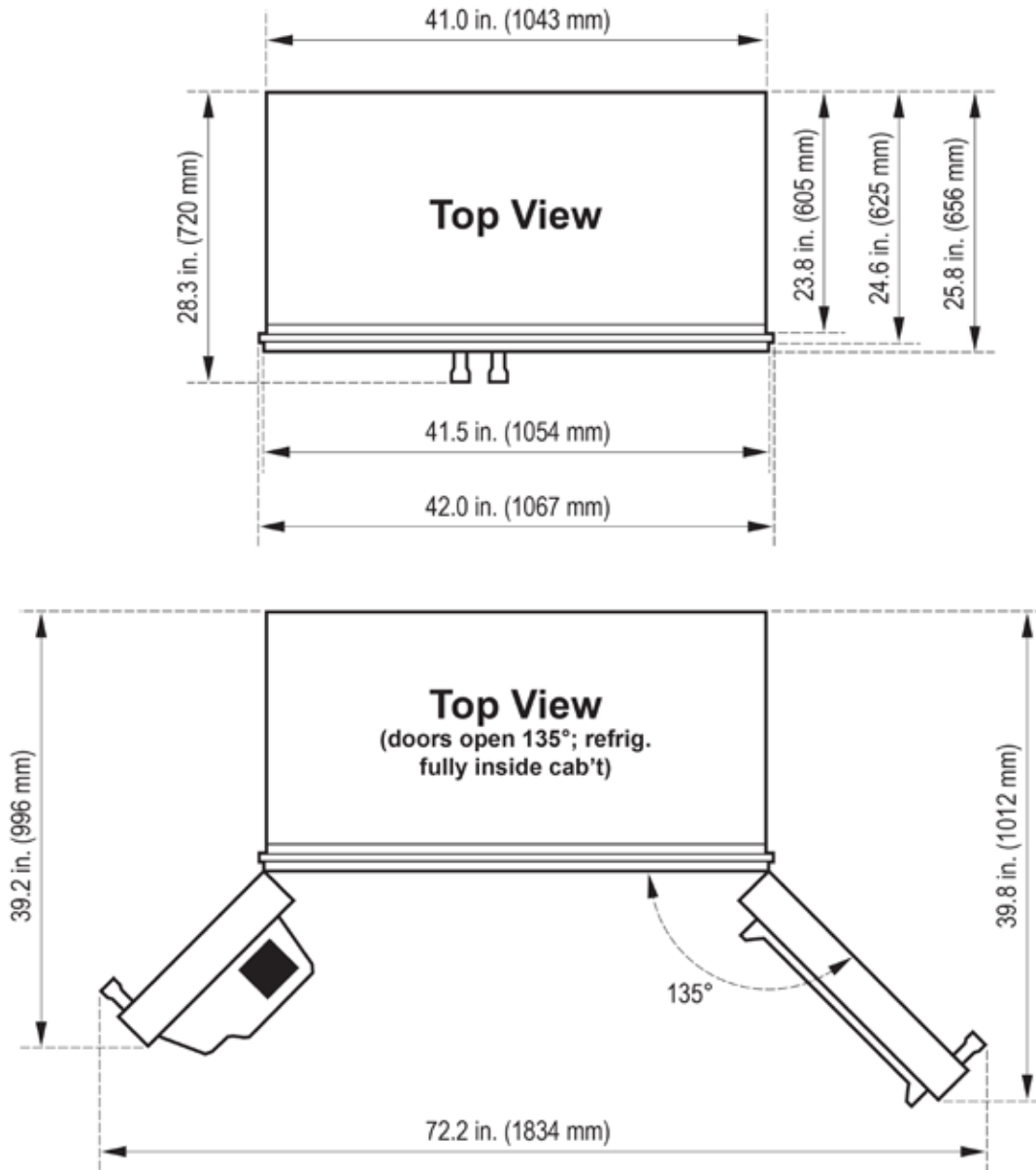

# INSTALLATION INSTRUCTIONS

## Removing the Packaging

The refrigerator comes bolted to a wooden pallet and boxed in heavy cardboard.

### CAUTION

At least two people are needed to unbox the refrigerator safely.

Remove the packaging outdoors or in a space with a very tall ceiling.

### CAUTION

- The refrigerator is secured to the pallet with six 1/2" bolts. Do not lay the refrigerator down to remove the pallet.
- Do not cut, scissor, saw, or otherwise remove the carton with sharp tools.

1. Carefully cut the banding at the top/bottom of the carton, and lift the carton off the refrigerator.
2. Slide out the two rear-corner posts.
3. Remove the kickplate (taped to the top of the refrigerator), and set it aside.

### NOTE

The refrigerator's front leveling legs are packed with the kickplate. You will install the legs in a later procedure.

4. At the base of the refrigerator on both sides, remove all six bolts that secure the refrigerator to the pallet.
5. From the freezer side, tilt the refrigerator, and remove the bracket.
6. Slide the appliance dolly under the freezer side, and carefully lower the refrigerator.
7. Place the corner posts on the refrigerator's forward corners (to protect those corners from tension from security straps), and secure the refrigerator to the dolly.

### NOTE

You may need to cut the corner posts to a usable length.

8. With the appliance dolly, lift the refrigerator off the pallet.

### CAUTION

- Do not roll/drag the refrigerator while it is on the pallet.
- Ensure the water line is clear of the appliance dolly.

## Connecting the Water-Supply Line

This consists of two options in which either: 1) code-approved flexible tubing, or 2) copper tubing, is attached to the main water-supply shut-off valve.

### Style 1: Flex Tube to Shut-Off Valve

First, review the directions. Ensure you have a minimum 7-ft. code-approved, flexible supply line.

### NOTE

If the water-line connection from the home supply line does not look like the connection in the graphic below, go instead to **Style 2: Copper Line to Shut-Off Valve**.

### IMPORTANT

- If you turn the refrigerator on before connecting the water line, be sure to turn the ice maker *off*.
- With this installation style, a valve placed *behind* the refrigerator would not allow the refrigerator front to be flush with the cabinets on either side. For a "flush" installation, the shut-off valve needs to be inside one of the base cabinets to the left/right of the refrigerator.

1. (With the refrigerator unplugged) Connect the flex tubing to the water shut-off valve by threading the provided nut onto the valve.

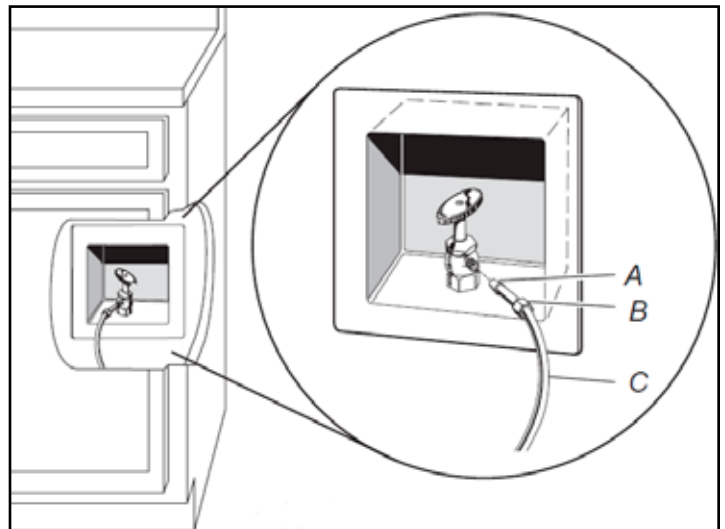

| Callout | Description  |
|---------|--|
| A       | Bulb (engages water-valve outlet)                          |
| B       | Nut (slides forward to screw/attach to water-valve outlet) |
| C       | Flexible water line (carries water to refrigerator)        |

2. (With the open end of the tubing in a bucket) Turn on the shut-off valve, check the fittings for leaks, and tighten any loose connections.

# INSTALLATION INSTRUCTIONS

## Style 2: Copper Tube to Shut-Off Valve

1. (With the refrigerator unplugged) Turn off the main water supply; turn on the nearest faucet briefly to clear the water from the line.
2. Find a 1/2" to 1 1/4" (1.3 cm to 3.2 cm) vertical *cold-water* pipe near the refrigerator.

### IMPORTANT

If using a horizontal pipe, drill the pipe from the top to keep water away from the drill and to prevent sediment from collecting in the valve.

3. Determine copper tube length by measuring from the refrigerator connection to the water pipe, then add 7 ft (2.1 m) so the refrigerator can be slid out of its cabinet without disconnecting the water line.

### IMPORTANT

Use 1/4" (6.4 mm) OD (outside diameter) copper tubing; cut both ends squarely.

4. With a cordless drill, put a 1/4" (6.4 mm) hole in the cold-water pipe.
5. Ensure the outlet end is solidly in the drill hole and the washer is under the pipe clamp, then tighten the packing nut.

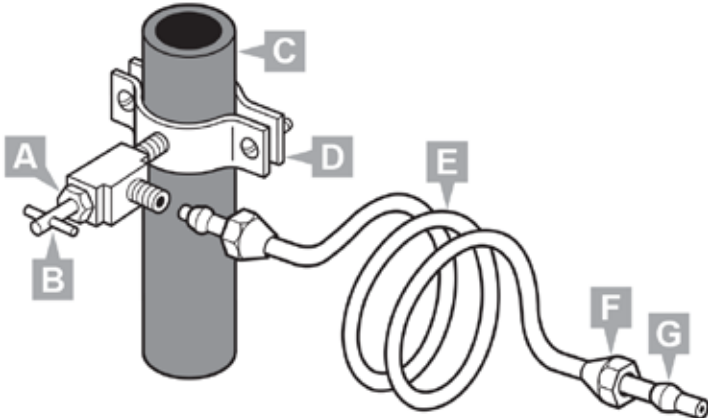

| Callout | Feature  |
|---------|--|
| A       | Packing nut (keeps water from leaking at shut-off valve)           |
| B       | Shut-off valve (controls water passage from main line to refrig.)  |
| C       | Cold-water pipe (home water-supply line)                           |
| D       | Pipe clamp (secures shut-off valve to main supply line)            |
| E       | Copper tubing (connects main supply line to refrigerator)          |
| F, G    | Compression nut, sleeve (join copper tubing to valve/refrigerator) |

6. Tighten the pipe-clamp screws slowly and evenly (but not overly tight) so the valve mechanism seals to the main water pipe.
7. Slip first the compression nut, then the compression sleeve onto the copper tube.

8. Insert the tube fully into the valve outlet, and screw the compression nut snugly in place.

### IMPORTANT

Overtightening the nut will crush the copper tubing.

9. Turn off the valve, and coil the slack tubing, taking care not to kink it.
10. Connect the flexible, code-approved water-supply line to the open end of the copper tubing as in Steps 7, 8.
11. With the end of the flex tube in a bucket, open the valve, and adjust the fittings where any leaks occur.

### IMPORTANT

Before attaching the tubing to the shut-off valve, flush the main water-supply line to remove particles and air in the line. Stop when the water is clear. This action helps keep filters/valves from clogging.

## Connecting the Flex Tubing to the Refrigerator

The flexible, code-approved tubing can connect to the supply valve through the floor or side cabinetry.

1. (With the refrigerator unplugged) Connect the 7 ft. (2.1 m) min. flexible tube to the main-line outlet (whether to the copper line or the supply-line valve as installed in one of the previous connection procedures).

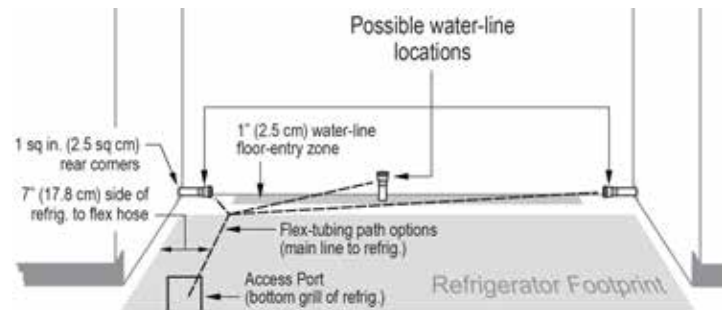

2. Run water through the tube from the main water-supply line to flush out particulates and air.

### NOTE

Flush the line until the water runs clear.

3. (At several points along the flex tube) Tape the tube to the floor 7" (17.8 cm) to the right of the refrigerator's left side and parallel to the cabinet wall.

### NOTE

- The 7" distance and the tape holds the tubing in a specific place so the refrigerator can pass safely over the tubing when installed/removed.
- Leave a minimum 26" (66.0 cm) of slack at the front end of the flex tube for connection to the refrigerator.

# INSTALLATION INSTRUCTIONS

4. Connect the flex line to the refrigerator.

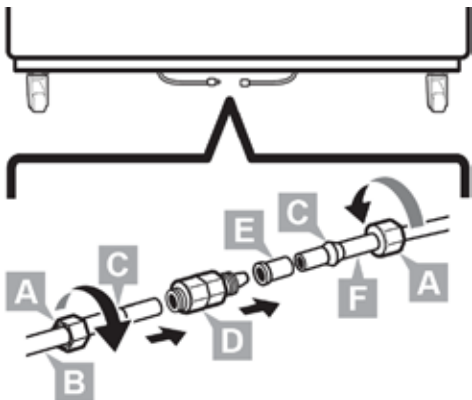

| Callout | Feature   |
|---------|---|
| A, C    | Compression nut, ferrule (connect home supply to coupling)          |
| B       | Flex tube (brings water from main supply to refrigerator)           |
| D       | Compression fitting (connects flex tube to refrigerator inlet tube) |
| E       | Sleeve (connects compression fitting to refrigerator inlet tube)    |
| F       | Refrigerator water-supply inlet tube                                |

5. (With the open end of the tube in a bucket) Turn on the shut-off valve, check the fittings for leaks, and tighten any loose connections.



## NOTE

If the main-line shut-off valve is behind the refrigerator, a secondary shut-off valve may be installed in the line with the supply line at the front of the appliance.

## Setting Up the Icemaker



## NOTE

- The appliance temperatures are preset at 37°F (refrigerator side) and 0°F (freezer side).
- Wait 24 hours for the temperatures to stabilize before adjusting them.

1. Open the upper grill door, and press the master power switch to turn on the refrigerator.
2. Open the freezer door, and on the ice maker, press-hold the Test button for 2 seconds.

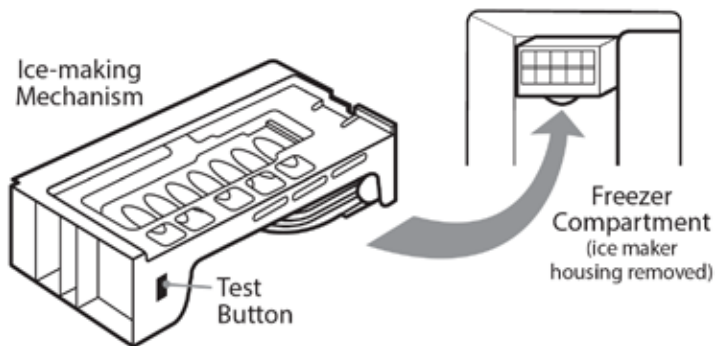

## NOTE

- The ice tray rotates and returns to its original position, then water enters the line, indicating normal operation.
- Discard the first bucket of ice cubes.

## Attaching the Kickplate

You removed the kickplate from the top of the refrigerator when you removed the packaging. Two screws are provided for installation.

The refrigerator's front leveling legs were packed with the kickplate; set the legs aside for later installation.



## CAUTION

The kickplate keeps foreign objects (e.g., mops, brooms, shoe tips) from impacting critical mechanical components beneath the appliance. Be sure to install this safety device.

To install the kickplate:

Align the screwholes in the front of the kickplate with the holes in the base of the refrigerator, and attach the kickplate with the provided screws.

# INSTALLATION INSTRUCTIONS

## Installing the Anti-Tip Brackets

These brackets are a safety measure that keep the top-heavy refrigerator from falling out of its enclosure.

1. Measure the distance from the floor to the top-rear surface of the refrigerator.
2. Using the measurement in Step 1, mark a *level* line across the cutout rear wall at the height at which you will attach the brackets. (The mark should be where the *bottom* of the bracket arms overhang the top of the refrigerator so it fits under the brackets.)



### NOTE

For this refrigerator model, the distance from the floor to the bottom surface of the bracket overhang should be 81.75" (2076.5 mm), but be sure to double-check this measurement to avoid complicating the installation.

3. Snugly attach the anti-tip brackets to the back wall of the refrigerator cabinet.

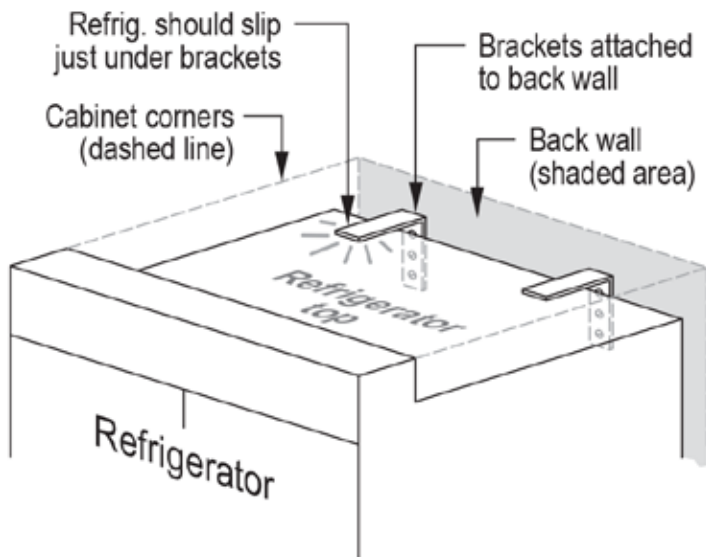

### NOTE: Alternate Method

Use this anti-tip method for steel wall-stud construction.

1. (The refrigerator face is flush with the surrounding cabinetry) Adjust refrigerator height to just touch the cutout opening.
2. Open the top grill panel to access the top case trim.
3. With a 5mm bit, drill four evenly spaced holes across the metal upper-case trim.
4. With a 2 mm bit, drill pilot holes through each hole in the metal into the wood trim above the refrigerator.
5. Install a 38 mm drywall screw into each pilot hole.

## Installing the Refrigerator

1. Position the line from the main water line to the refrigerator so you can access it easily when connecting to the refrigerator.
2. Plug in the refrigerator power cord.
3. Open the upper grill panel, and press the master power switch.

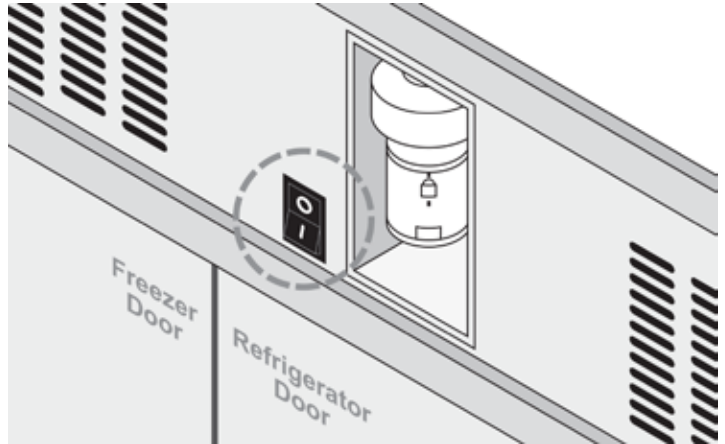

4. Open the doors to verify that the light is on and the refrigerator is receiving power.
5. Turn off the refrigerator, and attach the front leveling legs. (You separated these legs from the kickplate in an earlier procedure.)



### CAUTION

- If you fully screw in the leveling legs, the refrigerator base will rest on the floor and may damage the floor when the appliance is moved.
- The rear leveling legs are not designed for full extension. Do not extend the leveling legs past 3/4" (2 cm), or their threads will be stripped under the refrigerator's full weight, rendering the legs useless.
- Do *not* use a power drill to adjust the rear leveling legs.

6. Push the refrigerator into the cutout, ensuring the power cord is not pinched/kinked behind it.
7. One after the other, attach a ratchet to the rod of a rear leveling leg (front-left/-right sides at the refrigerator base), and adjust the refrigerator height.
8. In finalizing your adjustments, use a level tool to ensure the refrigerator is level side-to-side and front-to-back).



### NOTE

The refrigerator must be level so the doors align properly at the top, allowing them to open/close as designed.



# INSTALLATION INSTRUCTIONS

## Aligning the Refrigerator Doors

Stand back from the refrigerator, and note the door alignment. Shipping or custom installation of heavy door panels may have caused the doors to misalign.

1. Remove the rubber cap from the door's leveling leg, and with a Phillips screwdriver, loosen (do not remove) the leg's locking screw so you can turn the leg.

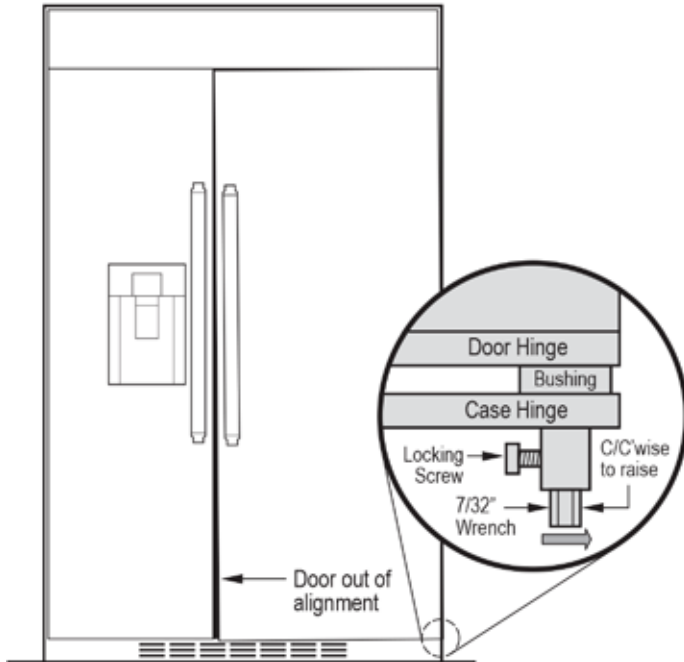

2. With a 7/32" wrench, turn the leveling leg (clockwise: lower; counterclockwise: higher) until the doors align horizontally.
3. Tighten the locking screw, and replace the rubber cap over the tip of the door-leveling mechanism.

## Anchoring the Refrig. to Its Cabinet

Performing this optional procedure keeps the refrigerator from being pulled from its cabinet.

1. Open the grill door to access the refrigerator side trim.
2. Through the provided holes in the trim, drive a screw into the cabinetry side wall.

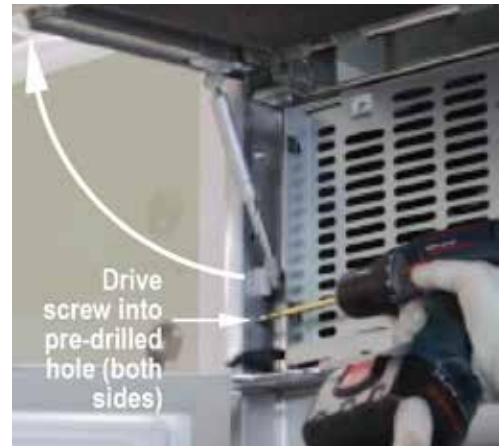

3. Repeat Steps 1, 2 on the other side of the refrigerator.
4. Press the main power switch to turn the refrigerator on, and close the grill door.

# NOTES



***dacor***  
The Life of the Kitchen.®