

CRYSTORAMA

LIGHTING THE WAY FOR SIXTY YEARS

ASSEMBLY INSTRUCTION MODEL #5168-EB-CL-MWP

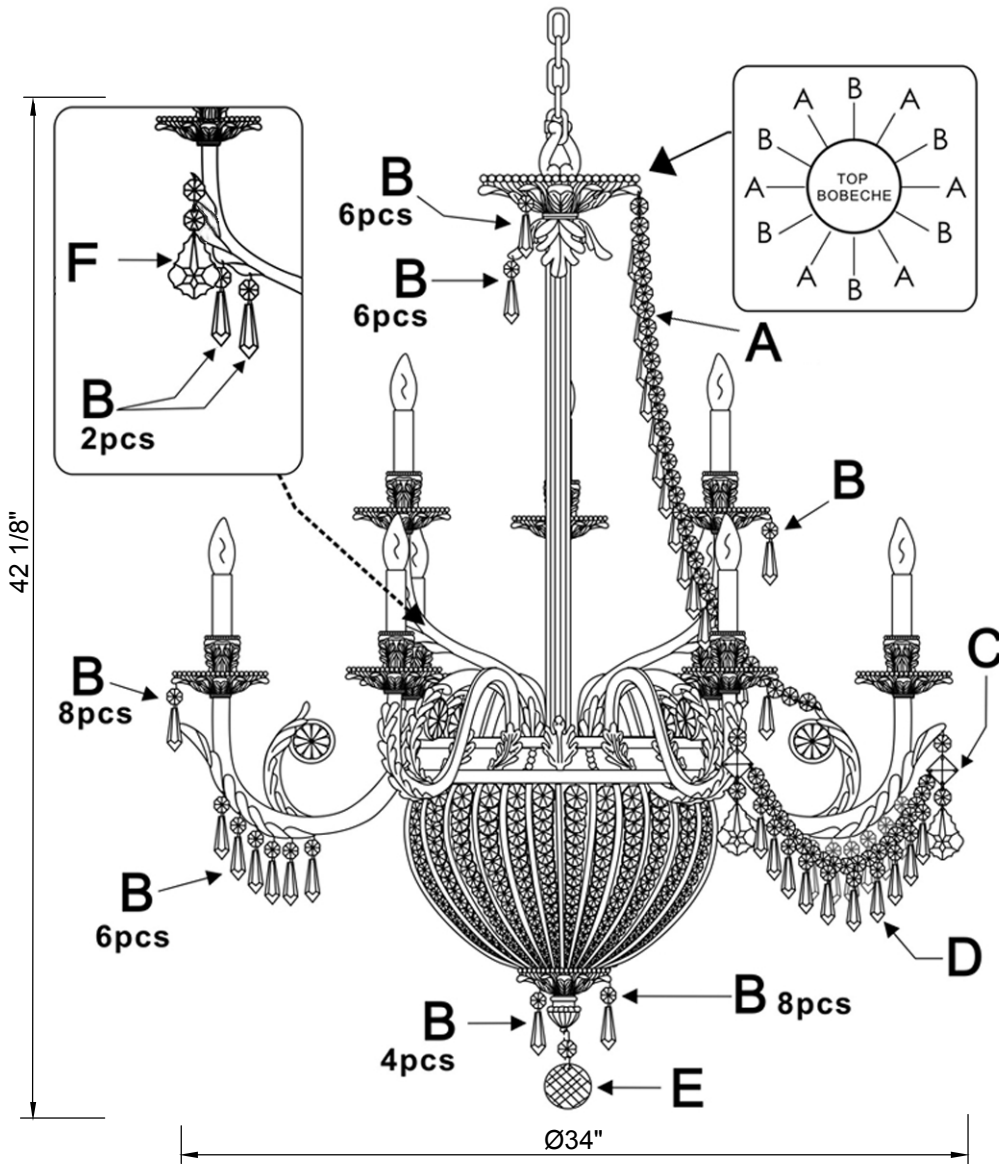

WARNING:



Electrical Danger

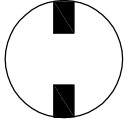

Turn Power Off

All electrical components must be installed by a licensed electrician in accordance with the National Electric Code and the appropriate local electrical codes.

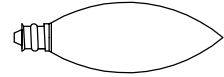

You will need 12 - Candelabra Bulb
40 Watts Recommended 60 Watts Max.
USE LED BULBS FOR EXTENDED USE

How to Install

1. Adjust each arm until they are at an equal distance from one another.
2. Screw long nipple into coupling on top of fixture and secure with nut.
3. Place long tube, big check ring, leaf and cap over nipple and secure with nut and loop.
4. Attach mounting plate to the outlet box using box screws. Thread nipple into mounting plate and secure with nut.
5. Slide collar ring and canopy over chain. Thread screw collar onto the nipple.
6. Connect chain to the screw collar and the loop.
7. Feed wires up through chain and pass wires through holes in screw collar.
8. Connect the fixture wires to the supply wires.
9. Secure canopy with screw collar ring.
10. Install the bulb (Not included) in accordance with the fixture's specifications. (DO NOT EXCEED THE MAXIMUM WATTAGE RATING!)
11. Screw short nipple into coupling on bottom of fixture and secure with nut.
12. Place short tube and small check ring over nipple and secure with nut.
13. Place basket over nipple and secure with nut.
14. Place cap over nipple and secure with finial.
15. Hook crystal on the body as shown.

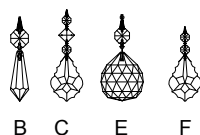
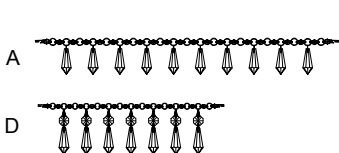
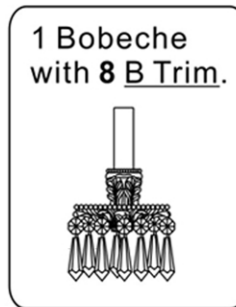
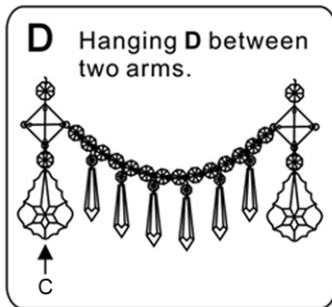

Crystal Sets

- A. 6 Set. 14mm*34+38mm*14
- B. 138 Set. 14mm+38mm
- C. 6 Set. 14mm+18mm+14mm+76mm
- D. 6 Set. 14mm*22+(14mm+38mm)*10
- E. 1 Set. 14mm+40mm
- F. 3 Set. 14mm+14mm+76mm

WARNING: This product can expose you to Lead, which is known to the State of California to cause cancer and/or birth defects or reproductive harm. For more information go to www.P65Warnings.ca.gov

CRYSTORAMA

LIGHTING THE WAY FOR SIXTY YEARS

PART NUMBER MODEL #5168-EB-CL-MWP

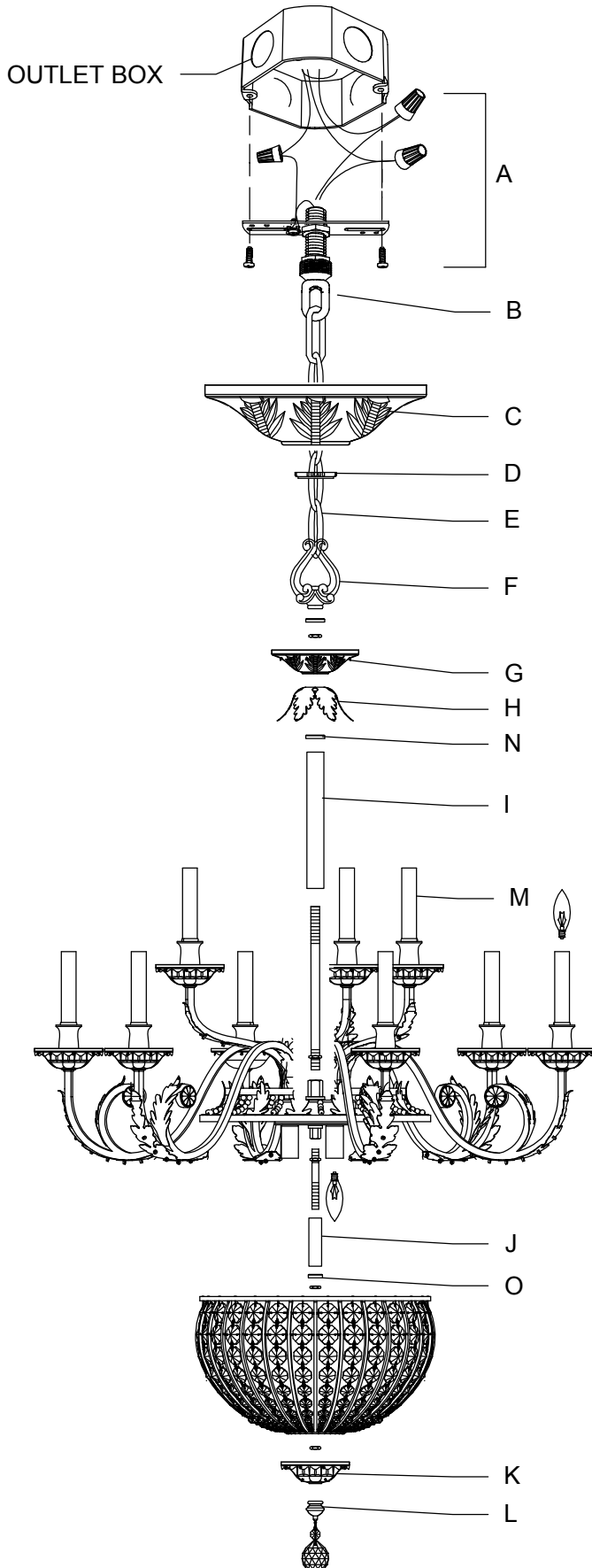

Part Number

Part Numbers

- A. Mounting Hardware
 - (3) - Wire connector
 - (1) - Mounting Plate
 - (2) - Box Screws
 - (1) - Grounding Screw
- B. (1) - Screw Collar;
- C. (1) - Canopy; Ø5" x 1 1/2"H;
XVE5168EBCAN5IN
- D. (1) - Collar Ring
- E. (1) - Chain; Ø3.8mm x 72";
XVE5168EBCHA3.8MM
- F. (1) - Loop
- G. (1) - Cap; XVE5168EBTCAP
- H. (1) - Leaf;
- I. (1) - Long Tube; Ø1" x 610mm;
- J. (1) - Short Tube; Ø0.75" x 175mm;
- K. (1) - Cap; XVE5167EBBCAP
- L. (1) - Finial; XVE5167EBFIN
- M. (9) - Candle Sleeve; Ø22X110mm;
XVE5168EBCDL4.3IN
- N. (1) - Big Check Ring;
- O. (1) - Small Check Ring.