

SPECIFICATIONS:

- Available in brushed nickel finish
- Single or 3 hole mount with optional escutcheon included
- Pop-up assembly included
- Max. flow rate : 1.2gpm @60 psi.
- Solid lead free brass body
- With Zinc lever handle
- With Neoperl areator

OVERALL DIMENSIONS:

2" (W) x 6¼" (D) x 11¾" (H)

50mm (W) x 158mm (D) x 298mm (H)

SHIPPING:**Cube** 0.223**GW** 4.20 lbs**COMPLIANCE CERTIFICATIONS:**

Meets or exceeds the following specs:

- IAPMO cUPC
- ASME A112.18.1/CSA B125.1
- NSF 61 Section 9
- NSF 372

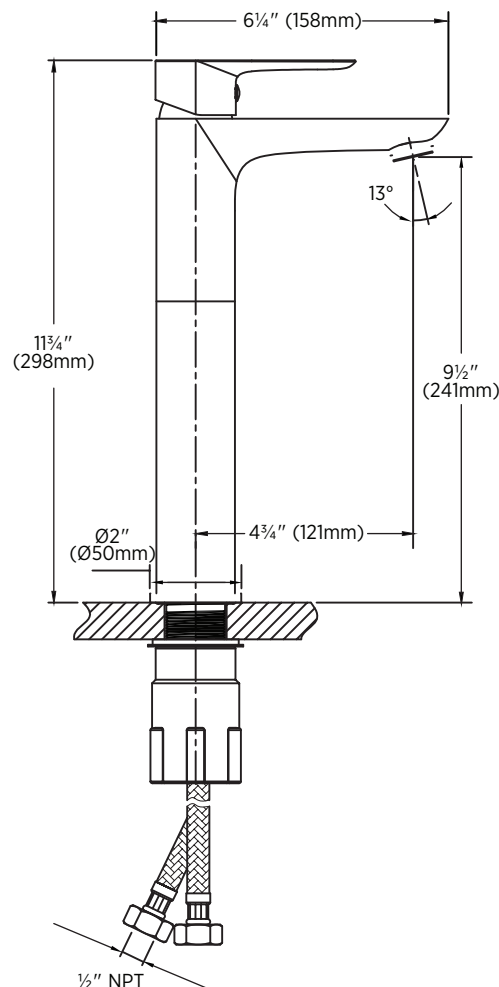
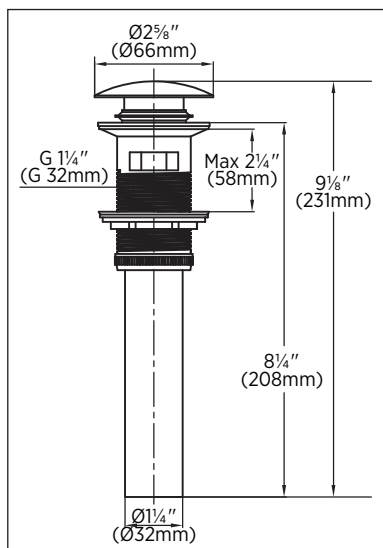
**ITEM TO BE SPECIFIED:****BRUSHED NICKEL:**☐ FS-1550-BN**Notes:**

Important: Dimensions of product are nominal and may vary within the range of tolerances allowed. These measurements are subject to change or cancellation. No responsibility is assumed for use of superseded or voided pages.