

# CHICAGO FAUCETS



2100 SOUTH CLEARWATER DRIVE  
DES PLAINES, ILLINOIS 60018-5999

Last As Long As The Building

FITTING NO.

981-WS

SUBMITTED MODEL NO.

JOB NAME

ITEM NO.

SUBMITTED AS SHOWN

SUBMITTED AS NOTED

SEE ATTACHED FOR  
SUBMITTED MODIFICATION

IS ASSUMED FOR USE OF SUPERCEDED OR VOIDED DATA.

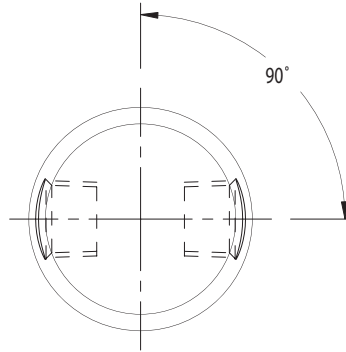

3/8" NPT FEMALE  
THREAD OUTLET  
(2 PLACES)

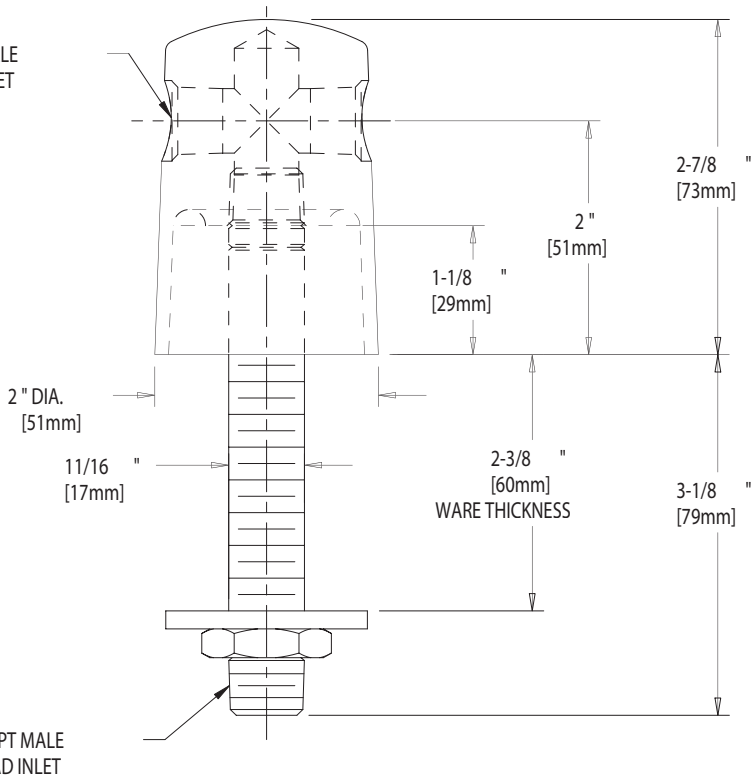

3/8" NPT MALE  
THREAD INLET

ROUGHING IN DIMENSIONS MAY VARY AND ARE SUBJECT TO CHANGE. NO RESPONSIBILITY

DIMENSIONS IN INCHES AND [MILLIMETERS].

TECHNICAL DATA

- TURRET WITH TWO SIDE OUTLETS AT 180°
- INLET SHANK ASSEMBLED TO TURRET
- FINISH: CHROME PLATE

DATE: 5-21-02

BY: JAR

CHK'D:

APP'D:

REV: A

981-WS