

CHICAGO[®] FAUCETS

2100 SOUTH CLEARWATER DRIVE
DES PLAINES, ILLINOIS 60018-5999

FITTING NO.

928-VR

SUBMITTED MODEL NO.

JOB NAME

ITEM NO.

SUBMITTED AS SHOWN

SUBMITTED AS NOTED

SEE ATTACHED FOR
SUBMITTED MODIFICATION

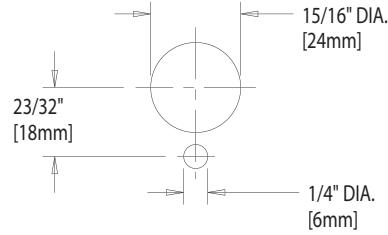

PLAN VIEW HOLE LOCATION
FOR BODY SHANK AND PIN

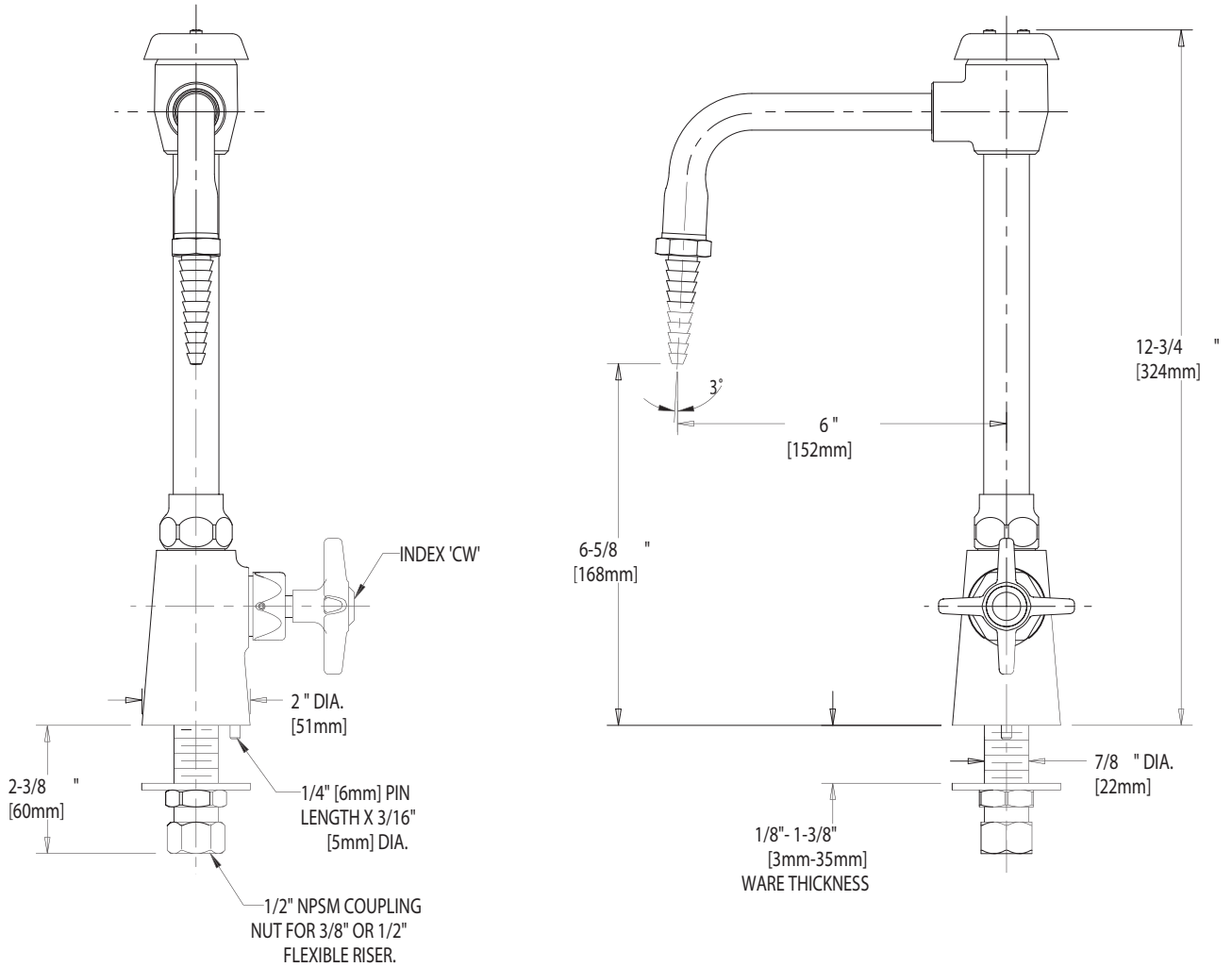

DIMENSIONS IN INCHES AND [MILLIMETERS].

TECHNICAL DATA

- DECK MOUNTED VANDAL RESISTANT LABORATORY FITTING
- RIGID VACUUM BREAKER SPOUT
- 204 INDEXED 4-ARM HANDLE
- SLO-COMPRESSION UNIT
- POLISHED CHROME FINISH OR AS SPECIFIED

- E7 LAB NOZZLE OUTLET
- ANSI A12.18.1 COMPLIANT
- CSA B125 COMPLIANT

DATE: 04-25-97

BY: MGM

CHK'D:

APP'D:

REV: 04-25-97

928-VR

IS ASSUMED FOR USE OF SUPERCEDED OR VOIDED DATA. (0192-1)

ROUGHING IN DIMENSIONS MAY VARY AND ARE SUBJECT TO CHANGE. NO RESPONSIBILITY