

JOB NAME

ITEM NO.

SUBMITTED AS SHOWN

SUBMITTED AS NOTED

SEE ATTACHED FOR
SUBMITTED MODIFICATION



ADA COMPLIANT

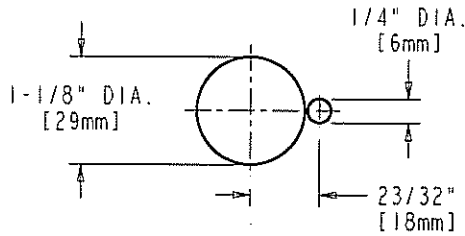

**PLAN VIEW HOLE LOCATION
FOR BODY SHANK AND PIN**

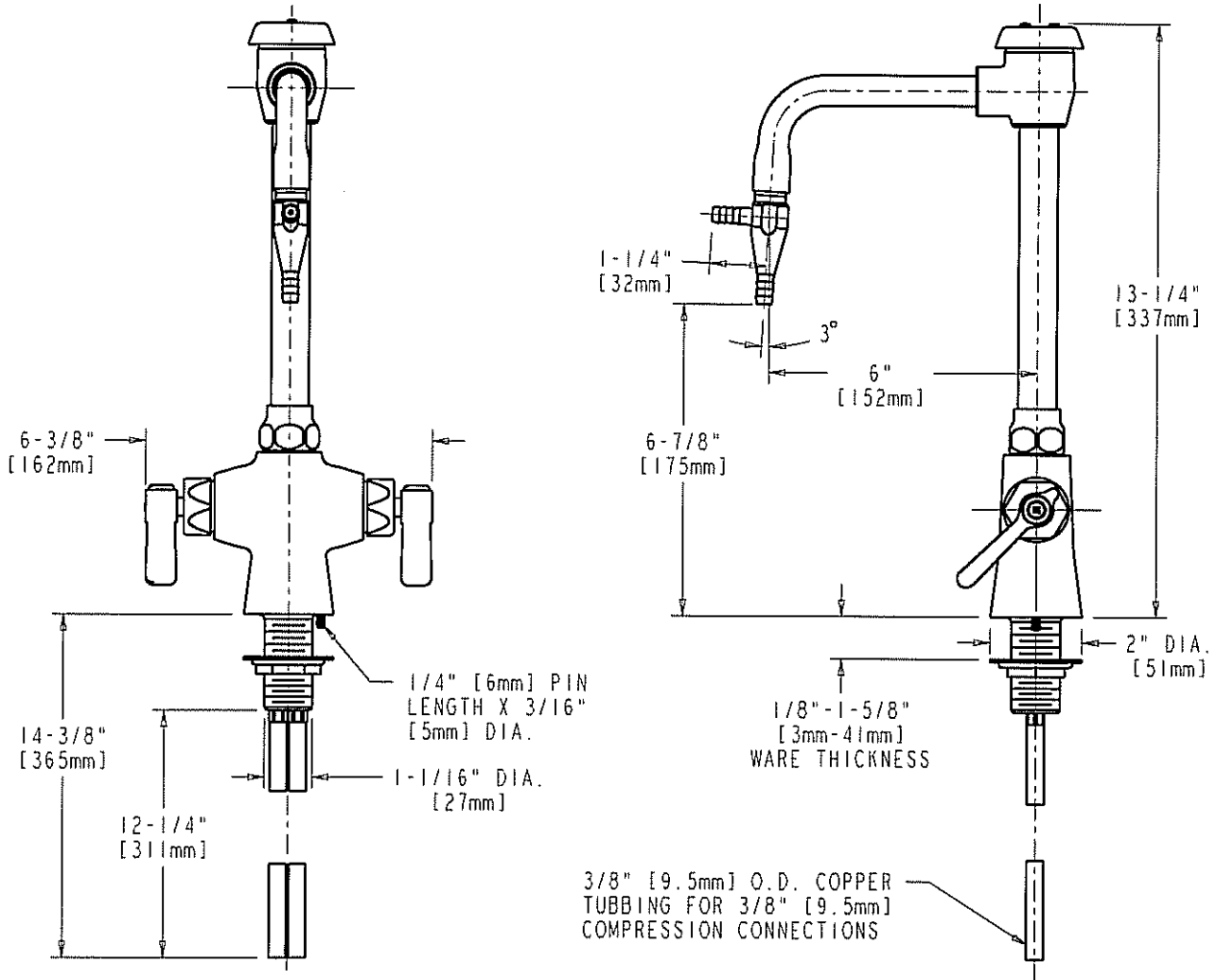

ROUGHING IN DIMENSIONS MAY VARY AND ARE SUBJECT TO CHANGE. NO RESPONSIBILITY IS ASSUMED FOR USE OF SUPERCEDED OR VOIDED DATA.

TECHNICAL DATA

- VANDAL RESISTANT DECK MOUNTED HOT AND COLD WATER FITTING
- RIGID VACUUM BREAKER SPOUT
- 369 INDEXED LEVER HANDLES
- QUATURN OPERATING CARTRIDGES
- FINISH: CHROME PLATE

- ALL THREADED CONNECTIONS FACTORY CEMENTED
- VANDAL RESISTANT VALVE BODY BASE
- E17 ASPIRATOR PUMP OUTLET
- ASME A112.18.1M COMPLIANT
- CSA B125 COMPLIANT

DATE: 03-01-06

BY: SID

CHK'D:

APP'D: *[Signature]*

REV:

930-VRE17-369