

Central Brass Company, Inc.  
3325 S. Garfield Ave.  
Commerce, CA 90040  
(800) 321-8630  
www.centralbrass.com

### Tools:



Adjustable Wrench



Teflon Tape



Pipe Cutter



Propane Torch



Lead-Free Solder

## Model Number: 0465, 0466, 0468, 0469, 0470 Series



### Warnings and Notes:

Check with local plumbing code requirements before installation.

This product should be installed by a local listed plumber.

**Do not use plumbers putty on threads.**

### Installation Steps:

Two Handle Laundry Faucet

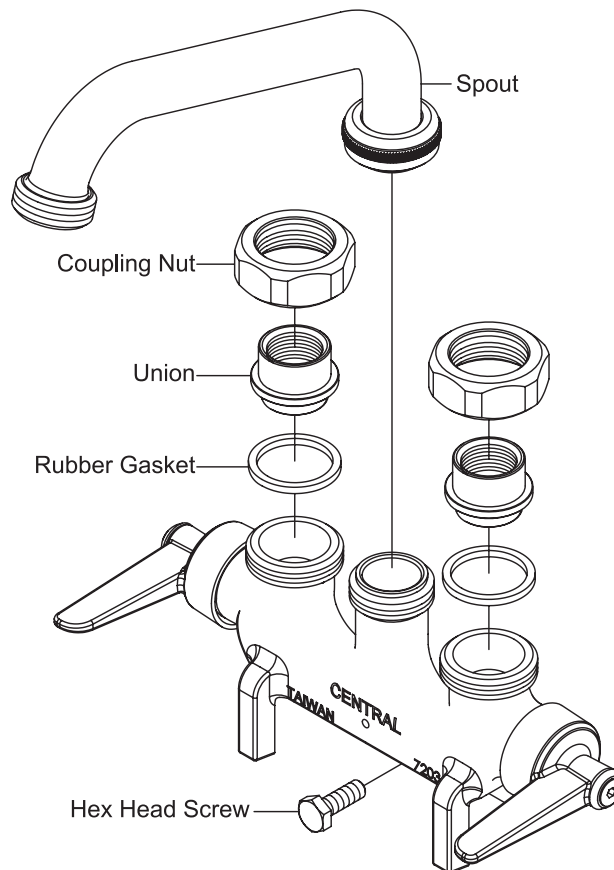

- (1) Place faucet on mounting place as shown, screw in the hex head screw to hold faucet secure.
- (2) **For IPS connection:** Apply Teflon tape onto the thread end of inlet pipe line, slide coupling nut onto inlet pipe line, screw and tighten the union to inlet pipe thread end. Repeat the same procedure to connect the other inlet pipe line.  
**For CXC connection:** Slide coupling nut onto inlet pipe line, solder inlet pipe line to the union. Repeat the same procedure to connect the other inlet pipe line.
- (3) With rubber gasket under the union, tighten coupling nut of both sides to faucet inlet with the help of a wrench.
- (4) Carefully insert the spout straight into the faucet spout hole to avoid jamming spout O-ring, tightly screw on spout nut. Attach handle of both sides.

Central Brass  
COMPANY, Inc.

For more care information or trouble shooting inquiries about your Central Brass product, please call:  
**Central Brass Company, Inc.** (800) 321-8630  
Monday-Friday 8 AM to 8 PM EST (5 AM to 5 PM PST)  
www.centralbrass.com