

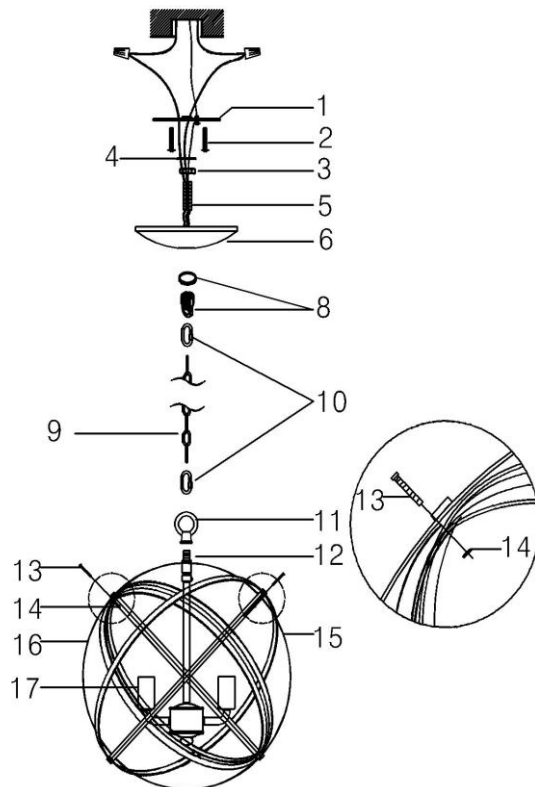

### ASSEMBLY AND INSTALLATION INSTRUCTIONS for the **4233/4234/4236** Fixture

#### Important Safety information (Please read before proceeding)

1. Remove the fixture, parts and all mounting hardware bags (orange) from the carton and verify that all parts are present according to the illustration sheet. All parts must be used as indicated. Do not replace any parts, leave any parts out, or use any parts which are worn out or broken. **Failure to follow the instructions could cause a hazardous situation, voids the warranty and violates the U.L. listing of the fixture.**
2. To prevent the electric shock, turn off the main power at the circuit breaker before installing the fixture. **NEVER attempt to install, clean or replace bulbs without shutting off the electricity to the fixture.**
3. **Never use light bulbs with wattage ratings that exceed the fixtures maximum rating.** Always make sure the electric current is turned off before changing the bulbs.
4. If you experience difficulties installing the lighting fixture or it fails to work as expected, please contact a local qualified licensed electrical contractor.
5. Please contact your local Capital Lighting Fixture reseller with any assembly or installation questions. Your local reseller can also provide you with replacement parts for your new fixture.



#### Components

1. Mounting Bar
2. Outlet Box Mounting Screw
3. Hex Nut
4. Washer
5. Nipple
6. Canopy
8. Threaded Ring & Screw Collar Loop (1/8-27IP)
9. Chain
10. Chain Link
11. Loop
12. Fixture
13. Pin
14. Small Hex Nut
15. Ring Group
16. Ring Group
17. Light Cluster

#### Assembly Instructions for the 4233/4234/4236 fixture

1. Screw Loop (11) onto center pipe end of Fixture (12).
  2. Take Nipple (5) from parts bag and screw in Screw Collar Loop (8), and run Hex Nut (3) and Washer (4) down Nipple (5), then screw Nipple (5) into Mounting Bar (1). Mounting Bar (1) must be positioned with extruded thread faced into Outlet Box. Nipple (5) must protrude out the back of Mounting Bar (1).
  3. Attach Mounting Bar (1) to Outlet Box with Outlet Box Mounting Screws (2).
  4. Unscrew the Threaded Ring from Screw Collar Loop (8). Take Canopy (6) and pass over Screw Collar Loop (8). Approximately one half of the Screw Collar Loop exterior threads should be exposed. Adjust Screw Collar Loop (8) by turning assembly up or down in Mounting Bar (1). Remove Canopy (6).
  5. After desired position is found, tighten Nipple (5) onto Screw Collar Loop (8) and tighten Hex Nut (3) with Washer (4) against the Mounting Strap (1).
  6. Slip Canopy (6) over Screw Collar Loop (8) and thread on Threaded Ring. Attach Chain (9) and Chain Link (10) with fixture connected to bottom of Screw Collar Loop (8). Unscrew Threaded Ring, let Canopy (6) and Threaded Ring slip down.
  7. Pass lead wire and ground wire through chain links no more than 3 inches apart, then pass wires through Threaded Ring, Canopy (6), Screw Collar Loop (8), Nipple (5) and into Outlet Box.
  8. Connect fixture ground wire to outlet box ground wire with wire connector supplied; connect white fixture wire to power supply white wire with wire connector supplied; connect black fixture wire to power supply black wire with wire connector supplied.
  9. Raise Canopy (6) to ceiling, verify all wires are securely inside Canopy (6), then secure Canopy (6) in place by tightening Threaded Ring onto Screw Collar Loop (8).
  10. Rotate each ring of Ring Group (15) per direction of arrow label on each ring so they are equally spaced around the fixture, make sure all assembly holes are in line, then insert Pin (13) into assembly holes, secure Ring Group (15) by screwing Small Hex Nut (14) onto Pin (13). Note: Both Pin (13) and Small Hex Nut (14) are packed into a plastic bag of parts bag box. If the Pin (13) cannot go thru assembly holes into Ring Group (15) smoothly it is normally due to the assembly holes are not in line.
  11. Repeat the same actions for the assembly of Ring Group (16).
- \* Image 1 to 4 shown how to assemble the whole orb step by step distinctly.