



California Faucets®

# Steampunk Bay®

INDUSTRIAL SINGLE HOLE FLOOR MOUNT TUB FILLER WITH HANDSHOWER

### Features

- Available in 28 finishes including 13 PVD finishes
- All brass construction
- No additional wall or trap stabilizer kit required
- Tub filler: Maximum flow rate: 10 gpm (37 L/min) at 60 psi
- Handshower: Flow rate: 2.0 gpm (7.6 L/min) or 1.8 gpm (6.8 L/min)
- Ceramic mixing cartridge
- Handshower holder may be adjusted forward during installation
- Rough valve sold separately (9511)

### Codes/Standards Applicable

Product meets or exceeds the following:

- ASME A112.18.1/CSA B125.1
- CEC (1.8 gpm) / DOE (2.0 & 1.8 gpm)
- Commonwealth of MA
- EPA WaterSense handshower (2.0 gpm)
- ADA compliant (with lever handles)
- Local codes may require installation of an upstream tempering valve



8611.FR shown

8611.20  
8611B.20  
8611W.20  
8611.18  
8611B.18  
8611W.18



DIMENSIONS, in.[mm]		
HANDLE OPTIONS	A	B
8611	1 3/8" [80]	15 1/16" [177]
8611B	3" [77]	6 1/4" [158]
8611W	3 2/4" [70]	15 5/16" [151]

	THROUGH-HOLE SPECIFICATIONS		
	MIN	RECOMMENDED	MAX
MOUNTING FLANGE:	Ø 3-11/16" [94]	Ø 3-11/16" [94]	Ø 3-15/16" [100]

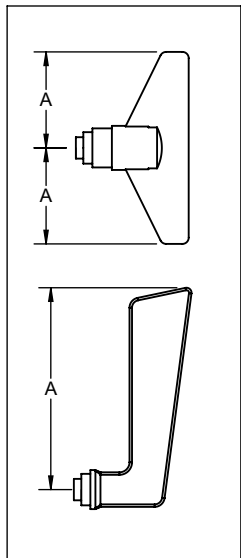
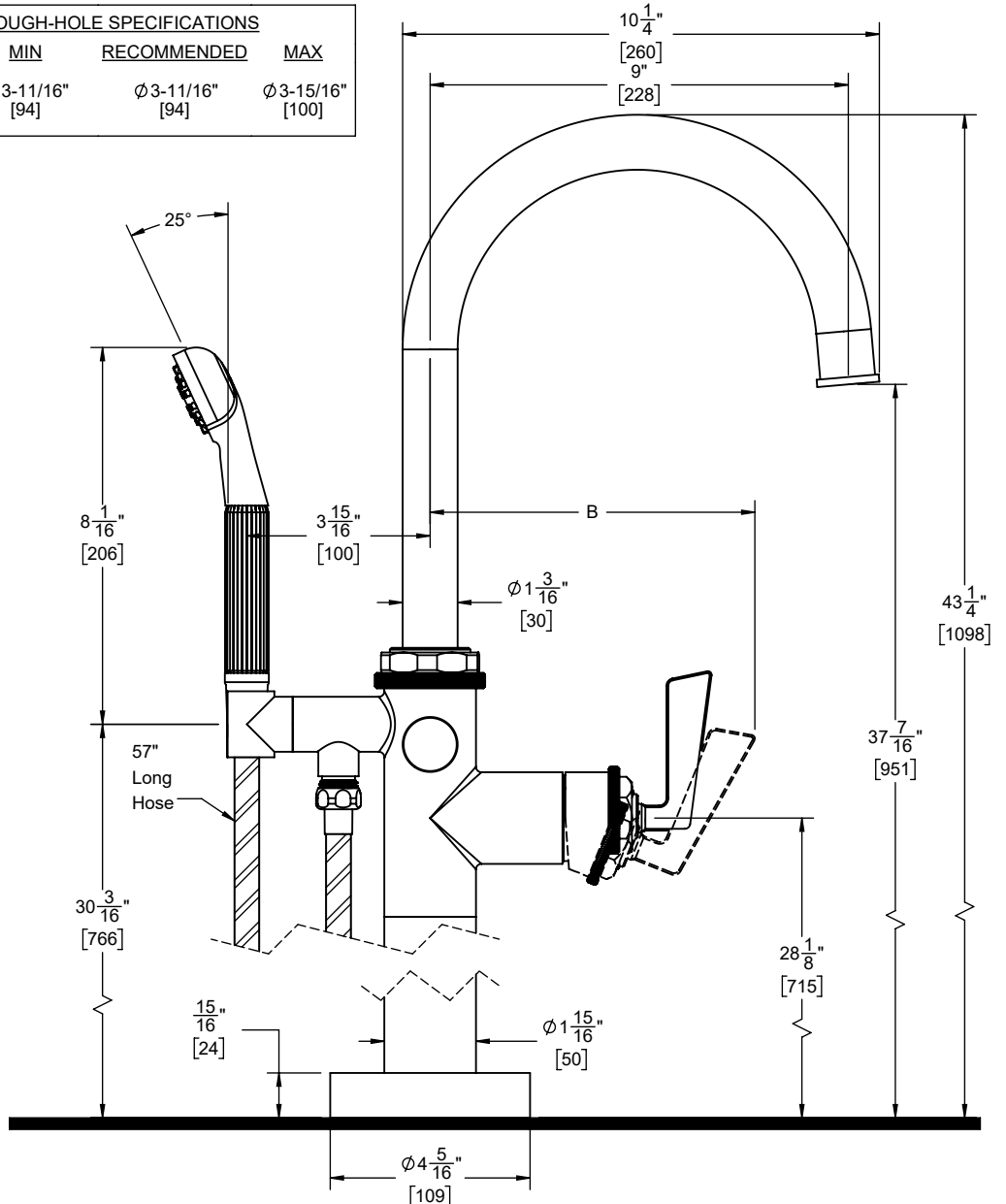

SPECIFICATIONS SUBJECT TO CHANGE WITHOUT NOTICE

ALL DIMENSIONS SHOWN TO NEAREST 1/16"  
[ALL DIMENSIONS SHOWN TO NEAREST 1MM]