



# Kitchen Pull-Down Faucet Installation Instructions

**CALIFORNIA FAUCETS RECOMMENDS THAT ALL PLUMBING PRODUCTS BE INSTALLED BY A LICENSED PROFESSIONAL**

**IMPORTANT: Read all instructions prior to installation and provide copy of instructions to consumer.**

**Operating Specifications:**

Recommended Supply Pressure: 20 to 70 psi \*†

\* Operating pressures between hot and cold supplies should vary no more than 30 psi.

† If water pressure exceeds 70 psi, install a Pressure-Reducing Valve (PRV).

## I

### INSTALLING TO SINK/DECK

- Place BASE (2) with GASKET (3) onto BODY (1)
- Slide INLET HOSES (4) and SPRAY-HOSE (5) through sink/deck hole

**NOTE:** Sink/deck recommended hole size is  $\varnothing 1-3/8"$

- From underside slide O-RING (6) first, then SPACER (7) if necessary, BRACKET (8), and NUT (9) onto SHANK (1a); loosely tighten NUT (9)

**IMPORTANT:** if deck thickness is LESS than 1/2" use SPACER (6)

- Position BODY (1) with handle on right side and securely tighten NUT (9)

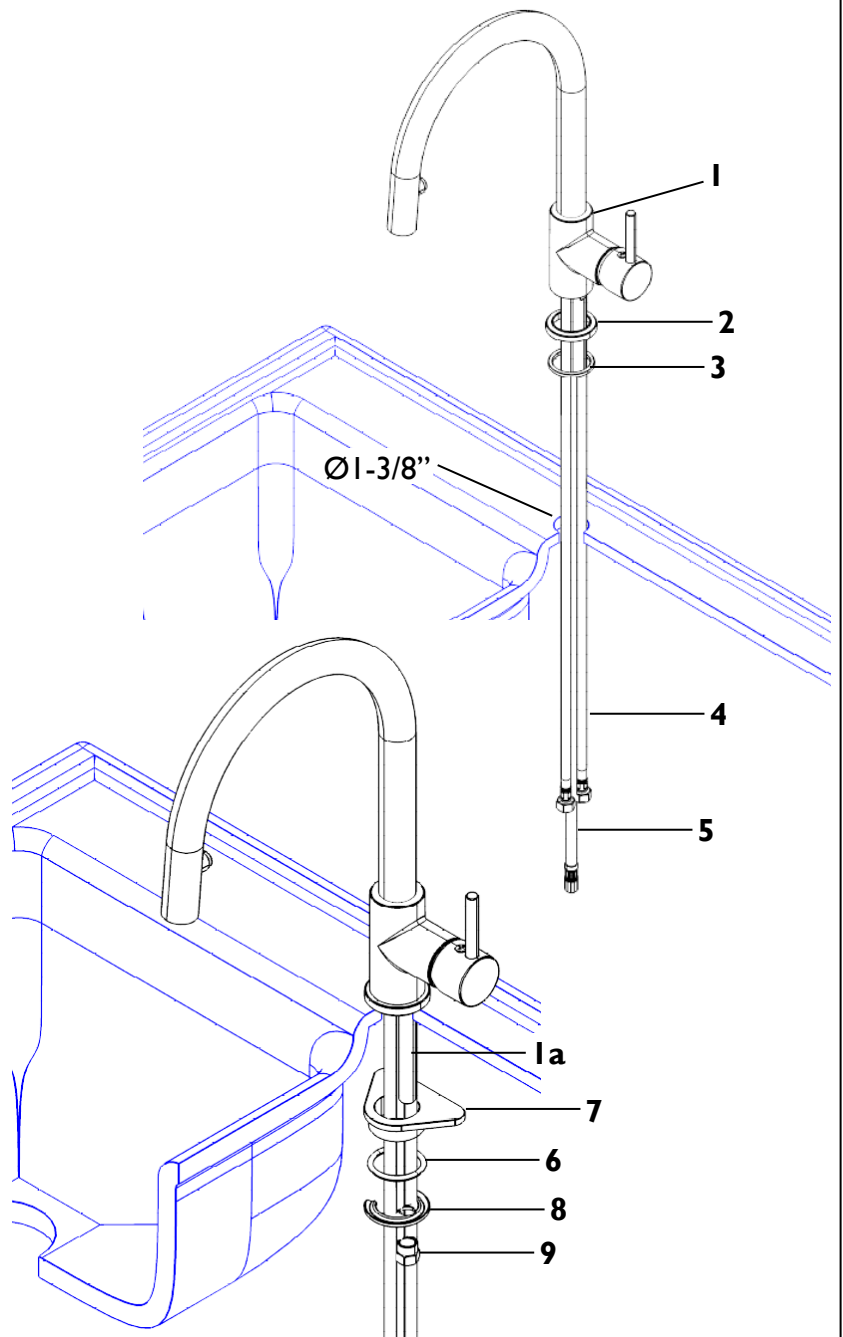
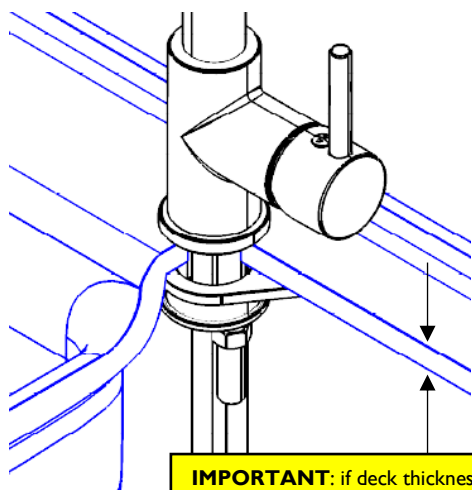

**IMPORTANT:** Water supplies MUST be flushed before running water through SPRAYHEAD (10); the following procedure will ensure debris removal

- Tighten red colored nut on HOT INLET HOSE (4a) to HOT SUPPLY (11a)
- Tighten blue colored nut on COLD INLET HOSE (4b) to COLD SUPPLY (11b)
- Ensure that faucet HANDLE (12) is in closed position as shown (straight up)
- Turn on **HOT** and **COLD** SUPPLY VALVES (11)
- Place BUCKET (13) (not supplied) under SHANK (1a)
- Slowly open HANDLE (12) on faucet and cycle through cold and hot water until water runs clear

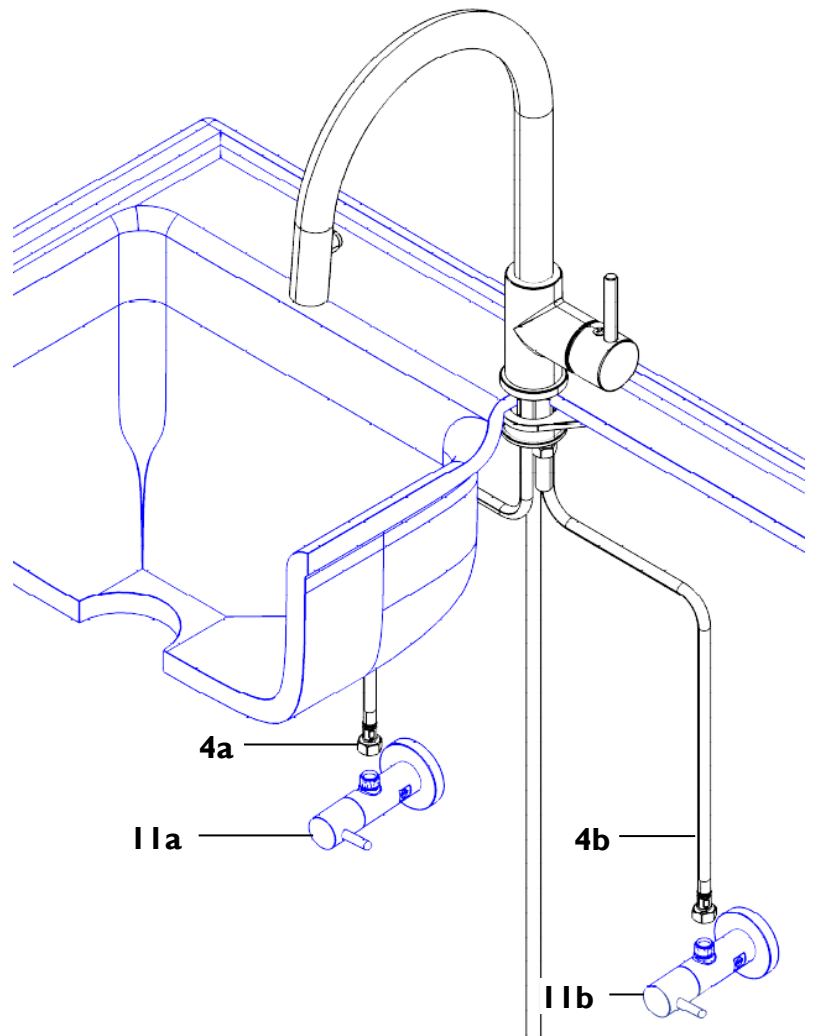
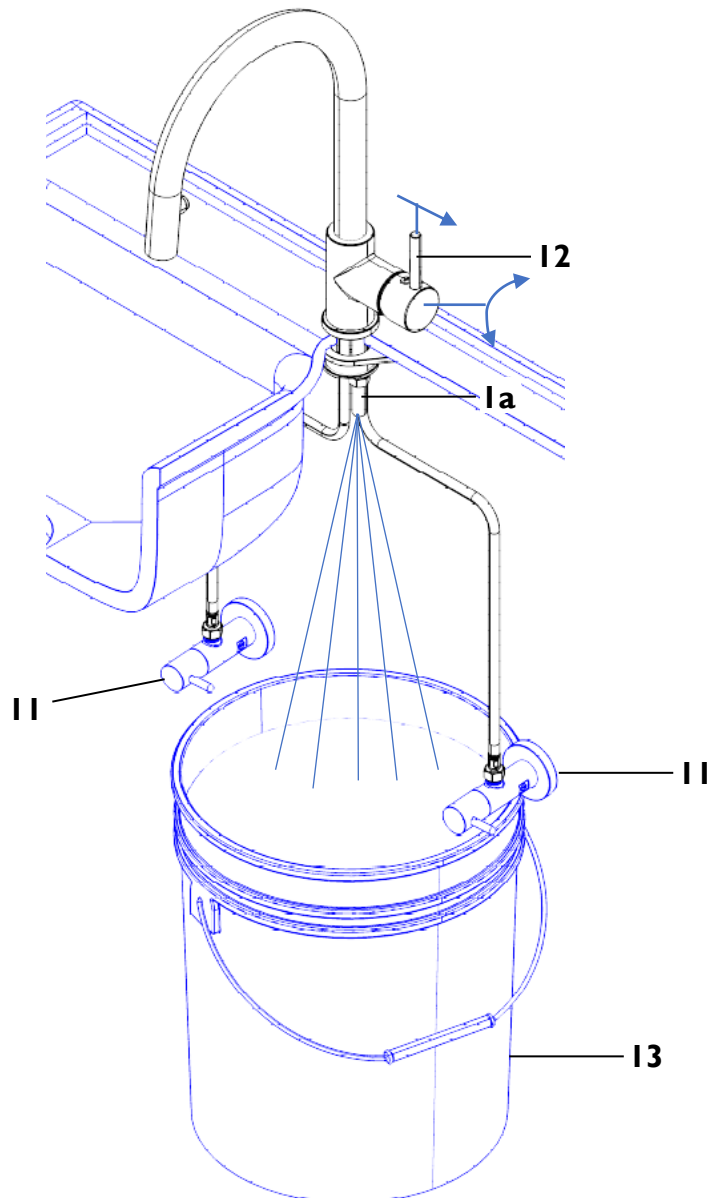

### 3

## FINAL CONNECTIONS

- Place LARGE WASHER (15) into top of CHECK ASSEMBLY (14) and tighten onto end of SHANK (1a)
- Place SMALL WASHER (16) into end of SPRAY-HOSE (17) and tighten onto end of CHECK ASSEMBLY (14)

### CHECK ASSEMBLY MAINTENANCE

- Disconnect CHECK ASSEMBLY (14) SPRAY-HOSE (17) and SHANK (1a)
- Unscrew UPPER HOUSING (14a), remove both CHECK VALVES (14b) by gently pushing through hole in LOWER HOUSING (14c)
- Rinse both CHECK VALVES (14b) with clean water
- Assemble CHECK VALVES (14b) into LOWER HOUSING (14c) using plumbers grease on orings as needed

**IMPORTANT:** Both CHECK VALVES (13b) must be orientated in LOWER HOUSING (13c) as shown.

- Apply thin film of plumber's grease to HOUSING O-RING (14d) and tighten UPPER HOUSING (14a) onto LOWER HOUSING (14c)
- Attach CHECK ASSEMBLY (14) to MIX HOSE (12)

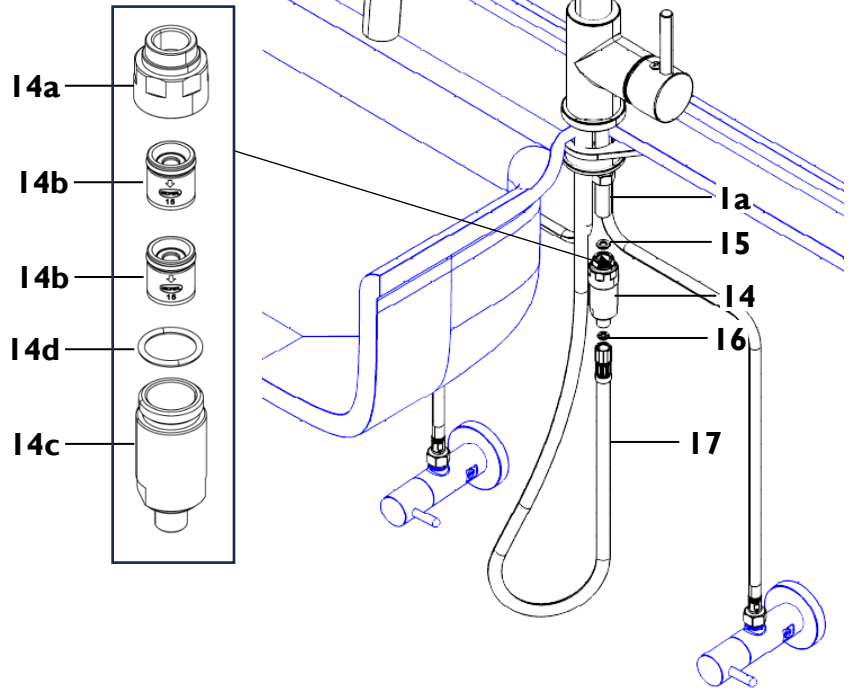

### 4

## ATTACHING WEIGHT

- Separate FEMALE WEIGHT (18a) and MALE WEIGHT (18b) sections by loosening SCREWS (18c)
- Place FEMALE WEIGHT (18a) at lowest straight point on SPRAY-HOSE (17) just above curve of hose

**IMPORTANT:** The placement of WEIGHT (18) shall be at the lowest portion of the SPRAY-HOSE (17).

- Secure MALE WEIGHT (18b) onto SPRAY-HOSE (17) by tightening both SCREWS (18c)

**IMPORTANT:** The area below hose/weight must be clear of all items.

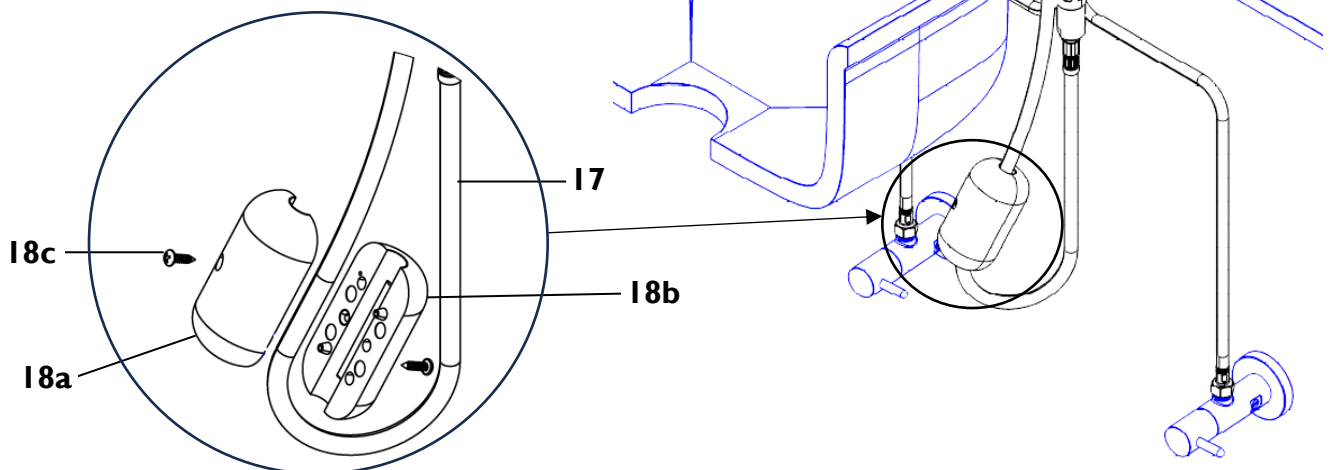

SPRAYHEAD - BUTTON

- Place drain strainer or towel in sink drain to prevent parts from falling down the drain
- Use KEY (19) to remove retaining RING (10a) and SPRAY-FACE (10b)

**IMPORTANT:** Once SPRAY-FACE (10b) is removed **DO NOT** operate water through SPRAYHEAD (10) as internal damage may be done to SPRAYHEAD (10)

- Rinse all parts with clean water to remove debris
- Replace all parts in opposite order as described above

CARTRIDGE

- Turn off **HOT** and **COLD** supply stops
- Remove CAP (12b) SETSCREW (12a) from HANDLE (12)
- Slide HANDLE (12) off CARTRIDGE (20)
- Remove BONNET (21), PACKING NUT (22), and slide CARTRIDGE (20) out
- Rinse CARTRIDGE (20) with clean water to remove debris
- Replace CARTRIDGE (20) and secure with PACKING NUT (22) torqued to 70-90 lb-in

**IMPORTANT:** Over tightening PACKING NUT (22) will cause damage to CARTRIDGE (20). Under tightening PACKING NUT (22) will cause CARTRIDGE (20) to leak.

- Replace remaining parts in opposite order as described above

