



California Faucets®

Libretto™

WALL OR DECK HANDLE TRIM ONLY

TO-E5-W

Features

- Available in 28 finishes including 13 PVD finishes
- All brass construction
- Base diameter 2"
- Use for wall stop, wall diverter, or deck diverter
- Rough valve sold separately (50-W-R, 75-W-R, WDV-R, DDV-R)



Codes/Standards Applicable

Product meets or exceeds the following:

- ASME A112.18.1/CSA B125.1
- ADA compliant

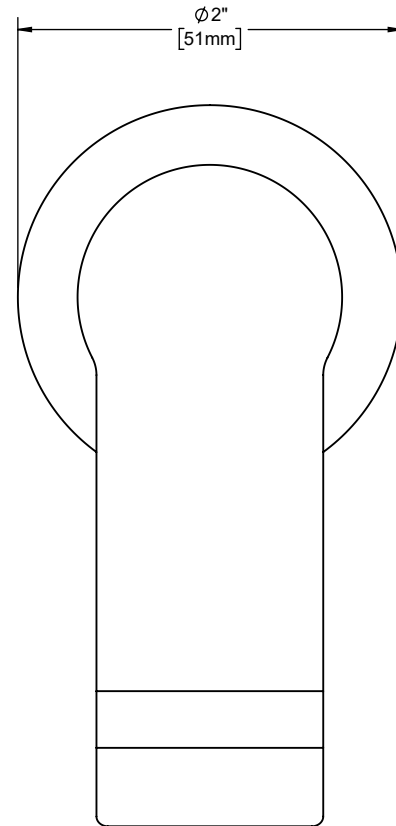
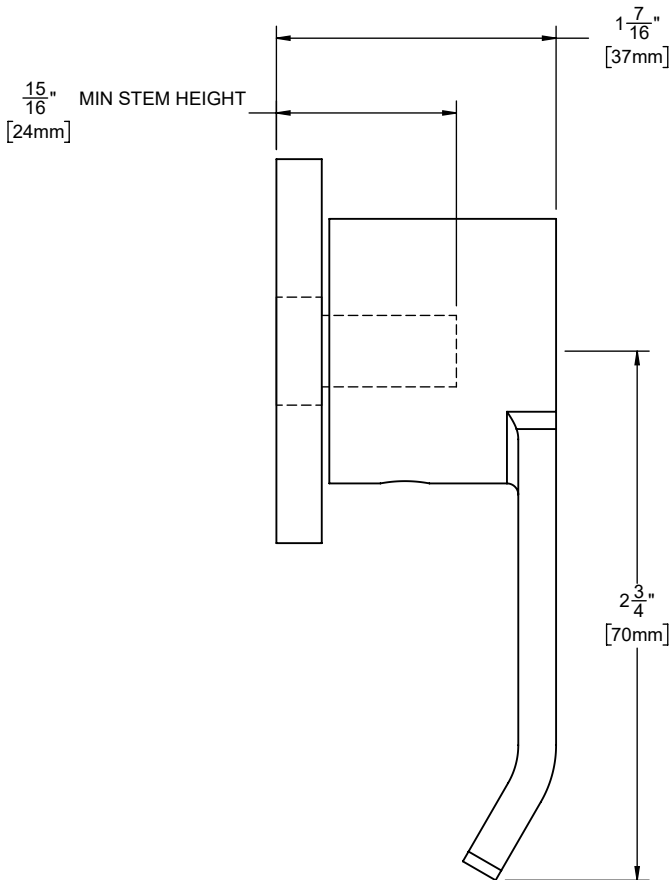

THROUGH-HOLE SPECIFICATIONS		
MIN	RECOMMENDED	MAX
$\text{Ø}11/16$ " [17mm]	$\text{Ø}1-1/4$ " [32mm]	$\text{Ø}1-5/8$ " [41mm]

DIMENSIONS TO NEAREST 1/16"
[DIMENSIONS TO NEAREST 1mm]

SPECIFICATIONS SUBJECT TO CHANGE WITHOUT NOTICE