

5202M
5202MF
5202MK
5302M
5302MF
5302MK

△ REQUIRES ITEM 15

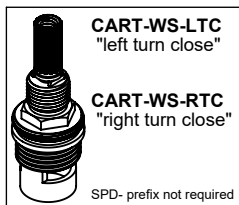
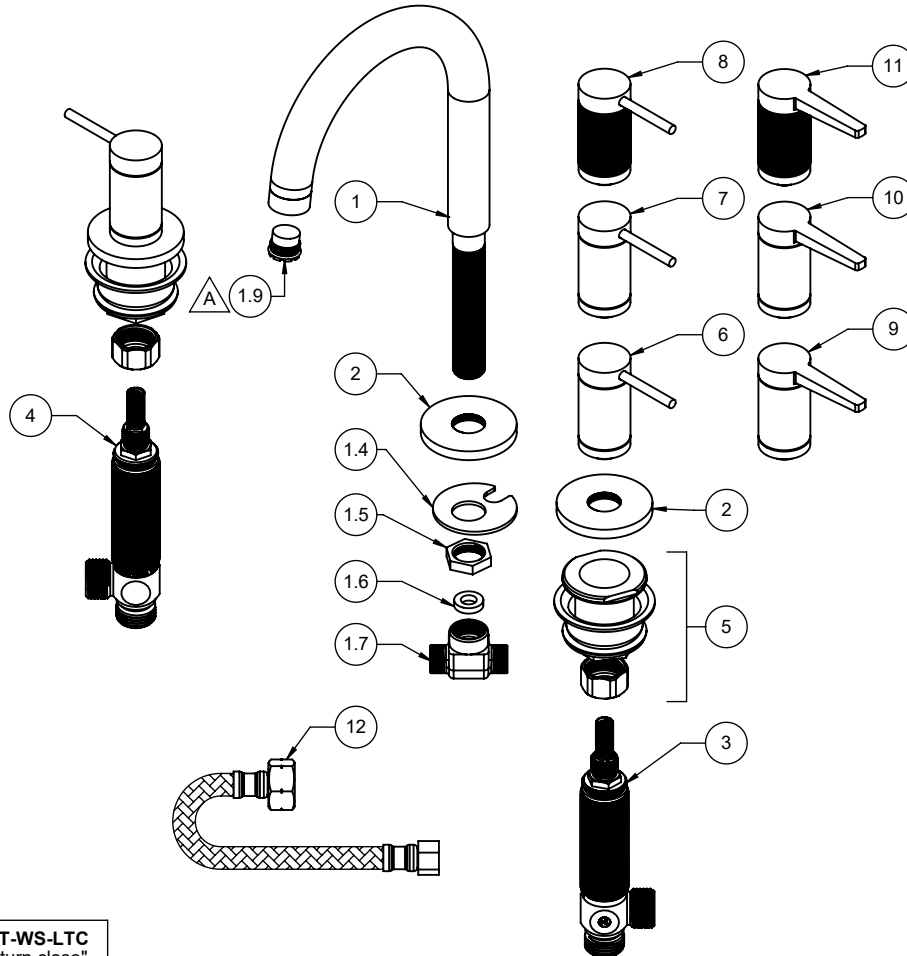

To order spare parts add and/or replace as stated below:

SPD- prefix added to part number(s)
-ZZ replaced with finish code (see finish table)
-WW replaced with **-90** (light finish) or **-96** (dark finish)

Ex: **SPD-7-100463-PC** or **SPD-86030-96**

ITEM	PART NO.	DESCRIPTION	QTY	
1	7-100463-ZZ	ASM, ANGLED LAV SPOUT, SMOOTH <i>(incl. 1.4, 1.5, 1.6, 1.7, 1.9)</i>	1	
1.4	881766-99	WSHR HORSESHOE	1	
1.5	881276-99	NUT, HEX 3/8"-18 NPSM X .20 HT	1	
1.6	87162-80	WSHR Ø8.5 X Ø15.5 X 3.5MM EPDM A70 (NSF-61-12 & WRAS)	1	
1.7	880083-90	TEE, 3-WAY LAV - SS	1	
1.9	880356-81	INSERT, 1.2 GPM, TT LAMINAR (CACHE)	1	
2	11089-ZZ	ESCUTCHEON, RD Ø2" W/ M18 X 1.0	3	
3	6-200087	ASM, COLD-LAV "NL" BODY & CART (.25 Pb)-G4 <i>(incl. CART-WS-LTC)</i>	1	
4	6-200088	ASM, HOT-LAV "NL" BODY & CART (.25 Pb)-G4 <i>(incl. CART-WS-RTC)</i>	1	
5	6-200294	KIT, W/S INV NUT - 2 SETS (1 SET= 6-200294-1)	1	
for 52M Series	6	7-100371-ZZ	ASM, STICK LEV HDL W/SMOOTH CYL	2
for 52MF Series	7	7-100372-ZZ	ASM, STICK LEV HDL W/CARBON FIBER CYL	2
for 52MK Series	8	7-100422-ZZ	ASM, STICK LEV HDL W/KNURLED CYL	2
for 53M Series	9	7-100478-ZZ	ASM, TANG LEV HDL W/SMOOTH CYL	2
for 53MF Series	10	7-100479-ZZ	ASM, TANG LEV HDL W/CARBON FIBER CYL	2
for 53MK Series	11	7-100480-ZZ	ASM, TANG LEV HDL W/KNURLED CYL	2
	12	880099-99	HOSE, POLY BRAIDED, 1/2 IPS X 3/8 CMP X 12 (DN6-SILICONE) (NL, NSF-61-12 & WRAS)	2
	15	223472-99	KEY, TT CACHE AERATOR INSERT	1