

Brondell®

Nebia Shelf

Quick Start Installation Guide

Brondell®

Feels better already.

PO Box 470085
San Francisco, CA 94147-0085
(888) 542-3355
brondell.com

021723



For Help Center support,
scan QR code or enter URL.

<https://www.brondell.com/ebgfxhkh>

LIMITED ONE YEAR WARRANTY

One (1) Year Limited Warranty: Brondell warrants this product to be free from manufacturing defects under normal use and service for a period of one (1) year from date of purchase. Save receipt as proof of purchase is required for warranty support. Brondell's obligations under this warranty are limited to repairs or replacement, at Brondell's option, of products or parts found to be defective, provided that such products were properly installed and used in accordance with instructions. Brondell reserves the right to make such inspections as may be necessary in order to determine the cause of the defect. Some States do not allow limitations, so the above limitation and exclusion may not apply to you.

Do not use cleaner containing abrasive materials, ammonia, bleach, acids, waxes, alcohol, solvents or other products that can damage the product. This will void the warranty.

Included parts:

- Nebia Shelf (with preinstalled tape liners)
- Alcohol wipes (3)
- Glue tube

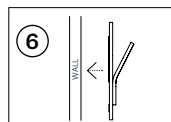
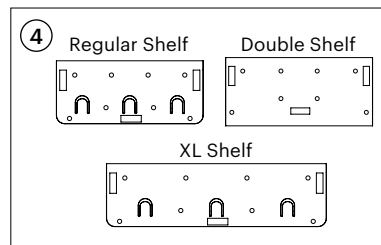
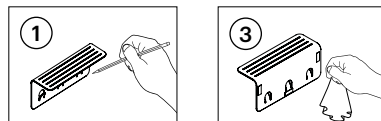

Installation:

1. Decide where to mount your Nebia Shelf. Use a pencil and a level to mark the location of your shelf.

TIP: Avoid mounting your shelf in the direct line of spray of your shower.

2. With the alcohol wipe, clean the wall surface inside the trace mark and let the surface dry for 1 minute.
 3. Clean the rear of the shelf with an alcohol wipe and let it dry.
 4. Unscrew the cap of the glue tube and puncture the foil seal with the cap. Apply 8 small dots to the rear of the shelf in the approximate locations shown in the diagram.
 5. Peel off the protective liners on all 3 pieces of double-sided tape on the rear side of the shelf.
 6. Mount the shelf to your wall. Press the shelf firmly against the wall for 1 minute.
- TIP:** Use a level to ensure correct orientation. You can also use the level feature on your smartphone.
7. Let the adhesive cure for 24 hours. Do not load the shelf and avoid wetting the adhesive during this time. After 24 hours, the shelf is ready to use and can hold up to 10 lbs (4.5 kgs).