



Sink Specifications

Color	SKU
Satin Finish	443147

Design and Planning Tips

- Min cabinet size: 28 in
- Bowl depth: 9 in (229.0 mm)

What is included:
Installation instructions
Cut-out template
Limited Lifetime Warranty

Codes/Compliance: ASME A112.19.3-2017/CSA B45.4-17
Drain hole compatible with 3.5" strainers or waste flanges
Depending on cabinet construction, a different cabinet size may be required.
Cubed weight: 77 lbs.
Nested SKU: 203958

Optional Accessories

Sink clips	212594
Sink Grid	203999
Colander	224387
Glass Cutting Board	224390
Ash Compound Cutting Board	231609
CapFlow Strainer Cover	517666
Elevated Grid	231608

QUATRUS R15 28 Stainless steel Satin Finish

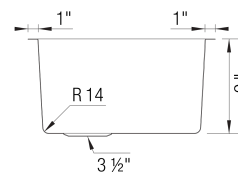
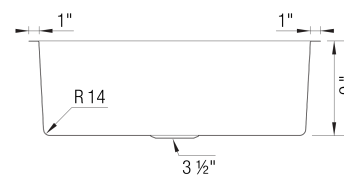
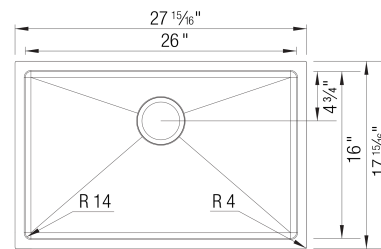

Warranty

BLANCO offers a limited lifetime warranty on all sinks and faucets, as well as a one-year warranty on all custom accessories.

Code/Standards Compliance

BLANCO sinks and faucets are third-party tested and certified to standards and listed by applicable certification bodies. For more information on individual product listings, contact our office or listing organization.



View our how-to videos to learn more about installing and caring for BLANCO products:
<https://www.blanco.com/us-en/service/how-to-videos/how-to-videos-for-sinks/>

Questions? Contact us today



BLANCO America, Inc.
110 Mount Holly By-Pass
Lumberton, NJ 08048

Phone & Fax
Phone: 888-668-6201
Fax: 609-668-6211

While BLANCO endeavors to provide accurate information, all dimensions are nominal, cannot be guaranteed, and are subject to change or cancellation. BLANCO assumes no responsibility for use of superseded or voided specifications.