

Operating Instruction Manual

Everclean A7

- Carefully read this operating instruction manual for proper use of this appliance.
- This operating instruction manual includes product warranty.
- This product is for domestic use only.
- If you have any questions, please call us.
- This item cannot be returned or exchanged once opened and installed.

[This product is exclusively for AC120V.
Please check prior to making any installation.]

**THIS UNIT WAS MANUFACTURED FOR HOUSEHOLD USE ONLY.
READ ALL OPERATING INSTRUCTIONS BEFORE INSTALLATION.**

Notes

- 1. This product should be installed according to this manual.*
- 2. Please read this manual carefully and install properly.*
- 3. Please save this manual and place in an easily accesible location.*
- 4. Do not attempt to service this appliance yourself. Doing so could void the warranty.*

Table of Contents

PREPARATION

1. IMPORTANT SAFEGUARDS	1
2. CAUTIONS BEFORE INSTALLATION	2
3. IDENTIFICATION	3
4. SAFETY INFORMATION (DANGER)	4
5. SAFETY INFORMATION (WARNING)	5

INSTALLATION

6. HOW TO INSTALL	6
-------------------	---

HOW TO USE

7. HOW TO USE	8
8. HOW TO CLEAN	10
9. MAINTENANCE	11

ETC

10. BEFORE CALLING FOR SERVICE	12
11. SPECIFICATIONS	12
12. WARRANTY	14

1. Important Safeguards

1. READ ALL INSTRUCTIONS BEFORE USING

DANGER - To reduce the risk of electric shock:

1. Do not place or store this appliance in a location where it can fall or be pulled into a tub or sink.
2. Do not place in, or drop into water or other liquids.
3. Do not touch a product that has fallen into water. Unplug immediately.

WARNING - To reduce the risk of burns, electric shock, fire or injury.

1. Close supervision is necessary when this appliance is used by or is near infants, elders, or handicapped persons. Children should not be permitted to use or touch this appliance without adult supervision. Be sure to adjust the toilet seat's temperature for elders, handicapped persons, or people with sensitive skin.
2. Use this appliance only for its intended purpose as described in this manual. Do not use attachments not recommended by the manufacturer.
3. Do not operate this appliance if the cord is damaged or if the product is dropped into water.
4. Install the unit properly by following the installation procedure.
5. Only authorized persons can install or repair the unit. Do not attempt to service this appliance by yourself. Doing so could void the warranty.
6. Keep the cord away from heated surfaces.
7. Never drop or insert any objects into any opening or hose.
8. Do not use outdoors. Do not use aerosol or oxygen spray products on the unit.
9. Always follow the grounding instructions in this manual before plugging in the unit.

SAVE THESE INSTRUCTIONS

2. Cautions before installation

1. NOTE THE FOLLOWING IMPORTANT POINTS

1. Do not install in a location where water might be splashed on this appliance or in a location exposed to excessive moisture where condensation might form on the product's surface.
2. To avoid damage to electronic components due to high levels of humidity, provide adequate ventilation by opening a window and/or door when bathing.
3. Water supply should have a water pressure of 11.38 psi to 106.68 psi.
4. Connect the product to a pipe carrying potable water. Do not connect to an industrial water line or other water supplies that are not potable.
5. Cool the unit in the room before installation.
6. The thermal protector in the water tank may malfunction when transporting or storing warm water.
7. The rated power voltage is 120V AC, 60Hz.
8. Do not plug the unit in until installation is complete. It may result in malfunction.

2. Cautions before installation

2. WIRING REQUIREMENTS

1. Any other servicing should be performed by authorized service representatives.

2. GROUNDING INSTRUCTIONS

This product should be grounded. In the event of an electrical short circuit, grounding reduces the risk of electric shock by providing an escape wire for the electric current. This product is equipped with a cord having a grounding wire with a grounding plug. The plug must be plugged into an outlet that is properly installed and grounded.

DANGER-Improper use of the grounding plug can result in a risk of electric shock.

Do not connect the grounding wire to a flat blade terminal. The grounding wire can be identified by its insulated outer surface. It will either be colored green or will not contain yellow stripes.

Check with a qualified electrician or serviceman if you do not understand grounding instructions or if you do not know whether the product is properly grounded.

3. This product is for use on a nominal 120V circuit. It has a grounding plug that looks like the plug illustrated in sketch A. A temporary adapter, which looks like the adapter illustrated in sketches B and C, may be used to connect this plug to a 2-pole receptacle as shown in sketch B if a properly grounded outlet is no available. The temporary adapter should be used only until the properly grounded outlet (sketch A) can be installed by a qualified electrician. The green colored rigid ear, lug and the like extending from the adapter must be connected to a permanent ground such as a properly grounded outlet box cover. Whenever the adapter is used, it must be held in place by the screw.

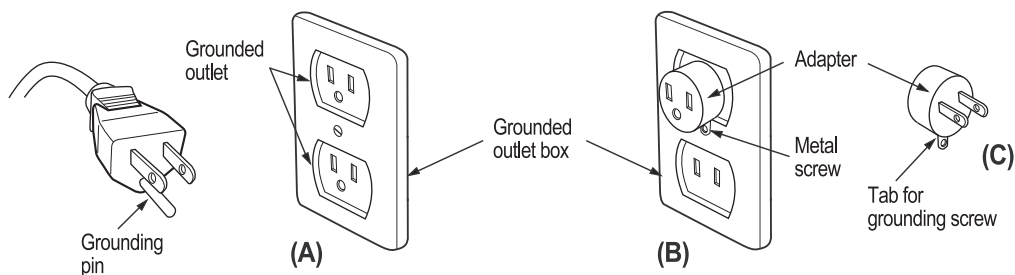

4. If it is necessary to use an extension cord, use only a three prong wire extension cord that has a three-blade grounding plug, and a three-slot receptacle that will accept the plug on the product. Replace or repair a damaged cord.

CAUTION

**RISK OF EXPLOSION TO BATTERY IF REPLACED BY AN INCORRECT TYPE.
DISPOSE OF USED BATTERIES ACCORDING TO THE INSTRUCTIONS.**

3. Identification

Main unit

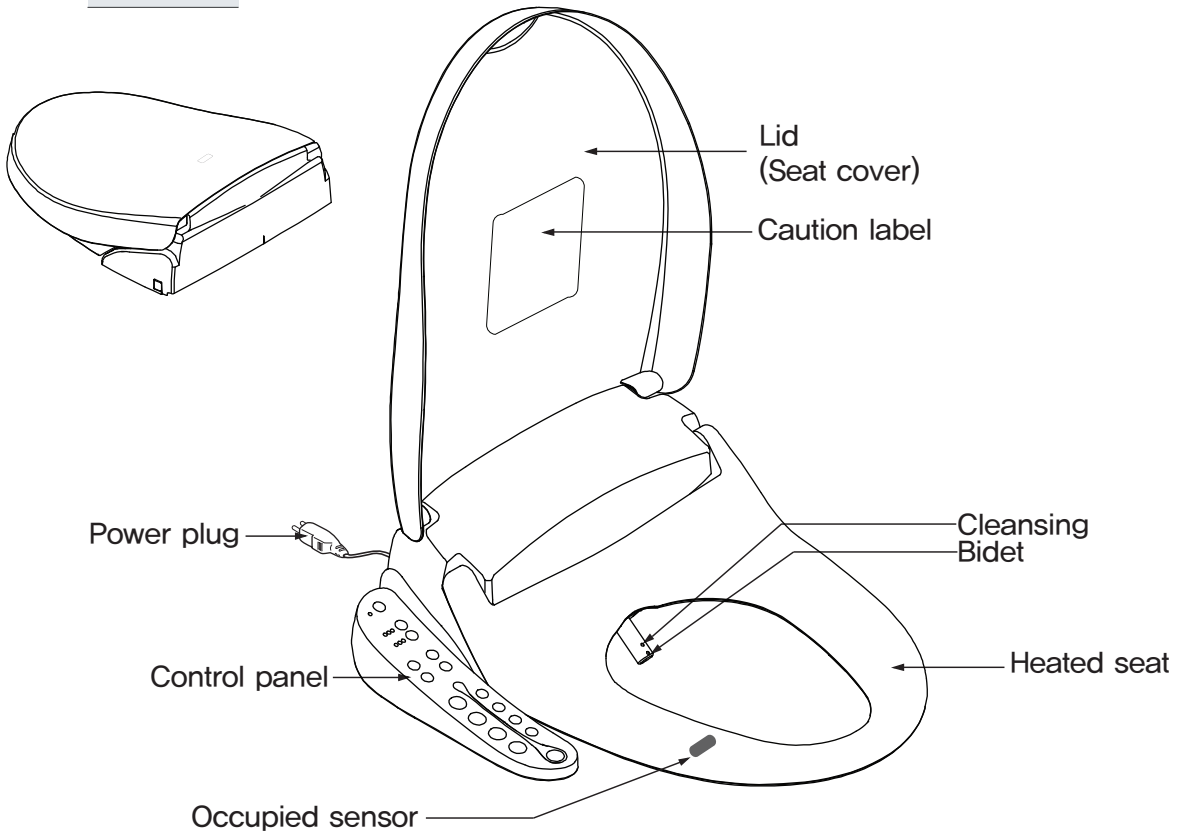

Accessories

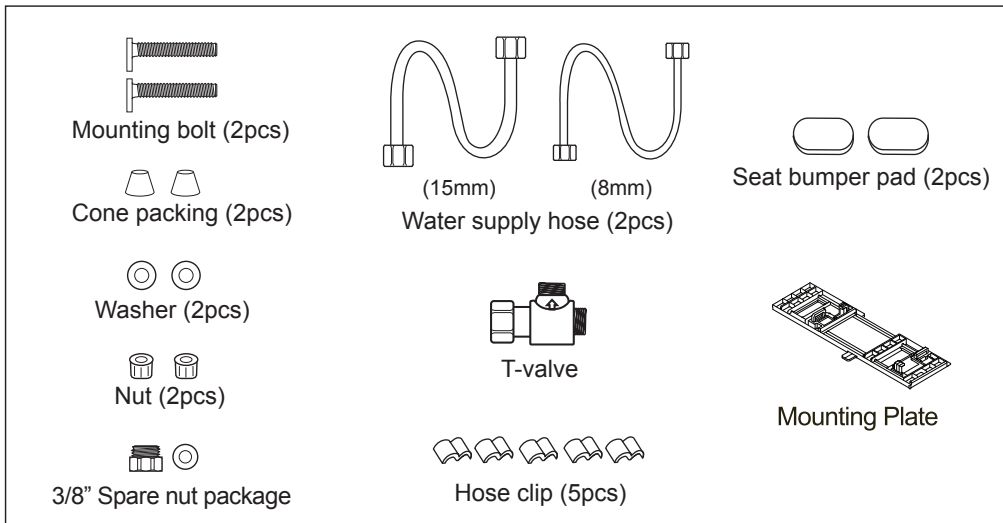

※ In the interest of continued product improvement, specifications may change without notice.











4. Safety Information (Danger)

Follow basic instructions to ensure the safe use of your appliance.

DANGER

Failure to follow may cause severe injury or death. Follow the instructions.

 Indicates a [prohibited] use of the appliance.	 Prohibited  Do not disassemble  Use of fire prohibited  Do not handle with wet hands
 Indicates a [required] step in use of this appliance.	 Required step  Ground Connection

-  Do not splash water or cleansers on the product's plug. Doing so may result in fire or electric shock.
-  Do not plug or unplug with wet hands.
-It may result in injury or electric shock.
-Regularly wipe off the plug and electric outlet with a dry, soft cloth to prevent electric shock or fire.
-  Do not use a faulty or loose electric outlet or cord.
-Doing so may result in short circuit, electric shock or fire.
-  Do not throw anything flammable into the toilet.
-Doing so may result in fire, discoloration or malfunction.
-  Grounded wire or outlet must be installed.
-Not doing so may result in malfunction or electric shock.
-If no grounded plug is used, make sure to install grounded wire.
-  Do not use many appliances in one power strip.
-Doing so may result in fire or damage.
-Be sure to use a dry and clean outlet.
-Do not use a faulty or loose outlet.
-  Use potable water only. (ground water)
-Not doing so may cause irritation or injury to your skin.
-It may clog the pipe due to contaminants.
-  Do not disassemble the seat.
-Doing so may result in electric shock.
-  Do not disassemble, repair or modify this appliance.
-Doing so may result in electric shock, injury or malfunction.
-  Unplug when you hear beeping or smell strange odor.
-Unplug right away and contact your dealer from whom you bought this appliance.













5. Safety Information (Warning)

Follow basic instructions to ensure the safe use of your appliance.

WARNING

Might cause slight injury or damage. Be aware.

 Indicates a [prohibited] use of the appliance.	 Prohibited  Do not disassemble  Use of fire prohibited  Do not handle with wet hands
 Indicates a [required] step in use of this appliance.	 Required step  Ground Connection

-  Be aware of a low-grade burn.
 - It may result in a low-grade burn if sitting on the heated seat for a long time.
 - Be aware if being used by the following: children, senior citizens, patients, people who cannot control the temperature, people who are not sober, or people who are tired.
 - If injured in a low-grade burn, see a doctor immediately.
-  Do not step on or place heavy objects on this appliance.
 - Doing so may damage the unit.
 - Do not step on a lid, seat, or control panel to avoid injury or product damage.
-  Unplug while not using over extended period of time.
-  Unplug when there is thunder or lightening.
-  Use this appliance on a toilet only.
 - Not doing so may result in fire, injury or electric shock.
-  Do not use force to pull out the water hose.
 - Doing so may cause water leakage.
-  Be aware of urine splash on a nozzle or warm air dryer outlet.
 - Not doing so may result in malodor or failure.
-  Do not use force to close the lid.
 - Doing so may cause malfunction.
 - Be aware not to put fingers between the lid and seat when you close the toilet. It may cause injury.
-  Unplug when cleaning.
 - Not doing so may result in fire or electric shock.
-  Use low temperature for children and handicapped.
 - If the temperature is too high, it may result in burn if they fail to recognize the temperature.
-  Do not sit or lean against the lid or the control panel.
 - Doing so may cause malfunction or breakage.
 - Applying excessive force may damage the lid or components that may lead to injury.
-  Do not put a vase cup or small materials on this appliance.
 - Doing so may result in fire or electric shock.

6. How to install

※ **If electric work is needed, please contact a qualified electrician or serviceman only.**

Remove the existing toilet lid and seat

1. Remove the nuts, washers, and cone packings from the toilet seat and mounting bolts in the back of the toilet.
2. Remove the toilet seat, lid and mounting bolts.
3. Keep them in case you need them.

Balance Pads

Depending on your toilet model, the toilet bowl may not be even and there could be a small gap on the front side of the bidet seat and the toilet bowl. Two (2) white adhesive pads supplied with your installation kit to be used to balance seat. Affix adhesive pad to seat bumper located on the underside of the bidet seat to balance the seat with toilet bowl.

Install the appliance

Installation

How to mount the plate

- 1 Place the mounting plate over each mounting hole. Insert the mounting bolts through the plate and mounting holes. Slide cone packings and washers onto the bolts and fasten tightly with nuts.

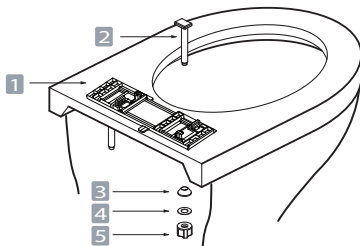

- | | |
|------------------|-----------------|
| 1 Mounting plate | 2 Mounting bolt |
| 3 Cone packing | 4 Washer |
| 5 Nut | |

How to attach and detach the unit

- 1 While pressing the detach button, slide the unit until it clicks into the plate.

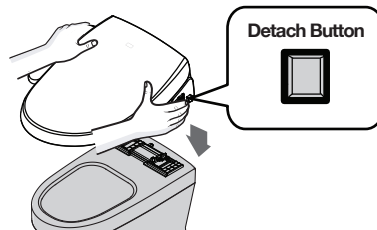

- 2 While pressing the detach button, pull the unit forward and separate it from the toilet bowl.

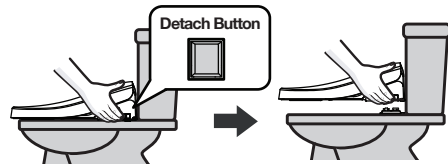

Toilet size (Elongated & Round front)

- 1 The toilet dimensions must be within those shown below. Do not install this appliance on a toilet that does not meet these dimensional requirements.

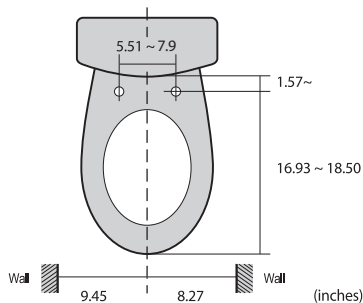

Occupied sensor

- 1 This appliance is equipped with an occupied sensor.
- 2 The unit will not work unless the seat is occupied.

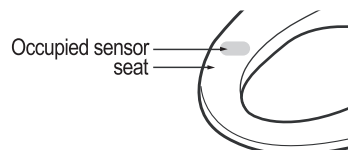

Connecting the water hose

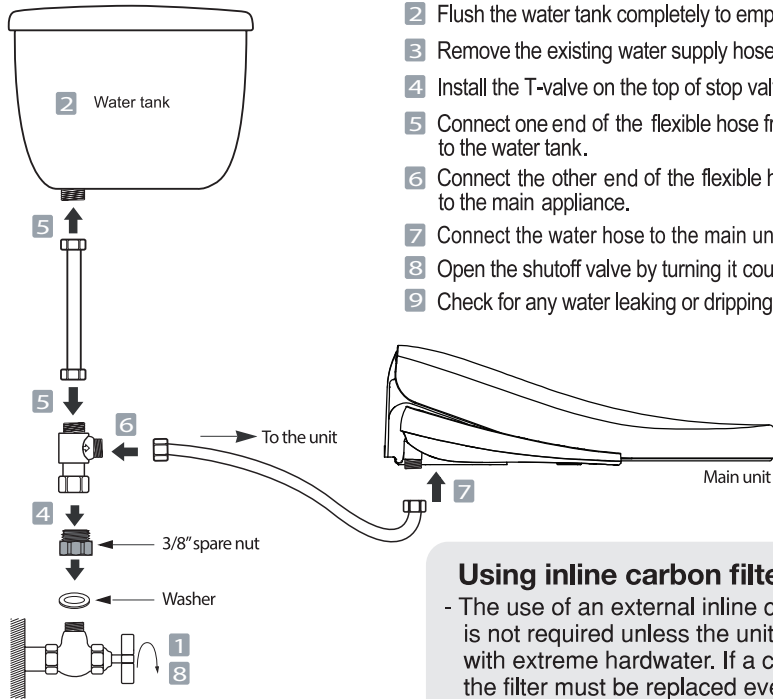

- 1 Close the shutoff valve by turning it clockwise.
- 2 Flush the water tank completely to empty.
- 3 Remove the existing water supply hose from the tank.
- 4 Install the T-valve on the top of stop valve.
- 5 Connect one end of the flexible hose from the T-valve to the water tank.
- 6 Connect the other end of the flexible hose from the T-valve to the main appliance.
- 7 Connect the water hose to the main unit.
- 8 Open the shutoff valve by turning it counter clockwise.
- 9 Check for any water leaking or dripping.

Using inline carbon filter

- The use of an external inline carbon water filter is not required unless the unit is used in an area with extreme hardwater. If a carbon filter is used, the filter must be replaced every 6 months. Inline carbon filters can be purchased from any authorized Bio Bidet reseller.

※ Shutoff valve sizes may vary. If supplied parts do not fit, please call 847-458-2334.

Trial operation

1. Preparation

Plug the power cord into the outlet, and then the water tank will be filled with water in 2 minutes.

2. Checking all functions

Cover the toilet bowl using the sheet of plastic wrap on the unit to prevent the washing water from being sprayed out of the toilet.

Then check for all function described in this manual.

3. There are possibilities of water coming out that remains in the unit while heating.

7. How to use

※ Caution

- All functions will be operational when the seat is occupied except Nozzle Cleaning.
- Before operating, ensure that water tank is filled up completely.

Stop

- Press "Stop" to stop current operation.
- When a user stands up, all operations will stop automatically.
- Press "Stop" for 3 seconds to turn the main unit off.

Cleansing

- Press "Cleansing" to clean your posterior. The function will stop in 60 seconds automatically.
- Press this button again to activate oscillation. The nozzle moves back and forth automatically to widen cleansing area.
- Oscillation wash stops if this button is pressed again.

Bidet

- Press "Bidet" for feminine wash. The function will stop in 60 seconds automatically.
- Press this button again to activate oscillation. The nozzle moves back and forth automatically to widen cleansing area.
- Oscillation wash stops if this button is pressed again.

Auto

- Press "Auto" during the operation of "Cleansing" or "Bidet".
- Cleaning wash, oscillating wash and oscillating with massage will operate for each 20 seconds consecutively.
- If Bidet Auto wanted, press "Bidet" and "Auto" consecutively.

Massage

- Press "Massage" to activate rhythmical wash for massage effect when you are using "Cleansing" or "Bidet".
- Press the button again to release this function.

User setting

- Press "USER 1" or "USER 2" while using "Cleansing" or "Bidet."
- The current water pressure level and nozzle position will be saved with a buzzer (beep beep).
- Press "USER 1" or "USER 2" button during the operation of "Cleansing, Bidet" will operate saved functions.

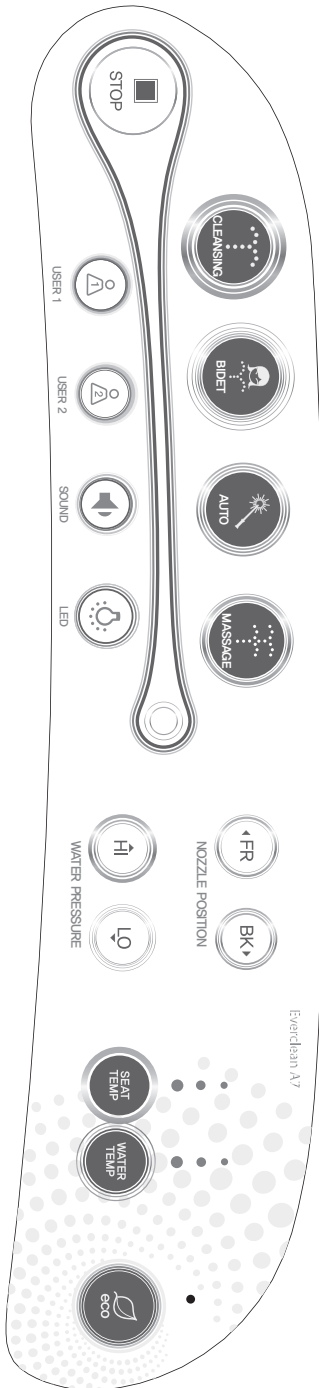

Sound

- Press "Sound" to enable the beeping sound.
- To disable, press the button again.

LED

- Press the button to activate LED light.
- Delicate light will help user to use toilet without turning the light on during night time.

Nozzle position ◀FR / BK▶

- Nozzle position can be adjusted by pressing FR or BK buttons to 5 levels.
- Nozzle position will remain.

Water pressure ⬆️ / ⬆️

- Water spray pressure can be adjusted by pressing HI or LO buttons to 5 levels.
- Water pressure level will remain.

Temperature adjustment (seat / water)

- Temperature of seat and water can be adjusted.
- There are four levels, Room temp-Low-Medium-High.

Eco

- Press "ECO" to activate the power saving mode. Seat and water temperature will be set to low.
- Press "ECO" again to release the function.

8. How to clean

Nozzle cleaning



Do not forcefully push or pull the nozzles, or bend them. It may result in failure.
Make sure to use "Stop" button on the side control panel.

MANUAL CLEANING

- 1 Make sure the occupied sensor is not activated.
(Do not sit on the seat or place hands on the seat sensor)
- 2 Press "Front" (FR) button for 3 seconds to extract the nozzle.
- 3 Use a toothbrush or soft cloth to clean the nozzle.
- 4 Press "Stop" button to retract the nozzle.

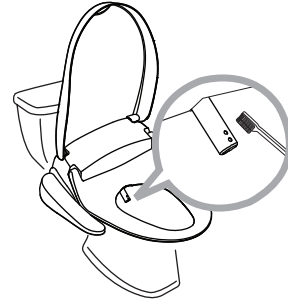

AUTO CLEANING

- 1 Press "Back" (BK) button for 3 seconds to start auto cleaning.
The nozzle will be cleaned and returned automatically.
- 2 Press "Stop" button while cleaning will retract the nozzle.

※ Do not use force to push or pull the nozzles while cleaning.

Strainer maintenance

This appliance will not operate properly if the strainer is clogged.
Be sure to clean the strainer regularly.

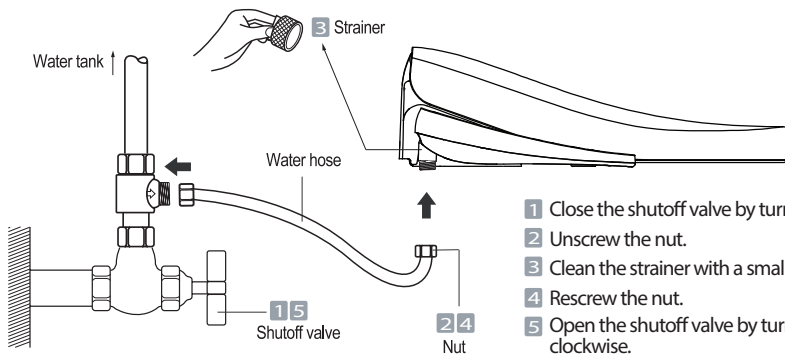

- 1 Close the shutoff valve by turning it clockwise.
- 2 Unscrew the nut.
- 3 Clean the strainer with a small brush.
- 4 Rescrew the nut.
- 5 Open the shutoff valve by turning it counter clockwise.

Cleaning the body

- 1 Regularly wipe off the body with a dry soft cloth or sponge, or wash with dampen cloth with mild detergent.
- 2 Release the lid.
 1. Pull left and up the left hinge part.
 2. Release the right hinge part (Be aware your fingers not to be caught)
- 3 For care of plastic body, do not use any cleansers which are not safe to use on toilet seats.
(toilet cleanser, home cleanser, bleach, benzene, paint thinner, cresol etc.)

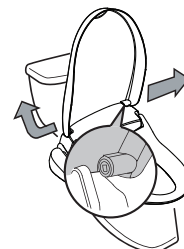

Toilet cleanser



Thinner
Benzene



Bugs killer



Sand paper

9. Maintenance

Draining water - while not using over extended period of time.

- 1 **Unplug the power supply cord.**
■ Not doing so may cause fire.

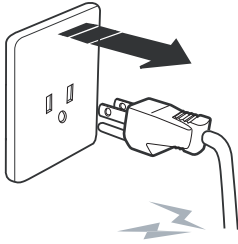

- 2 **Close the shutoff valve.**

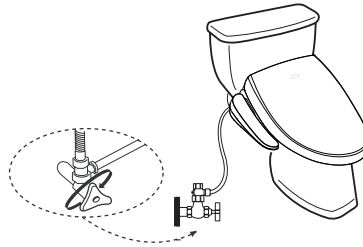

- 3 **Unscrew the mounting bolts.**
■ Refer to the installation method.



- 4 **Uphold the appliance and thoroughly drain the water by unscrewing the drain bolt.**
(beware of losing the drain bolt)

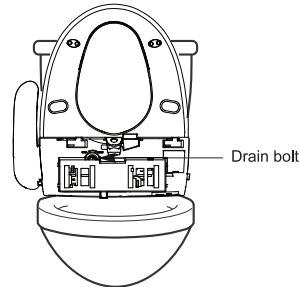

- 5 **Screw the drain bolt and install the appliance.**
■ Refer to the trial operation method in order to use this appliance again.

Preventing freezing

- 1 **Make sure the power cord is plugged in properly.**

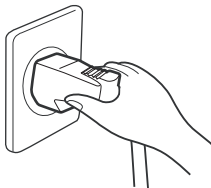

- 2 **Set the temperature of water to low or middle.**
(Freezing can be prevented by thermal efficiency of water tank.)

■ If there is no heating system in the toilet, wrap pipes with cloth or other materials.

- 3 **Not using the unit for a long time in winter unplug and drain the water from the water tank and pipes thoroughly.**

■ Refer to the water drain method.

10. Before calling for service

Problem	Possible cause	Solution
Completely fails to work	Is there a power cord outage? Is the power cord unplugged? Are you sitting on the seat correctly?	- Check for power cord failure or a tripped breaker - Plug the power cord in properly - Sit on the seat completely
Water does not spray	Is the water shutoff valve closed? Is the strainer clogged? Are the nozzles clogged? Is the water purifying filter clogged?	- Check for any water leaking or dripping - Clean the strainer - Clean the nozzles - Change the water purifying filter
Water is leaking or dripping	Are all hoses tightened up properly?	- If water is still leaking or dripping, contact to your dealer
Seat, water or air is not warm enough	Is the temperature set to OFF? Is appliance used in economy mode during cold weather?	- Reset the temperature - Release the economy function

11. Specifications

Item	Everclean A7	
Standard power supply	AC 120V 60Hz 1248W	
Water supply	Way of connection	Direct connection to tap water
	Water pressure	0.07MPa ~ 0.74MPa
Clean-sing	Spray for cleansing	700 (±150)mℓ/min
	Spray for bidet	700 (±150)mℓ/min
	Water capacity	740mℓ
	Spray temperature	Room temp ~ 39°C(102.2°F)
	Heater capacity	1200W
	Safety feature	Thermal switch, Temperature fuse, Floating switch
Heated seat	Seat temperature	Room temp ~ 39°C(102.2°F)
	Heater capacity	48W
	Safety feature	Temperature fuse
Deodorization method	-	
Circuit breaker	Within 15mA 0.03 second	
Length of power cord	1.5m	
Dimensions	(W)481 mm(18.94 inches) X (L)528 mm(20.79 inches) X (H)160 mm(6.30 inches)	
Weight	4.6Kg(10.14lbs)	

※ Recommended water supply pressure are 0.07MPa~0.74MPa

※ The minimum available water supply pressure is 0.07MPa, however under 0.1MPa pressure, water spray pressure might not be enough strong.

MEMO

WARRANTY

USPA Personal Hygiene Appliance Limited Warranty

- We warrant our products to be free from manufacturing defects under normal use and service for a period of one (1) year from the date of your purchase.
100% Coverage of all parts and labor for the entire product for the first year from original date of purchase.
This warranty is only valid within the United States and Canada.

 - Our obligation to you under this warranty is limited to repair or replacement, at our option, of defective products or parts, provided that the products were properly installed and used in accordance with instructions. We reserve the right to make inspections in order to determine the cause of the defect. We will not charge for labor or parts in connection with warranty repairs or replacement. We are not responsible for the cost of removal, return and/or reinstallation of products.

 - This limited warranty does not apply to:
 - a) Damage or loss from a fire, earthquake, flood, storm, etc.
 - b) Damage or loss resulting from any unreasonable use, abuse, negligence, or improper maintenance.
 - c) Damage or loss from improper installation, removal, repair, or modification.
 - d) Damage or loss resulting from sediment or other matters contained in your water system.

 - This warranty gives you specific legal rights.

 - For warranty or service information, please contact your dealer where you bought this appliance or us.

 - Only the original purchaser may submit a claim under this limited warranty. To activate your warranty, complete this form.

 - This limited warranty is our only warranty covering your product. Repair or replacement as provided under this warranty shall be the exclusive remedy available to you. We shall not be responsible for loss of the product or for other incidental, or consequential damage or expenses you may incur or for labor or other costs due to installation or removal, or cost of repairs by others, or for any other expense not specifically stated above. Except to the extent prohibited by applicable law, any implied warranties, including that of merchantability or fitness for use, are expressly limited to the duration of this warranty.
- ※ Warning! We are not responsible or liable for any failure of, or damage to, this plumbing product or product component caused by in-tank bowl cleaners containing chlorine (calcium hypochlorite).
- ※ Note : The use of high concentration of chlorine related products can seriously damage the fittings. This damage can cause leakage and serious property damage.
- For more information, please contact your dealer or us.

Mail, email or fax the warranty form to :

BBC INNOVATION

204 Berg St., Algonquin, IL 60102

Phone : 877_339_5214 Fax: 847_854_1296

E-mail : support@biobidet.com <http://www.biobidet.com>

SAMHONGTECH CO., LTD.

2F, Eunsung Building, 741, Yeongdong-daero, Gangnam-gu, Seoul, Korea

TEL: 82-2-3449-2341 FAX: 82-2-3445-1686

E-MAIL : info@isdongseo.co.kr <http://www.samhongtech.com>

Great products for your healthy living !

If you need any help,
Please call us.

CUSTOMER CENTER
847-458-2334

BBC INNOVATION
204 Berg St., Algonquin, IL 60102