

bioBidet®
by **BEMIS**

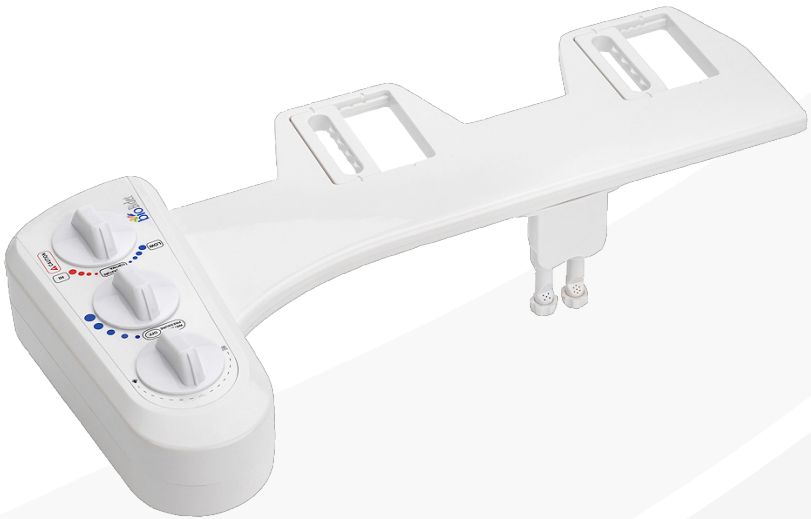

BB-270
User Manual

TABLE OF CONTENTS

PRODUCT INFORMATION

Features.....	5
Parts.....	7
Dimensions.....	8

PRODUCT INSTALLATION

Pre-Installation.....	9
Installation.....	10

PRODUCT OPERATION

How To Use.....	15
-----------------	----

MAINTENANCE

Cleaning.....	16
Short Term Non-Use.....	17
Warranty.....	18

FEATURES

- High-quality ABS material with full body panel
- Premium quality metal inlet and installation parts
- Continuous warm water
- Self clean
- Cold water bypass
- P.S.P.C technology
- Splash guarded nozzle
- Ambient temperature bidet wash
- Adjustable water pressure
- Unified internal brass valve
- Durable braided metal cold water hose
- No electricity or batteries required
- Adjustable toilet fit
- One-year warranty

PARTS

Bidet attachment

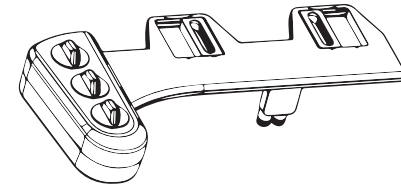

*2 T-Valves
3/8" - Hot
7/8" - Cold

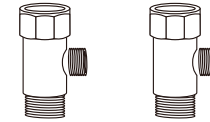

2 Protective O-rings

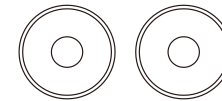

25.5" Braided metal hose



78.7" Hot water hose

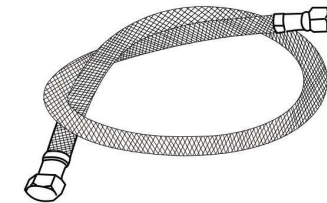

2 White washers



3 Toilet bumpers



*Alternate fittings available, contact support@biobidet.com

DIMENSIONS

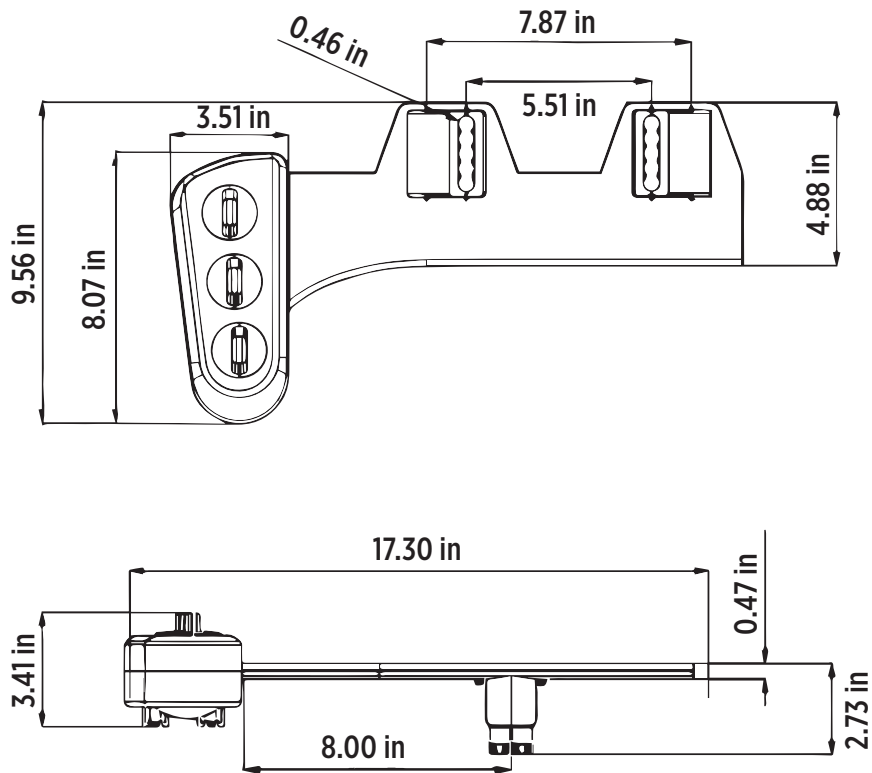

PRE-INSTALLATION

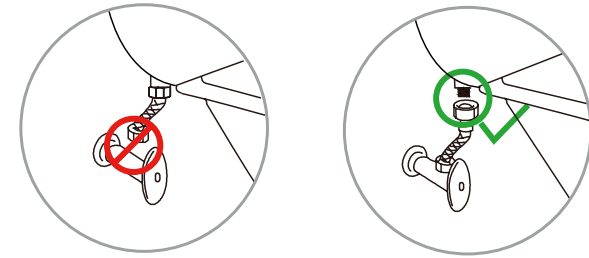

Please be advised that the provided T-Valve should be installed at the fill valve under the toilet tank, NOT down at the water supply coming from the wall.

Inspect your current water supply line that connects to the toilet tank fill valve to ensure it is a flexible water supply hose before installing the BB-270. The hose needs to be 7/8" (to connect to the T-Valve we provided) on one end and either 3/8" or 1/2", depending on your wall valve, on the other end.

If you do not have access to the fill valve under the toilet tank, contact Bio Bidet Customer Service at 847.458.2334 and we may be able to provide alternative fittings.

WARNING: Use care to avoid cross threading or over tightening the connection. Over tightening can cause leaking.

NOTICE: Observe all local plumbing, electrical and building codes. This device is designed for connection to a cold water source with a pressure of 20-80 psi.

INSTALLATION



1. Remove the existing toilet seat by locating the bolts and nuts, typically under a plastic cover, and removing them first.

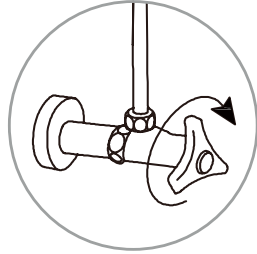

2. Close the water supply valve and flush the toilet completely so that there is little to no water left in the toilet tank.

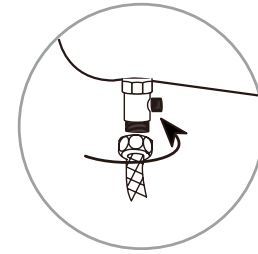

5. Attach the water supply hose that comes from the water shut off to the bottom of the T-Valve.

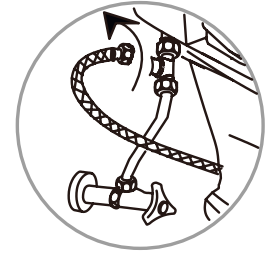

6. Connect the 25.5" metal hose we supplied to the open side of the T-Valve.



3. Disconnect the water hose from underneath the toilet tank.

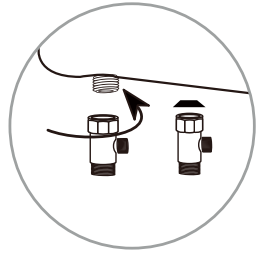

4. Connect the 7/8" T-Valve to the toilet fill valve where you just removed the water hose from.

Make sure the rubber washer is properly seated with the narrow side up.

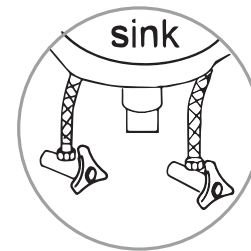

7. To install the hot water line, close the water supply valves underneath your sink.

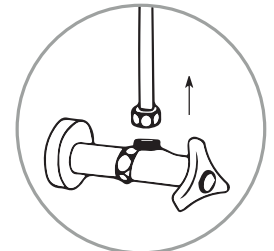

8. Disconnect the water hose from your sink's hot water supply valve.

INSTALLATION (CONT.)

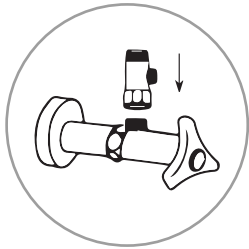

9. Connect the 3/8" T-valve to the hot water supply valve where you just removed your water hose. Make sure the runner washer is included into the connection.

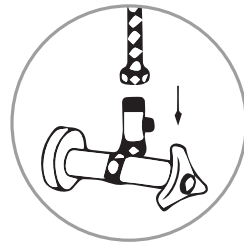

10. Attach the water supply hose that comes from the water shut off to the top of the T-valve.

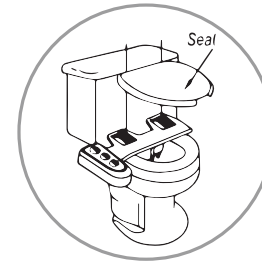

13. Place the toilet seat back on the toilet over the bidet and secure the bolts down so that the seat and bidet attachment are stable.

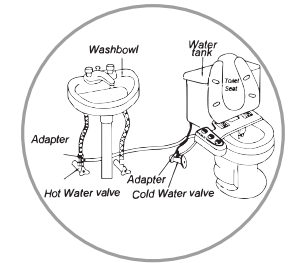

14. Connect the hoses from step 6 & 10 to the corresponding hot and cold bidet water connections underneath the handle of the BB-270.

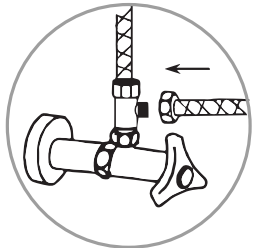

11. Connect the 78.7" metal hose we supplied to the open side of the T-valve.

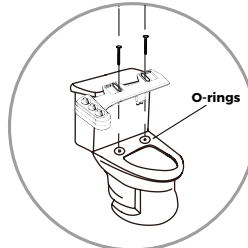

12. Place the bidet on the toilet with the mounting brackets over the bolt holes. Center the bidet on the toilet so that you can see the bolt holes through the mounting brackets of the bidet. Place the Protective O-rings under the mounting bracket to protect and secure the bidet on the toilet.

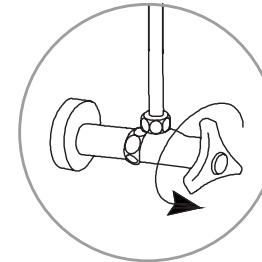

15. Slowly turn the water supply valve back on and check for leaks and test the unit for functionality.



16. After installing your bidet attachment, check to see if there is a gap between the toilet base and toilet seat.

INSTALLATION (CONT.)

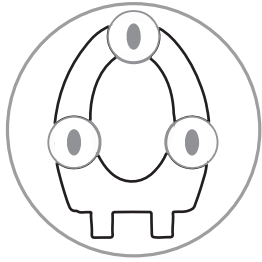



17. If necessary, place the bumpers on the underside of your toilet seat as indicated above.

HOW TO USE

Water can spray when no one is sitting on the seat. Do not activate the water until seated.

For feminine cleaning, turn the function selection knob to the right towards the “” position.

For self cleaning function, turn the function selection knob to the left towards the “” position.

For rear wash function, turn the function selection knob to the middle towards the “” position.

Adjust the water pressure control knob, choose the comfortable pressure you want. The water pressure control knob doesn't reset automatically, please turn it off manually.

Adjust the water temperature control knob and choose the comfortable temperature you want.

If there are no immediate leaks, check again in about 5-10 minutes and your BB-270 is ready for use!

If any leaks occur, check all rubber washers and make sure all connections are tight and secure.

CAUTION: Do not turn to the highest temperature at once to prevent being burned by hot water.

CLEANING

Your BB-270 is made with a high grade fire-retardant ABS resin. Using hard cleaning chemicals can weaken the material, causing it to damage and develop cracks.

1. Clean the BB-270 by wiping the surface area with a damp cloth regularly.
2. Do not use harsh detergents or any cleaning tools with bristles on your bidet.

Steam cleaning is the preferred cleaning method for your bidet. For a deep, chemical free clean, consider the BioMist Bidet Cleaner.

SHORT TERM NON-USE

If the product will not be used for more than a few days, it is highly recommended that the water supply valve is turned off.

WARRANTY

Your Bio Bidet is warranted against defects in materials or workmanship for (1) year from the date of original purchase. Defective parts or a defective products returned to Bio Bidet will be repaired with new or comparable rebuilt parts or exchanged for a refurbished Bio Bidet as determined by Bio Bidet in their sole discretion.

This limited warranty given by Bio Bidet covers all defects encountered in normal use of Bio Bidet, and do not apply in the following cases:

1. Loss of or damage to Bio Bidet due to abuse, misuse, tampering, Mishandling, improper packaging by you, alteration or fail to follow operating instructions.
2. Use of parts or supplies (other than those by Bio Bidet's dealers) that cause damage to Bio Bidet.
3. Replacement of discolored or stained parts caused by chlorine, bleach, ammonia and other chemicals, cleaning supplies, oxidation, normal wear and tear.
4. Damage to or malfunction of the unit as a result of improper and negligent installation.
5. Any and all damages to plumbing, walls, floors, ceiling and personal properties resulting from water leaks or breakage. The product must be used at the user's own risk. Therefore, the owner hereby releases the manufacturer and distributor from any and all claims for damages where the above condition exists.

No implied warranty, including any implied warranty of merchantability or fitness or a particular purpose, applies to BBC Innovation LLC bidet after the applicable period of the express limited warranty stated above, and no other express warranty or guarantee, except as mentioned above, given by any person or entity with respect to Bio Bidet shall bind Bio Bidet, (Some States and provinces do not allow limitations on how long an implied warranty, so the above limitation may not apply to you) BBC Innovation LLC shall not be liable for revenues or profits, inconvenience, expense for substitute equipment or service, or any other special, incidental or consequential damages caused by the use or misuse of, or inability to use, Bio Bidet, regardless of the possibility and foresee-ability of such damages. In no event shall recovery of any kind against BBC Innovation LLC be greater in amount than the purchase price of the product and causing the alleged damage. Without limiting the foregoing, you assume all risk and liability for loss, damage or injury to you and your property and to others and their property arising out of use or misuse of, or inability to use, the Bio Bidet not caused directly by the negligence or BBC Innovation LLC. This limited warranty shall not extend to anyone other than the original purchaser of the Bio Bidet.

Thank You



Technical Support/Customer Service
7900 S Route 31 Crystal Lake, IL 60014
T: 847.458.2334
U.S TOLL FREE: 877.339.5214

support@biobidet.com
www.biobidet.com