

**Installation Manual and
Operating Instructions**
..... BB-1700 & BB-2000

www.biobidet.com

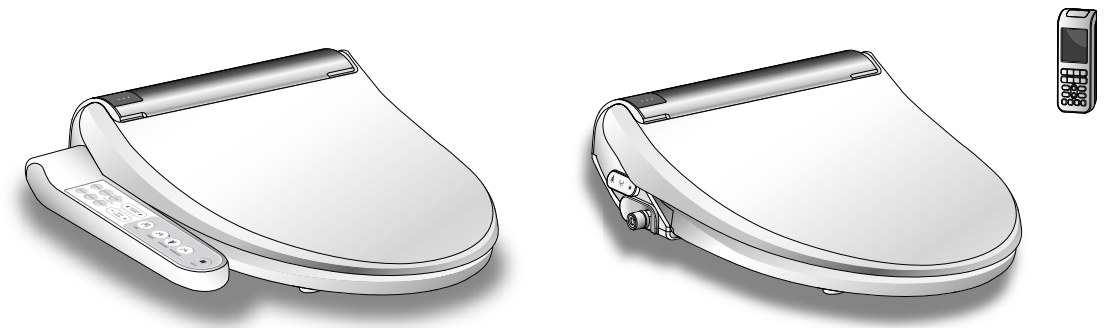

BBC Innovation Corporation

Head office:
205 Berg St.
Algonquin, IL 60102
U.S.A
Tel: (847) 458-2334
Fax: (847) 854-1296

- This product should be installed according to this manual.
- Please read this manual carefully and install properly.
- Please keep this manual for future reference.
- Please register warranty for proper service.



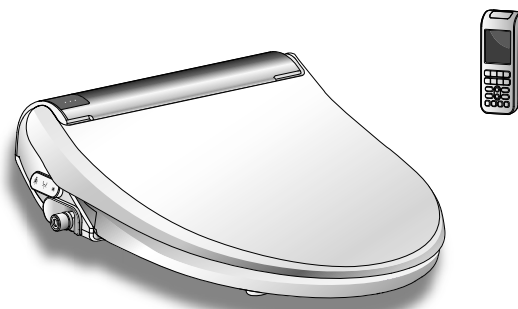

Thank you for purchasing Bio Bidet Advanced Toilet Seats.
Intended for household use only.

- IMPORTANT SAFEGUARDS / GENERAL CAUTIONS 4
- CAUTIONS BEFORE INSTALLATION 6
- CARTON CONTENTS / IDENTIFICATION 8

PREPARATION

- OPERATION (BASIC) 12
- OPERATION (DETAILS) 14

OPERATION

- INSTALLATION 18
- SEPARATION OF THE UNIT FROM THE TOILET BOWL 21

INSTALLATION

- MAINTENANCE 22
- WATER DRAINING 23
- TROUBLE SHOOTING 24
- SPECIFICATIONS 25
- WARRANTY 26
- INFORMATION TO THE USER 27

MAINTENANCE

1 IMPORTANT SAFEGUARDS / GENERAL CAUTIONS

● READ ALL INSTRUCTIONS BEFORE INSTALLATION AND USE

The following terms are used in this manual to indicate hazards of varying degrees of severity.

DANGER	Indicates an imminently hazardous situation which, if not avoided, will result in death or serious injury.
WARNING	Indicates potentially hazardous situation which, if not avoided, could result in death or serious injury.
CAUTION	Indicates potentially hazardous situation which, if not avoided, may result in minor or moderate injury or in damage to the product or other property.

DANGER - To reduce the risk of electrocution

WARNING - To reduce the risk of burns, electrocution, fire, or injury to persons

PLEASE OBSERVE THE FOLLOWING PRECAUTION BEFORE USING THIS PRODUCT

Do not open the product to repair or remodel. Only qualified service personnel should service this product. Do not use attachments not recommended by the manufacturer.



Connect this product to cold water supply pipe carrying potable water. Do not connect to an industrial water supply line that does not carry water of drinking quality. This will negatively effect hygiene and performance.

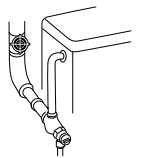

About Low Temperature Burns- A burn occurs when the skin has been exposed to high temperatures. However, a low temperature burn may occur when the skin has been in contact with an object at relatively low temperature (about 104 °F). Close supervision is necessary when this product is used by children or adults with sensitive skin.

If using any chemical toilet bowl cleaner, be sure to wipe up any spills that splash onto Electric Bidet. Do not use benzene or any acid chemical detergent. Only neutral detergent permitted.

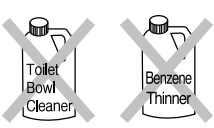

Do not plug in the power cord before connecting the water supply hose.

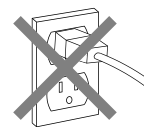

This product must be grounded. An approved Ground Fault Circuit Interrupt must be used.



Do not splash water on this product. Please provide adequate ventilation to avoid high levels of humidity which can damage the electronic components. It is necessary to provide adequate ventilation with a fan, open door or open window when bathing.



Do not touch the power cord with wet hands. Do not reach for a product that has fallen into water. Unplug immediately!

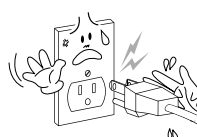

This product must be connected to a standard voltage power source. Do not connect power cord if the cord is damaged or broken. Do not plug the unit into a loose electric outlet.

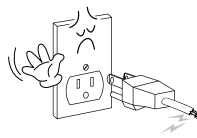

Please disconnect the power cord when you clean this product or detach it from toilet bowl. Do not supply electrical power to the unit until the plumbing work has been completed.

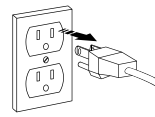

Keep the electrical cord away from heated surfaces to prevent a fire hazard. Also, keep any flammable materials away from this product at all times.



1 IMPORTANT SAFEGUARDS / GENERAL CAUTIONS

CAUTION



Never operate this product if it is not working properly, if it has been dropped or damaged, or dropped into water. Return the product to a service center for examination and repair.



Do not obstruct or put anything into the dry air outlet. Do not apply excessive force to the shower nozzle.



Do not stand or sit on the seat cover lid. It is not designed to support a user's body weight.



Allow the seat and lid to close automatically. Do not force the lid closed.



Do not strain or push the connected hose and tube connector; it may cause water leakage. Never drop or insert any object into any opening or hose. Use proper plumbing supplies if any modification is to be made.

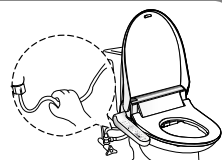

Use this product only as described in the operating instructions. Never use while sleeping or drowsy. Do not use while bathing.



Be careful so that this product does not become stained with excrement and urine.

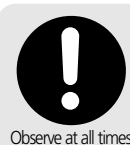

Drain the water from unit and unplug the power if this product is not going to be used for an extended period of time. Refer to page 19.



- SAVE THESE INSTRUCTIONS -

2 CAUTIONS BEFORE INSTALLATION

WIRING REQUIREMENT

THIS PRODUCT MUST BE PLUGGED into a regular voltage grounded GFCI outlet (North America 120V ac). The rated power consumption is 1400W. In locations where only a standard two-prong outlet is available, it is the responsibility of the user to install a grounded three-prong outlet. Using a higher voltage is dangerous and may result in a fire or other accident. This product is not responsible for damage resulting from the use of it on other than specified voltage, or operating it without proper grounding.

WARNING

This Product must be on a separate circuit. No other appliance should share the circuit with this product. Sharing a circuit could cause the branch circuit fuse to blow or the circuit breaker to trip. Continuous usage under these conditions could result in fire or property damage.

GROUND INSTRUCTIONS

- (1) This product has a three-prong grounding plug, which must be plugged into an outlet that is properly installed and grounded. In the event of an electrical short circuit, grounding reduces the risk of electric shock by providing an escape wire for the electric current. If repair or replacement of the cord or plug is necessary, do not connect the grounding wire to either flat blade terminal. The wire with insulation having an outer surface that is green with or without yellow stripes is the grounding wire. Check with a qualified electrician or service person if the grounding instructions are not completely understood, or if in doubt as to whether the product is properly grounded.
- (2) This product is for use on a nominal 120V circuit, and has a grounding plug that looks like the plug illustrated in sketch A in Figure 1. A temporary adapter, which looks like the adapter illustrated in sketches B and C, may be used to connect this plug to a 2-pole receptacle as shown in sketch B if a properly grounded outlet is not available. The temporary adapter should be used only until a properly grounded outlet (sketch A) can be installed by a qualified electrician. The green colored rigid ear, lug, or the like extending from the adapter must be connected to a permanent ground such as a properly grounded outlet box cover. Whenever the adapter is used, it must be held in place by the screw.

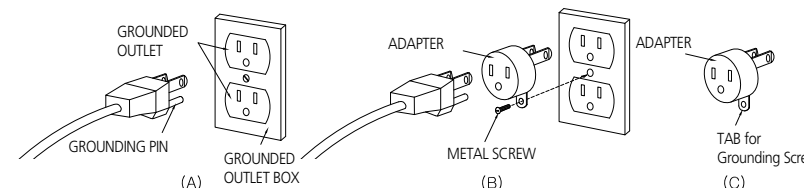

- Figure 1-

This appliance has to be earthed.

OPTIONAL GROUND INSTRUCTIONS

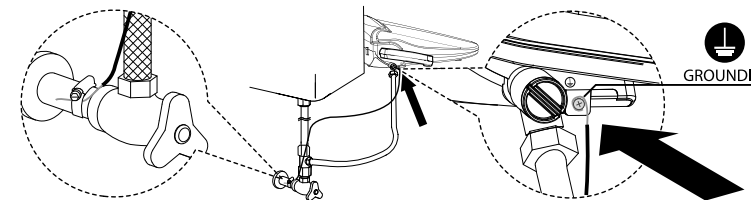

DANGER

IMPROPER GROUNDING CAN RESULT IN A RISK OF ELECTRIC SHOCK. Electric wiring has to be done in accordance with all local codes, or in the absence of local codes, with the National Electrical Codes.

The use of an extension cord is not recommended or advised. If it is necessary to use an extension cord, use only a three-prong extension cord (one to one), and a three slot built-in GFCI receptacle that will accept the plug on this product. The marked rating of the extension cord should be equal to or greater than the electrical rating of the unit (10amp). Consult a qualified electrician or service person if you are not sure whether the unit is properly grounded.

3 Identification

1 MAIN UNIT

BB-1700

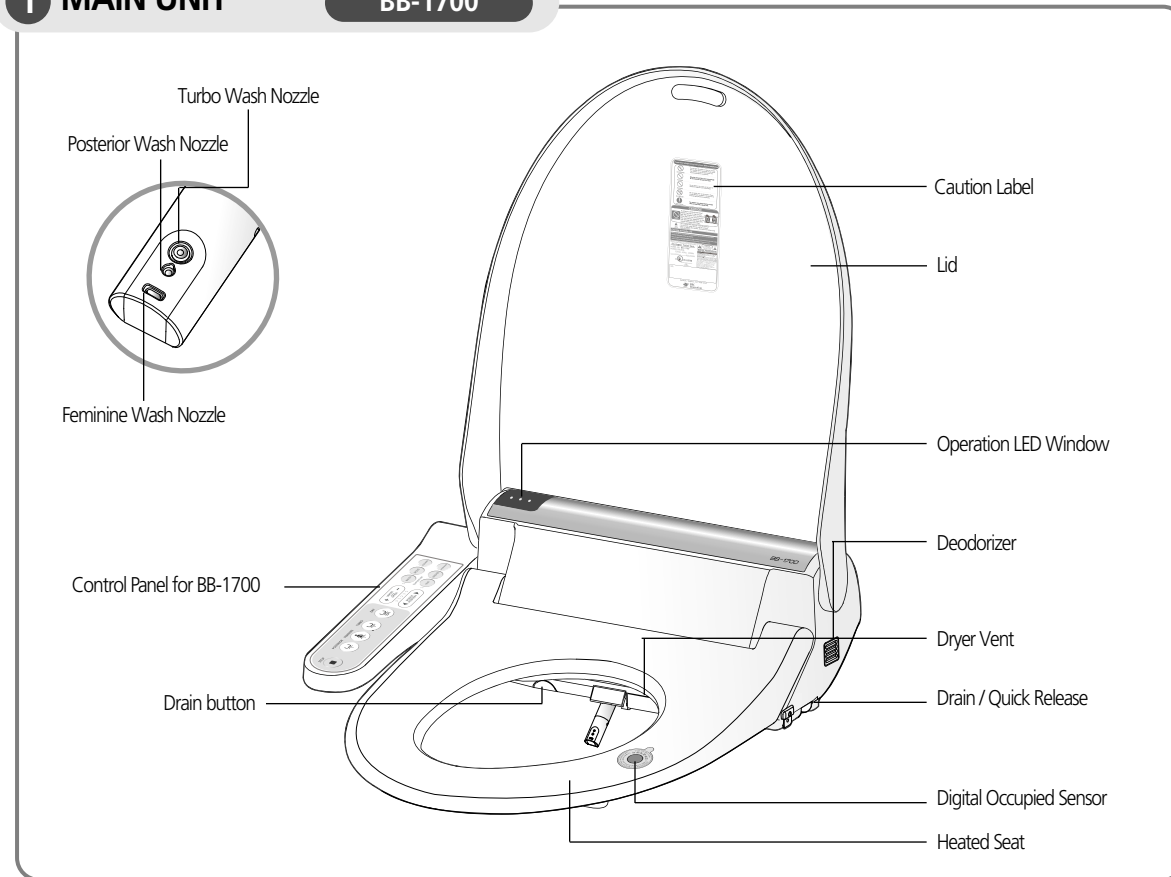

2 ACCESSORIES

For plumbing

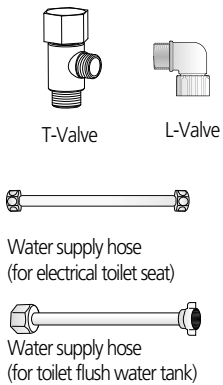

For product fixation

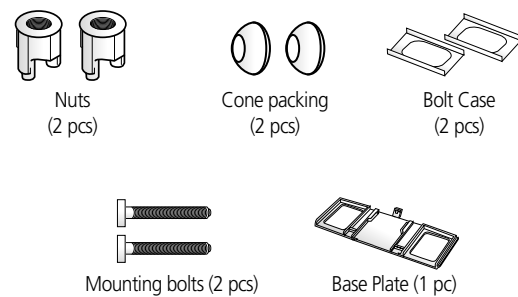

Installation instructions



3 BB-1700 Control Panel

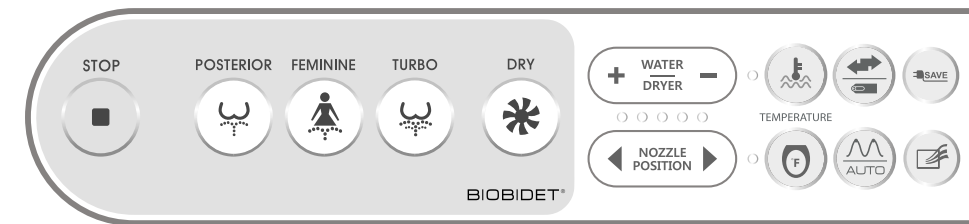

	Stop all operation.		
	Posterior wash.		Feminine wash.
	Turbo wash.		Dry washed area.
	Adjust the water pressure and warm air dryer temperature.		Adjust the oscillation function and nozzle position (5 levels).
	Adjust the water temperature (3 levels).		Adjust the seat temperature (3 levels).
	When selected during the wash function, the nozzle oscillates automatically for a wider wash.		When selected during the wash function, it starts the massage wash.
	If move button is selected when user is not sitting on the seat, it operates nozzle shower function.		If massage function selected when user is not using wash functions, it automatically operates wash and dry function sequentially.
	If Economy mode is selected, seat temperature and water temperature will stay at 89.6°F.		When user sits on the seat, it automatically operates to deodorize. (Can select on/off)

- When you sit down on this product, sit in the center in order to activate the sensor.

3 Identification

1 MAIN UNIT BB-2000

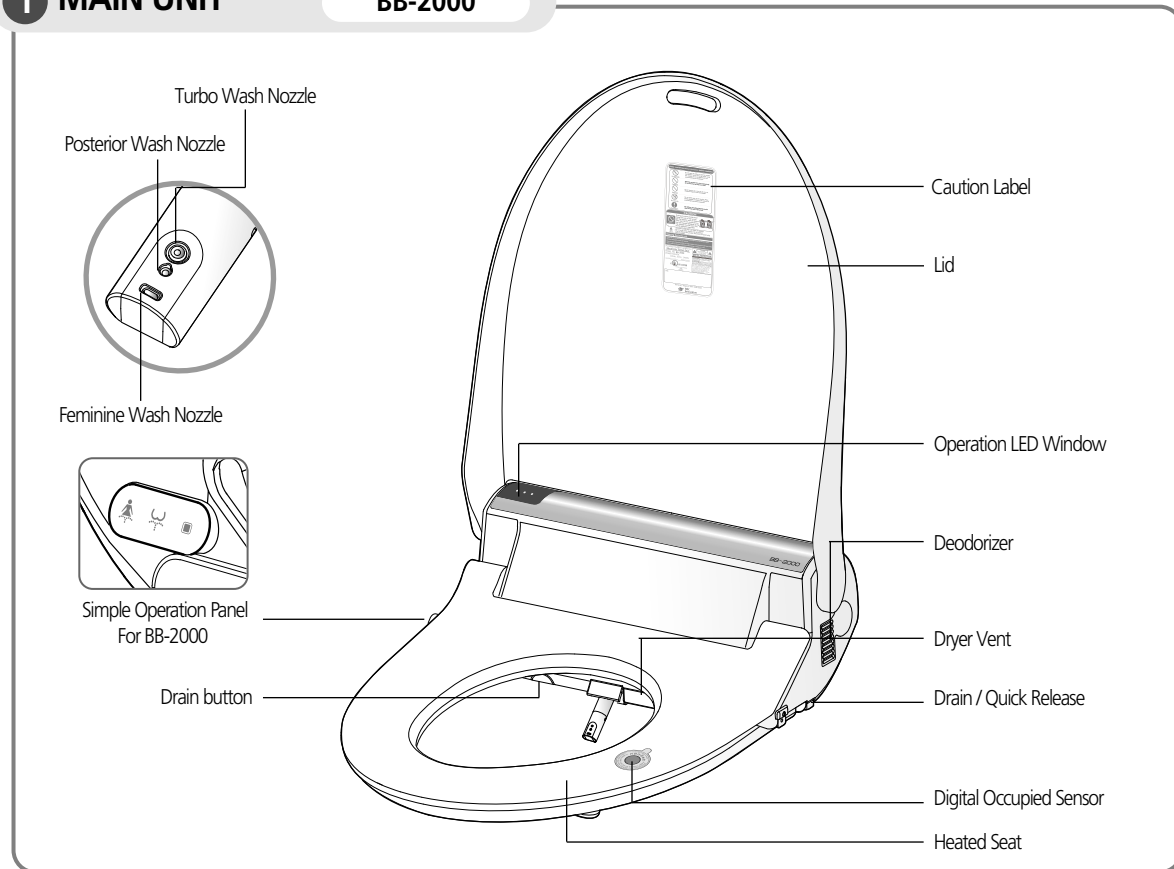

2 ACCESSORIES

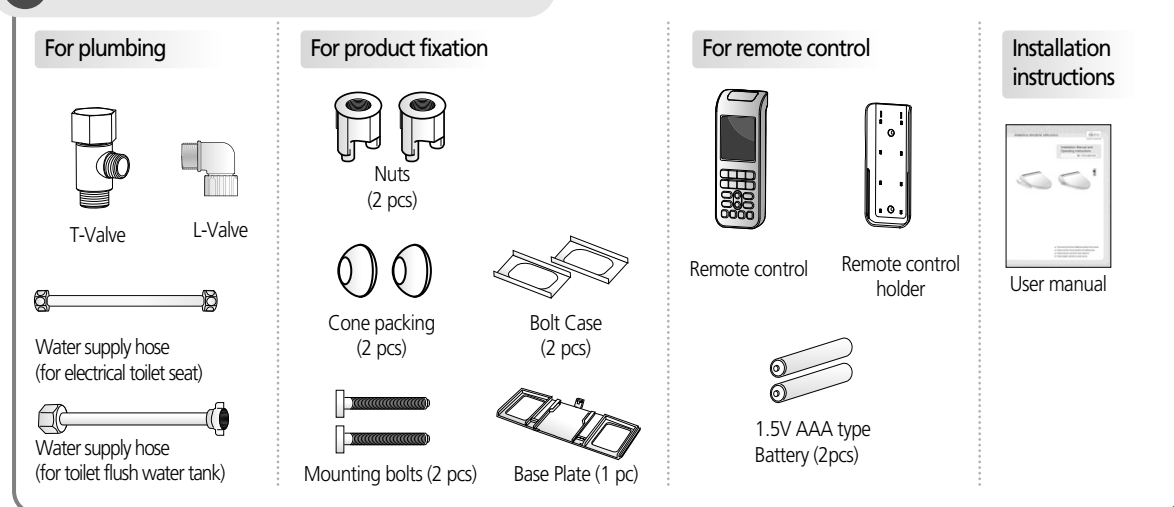

3 BB-2000 Remote Control



	Stop all operation.
	Posterior wash.
	Feminine wash.
	Dry washed area.
	VORTEX wash.
	When selected during wash function nozzle oscillates automatically for a wider wash.
	If move button is selected when user is not sitting on the seat, it operates nozzle shower function.
	When selected during wash function, it start massage wash.
	If massage function selected when user is not using wash functions, it automatically operates wash and dry function sequentially.
	When user sits on the seat, it automatically operates to deodorize. (Can select on/off)
	The water temperature can be adjusted up to 4 levels (off, low, middle, high).
	The seat temperature can be adjusted up to 4 levels (off, low, middle, high).
	Can set time in the remote control with hour() and minutes() buttons.
	If Economy mode is selected, seat temperature and water temperature will stay at 89.6°F.
	If this() symbol flashes, please change the battery in remote control.

Simple Operation Panel

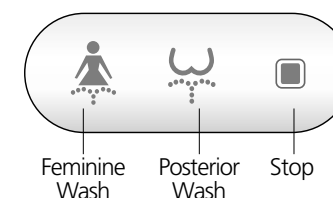

Display



1	Posterior Wash	10	Set Seat Temperature
2	Feminine Wash	11	Heated Seat
3	Dry	12	Water Pressure
4	Turbo	13	Dry On / Off
5	Deodrant	14	Set Nozzle position
6	Remote signal intensity	15	Watter pressure
7	battery life	16	Nozzle position
8	Set Water Temperature		
9	Heated Water		

- When you sit down on this product, sit in the center in order to activate the sensor.

CAUTION

CAUTION Please press the "off" or "low" button to reduce the seat temperature after using. Special precautions should be taken for children, those who cannot adjust the temperature, and those who have sensitive skin.

1 Check for any water leaks.

- Please turn on the water supply valve and check connected spots(1~5) for the leakage.

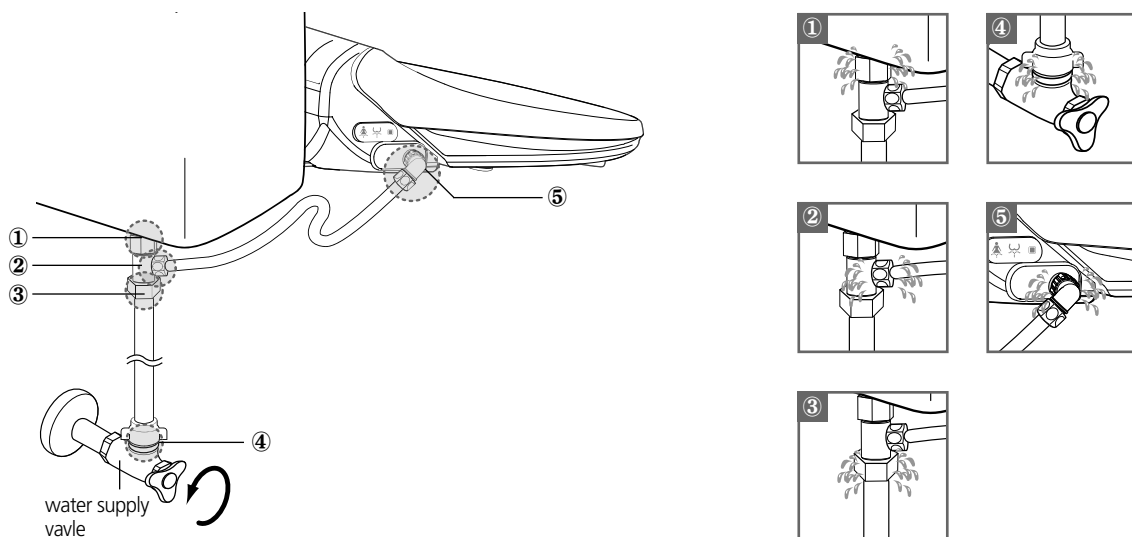

2 PREPARATION

- Please plug the power cord into AC110V power outlet.
- Plug the unit into the proper power source and the LED power light will start flashing.
- Wait until the LED power light stops flashing and becomes solid red.
- The water tank will be filled after pushing a "Wash" (or , or) button.
- When the water tank is filling the buzzer "Beeps" continuously. After the water tank is full the buzzer will end with "One Solid Beep".



Observe at all times

CAUTION

DO NOT ALLOW CHILDREN TO USE THE **TURBO WASH** or **VORTEX WASH** FUNCTION! SUPERVISION IS STRONGLY RECOMMENDED FOR THE ELDERLY OR OTHER PERSONS THAT MAY HAVE LIMITATIONS IN BODY MOVEMENT, ILLNESS OR DISABILITIES!

3 OPERATION

SIT DOWN ON THE SEAT

- When you sit down on the seat, the ORANGE LED lamp on the control panel will light up.
- When the digital sensor on the seat is activated, the operation LED window on the main unit will light "Occupied sensor" and simultaneously, the deodorizer fan will start to work. (BB-1700 / BB-2000 Models)
- See page 14 for details about changing the seat or water temperature.

STOP

- Press this button to stop all operation.

CLEANSING

CLEANSING 1. (Posterior Wash)

- 1- Press "Posterior Wash" (,). Automatically, the nozzle comes out and sprays warm water to posterior.
- 2- Additional functions during your Posterior Wash experience are available. See Oscillation, page 15 and Massage, page 16 for details.

CLEANSING 2. (Feminine Wash)

- 1- Press "Feminine Wash" (,). Automatically, the nozzle comes out and sprays warm water to feminine area.
- 2- Additional functions during your Feminine Wash experience are available. See Oscillation, page 15 and Massage, page 16 for details.

CLEANSING 3. (Turbo Wash / Vortex Wash)

- 1- Press "Turbo Wash" () or "Vortex Wash" (), the nozzle spray is more or focused to produce the effect of strong wash, to help stimulate bowel movement.
- 2- Press "Water pressure - High & Low button" to adjust the water pressure.

CLEANSING cont.

CLEANSING 3. (Turbo Wash or Vortex Wash)

- 1- Press "Turbo Wash" or "Vortex Wash" continuously for 3 to 5 seconds. Automatically, the water nozzle comes out and sprays a warm stream of water to the posterior center of the rectum.
- 2- If necessary, adjust "Position" of water stream with the (/) buttons.
- 3- Press "Water pressure High & Low button" (/) to adjust the water pressure to your desired comfort.
- 4- Press the "STOP" () button when you feel your abdomen is full or wait until the "Turbo Wash" or "Vortex Wash" function stops, approximately 1 minute.
- 5- You will shortly feel the urge to push the water out of your colon, push the water and feces out as thoroughly as you can.
- 6- Relax for a few minutes and be sure you feel your colon is empty and then use the "Posterior Wash" and "Air Dry" function to finish.

5 Operation (Details)

DRY

WARM AIR DRYER

- Press "Dry" (,), warm, dry air is gently directed to washed area for about 3 minutes.
 - You may adjust the warm air temperature by pressing High() and Low() buttons.
- ※ This product memorizes the air temperature of prior use.

WATER PRESSURE ADJUSTMENT

- After sitting down on the this product, the LED lamp() for water pressure on the Power Control will light at third or middle level().
- Press high(), or low() to adjust the pressure of the water spray to your desired comfort level.

BB-1700	BB-2000

WARM WATER TEMPERATURE AND SEAT TEMPERATURE ADJUSTMENT

BB-1700

- The temperature of water and seat are adjustable to the desired level by pressing the "WATER"() and "SEAT"() button.

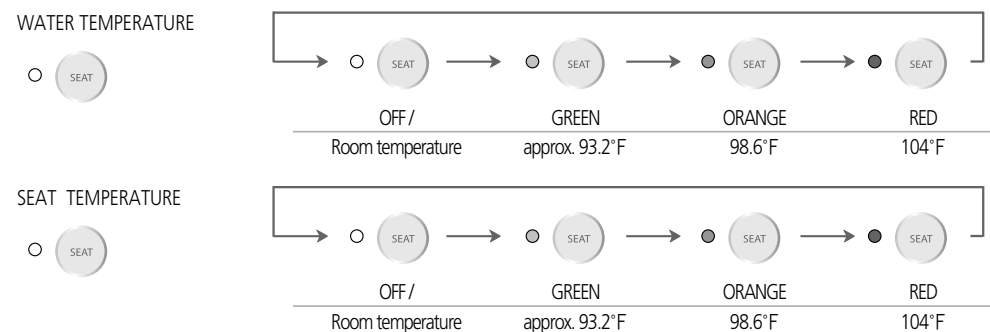

WARM WATER TEMPERATURE AND SEAT TEMPERATURE ADJUSTMENT

BB-2000

- The temperature of water and seat are adjustable to the desired level by pressing the "WATER"() and "SEAT"() button.

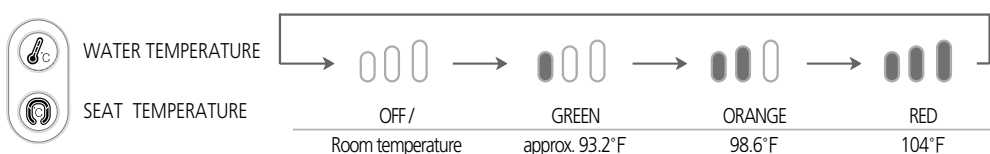

DEODORIZER

Deodorizer ON/Off (initial setting is Off)

- Press button for(,) 3 seconds (press the button again for 3 seconds, the function is canceled.)
- After setting Deodorizer function, it is automatically activated when sensing the human body.



- Once used, the Deodorizer function automatically stops after 1 minute of operation.

Reference - Deodorizer function stops while dryer is selected. After dryer function completes, deodorizer automatically is activated.

OSCILLATION (Nozzle Movement Function)

- When using Posterior or Feminine Washing functions, pressing the "MOVE"(,) button will provide a short-motion, front to back oscillating spray for a much wider cleansing experience.
- You may change the position of the Oscillating spray by pressing the "MOVE"(,) button again and "Front"() or "Rear"() buttons simultaneously.
- Push the "MOVE"(,) button again and the oscillation motion will stop automatically.

Auto-Setting of Oscillation Feature

- You can set this function to automatically oscillate whenever the seat is occupied and the Posterior or Feminine washes are in operation.

Step 1: Sit on this product.

Step 2: Press the "MOVE"(,) button for 3 seconds or until you hear a single Chime.

Step 3: Sit on the this product and proceed with Posterior or Feminine Wash.

Note: In the automatic setting, you may still adjust the position of the Oscillating spray by pressing the "Front"() or "Rear"() buttons.

Canceling the Automatic Oscillation function

Step 1: Sit on this product.





Step 2: Press the "MOVE"(,) button for 3 seconds or until you hear a double Chime.

NOZZLE POSITION ADJUSTMENT

- Nozzle position is adjustable to the desired position by pressing "Front"() or "Rear"() button from 1 to 5 positions. After using this product, the nozzle will return to position 3.

5 Operation (Details)

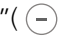
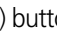
● MASSAGE (Rhythm Wash)

- When using the Posterior Wash or Feminine Wash functions, pressing the "MASSAGE" ( , ) button will provide a pulsation spray.
- You may change the pressure of the spray by pressing the "High" () button or "Low" () buttons.
- Push the "MASSAGE" ( , ) button again and the pulsating action will stop automatically.

Auto-Setting of Massage Feature

- You can set this function to automatically pulsate whenever the seat is occupied and the Posterior or Feminine washes are in operation.

Step 1: Sit on this product.

Step 2: Press the "MASSAGE" ( , ) button for 3 seconds or until you hear a single Chime.

Step 3: Sit on this product and proceed with Posterior or Feminine Wash.

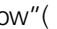

Note: In the automatic setting, you may still adjust the pressure of the pulsating spray by pressing the "high" () or "low" () functions.

Canceling the Automatic Oscillation function



Step 1: Sit on this product.

Step 2: Press the "MASSAGE" ( , ) button for 3 seconds or until you hear a double Chime.

● Auto Wash

- If the "MASSAGE" ( , ) function selected when user is not using wash functions, it automatically operates wash and dry function sequentially.
- Wash (30 Seconds) + Dryer (1minute) then automatically stops

● Nozzle Shower

- If the "MOVE" ( , ) button is selected without sitting on the seat, it operates nozzle shower function.
- Water flows automatically to nozzle and nozzle moves for about 20 seconds to wash entire nozzle and then it automatically retracts.

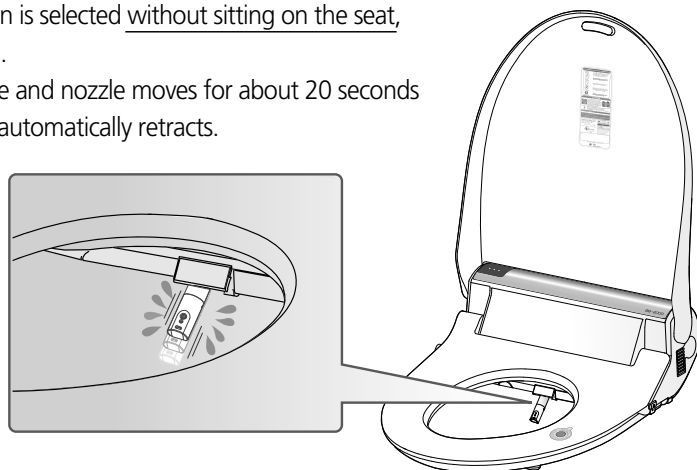

● ECONOMY (Energy Save Mode)

■ Saver On/ Off

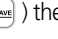
- When pressing ( , ) the energy saver LED on the main unit will turn on. (press button again, the saver LED will turn off)
- Energy saver mode automatically maintains a water and seat temperature of 89.6°F (32°C).
- When using bidet in saver mode, it is turned to automatic saver.
- When you rise from the seat, it goes into saver mode.
- Seat temperature is maintained 32°C.

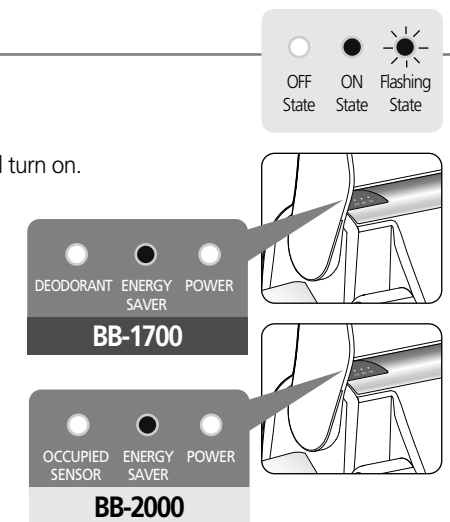

In energy saver mode, the seat heating temperature could appear to be lower than the actual temperature setting.

Other energy saver tips





In order to save energy, please abide by the following instructions:

- Keep seat cover closed when not in use to prevent heat from being lost.
- Keep temperature set to low.
- Unplug the power cord if you do not plan to use the unit for a long period of time.

● NOZZLE CLEANING (Automatically)

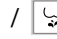
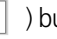
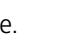
- This product has an automatic nozzle self-cleaning function that cleans the nozzle before and after each use.

● NOZZLE CLEANING (Manual)

- Nozzle can be cleaned manually by pressing "Posterior Wash" ( / ) button for 3 seconds without being occupied on the seat and nozzle will come out without spraying water. After cleaning the nozzle, Press "Stop" ( / ) button to return nozzle to stand-by mode. ( ,  : in Simple Operation panel -Remote Model)



CAUTION BEFORE INSTALLATION

- Do not plug in before installation.
- If you need an electric power system or extension, please consult a qualified electrician.

STEPS

1 Turn Off Water.

- Shut off the water supply shut off valve.
- Drain the toilet tank completely.
- Then remove the existing fill valve water supply hose.

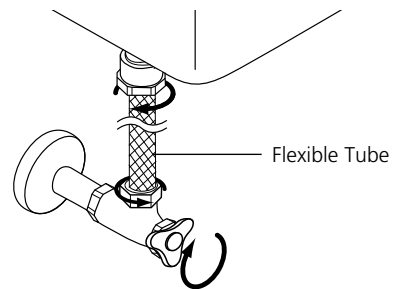

3 Removing the existing seat and lid.

- Remove mounting bolts to release existing toilet seat from toilet.



2 Connect T-Valve.

- Remove existing supply hose connected to the toilet tank. Make sure not to damage the water supply hose
- Install T-Valve at the thread from tank.

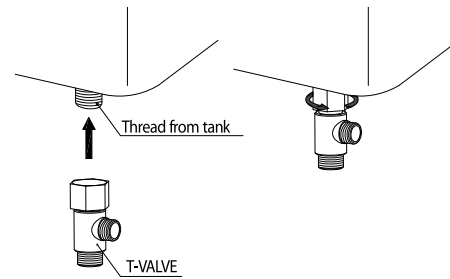

4 Connect water supply hose to the T-Valve.

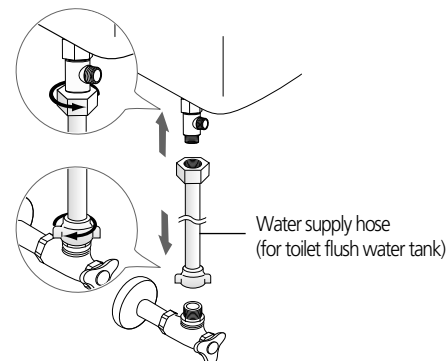

※ Check for any water leaks.

5 Installation Catch Plate.

Place the plate and guides over each mounting hole. Insert the mounting bolts through the plate and mounting holes.

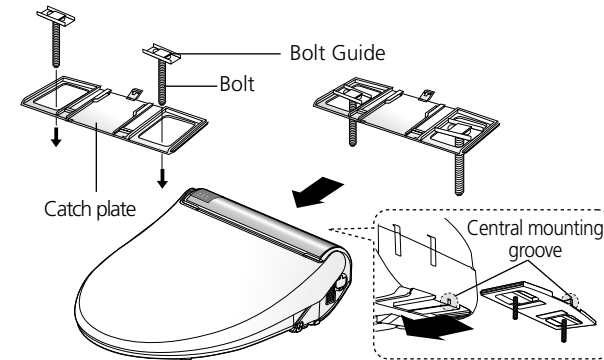

7 Assembly.

1. Slide this product onto the catch plate centering the unit with the guide arrows on the Base.
2. You will hear a click once this product is securely mounted to the catch plate.
3. This product will feel a little loose on the toilet bowl. Adjust the fit from front to back and side to side for balance.
4. Tighten the nuts on both bolts securely.

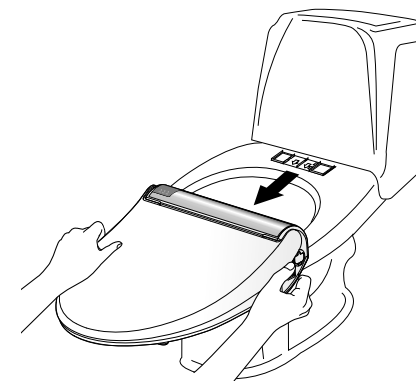

※ Check for any water leaks.

6 Bolt and Nut Assembly.

Slide cone packing and washers onto the bolts then fasten to securely mount bidet seat to toilet.

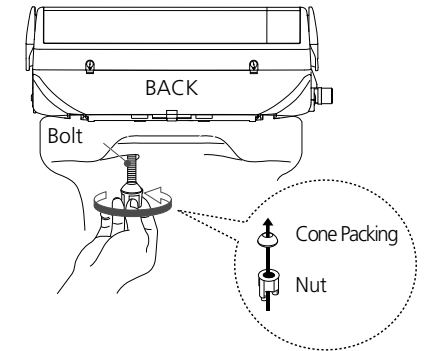

8 Connect the flexible tube from side of T-Valve to this product, Open the Angle Stop valve to fill water.

Check for any water leaks.

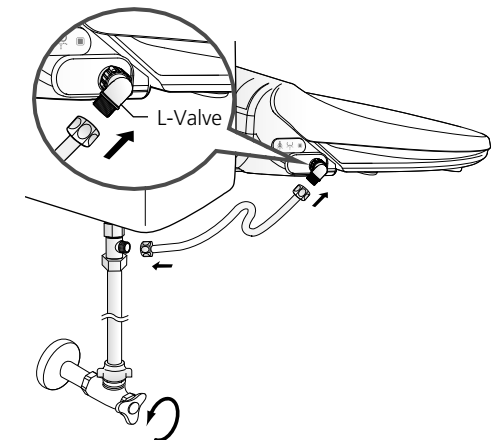

6 Installation

9 Wireless remote mounting guide. (BB-2000)

Install wireless remote with adhesive tape

- Remove adhesive from back of bracket and place bracket where desired.

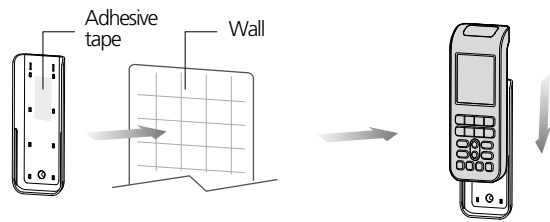

Inserting batteries

- Insert supplied batteries (1.5V AAA) and close battery cover.

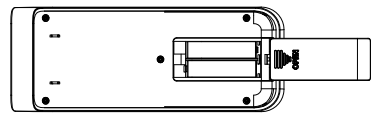

(Please check the polarity, before insert the batteries.)

10 Nozzle Change

Nozzle Separation

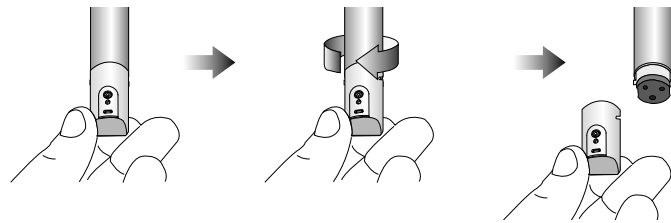

Nozzle Combination

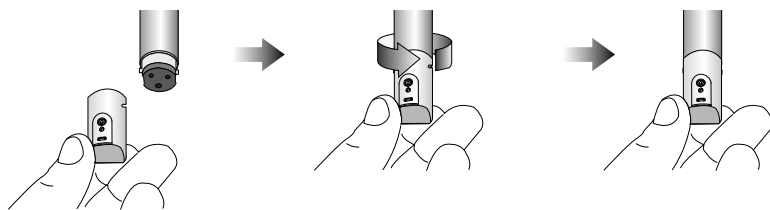

7 Separation Of Unit From The Toilet Bowl



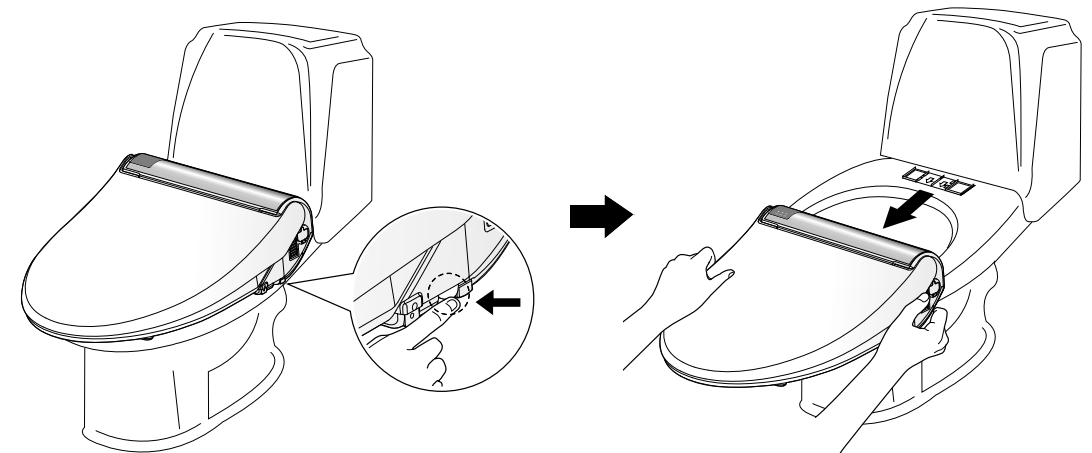
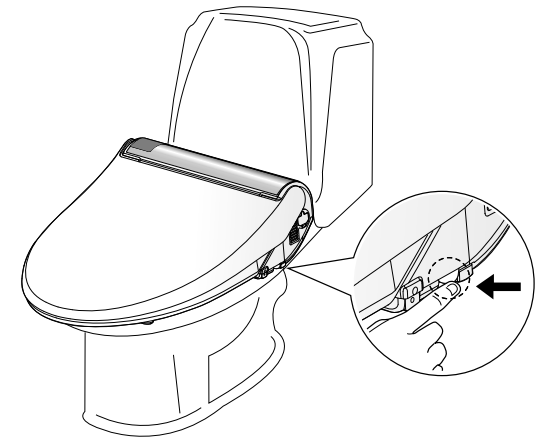

- 1 Disconnect the power plug.
- 2 Close water supply shut-off valve.
- 3 Drain water from bidet seat using drainage as illustrated.
- 4 Remove bidet seat from toilet as illustrated.

⚠ Do not turn unit upside down.

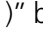
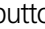
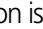

8 Maintenance

CLEANING THE NOZZLE

- When the "Posterior Wash ( / )" button is pressed for 3 seconds without occupying the seat, the nozzle can be cleaned with a soft toothbrush.
( : in Simple Operation panel -Remote Model)
- After cleaning the nozzle, push the "Stop ( / )" button once again, and the nozzle retracts itself.
( : in Simple Operation panel -Remote Model)

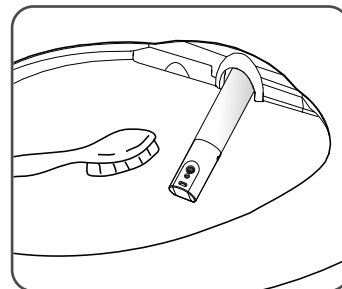

CLEANING THE BODY OF UNIT

- When you clean this product, do not use thinner, benzene or toilet bowl cleaner. It may cause damage to the surface of unit.
- Use a wet cloth when you clean this product.
- Do not spray water directly on to this product.
- When you clean this product, disconnect the power plug.

CLEANING THE STRAINER

This product will not operate properly if the strainer is clogged. Please clean the strainer regularly.

- 1) Close the water shut off valve.
- 2) Flush the toilet to empty the water reservoir.
- 3) Unscrew the water filter nut.
- 4) Clean the strainer with a small brush or water.
- 5) Re-screw the water filter nut.
- 6) Open the water shut off valve.

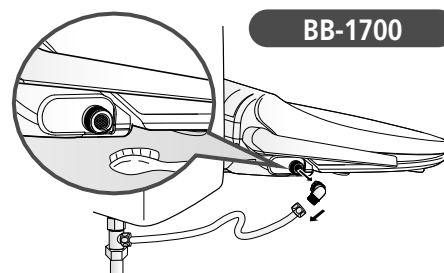
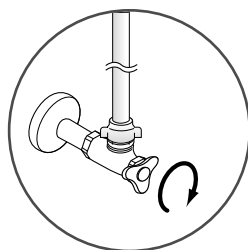

BB-1700

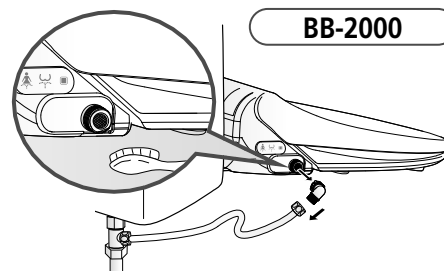

BB-2000

9 Water Draining

DRAINING THE WARM WATER TANK IN THE UNIT

If you do not intend to use this product for 14 days or longer, drain the water from this product's warm water tank.

- 1) Disconnect the power plug.
- 2) Close the water shut off valve.
- 3) Press the drain lever until the water is completely drained from water tank.
- 4) To re-supply water after draining, open the water shut off valve.

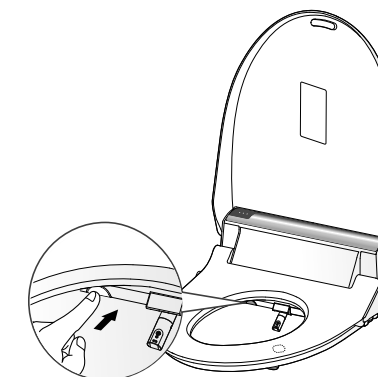
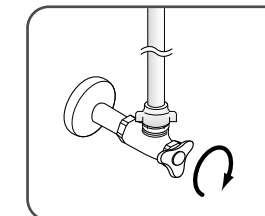

Do not drink the drained water.
Do not insert finger into the drain hole.
Before draining, unplug the power cord and wait 30 minutes until the unit has cooled down.

MAINTENANCE FOR WINTER SEASON

- 1 Check the power cord if it is plugged in or not.
- 2 Keep the water temperature on "Middle or High Level" to prevent water from freezing.
- 3 If you do not intend to use the unit for 14 days or longer, disconnect the power plug and drain the water.

10 Trouble Shooting

Trouble	Cause	Remedy
The washing water does not spray	<ol style="list-style-type: none"> The water tank is not filled. The shut off valve is closed. Freezing inside the main unit or the water supply pipe. 	<ol style="list-style-type: none"> Wait about one minute. Press the desired washing button once again. Turn on the shut off valve to open. Heat the room (for about two hours). Operating the unit while parts are frozen will cause a malfunction.
The unit is not operating	<ol style="list-style-type: none"> Disconnected the power cord. The seat is not occupied. The battery of remote controller is exhausted. (Only BB-2000 model) 	<ol style="list-style-type: none"> Connect the power cord. Check the power supply system in your house. Occupy the seat (The unit has an occupied sensor). Replace the battery.
Water is leaking	<ol style="list-style-type: none"> Check the water supply system 	<ol style="list-style-type: none"> If water is leaking from the main unit, call the service center or the place you purchased unit.
The washing water pressure is weak	<ol style="list-style-type: none"> The water pressure level is set to "LOW". The strainer is clogged. 	<ol style="list-style-type: none"> Set the water pressure to "HIGH". Clean the strainer.
The washing water is not warm	<ol style="list-style-type: none"> The water temperature is set to "LOW". Continuous operation has depleted the supply of warm water. 	<ol style="list-style-type: none"> Set the water temperature to "HIGH". Wait about three minutes.
The seat and dryer is not warm	<ol style="list-style-type: none"> The seat & dryer temperature is set to "LOW". 	<ol style="list-style-type: none"> Set the seat & dryer temperature to "HIGH".

11 Specifications

Specification	BB-1700	BB-2000
Power Rating	America or Canada: 120Vac, 60Hz, 1400W	
Water inlet type	Type	Direct Inlet flow type
	Water inlet pressure	0.4 ~ 7.5 kgf/cm ² (5.69 psi ~ 106.7psi)
Power cord	1.2m (4 feet): AMERICA	
Wash Device	Posterior Wash	Max. 0.7 l /min (Max. 0.32 GPM)
	Feminine Wash	Max. 0.7 l /min (Max. 0.32 GPM)
	Water Pressure Adjustable	5 Levels
	Warm Water Temperature	Room Temp - 40°C (Room Temp. 104°F)
	Heater	1340 W
Heated Seat	Safety Devices	Thermal fuse, Thermal switch, Float switch
	Temperature	Room Temp ~ 41°C (Room Temp. ~ 105.8°F)
	Heater	55 W
Warm Air Dryer Device	Safety Device	Thermal fuse
	Adjustable Dry Temperature (Room Temp~45°C)	
	Heater (250W)	○
Turbo& Vortex Function	Safety Device (Thermal fuse, bimetal)	○
		○
Deodorizer	-	○
Remote control	-	○
Inlet water temperature	3°C~ 35°C (37.4°F ~ 95°F)	
Ambient Temperature	3°C~ 40°C (37.4°F ~ 104°F)	
Dimension	Elongated(Control)	Elongated (Remote)
	W : 460mm / L : 531mm / H : 152mm	W : 392mm / L : 531mm / H : 152mm
Weight (kg)	4.9kg	4.8kg

Three Year Limited Warranty

1. 100% Coverage of all parts and labor for the entire product for the first year from original date of purchase.
2. 75% Coverage of all parts and labor for the entire product for the second year from original date of purchase.
3. 50% Coverage of all parts and labor for the entire product for the third year from original date of purchase.

BBC Innovation warrants its products to be free from manufacturing defects under normal use and service for a period of three (3) years pro-rated based as outlined above from original date of purchase.

This warranty is extended only to the ORIGINAL PURCHASER.

BBC Innovation's obligations under this warranty are limited to repair or replacement, at BBC Innovation's option, of products or parts found to be defective, provided that such products were properly installed and used in accordance with instructions.

BBC Innovation reserves the right to make such inspections as may be necessary in order to determine the cause of the defect.

BBC Innovation will not charge for labor or parts in connection with warranty repairs or replacements.

BBC Innovation is not responsible for the cost of removal, return and/or reinstallation of products.

This warranty does not apply to the following items:

Damage or loss sustained in a natural calamity such as fire, earthquake, flood, thunder electrical storm, etc.

Damage or loss resulting from any unreasonable use, misuse, abuse, negligence, or improper maintenance of the product.

Damage or loss resulting from removal, improper repair, or modification of the product.

Damage or loss resulting from sediments or foreign matter contained in a water system.

Damage or loss resulting from improper installation or from installation of a unit in a harsh and/or hazardous environment.

This warranty gives you specific legal rights. You may have other rights which vary from state to state.

To obtain warranty repair service under this warranty, you must take the product or deliver it prepaid to a BBC Innovation service facility together with a letter stating the problem, or contact a BBC Innovation distributor or products service contractor, or write directly to BBC Innovation Corporation, 205 Bert Street, Algonquin, IL 60102.

This written warranty is the only warranty made by BBC Innovation. Repair or replacement as provided under this warranty shall be the exclusive remedy available to the purchaser. BBC Innovation shall not be responsible for loss of the product or for other incidental, special or consequential damages or expenses incurred by the purchaser, or for labor or other costs due to installation or removal, or costs of repairs by others, or for any other expense not specifically stated above. Except to the extent prohibited by applicable law, any implied warranties, including that of merchantability or fitness for use, are expressly limited to the duration of this warranty. Some states do not allow limitations on how long an implied warranty lasts, or the exclusion or limitation of incidental or consequential damages, so the above limitation and exclusion may not apply to you.

Warning! BBC Innovation shall not be responsible or liable for any failure of, or damage to, this plumbing product or product component caused by either chloramines in the treatment of public water supply or in-tank bowl cleaners containing chlorine (calcium hypochlorite).

Note: The use of high concentration of chlorine or chlorine related products can seriously damage the fittings. This damage can cause leakage and serious property damage.



This equipment has been tested and found to comply with the limits for a Class B digital device, pursuant to part 15 of the FCC Rules. These limits are designed to provide reasonable protection against harmful interference in a residential installation. This equipment generates, uses and can radiate radio frequency energy and, if not installed and used in accordance with the instructions, may cause harmful interference to radio communications. However, there is no guarantee that interference will not occur in a particular installation. If this equipment does cause harmful interference to radio or television reception, which can be determined by turning the equipment off and on, the user is encouraged to try to correct the interference by one more of the following measures:

- Reorient or relocate the receiving antenna.
- Increase the separation between the equipment and receiver.
- Connect the equipment into an outlet on a circuit different from that to which the receiver is connected.
- Consult the dealer or an experienced radio/TV technician for help.

WARNING

Changes or modifications not expressly approved by the manufacturer could void the user's authority to operate the equipment.

Note : The manufacturer is not responsible for any Radio or TV interference caused by unauthorized modifications to this equipment. Such modifications could void the user's authority to operate the equipment.

For Service & Technical Support, call or write to:

BBC Innovation Corporation
 205 Berg Street
 Algonquin, IL 60102
 U.S.A

Tel: 847.458.2334
 Fax: 847.854.1296
 Support@biobidet.com

