



GAS PRESSURE WASHER

3,200 PSI - 5.5 GPM

WITH HONDA ENGINE

**TMR / TRUCK
MOUNT
READY**

MODEL: **B3213HTBAS**
UPC: **777987413856**

RELIABLE HONDA
GX390 ENGINE

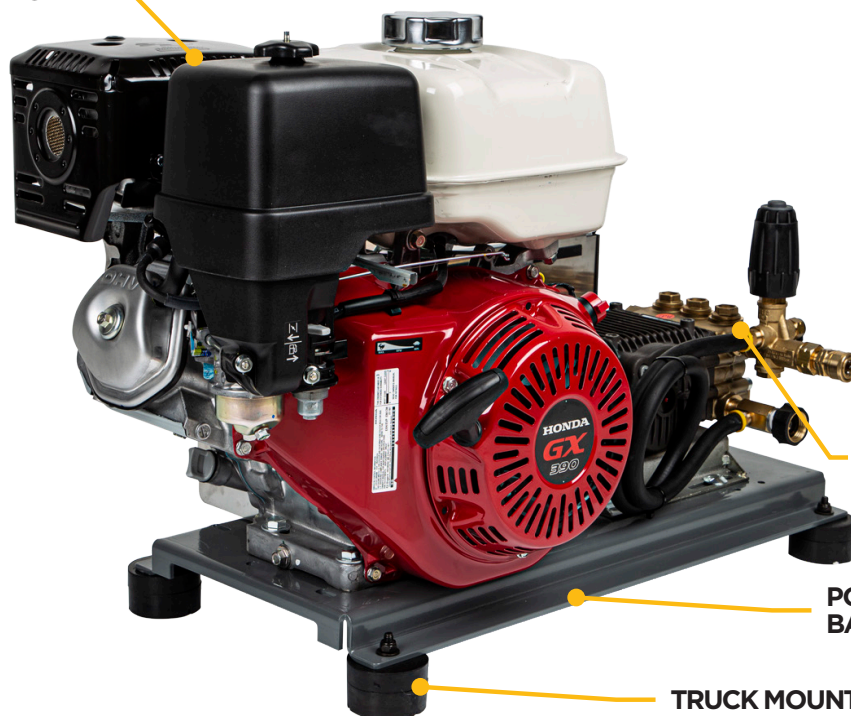

TRIPLEX PUMP WITH
EXTERNAL UNLOADER

POWDER COATED STEEL
BASE PLATE

TRUCK MOUNT READY



LEARN MORE ABOUT THIS
PRODUCT BY SCANNING THE
QR CODE



85.652.313



WARNING

FOR YOUR SAFETY, IT IS CRITICAL YOU ALWAYS FOLLOW THE BELOW PRECAUTIONS. READ AND UNDERSTAND THE MANUAL BEFORE USING.

DANGER: Engine exhaust contains **CARBON MONOXIDE**, an invisible, odorless and deadly gas. Exposure can cause sickness or death within a few minutes. This machine is for **OUTDOOR USE ONLY - NEVER USE IN ANY ENCLOSURE**. Always point muffler away from enclosures. Always use Carbon Monoxide Alarm(s) inside your home.

DANGER: High-pressure spray can directly cause serious injury. **NEVER** point the spray at any person or animal. Keep area clear of other people. Be aware of loose debris that can be propelled and cause damage or injury.

WARNING: ALWAYS wear safety (chemical splash) goggles and use caution. Other protective equipment such as hearing protection, steel toe boots, safety apparel, work gloves and face

shields are all recommended. Never use without closed-toe foot apparel in case of accidental spray.

WARNING: Know how to stop the machine and bleed the pressure quickly in case of an emergency.

WARNING: NEVER let unqualified people or children operate this machine. **NEVER** use the machine when fatigued or under the influence of alcohol or drugs.

WARNING: ALWAYS keep solid footing and good balance. Do not stand on slippery or unstable surfaces.

WARNING: ALWAYS stay alert of the surrounding area and where the spray gun is pointing. When spraying, always start from a safe distance and then move closer with the spray gun to avoid accidentally damaging surfaces.

START-UP PROCEDURE



1 Check your fluid levels.



2 Connect garden hose to pump inlet.



3 Connect high pressure hose to the pump outlet.

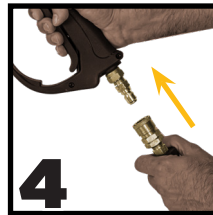

4 Connect spray gun to high-pressure hose.



5 Turn on water supply & purge air from system.

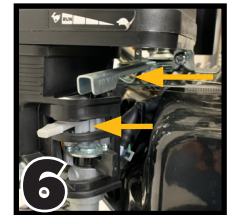

6 Move choke & throttle to the left.



7 Move gas valve to the right.

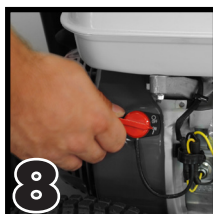

8 Switch engine to "on".



9 Pull recoil until engine starts.



10 Move choke to the right (run).

SHUT DOWN PROCEDURE

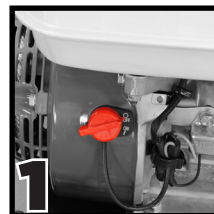

1 Switch engine to "off".



2 Purge water from system.



85.652.313