



ITEM #0354500
ELECTRIC TELESCOPIC HEATER
MODEL #ZHQ1821SH-T

Français p. 12



ATTACH YOUR RECEIPT HERE

Serial Number _____ Purchase Date _____



Questions, problems, missing parts? Before returning to your retailer, call our customer service department at 1-888-775-1330, 7AM-4PM PST Monday to Friday.

TABLE OF CONTENTS

Safety Information	5
Package Contents	3
Hardware Contents	4
Preparation	7
Assembly Instructions	8
Operating Instructions	11
Care and Maintenance	11
Troubleshooting	12
Warranty	12

SPECIFICATIONS

Voltage rating	120V 60 Hz
Power Consumption	1,500 W
Unit Size	24 in. (W) X 24 in. (D) X 81 in. (H)
Unit Weight	28.7 lbs. (13 kg)

PACKAGE CONTENTS

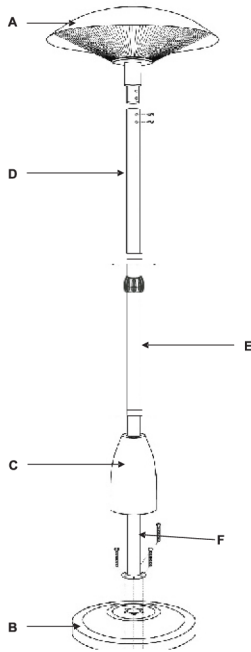

PART	DESCRIPTION	QUANTITY
A	Heater Head	1
B	Weighted Base	1
C	Decorative Cap	1
D	Top Tube	1
E	Middle Tube	1
F	Bottom Tube	1

HARDWARE CONTENTS

AA

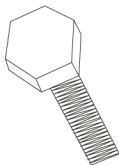

M6 × 50
Bolts
Qty. 3

BB



M4 × 8
Screw
Qty. 2

CC

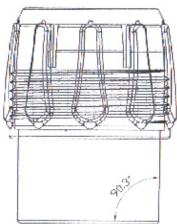

∅ M6 × 50mm
Securing Knob
Qty. 1

DD



M4
Nuts
Qty. 4

EE



M4
Allen Wrench
Qty. 1

⚠ SAFETY INFORMATION

Please read and understand this entire manual before attempting to assemble, operate or install the product.

⚠ WARNING

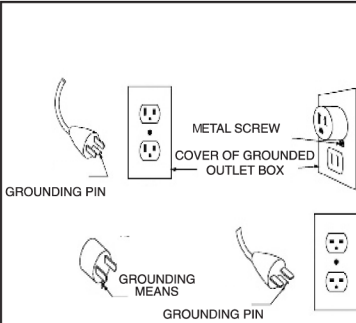

WARNING:

This heater has a voltage rating of 120 volts. The cord has a plug as shown at left. An adaptor as shown at left is available for connecting three-blade grounding-type plugs to two-slot receptacles. The grounding plug extending from the adaptor must be connected to a permanent ground such as a properly grounded outlet box. The adaptor should not be used if a three-slot grounded receptacle is available.

DO NOT DEFEAT THE SAFETY PURPOSE OF THE GROUNDED PLUG.

1. Read ALL instructions before using this unit.
2. **CAUTION: RISK OF ELECTRIC SHOCK. DO NOT** open or try to repair the heater yourself.
3. This unit may get hot when in use. To avoid burns, **DO NOT** touch the hot surface with bare skin.
4. Keep combustible materials at least 3 feet away from all sides of this unit. **DO NOT** place towels or other objects on the heater.
5. Extreme caution is necessary when this unit is used by or near children or the disabled.

SAFETY INFORMATION

6. DO NOT operate this unit with a damaged cord or if this unit is malfunctioning. Return the unit to an authorized service facility for examination or repair.
7. This unit is not intended for use in bathrooms, laundry areas and/or similar indoor locations. NEVER locate this unit where it may fall into a bathtub or any other water container. DO NOT immerse in water or any other liquid.
8. DO NOT touch the control panel or plug with a wet hand.
9. DO NOT run cord under carpeting. DO NOT cover the cord with a rug or any other similar coverings. Arrange the cord away from the traffic area to prevent obstruction.
10. DO NOT insert or allow any objects to enter any ventilation or exhaust opening as this may cause an electric shock, fire, or damage to the heater.
11. To prevent a possible fire, DO NOT block the air intakes or exhaust vent in any manner. DO NOT use on soft surfaces, such as a bed. Place on hard surfaces only.
12. A heater has hot and arcing or sparking parts inside. DO NOT use in areas where gasoline, paint, explosive and/or flammable liquids are used or stored. Keep this unit away from heated surfaces and open flames.
13. Avoid use of an extension cord as the extension cord may overheat and cause a risk of fire. However, if you have to use an extension cord, the cord shall be in compliance with the No. 14 AWG minimum size and rated no less than 1,875W.
14. This unit is designed for a 120 V AC electrical outlet connection ONLY.
15. To disconnect the unit, turn the control switch to the OFF position, then remove the plug from the outlet. Pull the plug firmly. DO NOT pull the cord.

SAFETY INFORMATION

16. Always unplug this unit before moving or whenever this unit is not in use.
17. This unit is only intended for household use as described in this manual. Any other use is not recommended by the manufacturer. This may cause a fire, electric shock, or injury. DO NOT use attachments that are not recommended or are sold by an unauthorized dealer. This may cause hazards.
18. Only use on a dry level surface. This unit is for floor or table use only.
19. **WARNING:** To reduce the risk of fire or electric shock, DO NOT use this unit with any solid-state speed control device.
20. DO NOT attempt to repair or adjust any electrical or mechanical function of this unit. Doing so will void your warranty. ONLY a qualified technician is recommended to perform service or repair.
21. Only connect this unit to properly grounded outlets.
22. Save this manual for future reference.

PREPARATION

Before beginning assembly of product, make sure all parts are present. Compare parts with package contents list and hardware contents. If any part is missing or damaged, do not attempt to assemble the product.

Estimated Assembly Time: 10 minutes

Tools Required for Assembly: Wrench (included)

ASSEMBLY INSTRUCTIONS

Step 1: Attach the bottom tube (F) to the weighted base (B) using 3 M 6 x 50 bolts (AA).

Hardware Used

AA

M6×50 Bolts



× 3

Step 2: Place the decorative cap (C) onto the bottom tube (F).

Step 3: Feed approximately 2 meters of the power cord through the weighted base (B) and the bottom tube (F).

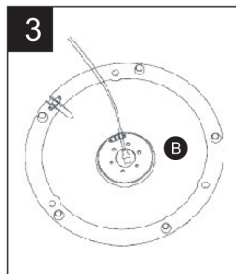
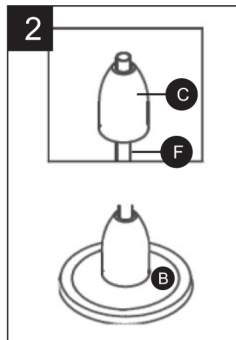
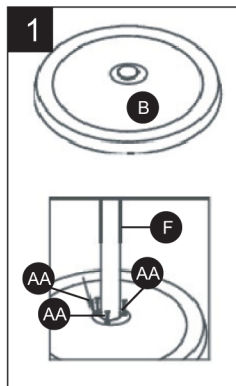

ASSEMBLY INSTRUCTIONS

Step 4: Screw the middle tube (E) to the bottom tube (F).

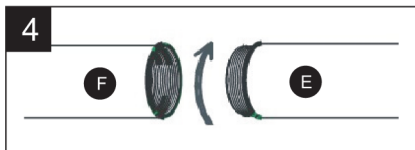

Step 5: Screw the top tube (D) to the middle tube (E).

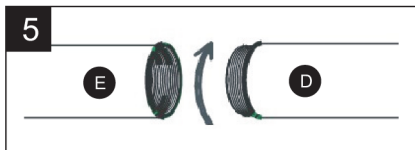

Step 6: Feed the power cord plug through the weighted base (B), bottom tube (F), middle tube (E) and top tube (D). Push the heater head (A) onto the top tube and secure using M 4 x 8 screws (BB).

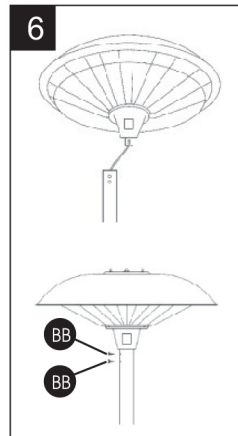

Hardware Used

BB M4×8 Screw ×2



ASSEMBLY INSTRUCTIONS

Step 7: Raise or retract the top tube to the desired height and fix it tightly with the middle tube (E) by screwing the knob down.

Hardware Used

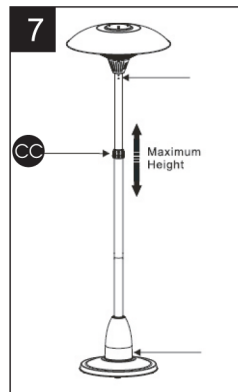
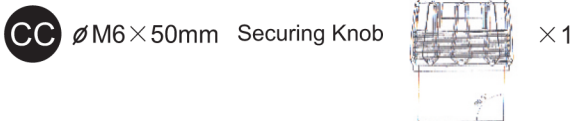

Step 8: Secure the power cord to the weighted base (B). Fix the power cord on the rubber base with four M4 Nut \times 4.

Hardware Used

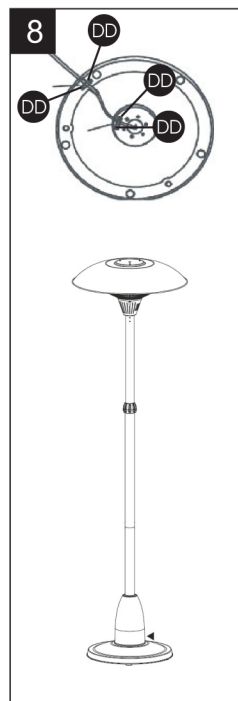

OPERATING INSTRUCTIONS

Place this unit on a firm, level surface and plug into a grounded 120V , 60 Hz power outlet. Only operate this unit when it is in the upright position and the base is attached. This unit is equipped with one heat setting , **On / Off**.

HEATER CONTROLS

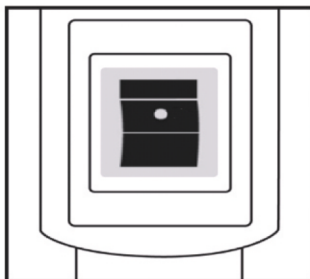

CARE AND MAINTENANCE

Unplug the unit and let it cool completely.

- To keep this unit clean, the outer shell may be cleaned with a soft, damp cloth. You may use a mild detergent if necessary. After cleaning, dry the unit with a soft cloth.
- DO NOT use alcohol, gasoline, abrasive powders, furniture polish, or rough brushes to clean the heater. This may cause damage or deterioration to the surface of the heater.
- Although this heater is outdoor approved, DO NOT immerse the heater in water for your safety.

Wait until the unit is completely dry before use.

TROUBLESHOOTING

PROBLEM	POSSIBLE CAUSE	CORRECTIVE ACTION
The unit does not operate properly	1.The power cord is not plugged into an electrical outlet 2.The power switches are not turned on	1.Plug in 2.Choose a setting

WARRANTY

RECEIPT REQUIRED FOR WARRANTY SERVICE.

This product is inspected, tested and carefully packaged to minimize the chance of damage during shipment. If a part (excluding light bulbs and fuses*) within one year from the date of purchase proves to be defective in material or fabrication under normal use, the part will be repaired or replaced. The Company's obligation under the warranty is to replace or repair defective parts at our discretion. Any expenses or damage resulting from the installation, removal or transportation of the product will be the responsibility of the owner and are not covered by this warranty. The owner assumes all other risks arising from the use or misuse of the product. The warranty will be void if the product damage or failure is deemed by the Company to be caused by accident, alteration, misuse, abuse, incorrect installation or removal, or connection to an incorrect power source by the owner. The Company neither assumes nor authorizes any person or entity to assume for it any obligation or liability associated with its products.

* Light bulbs and fuses are not covered under this warranty.

If you have any questions regarding the warranty or service, please call our toll free number: **1-888-775-1330**.

Printed in China