

Specification Sheet

Model: AWC242DPRG

WINE REFRIGERATOR



24-Inch Dual Zone Undercounter Wine Refrigerator, Panel-Ready Door

Features

- 45-bottle capacity built-in dual zone wine refrigerator
- White, blue and amber interior LED lighting options
- UV-resistant glass door with low-e, double-panes and argon gas between the two panes
- Touch panel with digital controls
- Wooden shelves with stainless steel trim
- Added security with a door lock
- Sabbath mode
- Energy Star Rated

Please note: Panel-ready appliances are designed to utilize custom panels to match your cabinetry. The panel-ready finish option does not include the pictured wood paneling.

Warranty

- One (1) year parts and labor
- Five (5) years compressor (part only)



Model Details

| Model | Voltage | Door Swing | Finish |
|--------------|---------|-------------|------------------|
| AWC242DPRGLH | 115V | Left Hinge | Panel-Ready Door |
| AWC242DPRGRH | 115V | Right Hinge | Panel-Ready Door |

Accessories

| Model | Description | Finish |
|------------|--|-----------------|
| PCWRFILTER | Replacement Carbon Filter | Gray |
| HDLPRO | PRO Style Handle for Undercounter Models | Stainless Steel |
| ADKP48SS | Dual Kickplate (intended for side-by-side installations of two 24" models) | Stainless Steel |



Exterior Dimensions

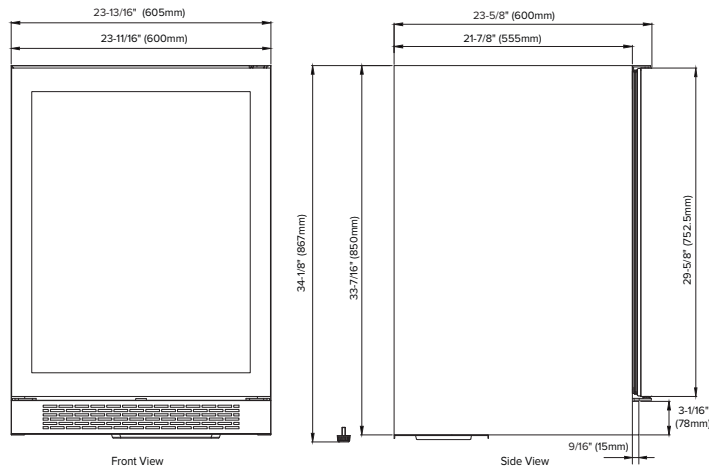

Interior Dimensions

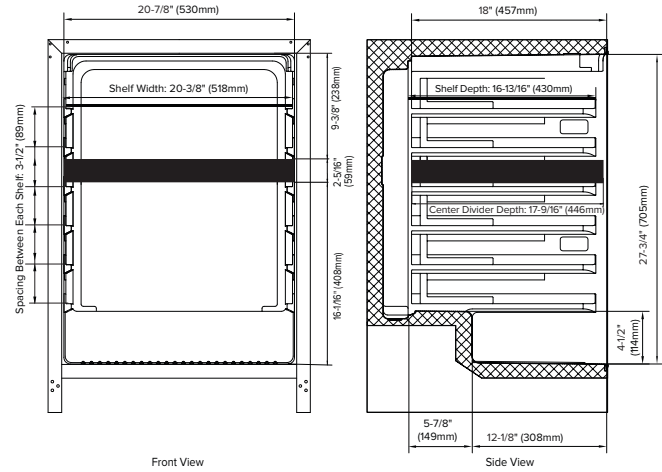

Door Swing

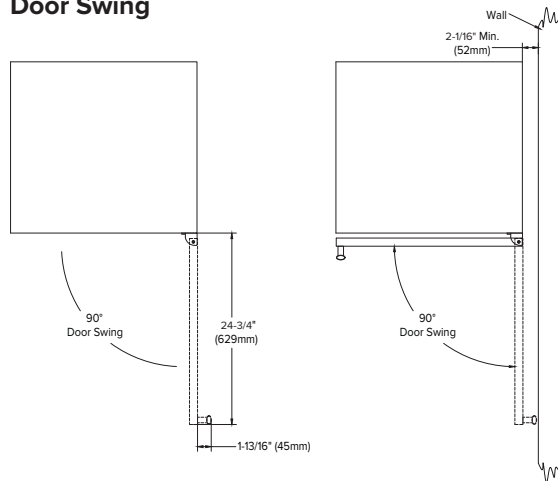

Specifications

| Model# | AWC242DPRG |
|---|----------------|
| Capacity (750 mL Wine Bottles) – Upper Zone | 15 |
| Capacity (750 mL Wine Bottles) – Lower Zone | 30 |
| Product Depth | 23-5/8" |
| Product Depth with Handle | 25-7/16" |
| Product Height | 34-1/8" |
| Product Width | 23-13/16" |
| Product Weight | 118 lbs |
| Refrigerant Type | R600a |
| Temperature Range | 40°F - 65°F |
| Power Cord Length | 6' |
| Amps | 1.5 |
| Electric Supply | 115 VAC, 60 Hz |

Cutout dimensions

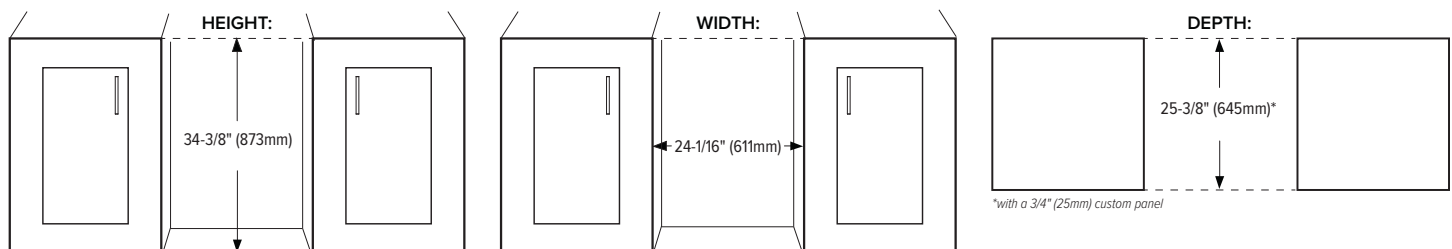

Note: Dimensions in parentheses are in millimeters. Specifications are subject to change without notice. Visit Avallon.com for the latest information.