

Specification Sheet

Model: AFR152SS

UNDERCOUNTER REFRIGERATOR



15-Inch Undercounter Refrigerator, Stainless Steel Door

Features

- 3.35 Cu Ft built-in low temp refrigerator
- White, blue and amber interior LED lighting options
- Stainless steel door
- Additional door storage
- Touch panel with digital controls
- Sanded tempered glass shelves
- Added security with a door lock
- Sabbath mode

Warranty

- One (1) year parts and labor
- Five (5) years compressor (part only)



Model Details

Model	Voltage	Door Swing	Finish
AFR152SSLH	115V	Left Hinge	Stainless Steel
AFR152SSRH	115V	Right Hinge	Stainless Steel

Accessories

Model	Description	Finish
PCWRFILTER	Replacement Carbon Filter	Gray



Exterior Dimensions

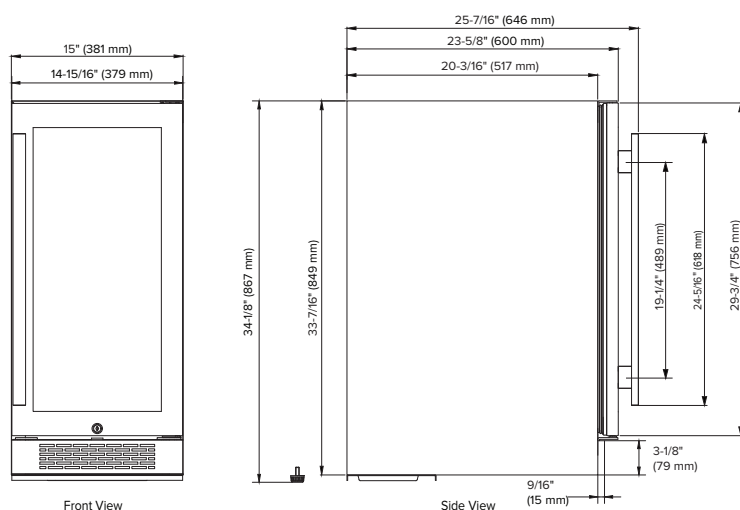

Interior Dimensions

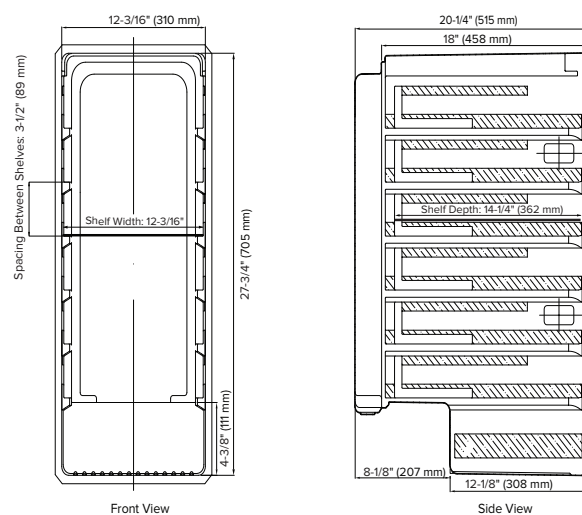

Door Swing

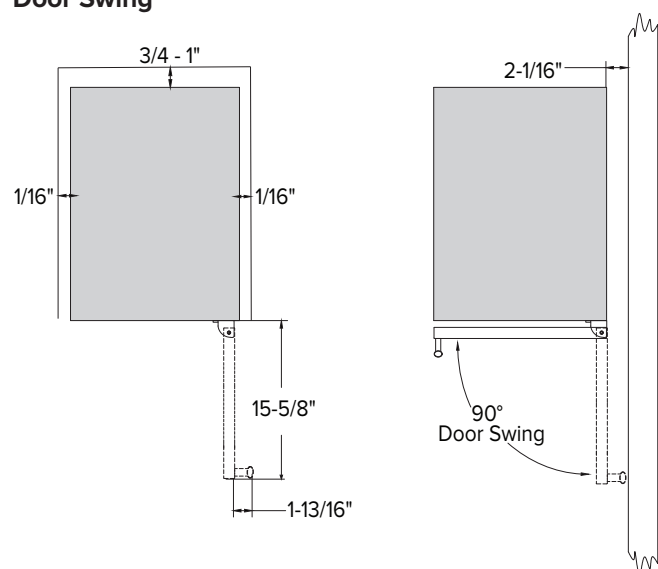

Specifications

Model#	AFR152SS
Capacity (Volume)	3.35 cu ft
Product Depth	23-5/8"
Product Depth with Handle	25-7/16"
Product Height	34-1/8"
Product Width	15"
Product Weight	72 lbs.
Refrigerant Type	R600a
Temperature Range	34°F - 65°F
Power Cord Length	6'
Amps	1.5
Electric Supply	115 VAC, 60 Hz



Cutout dimensions

