

FOR TECHNICAL SUPPORT CONTACT:

972-424-6900

[support@astonglobalinc.com](mailto:support@astonglobalinc.com)

[www.astonbath.com/support](http://www.astonbath.com/support)



## ASSEMBLY INSTRUCTIONS AND OWNER'S MANUAL

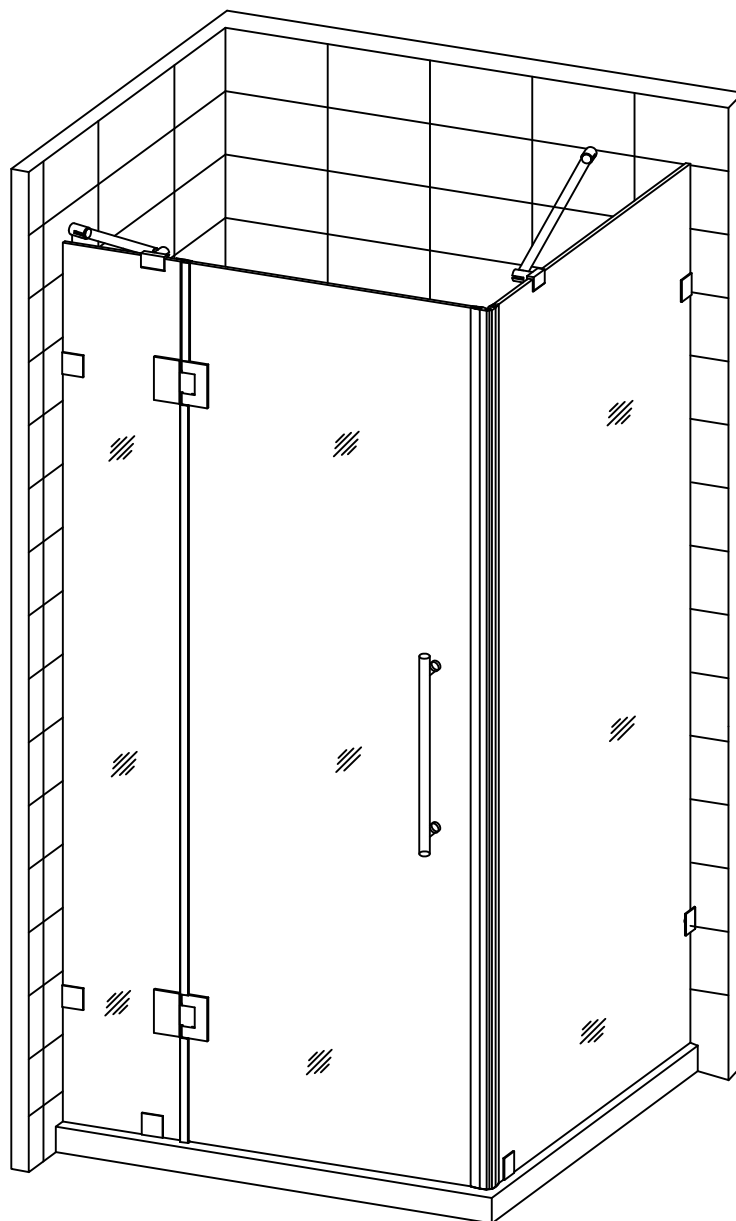

### AVALUX FRAMELESS SHOWER ENCLOSURE

**Model Number:**

**SEN987-BG-\*\*\*\*-10, SEN987-CH-\*\*\*\*-10, SEN987-MB-\*\*\*\*-10, SEN987-NBR-\*\*\*\*-10**

**SEN987-SS-\*\*\*\*-10, SEN987-ORB-\*\*\*\*-10**

\*\*\*\* indicates shower enclosure size

For more information about Aston Shower Doors, Enclosures & Tub Doors, please visit [astonbath.com](http://astonbath.com).

**02/24 REV A**



## READ THESE WARNINGS BEFORE PROCEEDING

- **IMPORTANT** - Inspect all glass panels, parts, and hardware for damage prior to installing. Do not proceed if damage is detected.
- **IMPORTANT** - Glass is very HEAVY. It is recommended that this door be installed by professionals with a minimum of two adults who are experienced in the process.
- **IMPORTANT** - Glass is manufactured TEMPERED for safety, which causes it to shatter into small but sharp pieces, rather than large dagger like shards that could cause greater damage.
- **IMPORTANT** - The weakest point on tempered glass is the corners. Keep the plastic corner protectors on until the glass is in place. Even the slightest bump could cause the glass to shatter.
- **IMPORTANT** - DO NOT install the handle until the door is fully mounted. Lifting the door by the handle will cause the door to shatter.
- **IMPORTANT** - ALL EDGE SEALS MUST BE FULLY INSTALLED properly before usage. Warranty will be voided otherwise.
- **IMPORTANT** - On Sliding Door models, the door stop bumpers must be installed securely and adjusted to the prescribed distance from the wall. Warranty will be voided otherwise.
- **IMPORTANT** - All hardware must be installed properly as per instruction. If the hardware is loose, the door's heavy glass will sag placing its panel corners in jeopardy. Alternatively, hardware that is overly tightened could put the door into stress.
- **IMPORTANT** - Once installed, treating the door by slamming it shut or throwing it open quickly could cause glass to shatter. Supervision should be provided for young children and the elderly.

# Before You Start

Thank you and congratulations on your purchase of a new Shower Door from Aston. We hope it will provide you and your home with years of satisfying functionality, usage and beauty.



Please read this manual carefully as it contains information and instructions about how to safely and properly install this unit. If you do not follow these certain conditions for assembly, installation, and maintenance, your warranty may be affected.

1. Inspect boxes for shipping damage. If the product has been damaged, has parts missing, or has a finish defect, please contact our customer support department within five business days of the delivery date.
2. NOTE: You should consult with your local building codes with any questions regarding installation compliance standards. Plumbing and building codes may vary by location.
3. Before installing, ensure that all installation surfaces are level, and have the strength to support the heavy weight of this shower door assembly. This shower door should only be installed to your existing wall studs, or with pre-installed two-by-six wood reinforcements behind finished walls.
4. This Shower Door assembly is very heavy and requires professional installation.

Aston Shower Doors feature:

- Thick Tempered Safety Glass
- High quality hardware

## **Certifications:**

All Aston shower doors are tested extensively by third parties to meet the following US, Canadian and International Standards:

- ANSI Z97.1-2015 CLASS A
- CPSC 16 CFR 1201 II
- CAN/CGSB 12.1-2017

REMEMBER TO REGISTER your new Aston Shower Door today: [astonbath.com/register](https://astonbath.com/register) to ensure proper service and activate warranties.

# Detailed Diagrams of Shower Enclosure Components

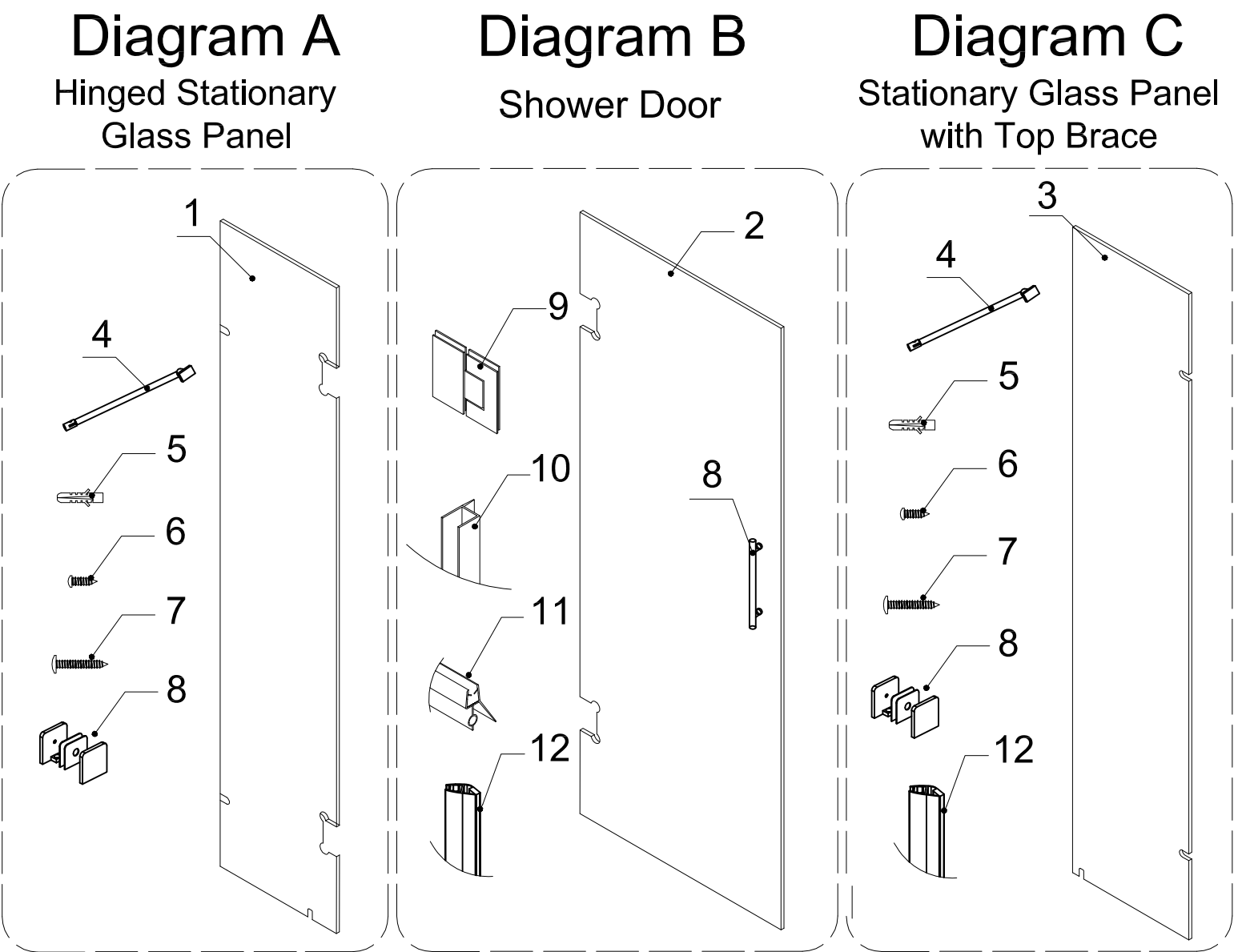

Diagram A

01	Hinged Stationary glass panel	1pc	06	M5 X 60 screw	1pcs
04	Support bar	1pc	07	M4 X 60 screw	3pcs
05	Wall anchor	4pcs	08	Glass clamp	3pcs

Diagram B

02	Glass door	1pc	10	Side strip (3 sections to cut)	1pc
08	Handle	1pc	11	Bottom anti-water strip	1pc
09	Hinge	2pcs	12	Magnetic strip	1pc

Diagram C

03	Stationary glass panel	1pc	07	M4 X60 screw	3pcs
04	Support bar	1pc	08	Glass clamp	3pcs
05	Wall anchor	4pcs	12	Magnetic strip	1pc
06	M5 X 60 screw	1pc			

PLEASE NOTE: During unpacking carefully inspect all parts and identify all parts using detailed diagram in your manual as a reference. Before discarding the packaging check for any parts or small hardware bags that may have been overlooked.

# Assembly and Installation Guide

Please read the following assembly and installation instructions and guidelines in this section.

Failure to follow the recommended instructions and installation techniques may lead to possible damage to the unit, the surrounding area, or can cause serious personal injury. This can affect warranty claims as well.

**ATTENTION:** This unit requires assembly. A minimum of two people are required for assembly and installation, as several of the components are large and unstable until fully assembled.

**You will need the following tools before proceeding:**

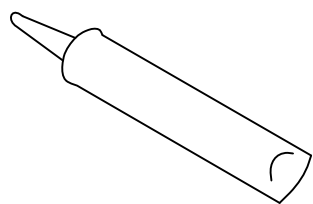

**Caulk**

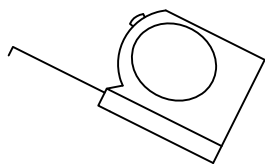

**Tape Measure**

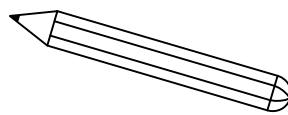

**Pencil**

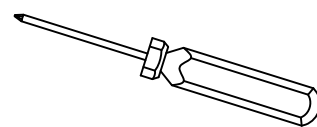

**Phillips Screwdriver**

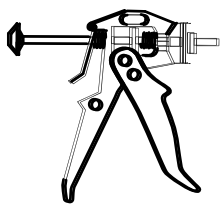

**Caulk Gun**



**Level**

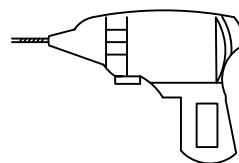

**Electric Drill**

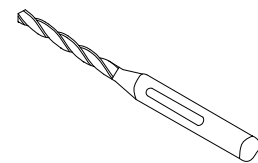

**Drill Bit ( $\varnothing 1/8"$  &  $5/16"$ )**

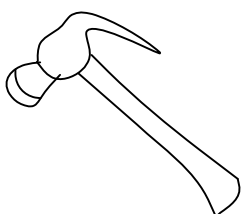

**Hammer**

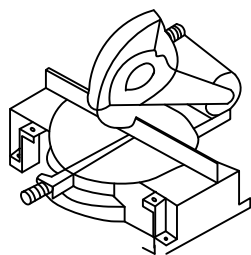

**Miter Saw or Hacksaw**

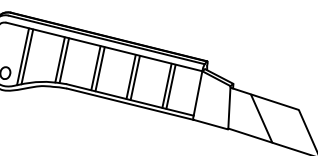
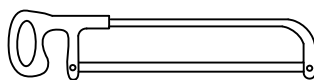

**Razor Knife**

Locate the accessory box and remove the individual parts and components, as well as the screw and hardware packages. Lay them out in sequential order to aid in the completion of the installation.

**NOTE:** DO NOT throw any packaging away until door is assembled. Door seals are sometime confused as packaging. Please locate them immediately and set them aside for later use.

# Shower Door Assembly and Installation



**WARNING: Could cause SERIOUS INJURY.** This glass is TEMPERED which causes it to shatter into small but sharp pieces, rather than large dagger like plates that could cause greater damage.



**WARNING: Could cause SERIOUS INJURY.** The weakest point on tempered glass is the corners. Keep the plastic corner protectors on until the glass is in place. Even the slightest bump could cause the glass to shatter.



**WARNING: Could cause SERIOUS INJURY.** Glass is very HEAVY. It is recommended that this door be installed by professionals with a minimum of two installers.

1. Measuring from the back corner in the shower, mark the shower wall for Stationary Glass Panels. Refer to the size of your model in the table below.

Model Number	W1
GLSP5010+GLSD1022	32"
GLSP5010+GLSD1023	33"
GLSP5010+GLSD1024	34 <sup>1</sup> / <sub>16</sub> "
GLSP5010+GLSD1025	35"
GLSP5010+GLSD1026	36"
GLSP5014+GLSD1023	37"
GLSP5014+GLSD1024	38"
GLSP5014+GLSD1025	39"
GLSP5014+GLSD1026	40"
GLSP5014+GLSD1027	41"
GLSP5014+GLSD1028	42 <sup>1</sup> / <sub>16</sub> "
GLSP5014+GLSD1029	43"
GLSP5014+GLSD1030	44"
GLSP5014+GLSD1031	45"
GLSP5014+GLSD1032	46"
GLSP5022+GLSD1025	47 <sup>1</sup> / <sub>16</sub> "
GLSP5022+GLSD1026	48"
GLSP5022+GLSD1027	49 <sup>1</sup> / <sub>16</sub> "
GLSP5022+GLSD1028	50 <sup>1</sup> / <sub>16</sub> "
GLSP5022+GLSD1029	51 <sup>1</sup> / <sub>16</sub> "
GLSP5022+GLSD1030	52 <sup>1</sup> / <sub>16</sub> "
GLSP5022+GLSD1031	53 <sup>1</sup> / <sub>16</sub> "
GLSP5022+GLSD1032	54 <sup>1</sup> / <sub>16</sub> "
GLSP5022+GLSD1033	55 <sup>1</sup> / <sub>16</sub> "
GLSP5022+GLSD1034	56 <sup>1</sup> / <sub>16</sub> "
GLSP5022+GLSD1035	57 <sup>1</sup> / <sub>16</sub> "
GLSP5022+GLSD1036	58 <sup>1</sup> / <sub>16</sub> "
GLSP5022+GLSD1038	60 <sup>1</sup> / <sub>16</sub> "

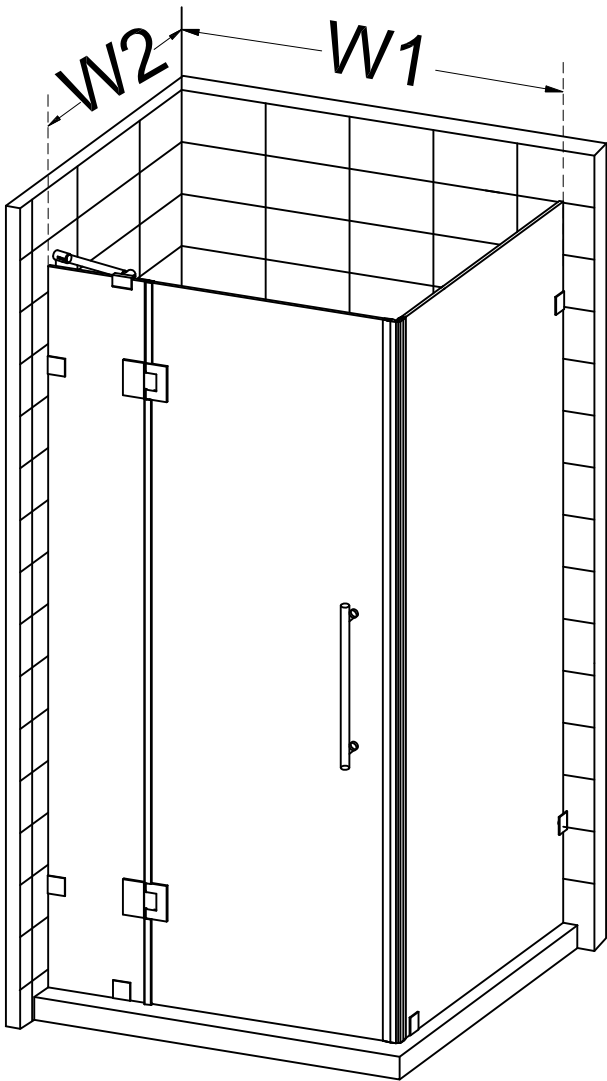

Figure 1

Model Number	W2
GLSP4030	30 <sup>3</sup> / <sub>16</sub> "
GLSP4032	32 <sup>1</sup> / <sub>8</sub> "
GLSP4034	34 <sup>3</sup> / <sub>16</sub> "
GLSP4036	36 <sup>3</sup> / <sub>16</sub> "
GLSP4038	38 <sup>3</sup> / <sub>16</sub> "

Note: This measurement is from the back corner in shower to the outside of glass

2. Remove pre-installed screws from pre-assembled Glass clamps (08).

Align the Glass Clamps (08) with notches in the Hinged Stationary glass (01) and install Glass clamps (08) to Stationary glass (01).

Noted: Smooth flat surface of Glass clamp (08) should be installed on outside of glass door.

See Figure 2 for details.

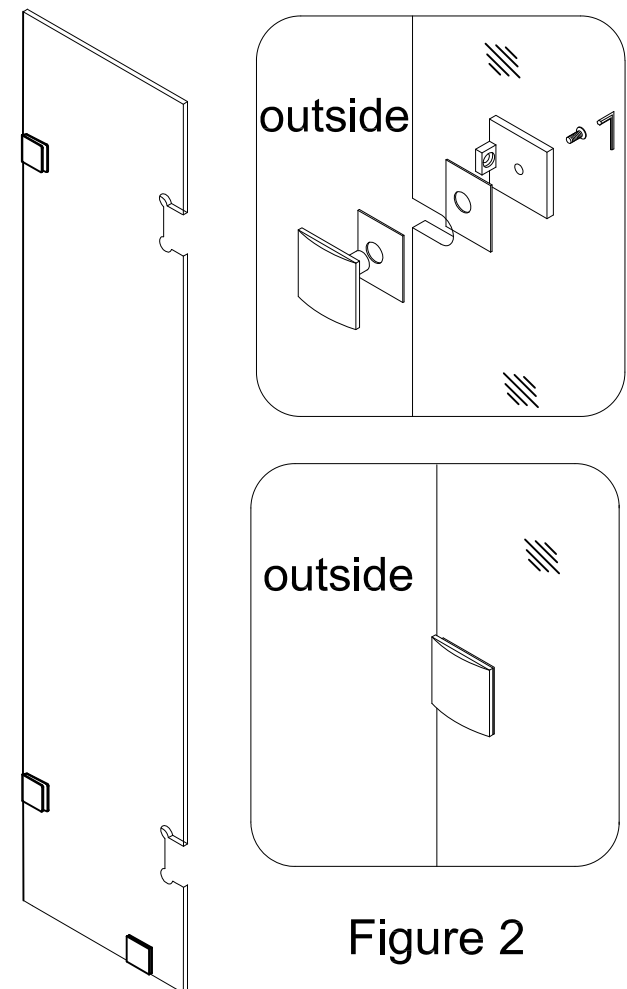

Figure 2

3. Remove pre-installed screws from pre-assembled Glass clamps (08).

Align the Glass Clamps (08) with notches in the Stationary glass (03) and install Glass clamps (08) to Stationary glass (03).

Noted: Smooth flat surface of Glass clamp (08) should be installed on outside of glass door.

See Figure 3 for details.

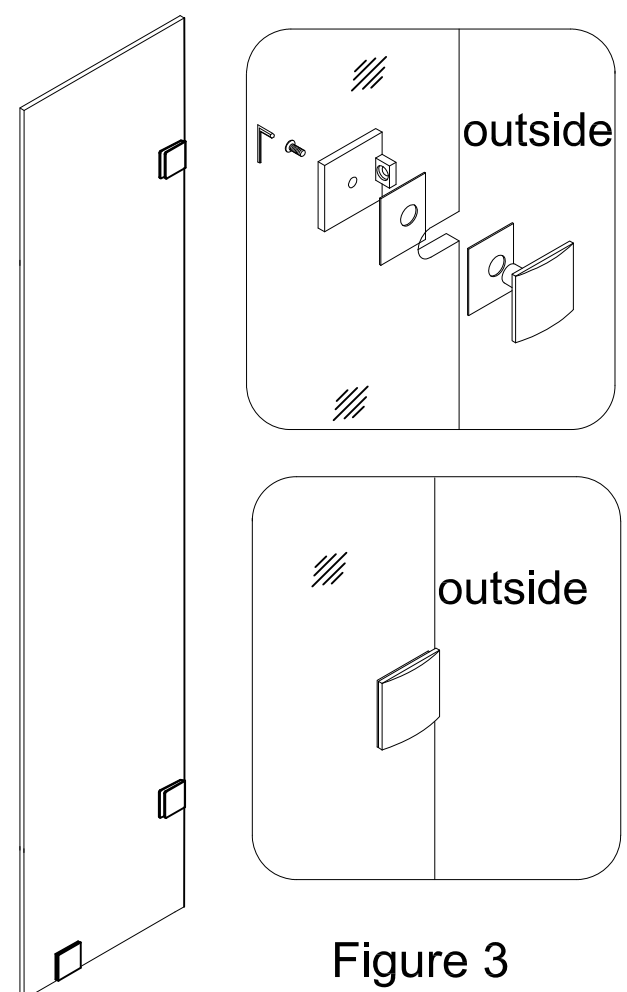

Figure 3

4. Carefully position the Stationary glass panels (01) and (03) against the shower wall aligning the outside edge of Stationary glass panels (01) and (03) with marked dimensions from earlier step. Check with level the plumb of Stationary glass panels (01) and (03).

Note: The Stationary glass panels (01) and (03) should be vertical and in plumb.

Note: The unit shown in figure 4 illustration is showing a left hand hinge assembly. If you need a right hand hinge assembly install the Hinged stationary glass panel to the right side of shower opening.

See Figure 4 for details.

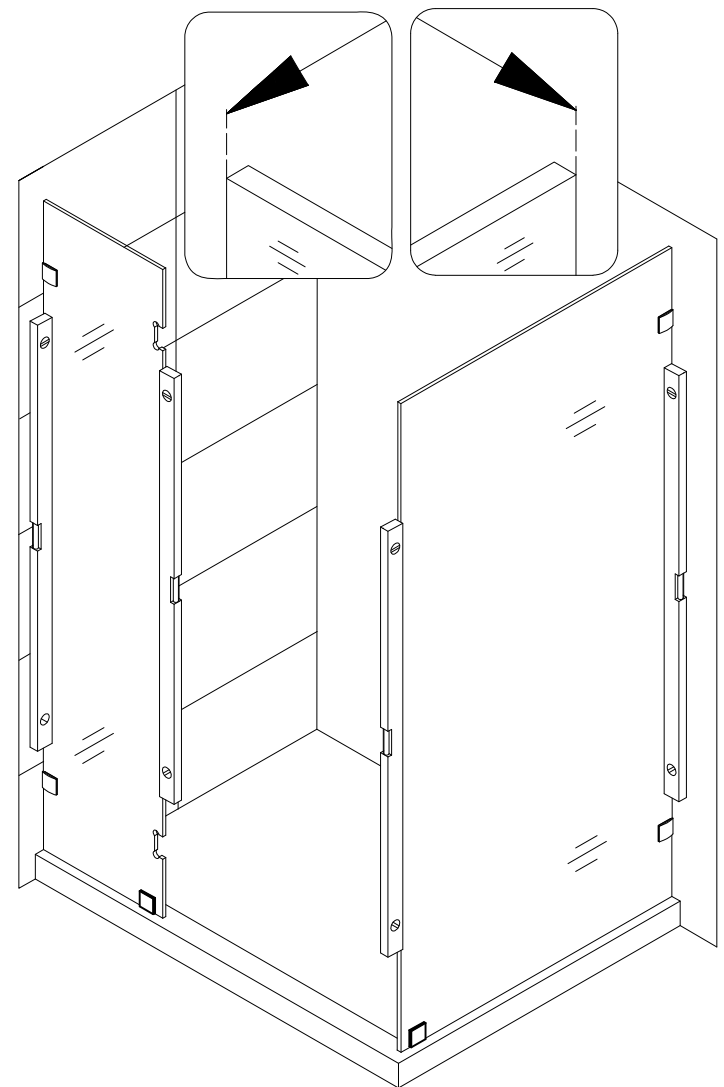

Figure 4

5. Mark the position of the the Glass clamps (08) on the shower wall and shower floor from the inside shower.

See Figure 5 for details.

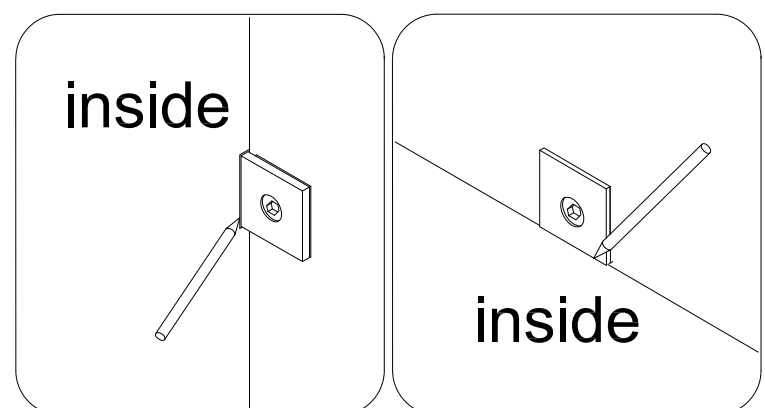

Figure 5

6. Carefully place the Stationary glass panels (01) and (03) aside.

Remove the Glass clamps (08) from the Stationary glass panels (01) and (03). Next position and align the Glass clamps (08) with marked location on shower wall and shower floor. Mark the drill hole locations for mounting the Glass clamps (08) to shower wall and shower floor.

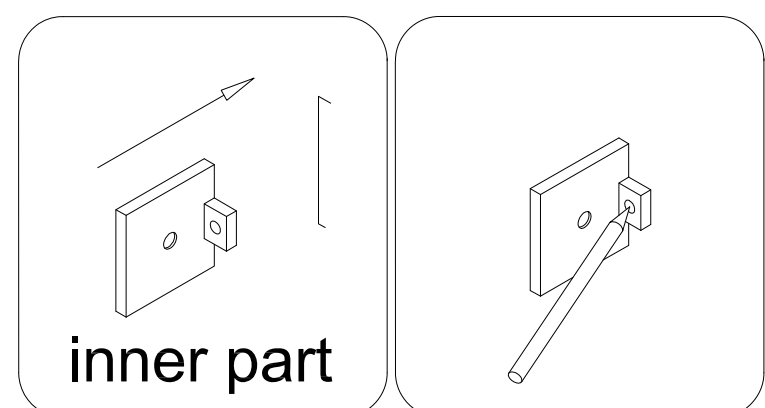

Figure 6

See Figure 6 for details.



7. Using the appropriate drill bit for your wall surface drill each hole location with a 5/16" diameter drill bit.

Using the appropriate drill bit for your floor surface drill hole location with an 1/8" diameter drill bit for shower base, use a 5/16" diameter drill bit for other surfaces and plastic wall anchor.

See Figure 7 for details.

NOTE: If your surface is prone to cracking or chipping then it is recommended that you pilot drill first using a smaller drill bit, and then step up to the final size.

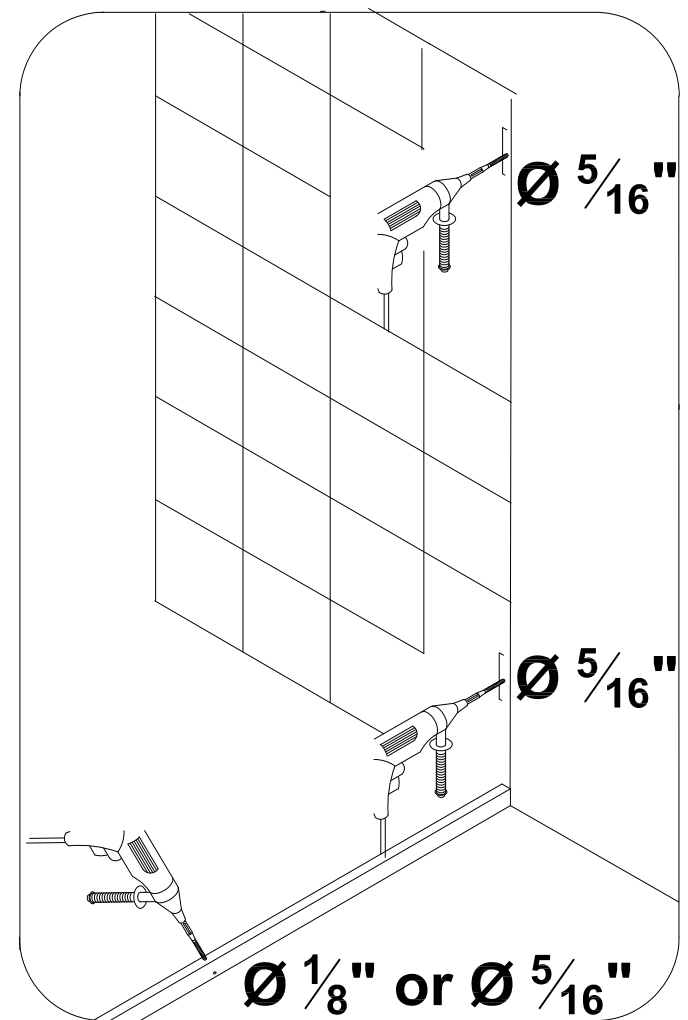

Figure 7

8. Install the plastic Wall anchors (05) provided into the drilled holes on wall.

See Figure 8 for details.

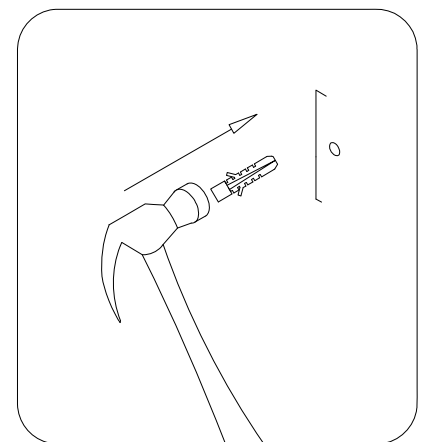

Figure 8

9. Attach the Glass Clamps (08) to shower wall and to shower floor using M4x60 screws.

The Glass clamps (08) should be positioned so that the single hole is facing toward the inside of shower.

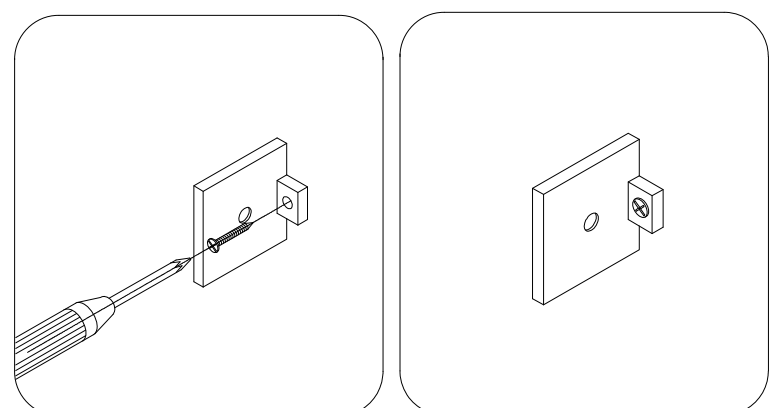

Figure 9

See Figure 9 for details.

10. Place the Hinge Stationary glass (01) into position in shower area and install glass clamps (08) to Hinge Stationary glass (01).

See Figure 10 for details.

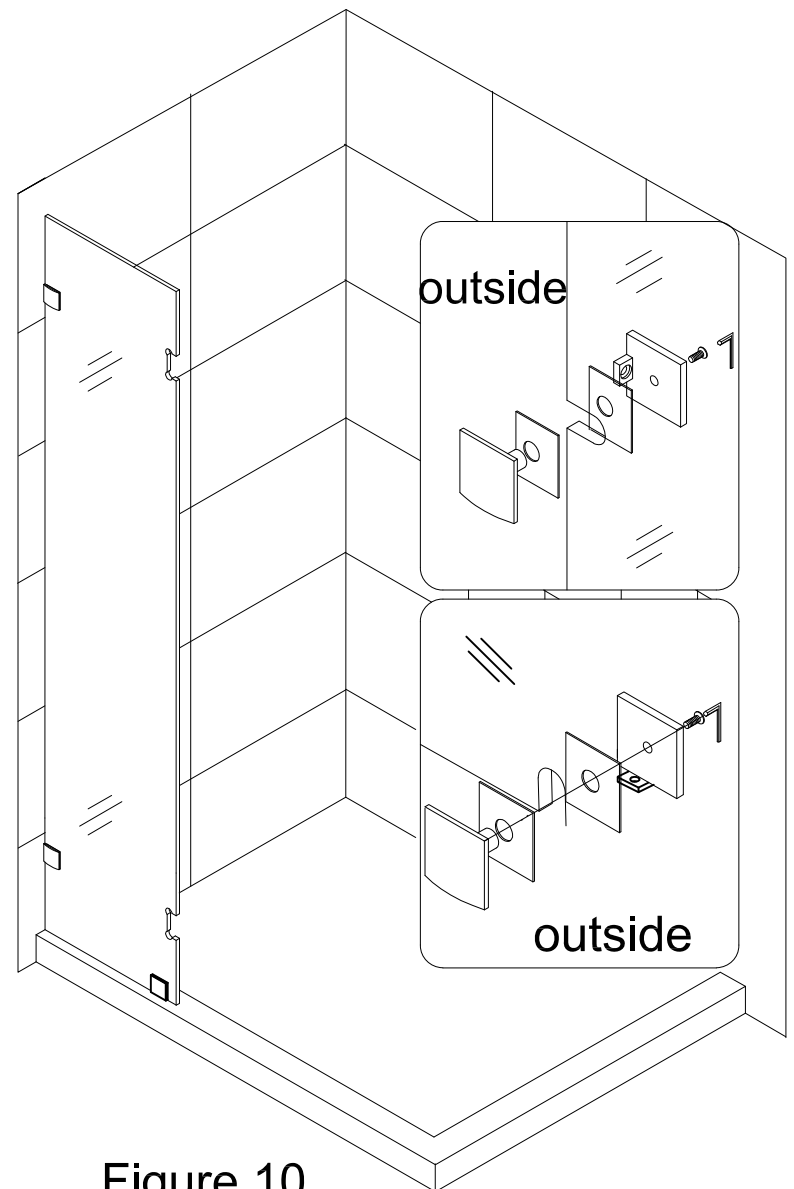

Figure 10

11. Place the Stationary glass (03) into position in shower area and install glass clamps (08) to Stationary glass (03).

See Figure 11 for details.

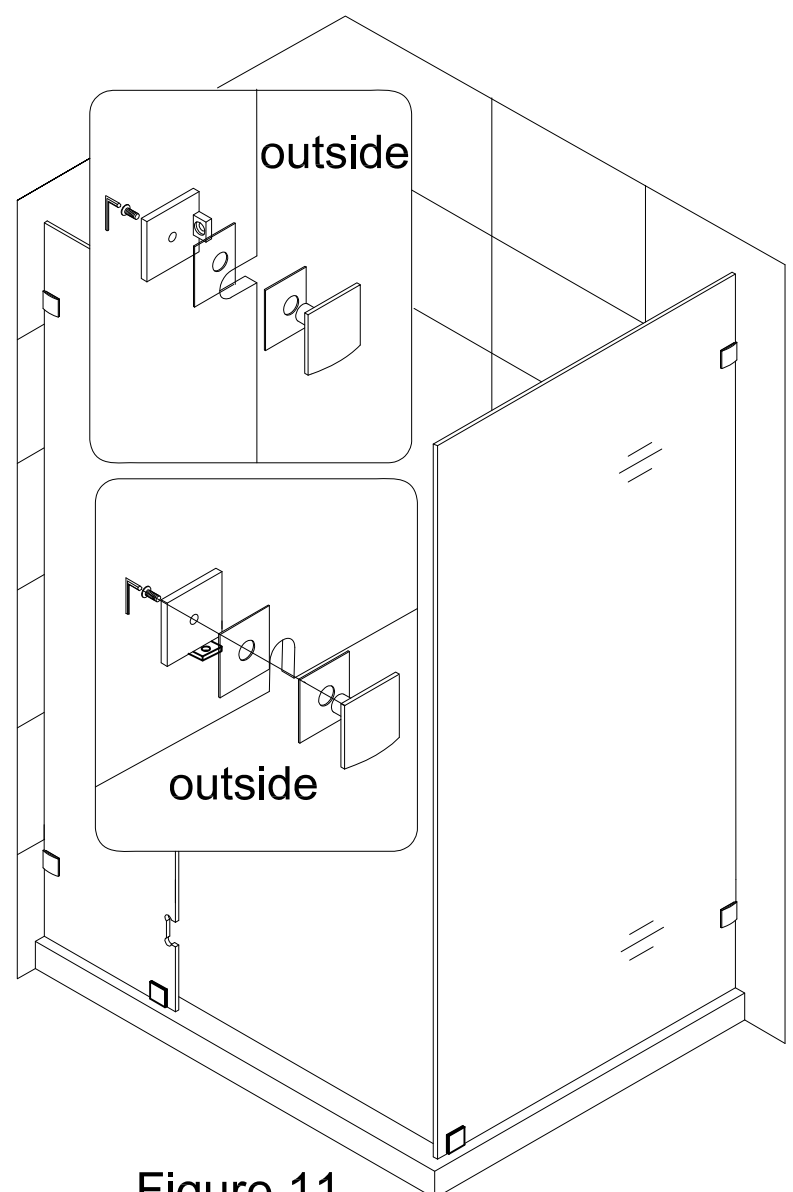

Figure 11

12. Press the Magnetic strips (12) onto the vertical edge of the Glass Door (02) and Stationary Glass Panel (03).

See Figure 12 for details.

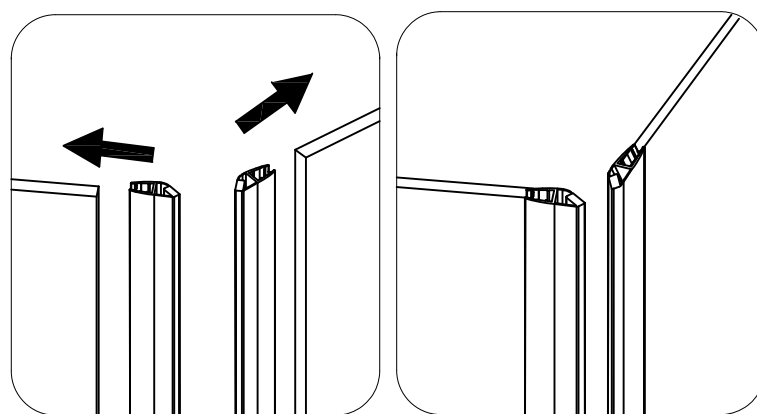

Figure 12

13. Attach the Hinges (09) to the Hinged stationary glass (01), Smooth flat surface of Hinges (09) should be installed on outside of stationary glass (01).

Place a piece of flat timber (1/2" thick) on the threshold or shower base.

Carefully position Glass door (02) on the flat timber and attach shower door to hinges.

Level up the Glass door next to the Hinged stationary glass and fasten the hinges on the Glass door.

If needed, adjust the position of the glass to make sure the Magnetic strips (12) are tight from top to bottom.

See Figure 13 for details.

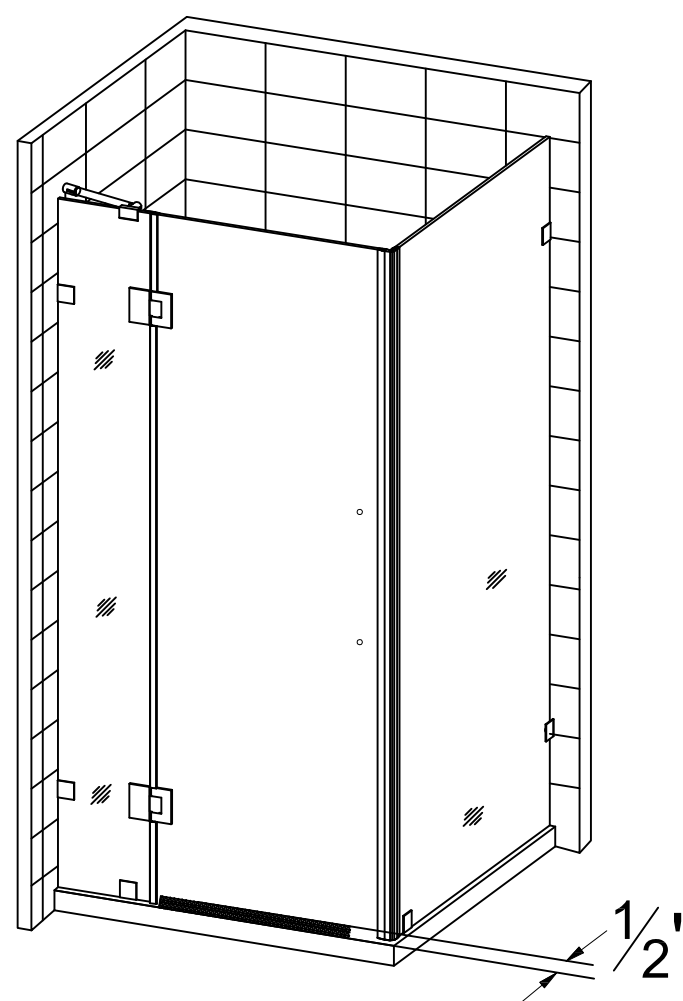
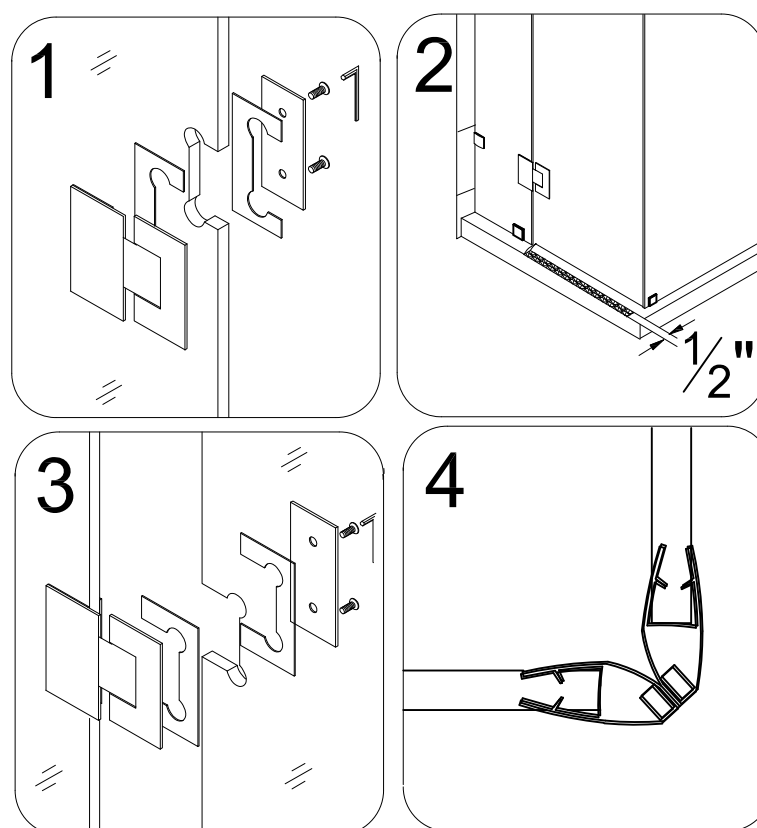

Figure 13

14. Marks on the Side Strip (10) at  $8\frac{1}{16}"$ ,  $48\frac{3}{8}"$  and  $8\frac{1}{2}"$ .

Carefully cut the seal at the appropriate marks, then install the individual seals on the appropriate sections of glass door:

- from the top edge of glass door to upper body of the top hinge:  $8\frac{1}{16}"$
- from the lower body of upper hinge to the upper body of the bottom hinge:  $48\frac{3}{8}"$
- from the lower body of bottom hinge to  $\frac{1}{16}"$  above the shower base:  $8\frac{1}{2}"$

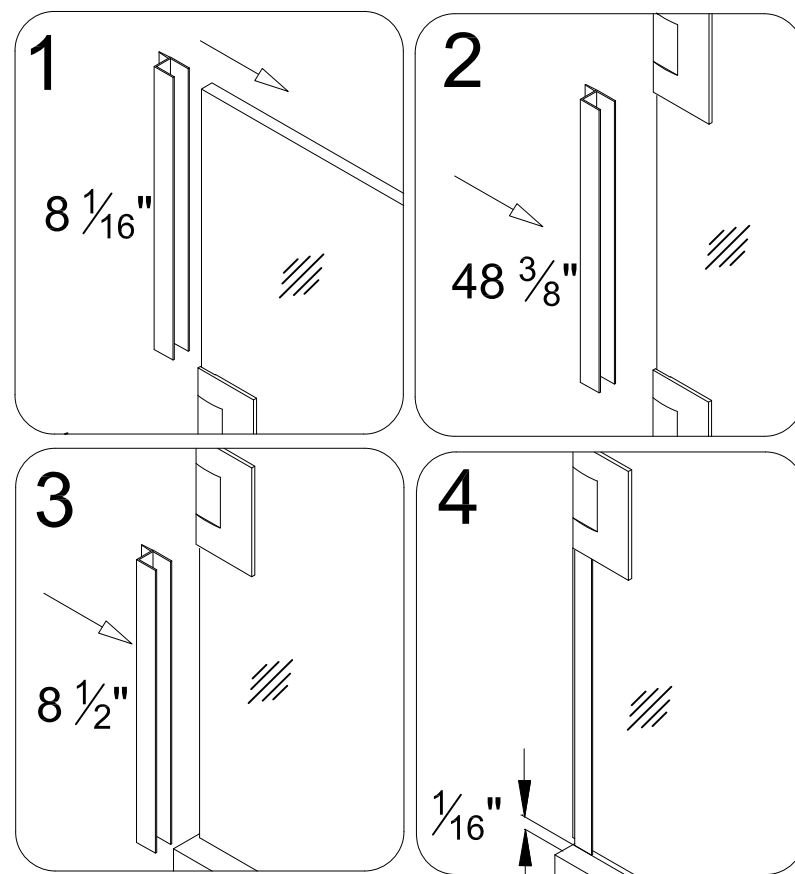

Figure 14

Remove the timber plate, fully open the glass door and press the cut strips on the vertical edge of the glass door.

See Figure 14 for details.

15. Measure the bottom of the Glass door (02) from the Side strip (10) to the vertical edge of Magnetic strip (12).

Cut the Bottom anti-water strip (11) to the size of measurement and press onto bottom edge of glass door.

See Figure 15 for details.

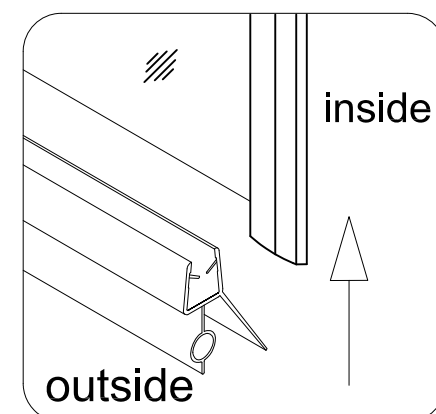

Figure 15

16. Install the Handle (08) to the Glass Door (02) using the hardware provided.

See Figure 16.

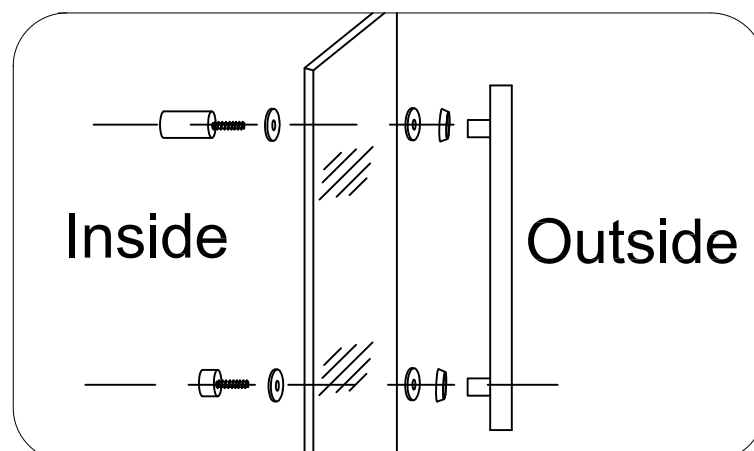

Figure 16

17. Position the Support bar (04) on the Hinged Stationary glass (01). Using a level, check support bar is level and mark the bracket's location on the shower wall.

Remove the Support bar (04) from the Hinged Stationary glass (01) and detach the wall bracket. Position the wall bracket to the marked area on shower wall and mark the drilling location on shower wall.

Drill the hole using 5/16" drill bit.

If your surface is prone to cracking or chipping then is recommended that you pilot drill first using a smaller drill bit, and then step up to the final size.

Insert the Wall anchor (05) and fasten the bracket to the wall with M5X60 screw (06).

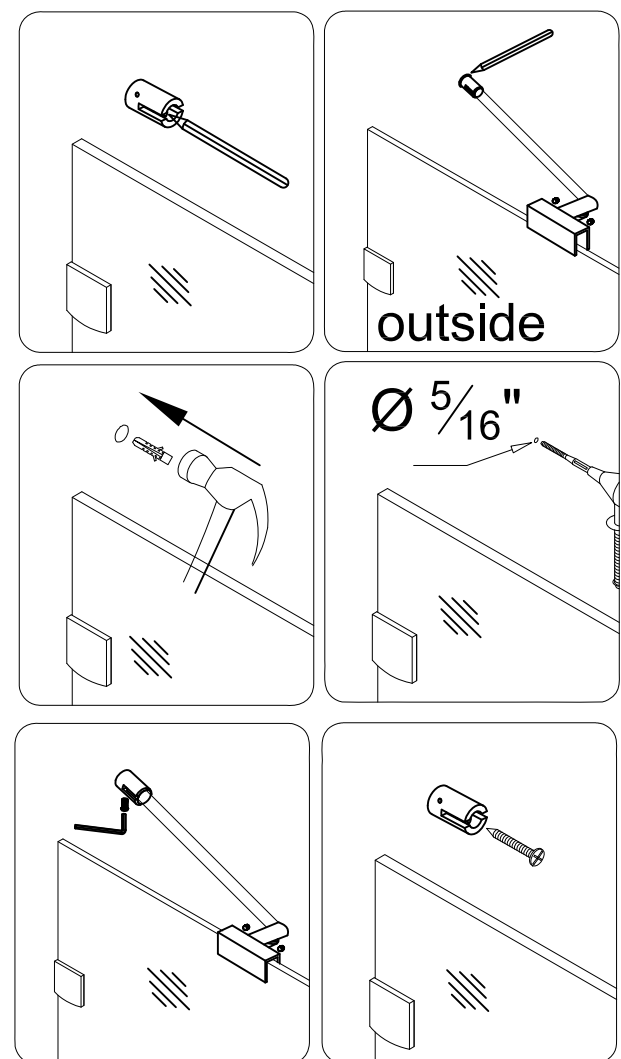

Figure 17

Attach the Support bar (04) to the wall bracket and the Hinged Stationary Glass (01) (with gasket in place) and tighten the set screws to secure in place. See Figure 17 for details.

18. Position the Support bar (04) on the Stationary glass (03). Using a level, check support bar is level and mark the bracket's location on the shower wall.

Remove the Support bar (04) from the Stationary glass (03) and detach the wall bracket. Position the wall bracket to the marked area on shower wall and mark the drilling location on shower wall.

Drill the hole using 5/16" drill bit.

If your surface is prone to cracking or chipping then is recommended that you pilot drill first using a smaller drill bit, and then step up to the final size.

Insert the Wall anchor (05) and fasten the bracket to the wall with M5X60 screw (06).

Attach the Support bar (04) to the wall bracket and the Stationary Glass (03) (with gasket in place) and tighten the set screws to secure in place. See Figure 18 for details.

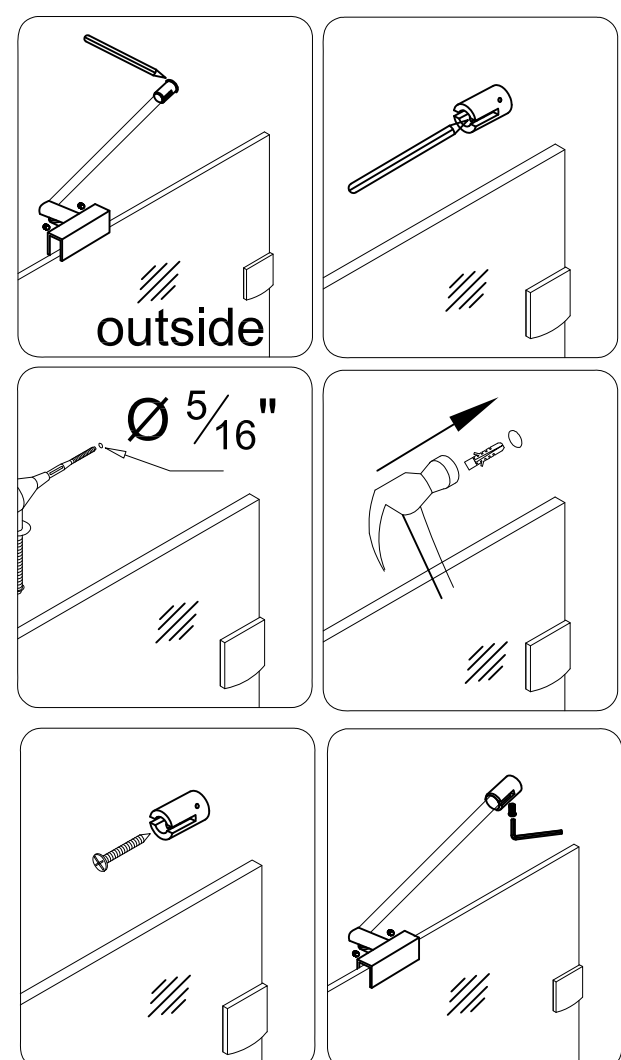
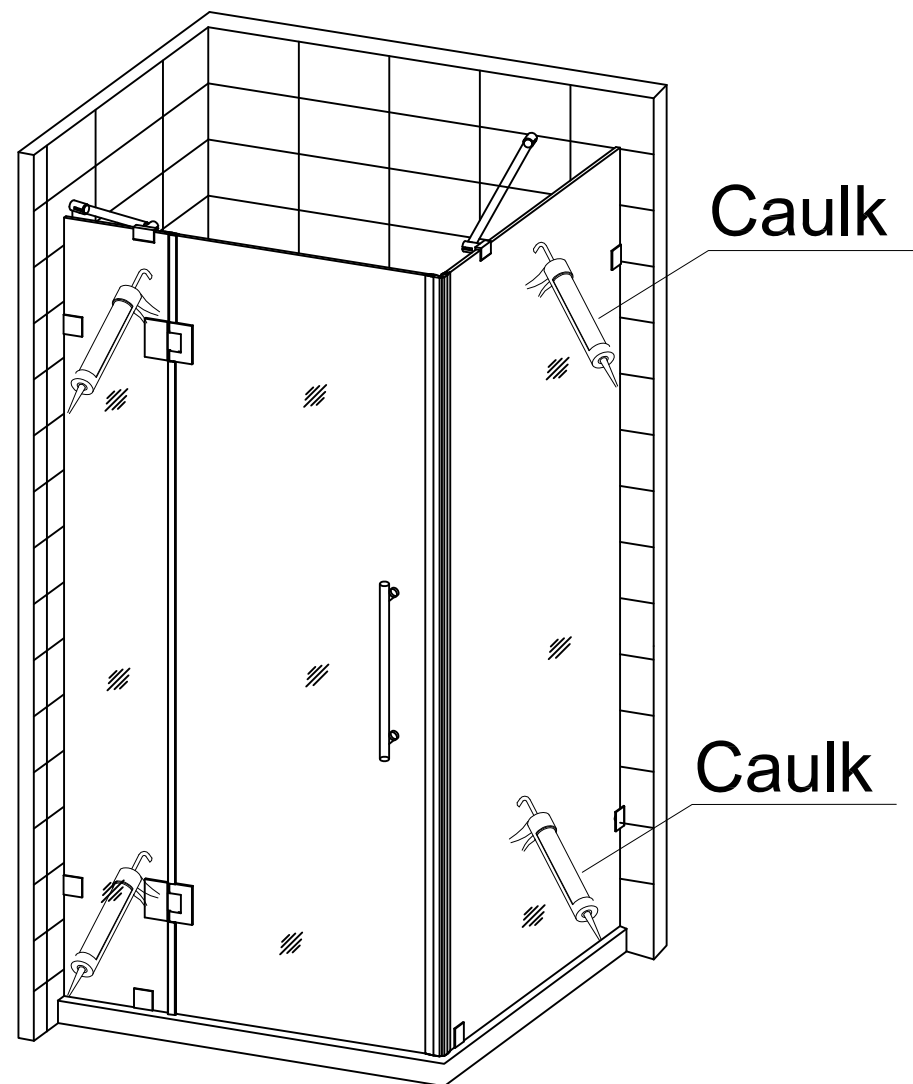

Figure 18

19. Apply silicone sealant to edge of Stationary glasses (01)/(03) and shower wall, and Stationary glasses (01)/(03) and shower base.

See Figure 19 for details.



# Care and Maintenance

As with any luxury item, maintenance and care are critical to the long-lasting quality and enjoyment of your shower door. The proper care and maintenance outlined in this section are necessary to ensure the longevity of the unit. Damage caused by not following the care and maintenance guidelines in this section is not covered under the manufacturer's warranty.

## Caring for your Hardware:

- The best way to maintain the beautiful finish on your shower's hardware is use a dry towel to thoroughly dry the hardware after every use. Hardware kept clean regularly will not collect mineral deposits and require the use of a cleansing solution.
- If a cleansing solution is required, use only a mild soap and warm water in small amounts, and gently clean with a non-abrasive cloth. After cleaning, rinse thoroughly with warm water and dry.
  - Important: many over-the-counter cleaners will harm the metal or powder-coat finish causing permanent damage even though their directions may indicate safe use. Additionally, never use a scouring agent to clean the metal or glass.
- Regularly inspect your hardware for loosening due to usage and home shifting. Inspect and tighten hinges, glass clamps, support bars, wall channels, rollers, door guides and any other associated hardware pieces.



**WARNING: Could cause SERIOUS INJURY.** All hardware must be installed properly as per instruction. If the hardware is loose, the door's heavy glass will sag placing its corners in jeopardy. Alternatively, hardware that is overly tightened could put the door into stress.

## Caring for your Glass:

- Keep your shower glass looking like new by rinsing down its panels and squeegee dry after every use. Towel dry any drops remaining the squeegee left behind.
- In areas where water has a high mineral content, dried water droplets could leave a deposit mark, including models with our StarCast coating. Mild acids, like white vinegar with warm water, will often remove the marks quickly with a soft sponge.
- Aston Frameless Showers are comprised of tempered safety glass. Be sure all edge seals are securely in place at all times, and NEVER allow the door to slam shut.
- Examine the glass periodically for cracks or chips; and pay special attention to its corners, edges and around the holes that accommodate screws or other hardware.

Models damaged by improper cleaning, installation and care are not covered under Aston's limited lifetime warranty.

# **ASTON GLOBAL INC.**

## **Limited Warranty**

“Limited Warranty”: Except as provided otherwise below, Aston Global Inc., a Texas Corporation ("Aston"), warrants its products to be free from defects in material and workmanship for a period of one year from the date of original purchase from Aston and/or from one of Aston's authorized retailers (the "Warranty Period"), subject to the following terms and conditions.

The Limited Warranty shall extend only to the original owner, and only to the original product and its components in their original, unaltered, condition, in the product's place of original installation. The Limited Warranty shall not be transferable to subsequent owners, or to anyone else. Aston reserves the right to modify this warranty at any time; however, any such modification shall not otherwise change the Limited Warranty. Further, the Limited Warranty shall be available only upon presentation by the original owner to Aston of the original sales receipt for the product.

This Limited Warranty does not cover, and specifically excludes coverage for, defects caused in whole or in part by alterations to the product and/or its components, either individually or as assembled, improper handling, improper assembly, improper installation, improper cleaning, improper maintenance, accidents, abuse, or misuse (foreseeable or otherwise), where “improper” shall mean “not in strict compliance with the product's Assembly Instructions and Owner's Manual.” Further, any modification or alteration to the product not specifically called for in the product's Assembly Instructions and Owner's Manual shall void the Limited Warranty. This Limited Warranty also does not cover, and specifically excludes coverage for, products used in any industrial, commercial, or business property, to include vacation or rental properties such as Airbnb, vrbo, and other properties used for substantially the same purposes. No person or entity other than Aston is authorized to make any affirmation, representation, or warranty other than those contained in this Limited Warranty; and any affirmation, representation, or warranty other than those expressly contained in this Limited Warranty shall not be enforceable against Aston. Except as otherwise expressly provided herein, Aston makes no warranties, expressed or implied, including warranties of merchantability and/or fitness for a particular purpose, or of a product's compliance with any code, either unassembled or as installed. Aston is not responsible for verifying building code restrictions on installation or use, and any such compliance is expressly excluded from this Limited Warranty.

To the fullest extent allowed by applicable law: this Limited Warranty does not cover, and Aston hereby expressly disclaims liability for, any special, incidental, or consequential damages. Such excluded damages shall include, but are not limited to, damages to property other than the product (e.g., tile, marble, etc.), and the costs of any labor (including removal and/or installation), transportation, shipping, storage, or delays occasioned in any way by defects that are otherwise covered by the Limited Warranty.



TO THE FULLEST EXTENT ALLOWED BY APPLICABLE LAW: THIS LIMITED WARRANTY IS IN LIEU OF ALL OTHER WARRANTIES, EXPRESSED OR IMPLIED, INCLUDING BUT NOT LIMITED TO THE IMPLIED WARRANTIES OF MERCHANTABILITY AND/OR FITNESS FOR A PARTICULAR PURPOSE; ASTON DISCLAIMS ALL LIABILITY FOR ANY SPECIAL, INCIDENTAL OR CONSEQUENTIAL DAMAGES OF ANY KIND WHATSOEVER; ASTON IS NOT LIABLE FOR DAMAGES FOR LOSS OF USE, LOSS OF TIME, LOSS OF PROFITS, INCONVENIENCE, OR FOR INCIDENTAL EXPENSES, LABOR OR MATERIAL CHARGES, OR ANY OTHER COSTS ARISING FROM ITS PRODUCTS, THEIR ASSEMBLY, INSTALLATION, OR USE, OR RESULTING FROM THE REMOVAL OR REPLACEMENT OF ANY PRODUCT OR COMPONENT COVERED BY THIS LIMITED WARRANTY.

TO AVOID ANY CONFUSION AS TO THE LIMITS OF THIS LIMITED WARRANTY: IN NO EVENT SHALL ASTON'S LIABILITY UNDER THIS LIMITED WARRANTY EXCEED THE ORIGINAL PURCHASE PRICE OF THE PRODUCT, AS REFLECTED IN THE ORIGINAL SALES RECEIPT PRESENTED TO ASTON BY THE ORIGINAL CUSTOMER.

Aston may fulfil the Limited Warranty by replacing the defective product or component, or, in Aston's sole discretion, refunding to the original customer the original price paid for the product or component, with shipping costs to be paid by the original customer. Aston's obligations under the Limited Warranty shall be fully discharged upon Aston's tender of a replacement for the defective product or its tender of a refund for such defective product. Any product replaced or repaired during the Warranty Period will be covered only for the remaining Warranty Period. Further, a refusal of such tender shall terminate and extinguish the Limited Warranty.

To make a claim under the Limited Warranty: The original customer must notify the Aston Customer Service Department within thirty (30) days of discovering the claimed defect by calling (877) 424-9699, emailing [support@astonglobalinc.com](mailto:support@astonglobalinc.com), or sending written notice to:

Aston Global, Inc.  
Attn: Customer Service Department  
902 Nicholson Rd., Suite 100  
Garland, TX 75042

Such notice must include a copy of the original sales receipt, identify the date the product was originally sold by Aston or its authorized retailer, and fully describe the nature of the claimed defect in material and/or workmanship. Aston may, in its sole discretion, request such additional information and/or documentation as Aston may require in order to evaluate the applicability of this Limited Warranty.



**Customer Service**  
**877-424-9699**

**Aston Global Inc**  
**902 Nicholson Rd Suite 100**  
**Garland, TX 75042**

If further assistance is needed , or you  
have a question, please visit our web  
site at:

**[www.astonbath.com](http://www.astonbath.com)**