

ASSEMBLY INSTRUCTIONS

ITEM DESCRIPTION:

| | |
|---|-------------------------|
| ITEM NO.: DWC51 | NAME: JAVIER SCONCE |
| MATERIAL TYPE: CRYSTAL | FINISH: CHAMPAGNE |
| SOCKET TYPE: E12 | SOCKET QTY: 2 |
| BULB WATTAGE: LED BULB ONLY 8W TYPE G45 | |
| VOLTAGE: 110V-120V | ITEM NET WEIGHT: 9.7LBS |

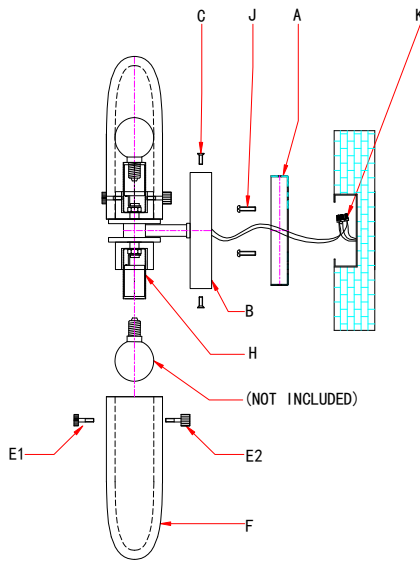

PARTS INCLUDED:

| | |
|---------------------------|-----------|
| Mounting Plate(A) | Qty: 1PC |
| Back Plate(B) | Qty: 1PC |
| Canopy Screw(C) | Qty: 2PCS |
| Thumb-screw (E1) | Qty: 2PCS |
| Thumb-screw (E2) | Qty: 2PCS |
| Crystal shade (F) | Qty: 2PCS |
| Socket(H) | Qty: 2PCS |
| Mounting Screw(J) | Qty: 2PCS |
| Plastic Wire Connector(K) | Qty: 3PCS |

HARDWARE INCLUDED:

| | |
|------------------------|-----------|
| Mounting Screws | Qty: 2PCS |
| Canopy Screws | Qty: 2PCS |
| Green Ground Screw | Qty: 1PC |
| Plastic Wire Connector | Qty: 3PCS |

TOOLS NEEDED (Not Included):

1 Screwdriver

These instructions are provided for safety. It is very important that they are read carefully and completely before beginning installation.

We strongly suggest that all hard-wired fixtures must be installed by a professional electrician.



TO ASSEMBLE:

1. Shut off the main electrical supply from the main fuse box/circuit breaker.
2. Carefully unpack all fixture parts and hardware and lay them on a soft surface for assembly.
3. Gently pull wiring down from junction box and allow to hang.
4. Remove mounting plate(A) from the back plate(B) by loosening the canopy screw (C) using a Phillips screwdriver.
5. Place the mounting plate(A) over the center of the junction box.
6. Align the holes in the mounting plate (A) with the holes in the junction box and secure it with two mounting screws (J). Secure the screws using a Phillips head screwdriver.
7. Connect ground wire from wall to ground wire from lamp using wire caps (K).
8. Attach house wire to lamp wires as shown. Fasten the pairs together with a wire caps
DO NOT REVERSE THE HOT AND NEUTRAL CONNECTIONS OR SAFETY WILL BE COMPROMISED.
9. Gently tuck the wire connections(K) neatly into the junction box.
10. Attach front face of light to back plate by inserting canopy screws (C) through predrilled holes in front face and into back plate as shown. Tighten using screwdriver.
11. Insert 2 LED 8W TYPE G45 bulbs (not included) into the socket(H). DO NOT EXCEED SPECIFIED MAX WATTAGE.
12. Place the crystal shade (F) on the lamp body and secure it with the thumb screws (E1, E2) as shown.
13. Restore power to junction box and test fixture.

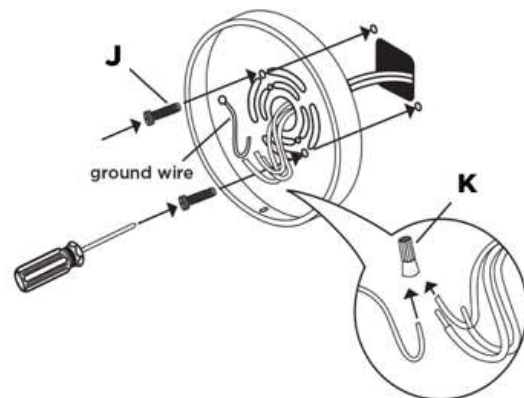

CARE INSTRUCTIONS:

Wipe with a soft, dry cloth. To protect finish, avoid the use of chemicals and household cleaners.