

ASSEMBLY INSTRUCTIONS

ITEM #DWC17 | Raine Sconce

ITEM DESCRIPTION

MATERIAL TYPE: STEEL /GLASS FINISH :ANTIQUE BRASS,SMOKE SLUMP SEEDY GLASS TOP COAT/SEALANT:
 SOCKET TYPE: E12 CERAMIC SOCKET QTY: 2
 BULB TYPE: TYPE B BULB WATTAGE: 60W or/CFL 13W or/LED 8W VOLTAGE:110V-120V
 ITEM NET WEIGHT:
 UL COMPLIANT
 INSTALLATION ENVIRONMENT:SUITABLE FOR DAMP LOCATIONS



NOTE:

*YOUR PRODUCT(S) MAY BE PACKED IN MORE THAN ONE CARTON
 *THIS ITEM MAY REQUIRE PERIODIC TIGHTENING

PARTS

A	MOUNTING PLATE	1 PC
B	BACK PLATE SCREW	2 PCS
C	LAMP BODY	1 PC
D	ANCHOR	2 PCS
E	STRENGTHENED SCREW	2 PCS
F	SOCKETS	2 PCS
G	BULB(NOT INCLUDED)	2 PCS
H	IRON RING	2 PCS
I	GLASS I	4PCS
L	GLASS L	5PCS
M	GLASS M	5PCS
N	GLASS N	3 PCS

INCLUDED ASSEMBLY HARDWARE

J mounting screws	K Plastic wire connectors
D anchor	E strengthened screw

PRODUCT ASSEMBLY

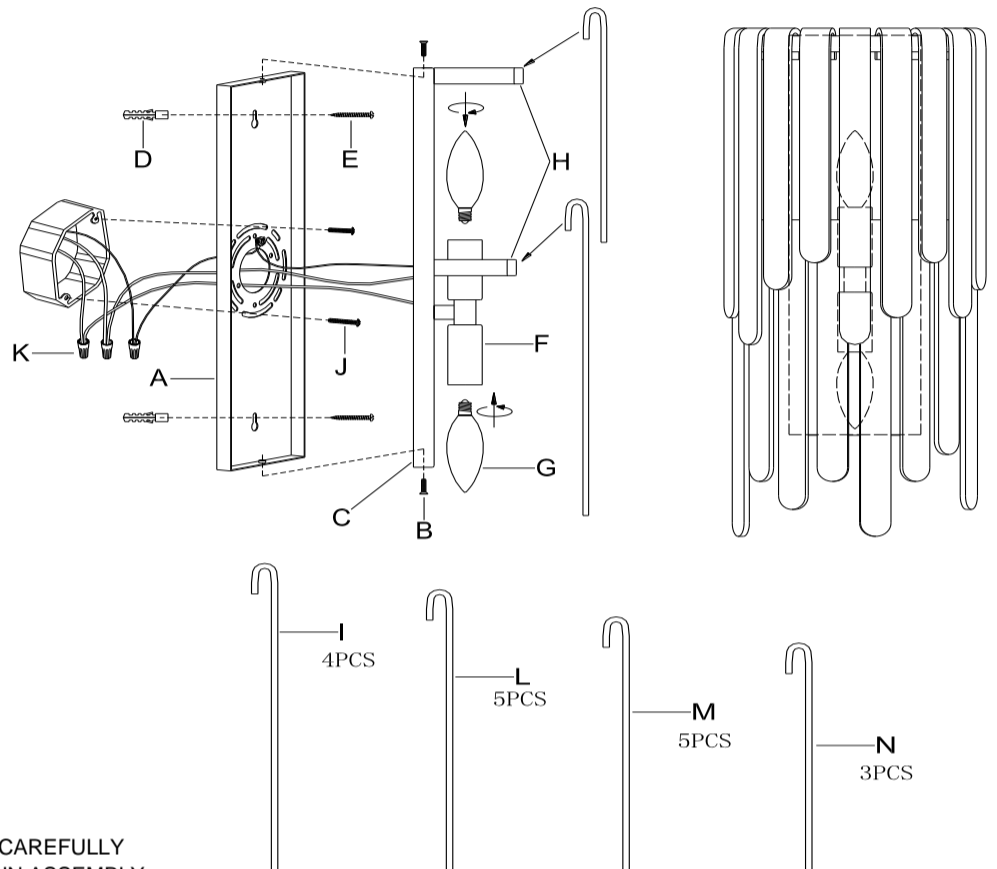

ASSEMBLY INSTRUCTIONS

- 1.REMOVE ALL PACKING CONTENTS AND PARTS FROM THE CARTON(S)CAREFULLY
- 2.PLEASE BE SURE YOU HAVE ALL PARTS INDICATED BEFORE YOU BEGIN ASSEMBLY
- 3.SHUT OFF THE MAIN ELECTRICAL SUPPLY FROM THE MAIN FUSE BOX/CIRCUIT BREAKER.
- 4.REMOVE THE MOUNTING PLATE (A) FROM THE LAMP BODY(C) BY TURNING BACK PLATE SCREWS(B) IN A ANTICLOCKWISE DIRECTION.
- 5.PULL THE ELECTRICAL CORD OF "J BOX"THROUGH THE EXIT HOLE OF THE MOUNTING PLATE(A)
- 6.CAREFULLY INSPECT THE FIXTURE WIRES. THE NEUTRAL FIXTURE WIRE HAS VERY FINE RIDEGS MOLDED INTO ITS PLASTIC COVERING. THE HOT FIXTURE WIRE HAS A SMOOTH COVERING.THE BARE WIRE IS THE GROUNDED WIRE.
7. ATTACH THE GROUND WIRE FROM THE FIXTURE TO THE GROUND JUNCTION BOX WIRE FROM THE OUTLET (USUALLY GREEN OR BARE WIRE). FASTEN EACH TOGETHER WITH A PLASTIC WIRE CONNECTOR (K) AND WRAP THE CONNECTION WITH ELECTRICAL TAPE. IF YOUR OUTLET BOX DOES NOT HAVE A GROUND WIRE, INSERT THE GREEN GROUND SCREW INTO THE MOUNTING PLATE (A) FACING DOWN, AND WRAP THE FIXTURE'S BARE GROUND WIRE AROUND THE GROUND SCREW. **IT IS IMPERATIVE THAT THE OUTLET BOX IN YOUR HOME BE PROPERLY GROUNDED.**
8. CONNECT THE NEUTRAL FIXTURE WIRE TO THE NEUTRAL JUNCTION BOX WIRE (USUALLY WHITE). FASTEN EACH TOGETHER WITH A WIRE CONNECTOR (K) AND WRAP THE CONNECTION WITH ELECTRICAL TAPE. BE SURE NO STRANDS ARE EXPOSED.
- 9.CONNECT THE HOT FIXTURE WIRE TO THE HOT JUNCTION BOX WIRE (USUALLY BLACK). FASTEN EACH TOGETHER WITH A PLASTIC WIRE CONNECTOR (K) AND WRAP THE CONNECTION WITH ELECTRICAL TAPE. BE SURE NO WIRE STRANDS ARE EXPOSED. **DO NOT REVERSE THE HOT AND NEUTRAL CONNECTIONS OR SAFETY WILL BE COMPROMISED.**
10. GENTLY TUCK THE WIRE CONNECTIONS NEATLY INTO THE JUNCTION BOX.
- 11.DRILL 2 HOLES IN WALL IN LINE WITH 2 HOLES OF MOUNTING PLATE(A), ATTACH THE MOUNTING PLATE (A) TO THE OUTLET BOX USING THE MOUNTING SCREWS (E) AND TIGHTEN WITH A SCREWDRIVER.THEN SCREW THE STRENGTHENED SCREWS (E) INTO THE ANCHORS TO SECURE THE MOUNTING PLATE(A).
 IF ATTACH TO CEMENT WALL, USE ANCHOR (D) FIRST THEN SCREW STRENGTHENED SCREWS(E)INTO THE ANCHOR
 IF ATTACH TO WOOD WALL,THREAD STRENGTHENED SCREW(E) DIRECTLY INTO WALL
- 12.ATTACH THE LAMP BODY(C) TO THE MOUNTING PLATE(A) BY USING THE ENCLOSED BACK PLATE SCREWS(B) AND TIGHTEN SCREWS WITH SCREWDRIVER.
- 13.INSERT 2 TYPE B 60W or/CFL 13W or/LED 8W BULB (NOT INCLUDED) (G) INTO THE SOCKETS(F).**DO NOT EXCEED SPECIFIED WATTAGE.**
- 14.PUT GLASS I (I), GLASS L (L) GLASS M (M) AND GLASS N (N) IN SEQUENCE ONTO IRON RING (H) CAREFULLY.
 THEN REPEAT THE SAME OPARETION ON THE OTHER GLASSES. ADJUST THE GLASS IN A COMFORTABLE SPACE.
- 15.RESTORE POWER TO THE JUNCTION BOX AND TEST FIXTURE.

CARE & MAINTENANCE

DUST WITH A DRY CLOTH.
 FOR CUSTOMER SERVICE QUESTIONS CALL 1.888.488.8866
 ARTERIORS HOME:972.488.9800
 ARTERIORS CONTRACT:972.488.9800 EXT.321

DISCLAIMERS

WE RECOMMEND THE INSTALLATION OF THIS ELECTICAL LIGHT FIXTURE TO BE DONE BY A LICENSED ELECTRICIAN.

ARTERIORS