

ASSEMBLY INSTRUCTIONS

ITEM # 49852 | **Omaha Sconce**

ITEM DESCRIPTION

MATERIAL TYPE: STEEL, GLASS FINISH :ORB + FROSTED GLASS TOP COAT/SEALANT:
 SOCKET TYPE: E12 CERAMIC SOCKET QTY: 1PC
 BULB TYPE:TYPE B BULB WATTAGE: 60W or /CFL 13W VOLTAGE:110V-120V
 ITEM NET WEIGHT:
 UL COMPLIANT
 INSTALLATION ENVIRONMENT:SUITABLE FOR DAMP LOCATIONS



NOTE:

*YOUR PRODUCT(S) MAY BE PACKED IN MORE THAN ONE CARTON
 *THIS ITEM MAY REQUIRE PERIODIC TIGHTENING

PARTS

A	MOUNTING PLATE	1 PC
B	BACKPLATE SCREWS	2 PCS
C	LAMP BODY	1 PC
D	FINIAL	1 PC
E	THUMB SCREW	3 PCS
F	SOCKET	1 PC
G	BULB(NOT INCLUDED)	1 PC
H	GLASS SHADE	1 PC

INCLUDED ASSEMBLY HARDWARE

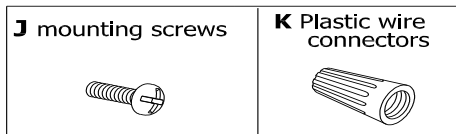

PRODUCT ASSEMBLY

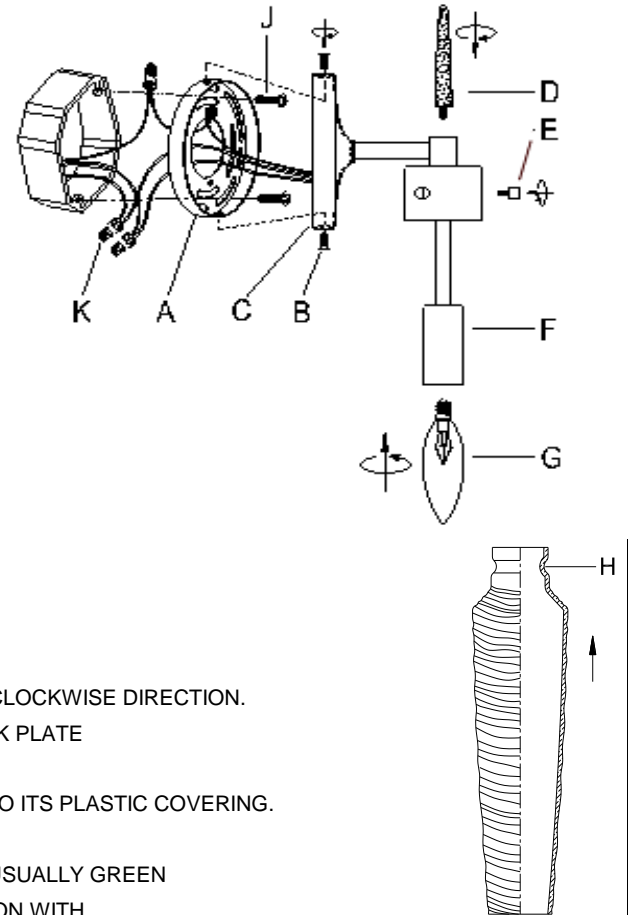

ASSEMBLY INSTRUCTIONS

- 1.REMOVE ALL PACKING CONTENTS AND PARTS FROM THE CARTON(S)CAREFULLY.
- 2.PLEASE BE SURE YOU HAVE ALL PARTS INDICATED BEFORE YOU BEGIN ASSEMBLY.
- 3.SHUT OFF THE MAIN ELECTRICAL SUPPLY FROM THE MAIN FUSE BOX/CIRCUIT BREAKER.
- 4.REMOVE THE MOUNTING PLATE (A) FROM THE LAMP BODY(C) BY TURNING BACKPLATE SCREW(B) IN A ANTICLOCKWISE DIRECTION.
- 5.GENTLY PULL THE ELECTRICAL CORD FROM JUNCTION BOX, THEN PULL THE ELECTRICAL CORD FROM BACK PLATE THROUGH THE EXIT HOLE OF THE MOUNTING PLATE(A).
- 6.CAREFULLY INSPECT THE FIXTURE WIRES. THE NEUTRAL FIXTURE WIRE HAS VERY FINE RIDEGS MOLDED INTO ITS PLASTIC COVERING. THE HOT FIXTURE WIRE HAS A SMOOTH COVERING.THE BARE WIRE IS THE GROUNDED WIRE.
- 7.ATTACH THE GROUND WIRE FROM THE FIXTURE TO THE GROUND JUNCTION BOX WIRE FROM THE OUTLET (USUALLY GREEN OR BARE WIRE). FASTEN EACH TOGETHER WITH A PLASTIC WIRE CONNECTOR (K) AND WRAP THE CONNECTION WITH ELECTRICAL TAPE. IF YOUR OUTLET BOX DOES NOT HAVE A GROUND WIRE, INSERT THE GREEN GROUND SCREW INTO THE MOUNTING PLATE (A) FACING DOWN, AND WRAP THE FIXTURE'S BARE GROUND WIRE AROUND THE GROUND SCREW. **IT IS IMPERATIVE THAT THE OUTLET BOX IN YOUR HOME BE PROPERLY GROUNDED.**
- 8.CONNECT THE NEUTRAL FIXTURE WIRE TO THE NEUTRAL JUNCTION BOX WIRE (USUALLY WHITE). FASTEN EACH TOGETHER WITH A WIRE CONNECTOR (K) AND WRAP THE CONNECTION WITH ELECTRICAL TAPE. BE SURE NO STRANDS ARE EXPOSED.
- 9.CONNECT THE HOT FIXTURE WIRE TO THE HOT JUNCTION BOX WIRE (USUALLY BLACK). FASTEN EACH TOGETHER WITH A PLASTIC WIRE CONNECTOR (K) AND WRAP THE CONNECTION WITH ELECTRICAL TAPE. BE SURE NO WIRE STRANDS ARE EXPOSED. **DO NOT REVERSE THE HOT AND NEUTRAL CONNECTIONS OR SAFETY WILL BE COMPROMISED.**
- 10.GENTLY TUCK THE WIRE CONNECTIONS NEATLY INTO THE JUNCTION BOX.
- 11.ATTACH THE MOUNTING PLATE (A) TO THE OUTLET BOX BY USING THE MOUNTING SCREWS(J).TIGHTEN SCREWS(J) WITH SCREWDRIVER.
- 12.ATTACH THE LAMP BODY(C) TO THE MOUNTING PLATE(A) BY USING THE ENCLOSED BACKPLATE SCREWS(B).TIGHTEN SCREWS(B) WITH SCREWDRIVER.
- 13.SCREW THE FINIAL (D) ONTO THE LAMP BODY (C) THEN TIGHT .
- 14.INSERT 1 TYPE B 60W or/CFL 13W or/LED 8W BULB (NOT INCLUDED)(G) INTO THE SOCKETS(F).
DO NOT EXCEED SPECIFIED WATTAGE.
- 15.ATTACH THE GLASS SHADE (H) ONTO THE LAMP BODY (C) ,AND THEN USE 3PCS THUMB SCREW(E) TO SECURE THE GLASS SHADE (H) .
- 16.RESTORE POWER TO THE JUNCTION BOX AND TEST FIXTURE.

CARE & MAINTENANCE

DUST WITH A DRY CLOTH.

FOR CUSTOMER SERVICE QUESTIONS CALL 1.888.488.8866

ARTERIOS HOME:972.488.9800

ARTERIOS CONTRACT:972.488.9800 EXT.321

DISCLAIMERS

WE RECOMMEND THE INSTALLATION OF THIS ELECTRICAL LIGHT FIXTURE TO BE DONE BY A LICENSED ELECTRICIAN.

ARTERIOS