

ASSEMBLY INSTRUCTIONS

ITEM # 49841 | Faceted Crystal LED Scone

ITEM DESCRIPTION

MATERIAL TYPE: STEEL.CRYSTAL FINISH :ANTIQUE BRASS +CRYSTAL TOP COAT/SEALANT:
 SOCKET TYPE: LED 3000K, CRI 90 SOCKET QTY: 1PC
 BULB TYPE: LED BULB WATTAGE: LED 7W (361LM) VOLTAGE:100V-130V
 ITEM NET WEIGHT:
 UL COMPLIANT
 INSTALLATION ENVIRONMENT:SUITABLE FOR DAMP LOCATIONS



NOTE:
 *YOUR PRODUCT(S) MAY BE PACKED IN MORE THAN ONE CARTON
 *THIS ITEM MAY REQUIRE PERIODIC TIGHTENING

PARTS

A	MOUNTING PLATE	1 PC
B	SCREWS	2 PCS
C	LAMP BODY	1 PC
D	CRYSTAL	1 PC
E	METAL PART	1 PC
H	BUTTERFLY NUT	2 PCS
M	METAL WASHER	2 PCS

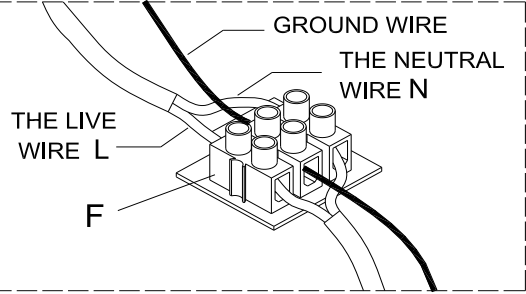

PLEASE IGNORE THIS DEVICE IN THE BACK PLATE

INCLUDED ASSEMBLY HARDWARE

I mounting screws 	K Plastic wire connectors
J Strengthen Screw 	L Anchor

ASSEMBLY INSTRUCTIONS

- 1.REMOVE ALL PACKING CONTENTS AND PARTS FROM THE CARTON(S)CAREFULLY
- 2.PLEASE BE SURE YOU HAVE ALL PARTS INDICATED BEFORE YOU BEGIN ASSEMBLY
- 3.SHUT OFF THE MAIN ELECTRICAL SUPPLY FROM THE MAIN FUSE BOX/CIRCUIT BREAKER.
- 4.PULL THE ELECTRICAL CORD FROM CANOPY THROUGH THE EXIT HOLE OF THE MOUNTING PLATE(A).
- 5.DRILL 2 HOLES IN WALL IN LINE WITH 2 HOLES OF MOUNTING PLATE(A),INSERT ANCHORS (L) INTO DRILLED HOLES.FASTEN MOUNTING PLATE(A) TO WALL BY SCREWING THE 2 STRENGTHEN SCREWS(J) PROVIDED IN THE ANCHORS(L).
- 6.**PLEASE PAY SPECIAL ATTENTION THAT YOU DO NOT NEED TO CONNECT THE TERMINAL BLOCK(F). IT IS USED FOR THE WIRE CONNECTION FOR EURO-MARKET.**
- 7.CAREFULLY INSPECT THE PENDANT'S FIXTURE WIRES. THE NEUTRAL FIXTURE WIRE HAS VERY FINE RIDEGS MOLDED INTO ITS PLASTIC COVERING. THE HOT FIXTURE WIRE HAS A SMOOTH COVERING.THE BARE SILVER WIRE IS THE GROUNDED WIRE
8. ATTACH THE GROUND WIRE FROM THE FIXTURE TO THE GROUND JUNCTION BOX WIRE FROM THE OUTLET (USUALLY GREEN OR BARE WIRE). FASTEN EACH TOGETHER WITH A PLASTIC WIRE CONNECTOR (K) AND WRAP THE CONNECTION WITH ELECTRICAL TAPE. IF YOUR OUTLET BOX DOES NOT HAVE A GROUND WIRE, INSERT THE GREEN GROUND SCREW(H) INTO THE MOUNTING PLATE (A) FACING DOWN, AND WRAP THE FIXTURE'S BARE GROUND WIRE AROUND THE GROUND SCREW. **IT IS IMPERATIVE THAT THE OUTLET BOX IN YOUR HOME BE PROPERLY GROUNDED.**
9. CONNECT THE NEUTRAL FIXTURE WIRE TO THE NEUTRAL JUNCTION BOX WIRE (USUALLY BLACK). FASTEN EACH TOGETHER WITH A WIRE CONNECTOR (K) AND WRAP THE.CONNECTION WITH ELECTRICAL TAPE. BE SURE NO STRANDS ARE EXPOSED.
- 10.CONNECT THE HOT FIXTURE WIRE TO THE HOT JUNCTION BOX WIRE (USUALLY RED). FASTEN EACH TOGETHER WITH A PLASTIC WIRE CONNECTOR (K) AND WRAP THE CONNECTION WITH ELECTRICAL TAPE. BE SURE NO WIRE STRANDS ARE EXPOSED. **DO NOT REVERSE THE HOT AND NEUTRAL CONNECTIONS OR SAFETY WILL BE COMPROMISED.**
11. GENTLY TUCK THE WIRE CONNECTIONS NEATLY INTO THE JUNCTION BOX.
- 12.ATTACH THE MOUNTING PLATE (A) TO THE OUTLET BOX BY USING THE MOUNTING SCREWS(I)AND TIGHTEN SCREWS WITH A SCREWDRIVER.
- 13.INSERT THE BOTTOM OF THE CRYSTAL(D) INTO THE METAL PART(E) AND INSERT THE SCREW OF THE METAL PART(E) INTO THE 2 HOLES ON THE LAMP BODY(C), THEN INSERT THE TOP OF THE CRYSTAL(D) INTO THE LMAP BODY(C). AT LAST, SECURE THE METAL PART(E) AND CRYSTAL(D) BY TURNING THE BUTTERFLY NUT(H) AND METAL WASHER(M) IN A CLOCKWISE DIRECTION.
- 14.ATTACH THE BACK PLATE TO THE MOUNTING PLATE(A) BY USING THE ENCLOSED 2PCS SCREWS (B) AND TIGHTEN SCREWS WITH A SCREWDRIVER.
- 15.RESTORE POWER TO THE JUNCTION BOX AND TEST FIXTURE.

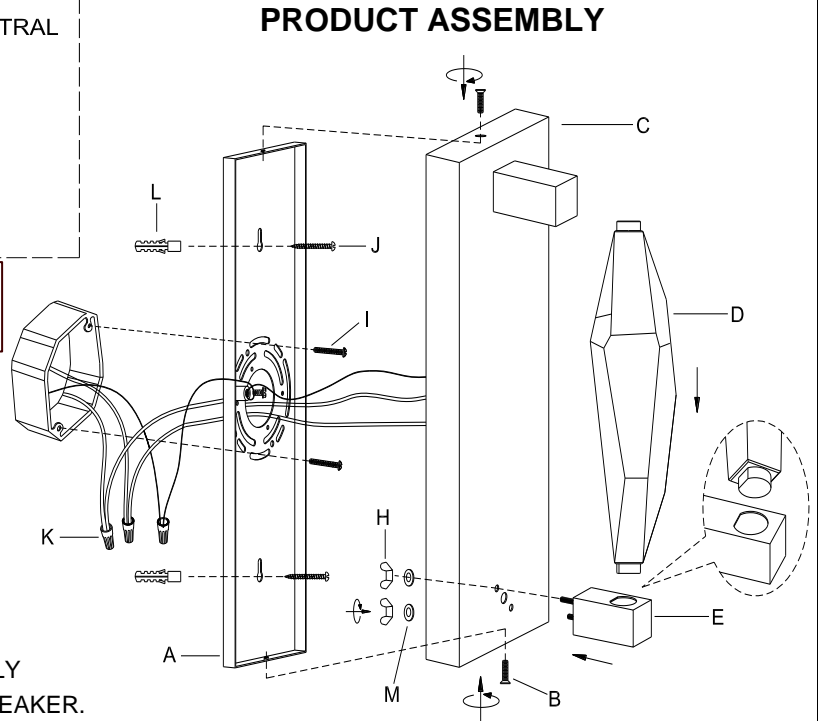

CARE & MAINTENANCE

DUST WITH A DRY CLOTH.

FOR CUSTOMER SERVICE QUESTIONS CALL 1.888.488.8866

ARTERIOS HOME:972.488.9800

ARTERIOS CONTRACT:972.488.9800 EXT.321

DISCLAIMERS

WE RECOMMEND THE INSTALLATION OF THIS ELECTRICAL LIGHT FIXTURE TO BE DONE BY A LICENSED ELECTRICIAN.

ARTERIOS