

**MODEL NUMBER:**

7105.224 - DOUBLE Towel Bar

**Available Finishes**

002	Polished Chrome
295	PVD Brushed Nickel
243	Matte Black

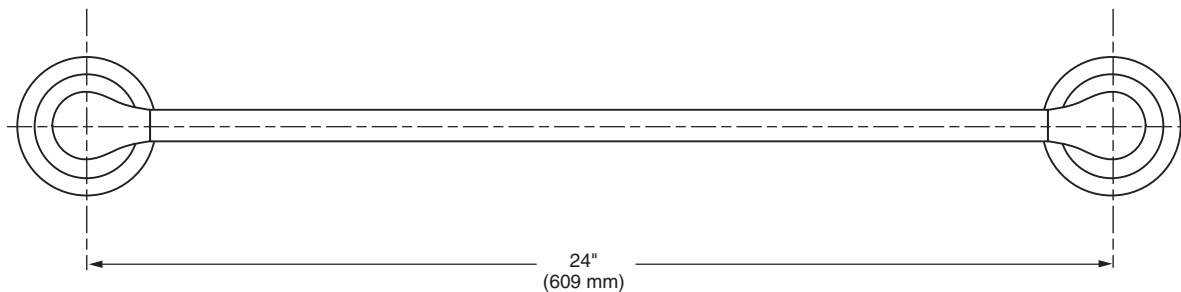
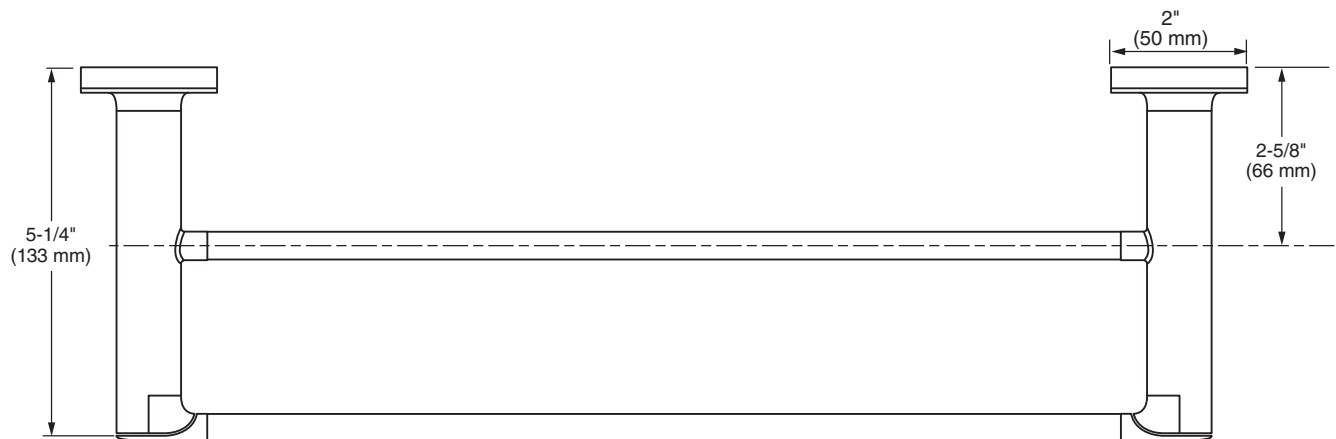

**PRODUCT FEATURES:**

**Materials of Construction:** Metal construction for durability & long life. Brass rod.

**Concealed Mounting:** No exposed set screws.

**Easy to Install**

**SUGGESTED SPECIFICATION**

24" Double Towel Bar shall feature metal construction. Rods shall be brass. Shall feature concealed mounting with no exposed set screws. Double Towel Bar shall be American Standard Model # 7105.224.\_\_\_\_.

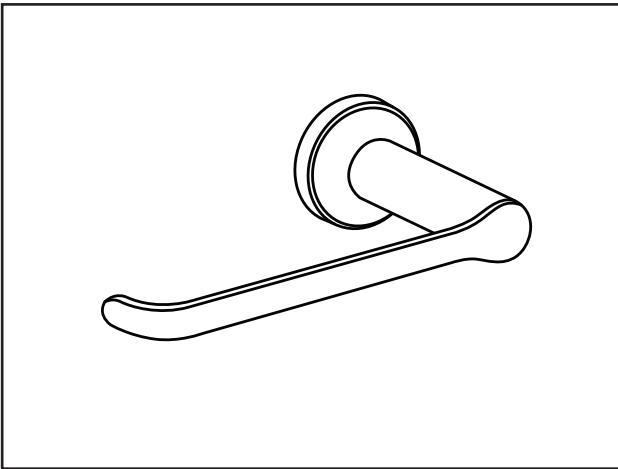

**MODEL NUMBER:**

□ **7105.230 - Toilet Paper Holder**

**Available Finishes**

002	Polished Chrome
295	PVD Brushed Nickel
243	Matte Black

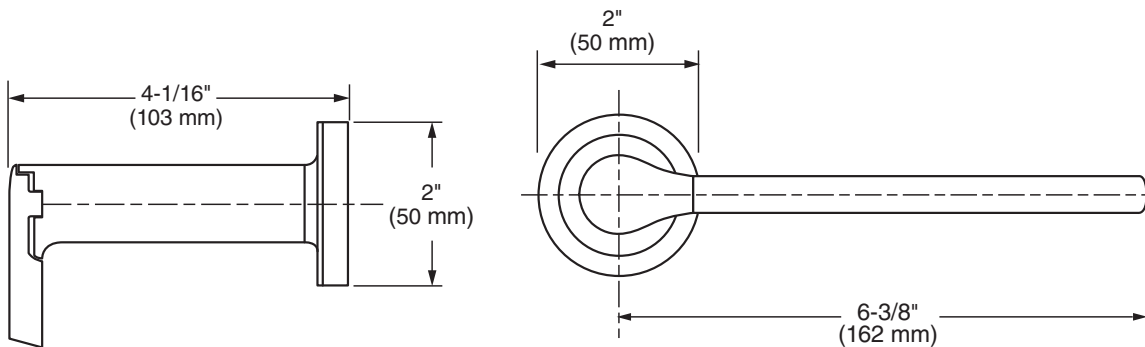

**PRODUCT FEATURES:**

**Materials of Construction:** Metal construction for durability & long life.

**Concealed Mounting:** No exposed set screws.

**Easy to Install**

**Easy to Use**

**SUGGESTED SPECIFICATION**

Toilet Paper Holder shall feature metal construction. Shall feature concealed mounting with no exposed set screws.  
Toilet Paper Holder shall be American Standard Model # 7105.230.\_\_\_\_.

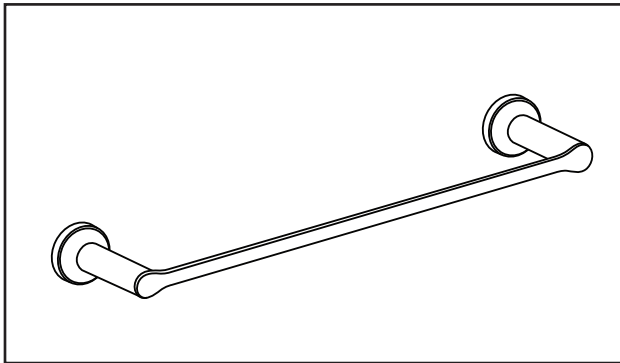

**MODEL NUMBER:**

- ❑ 7105.018 - 18" Towel Bar
- ❑ 7105.024 - 24" Towel Bar

**Available Finishes**

002	Polished Chrome
295	PVD Brushed Nickel
243	Matte Black

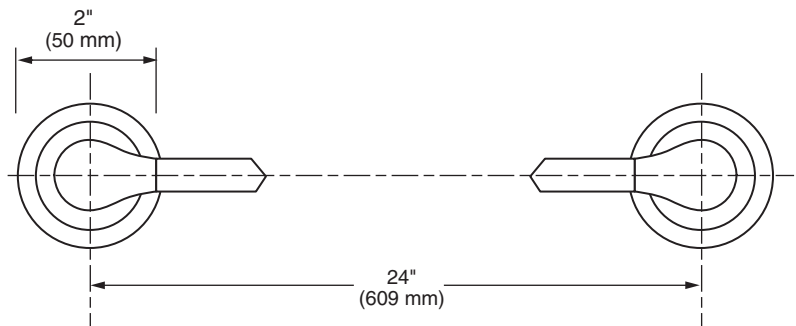
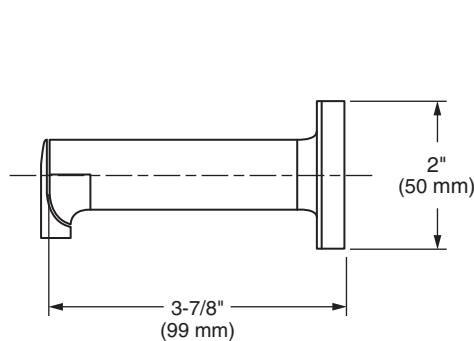
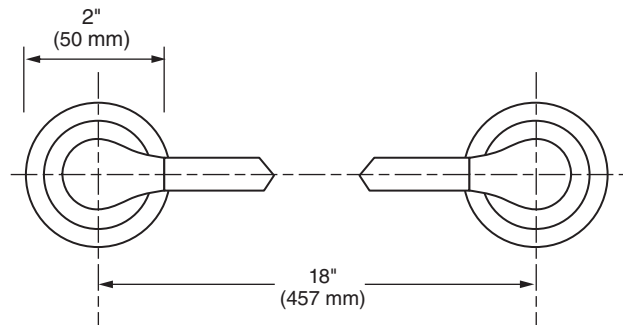
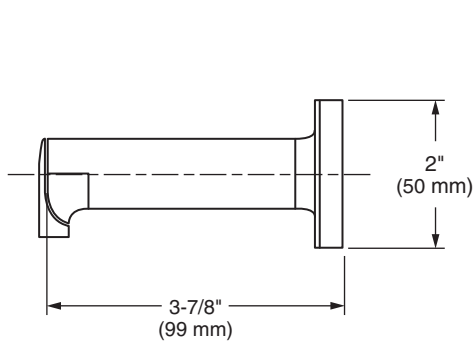

**PRODUCT FEATURES:**

**Materials of Construction:** Metal construction for durability & long life. Brass rod.

**Concealed Mounting:** No exposed set screws.

**Easy to Install**

**SUGGESTED SPECIFICATION**

18" and 24" Towel Bar shall feature metal construction. Rod shall be brass. Shall feature concealed mounting with no exposed set screws. Towel Bar shall be American Standard Model # 7105.\_\_\_\_.\_\_\_\_.