

INSTALLATION INSTRUCTIONS CARE AND MAINTENANCE



VORMAX PLUS TOILET SEAT AND FRESHINFUSER PACKAGE

Before You Start:

Before installing your toilet, please see your product spec page to verify the dimensions and water supply connections. Visit our website where you can search by Model number for the product spec page at:

<http://www.americanstandard-us.com/>

For Assistance Call Customer Care at: (800) 442-1902

NOTE: These instructions are specifically for installing the VorMax Plus seat and FreshInfuser package only. Refer to the appropriate VorMax toilet installation manual packed inside the tank for the toilet installation.

VORMAX PLUS TOILET SEAT AND FRESHINFUSER PACKAGE

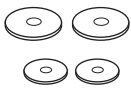

Washers (4)



Long Bolts (2)



Nuts (2)



Rubber Grommets (2)

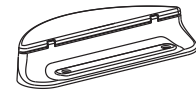

Base Plate Housing

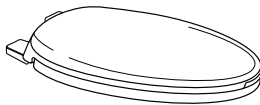

Toilet Seat



VorMax Plus
FreshInfuser™
2 Packs



Base Plate

IMPORTANT: Do not connect the water supply line until you have completed the VorMax Plus seat and FreshInfuser Installation procedure.

S
A
V
E
F
O
R
F
U
T
U
R
E

TANK

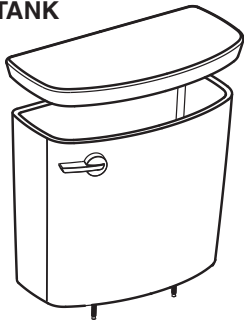

VorMax Toilet Installation Instructions:

See separate installation document located in tank package.

EZ-INSTALL KIT INCLUDED WITH TANK



Attachment Handle



Nuts (3)

EZ-INSTALL INLET VALVE COUPLING KIT



BOWL



EZ-INSTALL KIT INCLUDED WITH BOWL

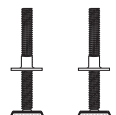

T-Bolts with Retainer (2)



Bolt Caps (2)



Bowl-To-Floor Knobs (2)

SOLD SEPARATELY

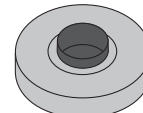

Wax Ring



Water Supply Line

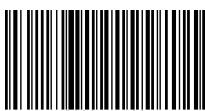

Product names listed herein are trademarks of AS America, Inc.
© AS America, Inc. 2017



CAUTION: IF A VORMAX PLUS FRESHINFUSER IS NOT SECURELY INSERTED INTO THE SPUD OPENING, **DO NOT FLUSH THE TOILET** AS THIS MAY RESULT IN WATER LEAKING FROM THE TOILET. TOILET MUST HAVE A VORMAX PLUS FRESHINFUSER INSERTED IN THE SPUD OPENING AT ALL TIMES WHEN FLUSHING THE TOILET.

For further assistance please call Customer Care at: (800) 442-1902

1

Assembly of Housing Base Plate

Read carefully then remove CAUTION sticker (1) next to spud (2) from rear of bowl.

Insert rubber grommets (3) (narrow end first) up underneath the bowl and into each seat mounting hole. Ensure grommets stay in place in bowl.

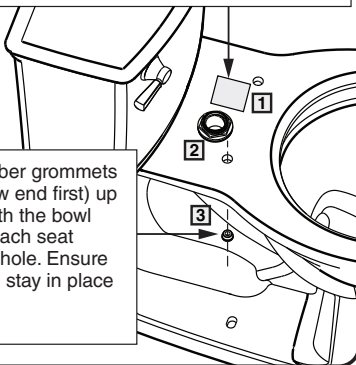

2

Check that rubber gasket is firmly attached to the underside of the base plate (1) and place plate over Spud (2) and rear of bowl while aligning the two mounting holes through the bowl.

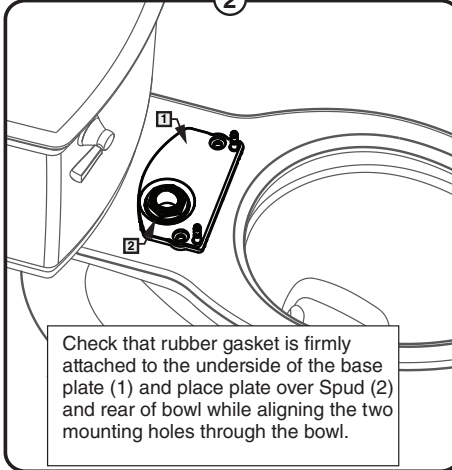

3

From above, install mounting screws and washers (1) through each hole, then place rubber washer (2) and plastic nut (3) from underneath onto each bolt. Snug down but do not fully tighten.

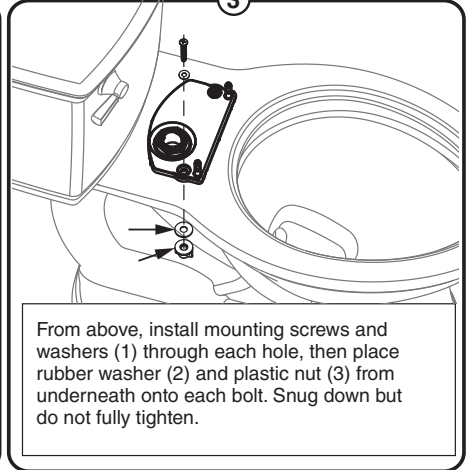

4

Seat Alignment

Place seat onto the protruding Base Plate Posts and press in to "click" into place, close seat and cover and align seat with bowl. Once aligned, further tighten seat nuts under bowl to securely hold seat in position.

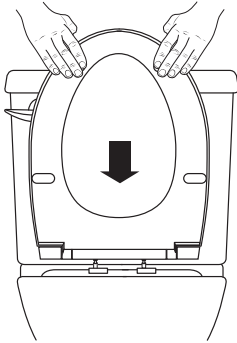

Remove seat by pressing both inside buttons to release seat and cover:

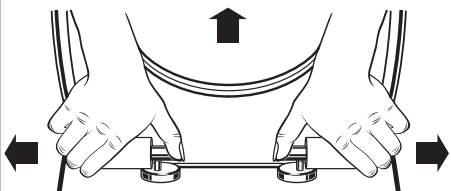

Open the seat and cover. Push both inside buttons to release seat and cover. Pull the seat and cover upwards to take it off the hinges.

5

Install VorMax Plus Housing (1) onto VorMax Plus Base Plate (2), snap in to secure.

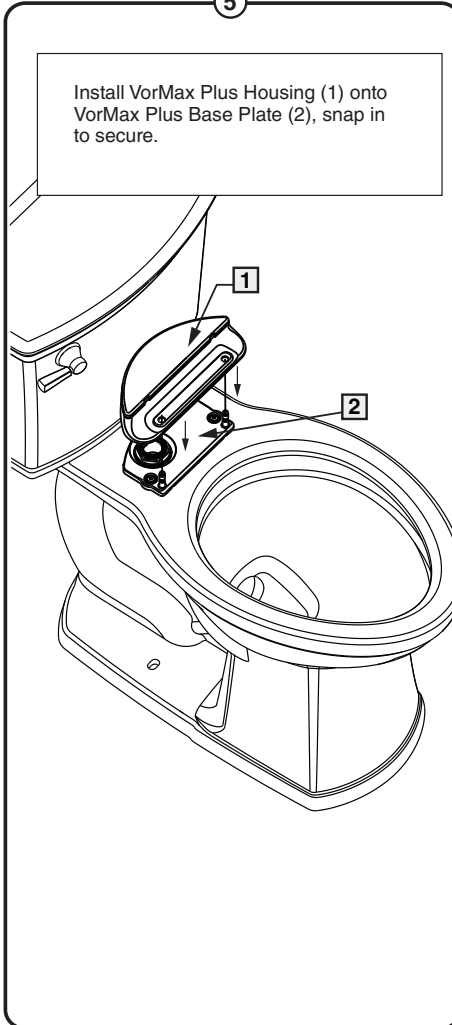

6

Open Base Plate Housing Door (1). Observe the marked notch on the VorMax Plus FreshInfuser (2). Observe the same marked notch located on the Base Plate Housing.

Before installing, line up the marked notches on the Base Plate Housing and the VorMax Plus FreshInfuser.

Insert the VorMax Plus FreshInfuser into the spud opening aligning the marked notch on the VorMax Plus FreshInfuser and the Base Plate Housing.

Marked Notch on VorMax Plus FreshInfuser

Notch on Base Plate Housing Door

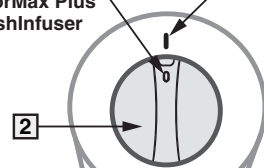

Marked Notch on VorMax Plus FreshInfuser

Notch on Base Plate Housing Door

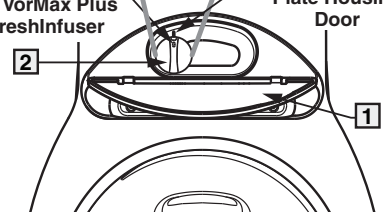

UNLOCKED



CAUTION: IF A VORMAX PLUS FRESHINFUSER IS NOT SECURELY INSERTED INTO THE SPUD OPENING, **DO NOT FLUSH THE TOILET** AS THIS MAY RESULT IN WATER LEAKING FROM THE TOILET. **TOILET MUST HAVE A VORMAX PLUS FRESHINFUSER INSERTED IN THE SPUD OPENING AT ALL TIMES WHEN FLUSHING THE TOILET.**
For further assistance please call Customer Care at: (800) 442-1902

7

Turn VorMax Plus FreshInfuser (1) in a clockwise direction (following arrow direction) until it stops at the "Lock" symbol  approximately 1/4 turn.

WARNING: Ensure that the VorMax Plus FreshInfuser is correctly aligned when inserted. If it is not correctly aligned water could leak from the opening.

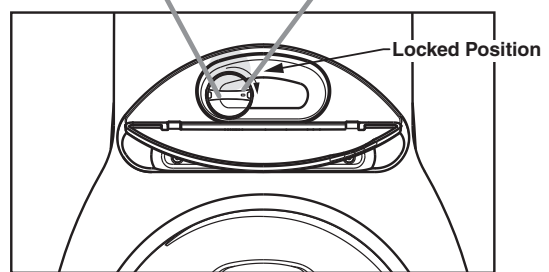
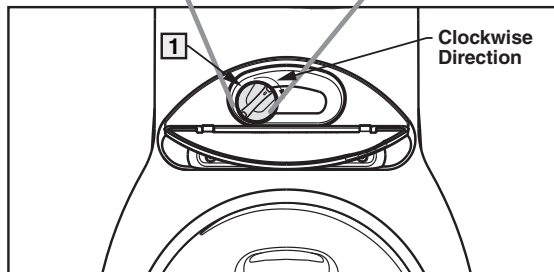
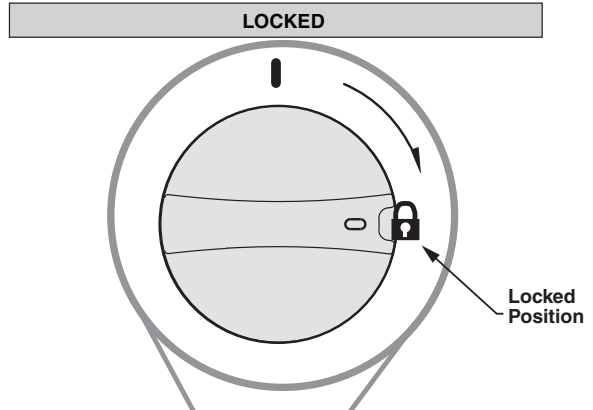
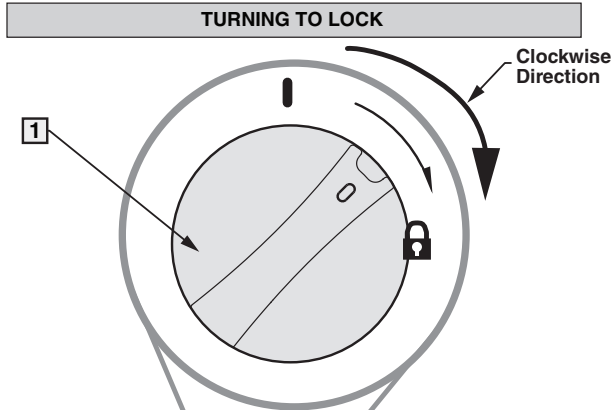

CAUTION: IF A VORMAX PLUS FRESHINFUSER IS NOT SECURELY INSERTED INTO THE SPUD OPENING, **DO NOT FLUSH THE TOILET** AS THIS MAY RESULT IN WATER LEAKING FROM THE SPUD OPENING.

TOILET MUST HAVE A VORMAX PLUS FRESHINFUSER INSERTED IN THE SPUD OPENING AT ALL TIMES WHEN FLUSHING THE TOILET.

8

Place seat back onto the back plate posts and press to "click" into place.

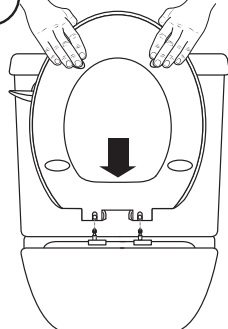

9

A Connect water supply line. (Sold separately) Hand tighten nut.

B Turn on water supply.

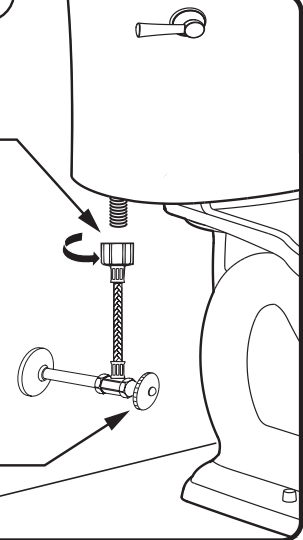

WARNING: Overtightening of water supply line nuts could result in breakage and potential flooding. If the connection leaks after hand tightening, replace the supply line. If the connection continues to leak with the new supply line, replace the fill valve. Do not use any type of sealant on the water supply connection. Use of plumber's putty, pipe dope, or any other type of sealant will void the warranty.

American Standard



HOW IT WORKS

VorMax® Plus technology infuses Lysol® cleaner into the water with each flush, freshening the bowl day after day. Its powerful VorMax® jetted scrub allows Lysol® cleaner to scrub the entire bowl, including under the CleanCurve™ Rim. The VorMax Plus FreshInfuser™ is hidden in a compartment and easy to access. Unlike competitive products, there's nothing unsightly hanging inside of the bowl. Each VorMax Plus FreshInfuser™ lasts 30 days and exudes an ocean fresh scent. Daily use of the VorMax® Plus toilet offers continuous freshness, flush after flush.



VorMax Plus FreshInfuser™

- Two VorMax Plus FreshInfuser™ included with the purchase of your toilet
- Each VorMax Plus FreshInfuser™ pack freshens up to 30 days (about 360 flushes).
- Ocean Fresh Scent
- VorMax Plus FreshInfuser™ packs for purchase available online at: <https://www.americanstandard.com/VorMaxPlus> or at participating supply houses and retailers.

LYSOL® is used under license to American Standard. © 2017

Care and Cleaning

When cleaning your toilet seat wash it with a mild, soapy water: rinse the seat thoroughly with clear water and dry with a soft cloth.

Avoid detergents, disinfectants, or cleaning products in aerosol cans. Never use abrasive scouring powders on your seat. Some bathroom chemicals and cosmetics may damage the seat's finish. After installation, check the tightness of the bolts from time to time to ensure a tight fit.

Troubleshooting Guide for VorMax Plus FreshInfuser™

Problem	Possible Cause	Corrective Action
Water leaks around VorMax Plus FreshInfuser	a. VorMax Plus FreshInfuser not inserted into Spud correctly b. Rubber gasket around VorMax Plus FreshInfuser is damaged or missing c. No FreshInfuser inserted in spud	a. Remove VorMax Plus FreshInfuser and reinsert. Reference steps 6 and 7 b. Replace VorMax Plus FreshInfuser c. Insert VorMax Plus FreshInfuser
Bowl not as clean as it should be	a. VorMax Plus FreshInfuser cleaner pack is empty	a. Replace VorMax Plus FreshInfuser

In the United States:

American Standard Brands
1 Centennial Ave
Piscataway, New Jersey 08854
Attention: Director of Customer Care

For residents of the United States, warranty information may also be obtained by calling the following toll free number: (800) 442-1902 www.americanstandard.com

In Canada:

AS Canada, ULC
5900 Avebury Rd.
Mississauga, Ontario
Canada L5R 3M3

Toll Free: (800) 387-0369
www.americanstandard.ca

In Mexico:

American Standard B&K Mexico
S. de R.L. de C.V.
Via Morelos #330
Col. Santa Clara
Ecatepec 55540 Edo. Mexico

Toll Free: 01-800-839-1200
www.americanstandard.com.mx