

INSTALLATION INSTRUCTIONS

SPKPL-NFL-RGBW-12VAC-6MKIT Series



⚠ WARNING

These products may represent a possible shock or fire hazard if improperly installed or attached in any way. Products should be installed in accordance with these instructions, current electrical codes, and/or the current National Electric Code (NEC).

⚠ WARNING

Use this fixture with included connection kit and 12V AC transformer only. Any other power feed may damage the fixture.

⚠ WARNING

To reduce the risk of fire, electric shock or injury to persons, use this flexible light only with American Lighting recommended drivers, controllers, power connectors, splices and extensions.

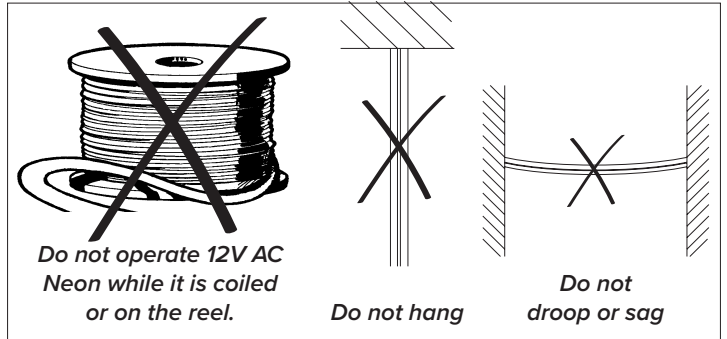

⚠ WARNING

To reduce the risk of fire, electric shock or injury to persons, make sure that the electrical power to the fixture is disconnected at the source prior to installation or any servicing.

SAFETY INFORMATION

- Read all installation instructions before beginning; if not qualified, do not attempt installation. Contact a qualified electrician.
- To reduce the risk of fire, electric shock, or injury to persons, pay close attention to this manual and stay within its guidelines when using this product. Save these instructions for future use.
- Do not cover this product as the covering may cause product to overheat, melt, or ignite.
- Risk of fire or electric shock. Uncoil flexible light prior to plugging in. Do not operate 12V AC Neon while it is tightly coiled.
- Do not route the cord or 12V AC Neon through walls, ceilings, doors, windows, or any similar part of the building structure.
- Secure this flexible light using only the included factory recommended mounting clips or channel (NFL-RGBW-FCHAN-1M), sold separately.
- Do not secure this product or its cord with staples, nails, or like means that may damage the outer jacket or cord insulation.
- Do not use if there is any damage to the silicone housing or power cord insulation. Inspect periodically.
- Do not install on gates or doors, where subject to continuous flexing.
- Do not install near flammable liquids or other flammable materials.
- Follow instructions carefully when cutting 12V AC Neon. Ensure all end caps are properly sealed with appropriate silicone or Silicone type glue.
- 12V AC Neon can only be cut at specific intervals as indicated by the cutting marks printed on the side of the Silicone housing (31.25mm or 1.23"). Failure to cut at a cut mark will result in a loss of light. Before making any cuts or attaching any power cords, be sure power source is disconnected at the source!
- This product is designed for use by a qualified installer.
- This product is for decorative use only. Not to be used by children as a toy. Keep out of reach of small children.
- The rated ambient temperature range for 12V AC Neon is -4°C (-40°F) to 60°C (140°F).
- The maximum bend radius of 12V AC Neon is 24cm or 11.8". Do not twist, drop, hang, sag, or bend product in any way other than intended. This product can only bend laterally in relation to its light output. See Figure 1 below for reference.
- **WARNING - KEEP BATTERIES OUT OF REACH OF CHILDREN!** Batteries are not a toy!
 - The handheld remote control included utilizes a 3V CR2025 battery; If swallowed, it could cause severe injury or death in just 2 hours due to chemical burns and potential perforation of the esophagus. If you suspect your child has swallowed or inserted a button battery, immediately seek urgent medical assistance.
 - Do not dispose of batteries in fire as they may explode or leak. Please dispose of used batteries immediately and safely. Only replace with the same battery type.
 - Examine devices and make sure the battery compartment is correctly secured, e.g. that the screw or other mechanical fastener is tightened. Do not use if compartment is not secure.

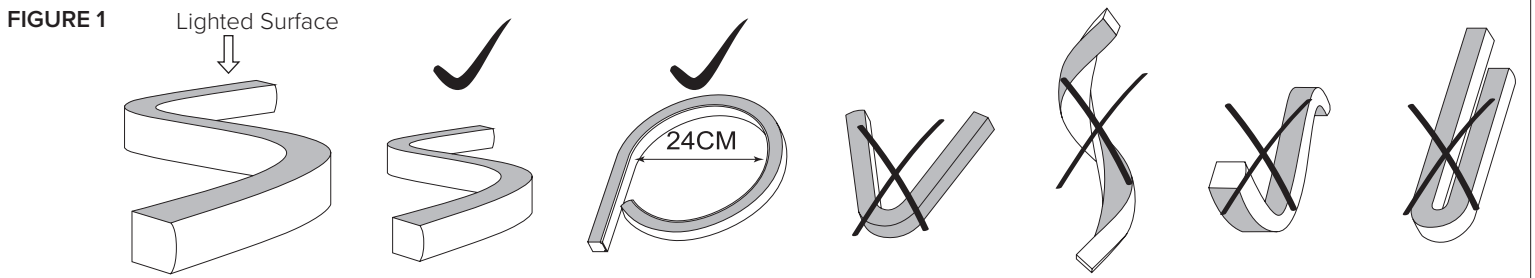

WARNING

When using outdoor portable lighting products, basic safety precautions should always be followed to reduce the risk of fire, electric shock, and personal injury, including the following:

- Use dielectric grease and shrink tube at all power connections, including end cap when using outdoors.
- Use ground fault circuit interrupter (GFCI) protection on the circuit(s) or outlet(s) when using outdoors.
- Use only UL approved outdoor extension cords, such as type SW, SOW, STW, STOW, SJW, SJOW, SJTW, or SJTOW. This designation is marked on the jacket of the extension cord.

INSTALLATION INSTRUCTIONS

SPKPL-NFL-RGBW-12VAC-6MKIT Series



INSTALLING 12V AC NEON:

Disconnect power at the source prior to attempting installation or service of product. Use this fixture with included power cable and 12V AC rectifier only. Any other power feed may damage the fixture.

1. Determine the desired locations and lengths of 12V AC Neon, as well as the location for the RF receiver and 12V AC rectifier, to be installed. Use this information to determine locations and sizes of 12V DC power supplies (sold separately).
2. Install mounting clips or aluminum channel (NFPROL-FCHAN-1M) by screwing into a solid, sturdy surface. See Figure 2. Mounting clips should be evenly spaced and a maximum of 3 feet apart. Two parallel lines of 12V AC Neon must be at least 1/2" apart.
3. Gently push the 12V AC Neon into the mounting clips or channel starting at the beginning of the run and moving down the line towards the end. Leave enough room for the power cable to reach the power supply. End caps cannot be installed within the aluminum channel. See Figure 3. Ensure the NeoFlux does not sag and does not bend more than the maximum bend radius of 24cm at any point.
4. Connect the RF Receiver to the beginning of the 12V AC Neon run using the preinstalled power cable. See Figure 4.
5. Connect the 12V DC power supply to line voltage and then connect to 12V AC rectifier using bare wire lead.
6. Reconnect power at source.

Note: To reset to factory default setting, disconnect & reconnect LED Controller/ Receiver from Power Supply ON then OFF x 3 times in succession. The light will pulse when it has been reset and is ready to be paired to the app. See Spektrum+ App Guide for pairing instructions.

CUTTING 12V AC NEON:

Disconnect power at the source prior to attempting installation or service of product.

1. Determine the location of the cut based on the cutting increments marked on the bottom of the 12V AC Neon (31.25mm or 1.23").
2. Using an appropriate utility blade, gently cut straight down through the 12V AC Neon directly on the cutting increment mark. Do not use scissors or bolt cutters. Do not cut diagonally or horizontally as this may damage the product. See Figure 5.
3. Seal cut-end using included end cap and an appropriately rated silicone or Silicone glue (not included). See Figure 6.

CONTROLLING THE TAPE LIGHT: The in-line LED controller/receiver utilizes Bluetooth® Wireless Technology and can be controlled via the Spektrum+ Smart Lighting App. It is not intended to be used with a standard dimmer switch.

USING THE REMOTE CONTROLLER (See Figure 10): Do not remove protective film from battery compartment until ready to use. This remote includes a 3V CR2032 battery, only replace with the same type battery. Please dispose of old batteries properly.

USING REMOTE WITH SPEKTRUM+ SMART LIGHTING APP: Add the remote to the app by selecting "Add Device", then pressing and holding the On + Off button together for 3 seconds to enter configuration mode. Follow the app instructions to finish binding the remote. Within the app, select the remote to add devices to be controlled by the remote. The remote can be added to specific rooms as well.

DISTANCE OF CONTROL CAPABILITY: 25 meters (approx. 80ft)

RESET THE REMOTE CONTROLLER: Press and hold Off and Scene buttons together for 5 seconds.

USING THE SPEKTRUM+ SMART LIGHTING APP: Please follow the Spektrum+ Smart Lighting App guide.

FCC Compliance Statement

This device complies with part 15 of the FCC Rules. Operation is subject to the following two conditions:

1. This device may not cause harmful interference, and
2. This device must accept any interference received, including interference that may cause undesired operation.

FCC WARNING

This equipment has been tested and found to comply with the limits for a Class B digital device, pursuant to Part 15 of the FCC Rules. These limits are designed to provide reasonable protection against harmful interference in a residential installation. This equipment generates, uses and can radiate radio frequency energy and, if not installed and used in accordance with the instructions, may cause harmful interference to radio communications. However, there is no guarantee that interference will not occur in a particular installation. If this equipment does cause harmful interference to radio or television reception, which can be determined by turning the equipment off and on, the user is encouraged to try to correct the interference by one or more of the following measures:

- Reorient or relocate the receiving antenna.
- Increase the separation between the equipment and the receiver.
- Connect the equipment into an outlet different from that to which the receiver is connected.
- Consult the dealer or an experienced radio/TV technician for help. Changes or modifications not expressly approved by the party responsible for compliance could void the user's authority to operate the equipment.

Any changes or modifications not expressly approved by the party responsible for compliance could void the user's authority to operate the equipment.

FIGURE 2

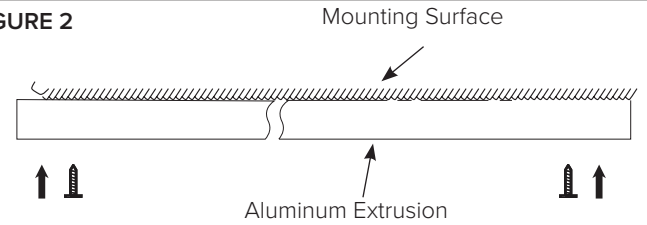

FIGURE 3

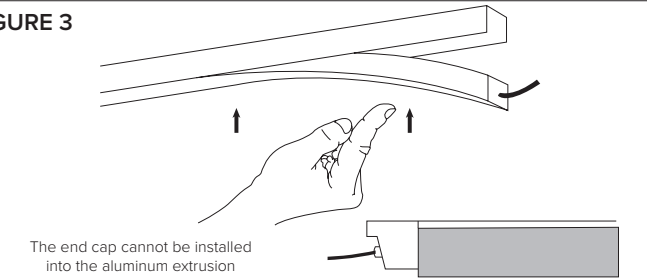

FIGURE 4

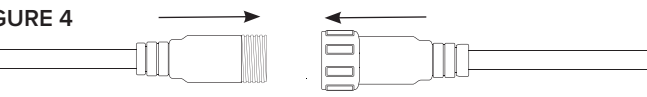

FIGURE 5

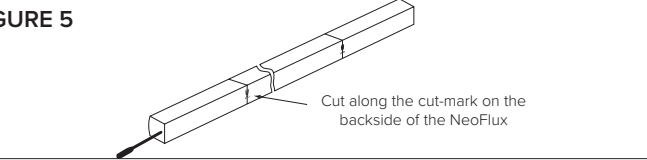

FIGURE 6

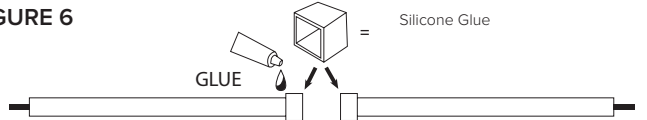

FIGURE 10

