

DMX WALL CONTROL

Tunable CCT 4 Zone Wall Control

Specifically designed to be used with Tunable CCT light fixtures, this DMX wall plate controller allows for simultaneous control of Tunable CCT tape light applications. Create ultra dynamic lighting when needed or utilize the built in presets with the touch of a button. Requires 3-channel DMX receiver for operation.

- Touch-sensitive configuration & operation
- Touch color circle with color tone shortcuts
- Adjust, dim, or turn on/off Tunable CCT channels independently
- Includes selection of 4 zones with 4 savable scenes each
- Features full range dimming capabilities (1-100%)
- Requires 12-24V DC input and 2-channel DMX decoder
- Fits standard single gang junction box



DMX WALL CONTROL QUICK SPECS

INPUT VOLTAGE	12-24V DC
POWER CONSUMPTION	200mA
OUTPUT	DMX 512 signal
OPERATING TEMP	-20°C to 55°C (-4°F to 131°F)
RATING	UL, FCC Compliant; RoHS Compliant; Dry locations



DMX WALL CONTROL QUICK SPECS

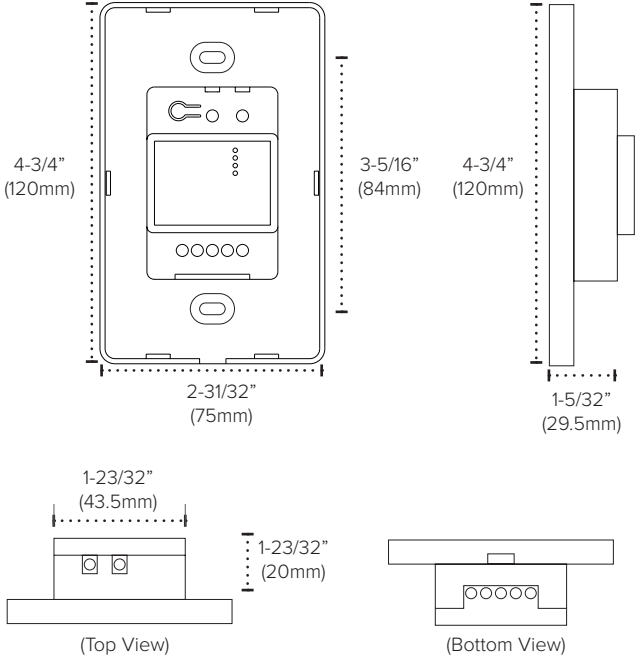

DMX WALL CONTROL ORDERING INFORMATION

ITEM NUMBER	DESCRIPTION	VOLTAGE	OUTPUT	RATING
CTRLW-DMXB-TW-4Z	Tunable CCT 4 Zone Wall Control	12-24V DC	DMX 512	UL, FCC Compliant; RoHS Compliant; Dry locations

RECOMMENDED DECODERS

PART NUMBER	DESCRIPTION	APPLICATION	INPUT	CURRENT	OUTPUT
REC-DMX-5A-4Z	DMX 4-Channel Decoder	Dry location	12-24V DC	4x5A	4x(60-180W)
REC-DMX-RJ45-5CH	DMX 5-Channel Decoder	Dry location	12-24V DC	5x8A	5x(96-192W)
REC-DMX-RJ45-3X4CH	DMX 3 Port 4-Channel Decoder	Dry location	12-24V DC	12(3x4)x5A	12x(60-120W)
DEC-DMX-IP67	DMX 4 Channel IP67 Decoder	Wet location	12-24V DC	4x5A	4x(60-180W)

Control can be powered from secondary side of 12-24V DC driver being used to power the decoder.

RECOMMENDED TRANSCEIVER

PART NUMBER	DESCRIPTION	APPLICATION	INPUT	LISTING
CTRL-WDMX-TRNRCV	Wireless DMX Transceiver	Dry location	5-24V DC	FCC Compliant; RoHS Compliant

DMX WALL CONTROL QUICK SET-UP

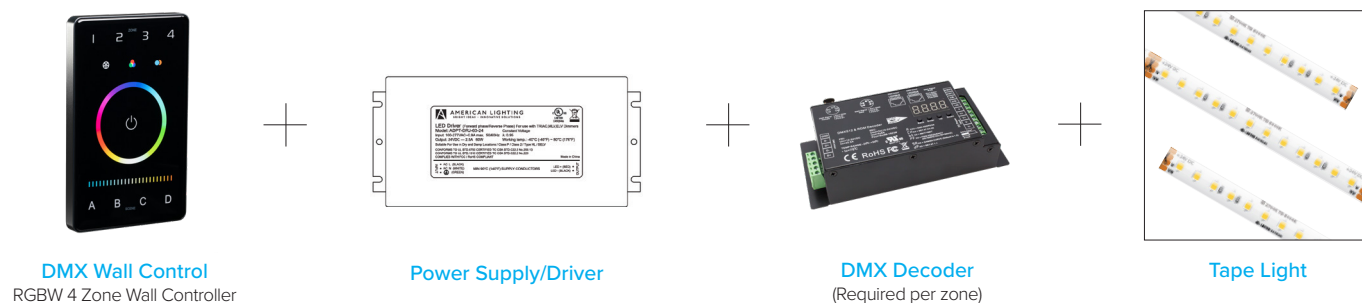

DMX WALL CONTROL QUICK SET-UP

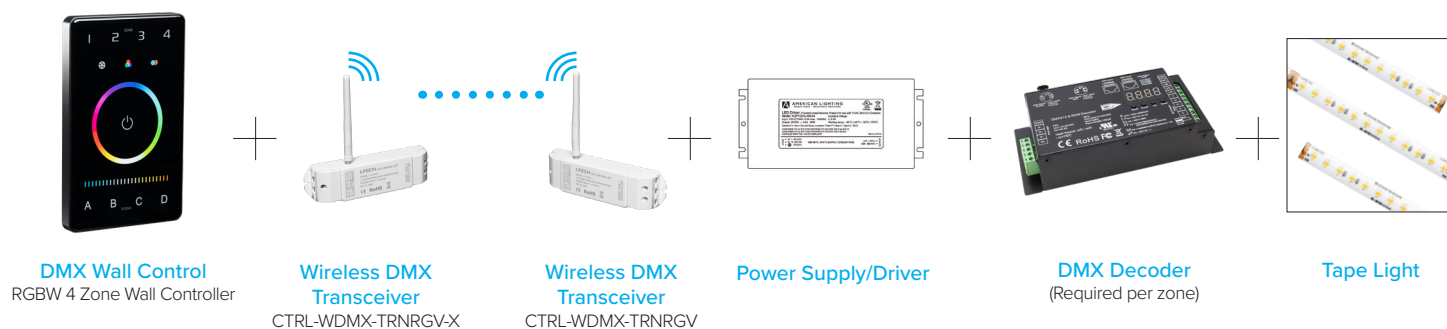

RECOMMENDED 24V DC DRIVERS

PART NUMBER	DESCRIPTION	APPLICATION	INPUT	CURRENT	LISTING
LED-DR8-12	LED-DR Series Driver	Dry/damp location	12V DC	8W	cULus Recognized
LED-DR8-24	LED-DR Series Driver	Dry/damp location	24V DC	8W	cULus Recognized



AMERICAN LIGHTING WARRANTY

LIMITED WARRANTY FOR LED PRODUCTS: 2 YEARS

LIMITED PRODUCT WARRANTY

Our products are warranted to be free from defects in material and workmanship for the warranty period listed. Warranty periods begin from the date of shipment from American Lighting Inc's warehouse to the original purchaser. Products that prove to be defective during their specific warranty period will be either repaired or replaced, at the sole discretion of American Lighting Inc. Claims for defective products must be submitted in writing to American Lighting Inc's RGA Department within the warranty period. Upon approval of such return, American Lighting Inc reserves the right to inspect the product for misuse or abuse. Claims for indirect or consequential damages or for product that, in American Lighting Inc's opinion, has been misused will be denied. This is a warranty of product reliability only and not a warranty of merchantability or fitness for a particular purpose. American Lighting Inc shall have no liability whatsoever in any event for payment of incidental or consequential damages, including, without limitations, installation costs and/or damages for personal injury and/or property. These products may represent a possible shock or fire hazard if improperly installed or altered in any way. This warranty does not apply to any product that has not been properly installed in accordance with current local codes and/or the National Electrical Code. Products that require a transformer, driver, or power supply must be used in conjunction with American Lighting Inc's recommended power supply to ensure safety and retain product warranty.

PRODUCT SPECIFICATIONS

For the latest product information, updates, instructions and details concerning specifications, colors, finishes, performance, installation and design, visit www.americanlighting.com. Color may vary from the color printed herein due to limitations in photographic and printing processes. American Lighting Inc. reserves the right to change product specifications without notice. Other product specifications such as color temperature, wavelength characteristics and lumen output are subject to production limitations and may vary. LED technology is changing rapidly, and not all color temperatures and performance levels can be duplicated at a later time. Best practices include purchasing 10-15% more for a particular project on the same initial order where white LED color temperatures must be maintained over project and product life. Eventual product replacement should be considered at layout and design stages. Best practices also include testing connections and product performance prior to mounting and/or installing.

AVERAGE LIFE

Average incandescent lamp life, rated life and average life are terms used to describe the number of hours at which half of the lamps have failed. For LEDs, the hours of rated life specify the point where 70% of original lumen output is reached. Below this point, the effective life is over, however, the LED may still emit light. Individual results may vary with actual environmental conditions including, but not limited to, proper installation, ambient temperature and/or input voltage fluctuations.