

RGBTW SERIES TAPE LIGHT

24V RGB + Tunable CCT (2700-6000K)

RGB + Tunable CCT tape light is the ultimate solution in color changing RGB linear lighting technology. With RGBTW, not only do you have a virtually unlimited RGB palette of color combinations, you also have the ability to adjust true white light ranging from 2700K up to 6000K. Providing intense color saturation, transition effects, and fade to white lighting effects.

- Dynamic RGB+Tunable CCT color mixing capabilities
- Create millions of color combinations for impactful installations
- Features 3-in-1 RGB LEDs with alternating 2700K & 6000K LEDs
- Lumen output ranging up to 410Lm per foot
- Cuttable every 13.94" with 13.1ft max run
- Easy installation featuring 3M VHB adhesive backing
- IP54 rating featuring nano-coating protective layer
- Control via DMX for color and dimming (requires DMX receiver)
- cULus Listed for indoor dry/damp locations
- 50,000 hours rated life



PROJECT: _____

TYPE: _____

LOCATION: _____

CATALOG NUMBER: _____



RGBTW SERIES QUICK SPECS	
VOLTAGE	24V
WATTAGE	7W / ft
LUMENS	Up to 410Lm / ft
CCT OPTIONS	RGB + 2700-6000K
CRI	90+
MAX RUN	13.1ft
CUTTING POINTS	3.94" (100mm)
IP RATING	IP54 - Coated
DIMMING	5-100% (Requires Secondary Side Controller)
DIMENSIONS	0.39" (10mm) W x 0.06" (1.65mm) H
BEAM ANGLE	120°
OPERATING TEMP	5°C (41°F) to 70°C (158°F)
CERTIFICATIONS	cULus Listed - Dry / Damp Location
RATED LIFE	50,000 Hours

RGBTW SERIES IP RATINGS

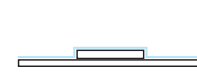

IP54 (Coated)

Features a light nano-coating applied to the tape light and LED's that protects from moisture and dust.
Best suited: Indoor dry & damp locations

RGBTW SERIES QUICK LOOK

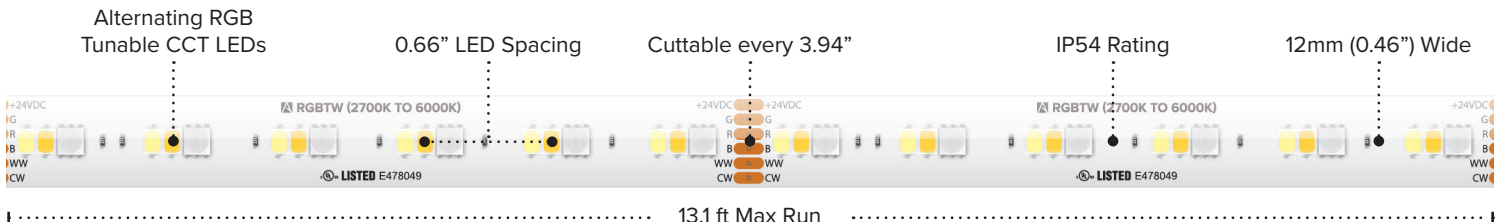

RGBTW SERIES ORDERING INFORMATION *Custom Cut Orders - Please Allow Up To 2-4 Weeks Order Processing & Delivery*

ITEM NUMBER	VOLTAGE	CCT	LENGTH	LUMENS / FT	WATTAGE / FT	IP RATING	CRI	CUTTING	MAX RUN
SPTL-RGBTW	24V	RGB + 2700-6000K	13.1 ft	410Lm / ft	7W / ft	IP54	90+	3.94" (100mm)	13.1 ft
SPTL-RGBTW-100	24V	RGB + 2700-6000K	100 ft	410Lm / ft	7W / ft	IP54	90+	3.94" (100mm)	13.1 ft
SPTL-RGBTW-CC	24V	RGB + 2700-6000K	Custom Cut	410Lm / ft	7W / ft	IP54	90+	3.94" (100mm)	13.1 ft

13.1ft Reels (IP54) Include: Attached 3ft Lead Wire / (3) HD Power Feeds / (3) HD Splice Connectors
100ft Reels (IP54) Include: Attached 3ft Lead Wire / (5) HD Power Feeds / (5) HD Splice Connectors

RGBTW SERIES ACCESSORIES

ITEM NUMBER	DESCRIPTION
TL-6PWR-HD	6" HD Power Feed (IP54)
TL-6SPL-HD	HD Splice (IP54)
TL-6JUMP6-HD	6" HD Linking Cable (IP54)
TL-6JUMP24-HD	24" HD Linking Cable (IP54)
WIRE-15-6PIN	15ft (20/6) Wire Spool
WIRE-CMP-100-6PIN	100ft (16/6) In-wall Rated Wire Spool
RCWY-PVC-1M	1m Plastic Wire Cover Raceway



RGBTW DMX QUICK SET-UP

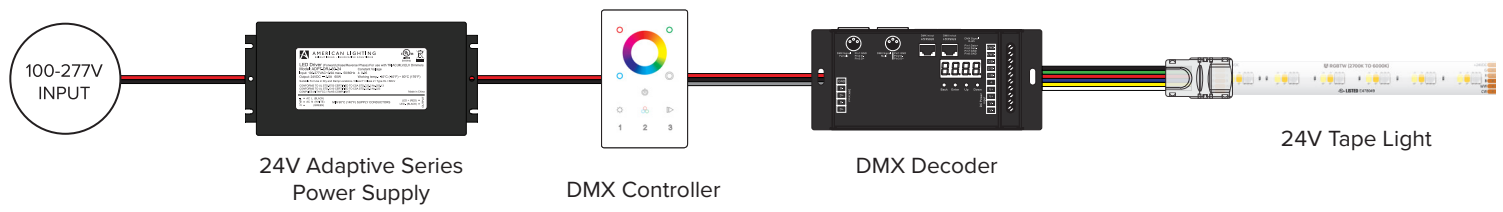

RGBTW SIMPLE SELECT QUICK SET-UP

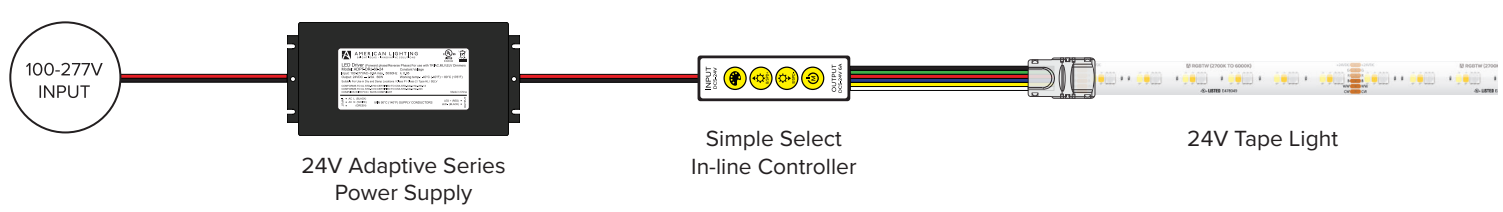

RECOMMENDED POWER SUPPLIES

ITEM NUMBER	DESCRIPTION	MAX / MIN LOAD	INPUT VOLTAGE	OUTPUT VOLTAGE	DIMMABLE	DIMENSIONS
ADPT-DRJ-30-24	Adaptive Series 30W	30W / 3W	100-277V AC	24V	Yes*	6.49"L x 3.6"W x 1.02"H
ADPT-DRJ-60-24	Adaptive Series 60W	60W / 6W	100-277V AC	24V	Yes*	7.4"L x 3.6"W x 1.02"H
ADPT-DRJ-96-24	Adaptive Series 96W	96W / 9.6W	100-277V AC	24V	Yes*	8.66"L x 3.6"W x 1.61"H
ADPT-DRJ-192-24	Adaptive Series 192W (2 x 96W)	192W / 19.2W	100-277V AC	24V	Yes*	10.94"L x 4.25"W x 1.8"H
ADPT-DRJ-288-24	Adaptive Series 288W (3 x 96W)	288W / 28.8W	100-277V AC	24V	Yes*	11.85"L x 4.25"W x 1.8"H

Phase Dimming Compatible With Most MLV, ELV, and TRIAC Dimmers