

Model No :: **63968LEDD-BL/ACR**  
 Name :: **Squared**

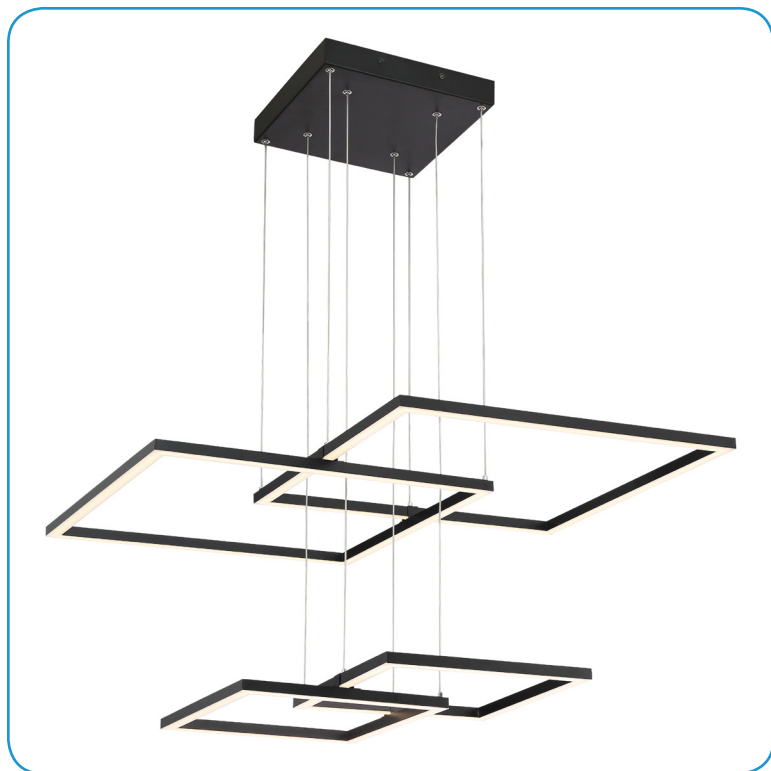

Project Name :: \_\_\_\_\_  
 Location :: \_\_\_\_\_  
 Type :: \_\_\_\_\_  
 Quantity :: \_\_\_\_\_  
 Notes :: \_\_\_\_\_

**Product Information**

Product ID :: 63968  
 UPC Code :: 641594228960  
 Mounting Type :: Ceiling or Wall  
 Finish :: Black (BL)  
 Diffuser :: Acrylic Lens (ACR)  
 Alt. Finishes :: White (WH)  
 Alt. Diffusers :: N/A

**Product Dimensions**

Fixture	Canopy
Length :: 30.3"	Length :: 11"
Width :: 30.3"	Width :: 11"
Diameter :: N/A	Diameter :: N/A
Extension :: N/A	Height :: 1.625"
Height :: 4.5"	
Overall Height :: 4.5"-123" Max.	

**Technical Specifications**

Qualifications	Specifications	Photometrics	Recommended Dimmers
Location Rating :: Damp	Frame Material :: Metal	CCT :: 3000	(ELV) LEGRAND Paddle ADPD453LM2; (ELV) LUTRON Diva DVELV-300P; (ELV) LUTRON Diva DVELV-303P; (ELV) LUTRON Skylark SELV-300P; (TRIAC) LUTRON Diva DV-600P
Certification :: cULus	Diffuser Material:: Acrylic	CRI :: 85	
IES File :: No	Voltage :: 120v	Wattage :: 75 W	
JA8 Compliant :: No	Lamping Type :: Dedicated LED	Nominal Lumens :: 5600	
Title 20 Compliant :: N/A	Lamping Base :: SSL	Delivered Lumens :: N/A	
Energy Star :: No	Lamp Quantity :: 1		
ADA Compliant :: No	Lamp Wattage :: 75 W		
Marine Grade :: No	Total Wattage :: 75 W		
Emergency Lighting :: No	Lamps Included :: Yes		
Warranty :: 5 Year Limited	J-Box Type :: Standard		

Custom Options :: N/A; Additional Items :: N/A

**Line Drawing #1**

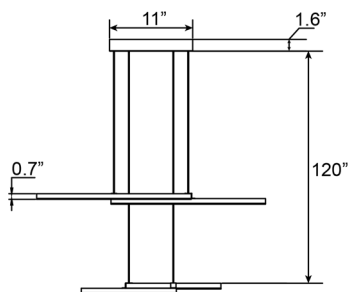

**Line Drawing #2**

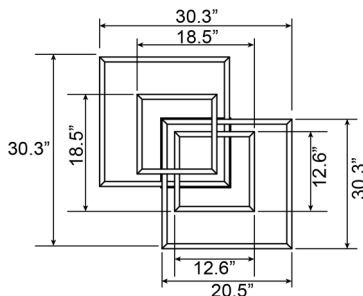

**IES File**

Image Not Available

**Toll Free 800-828-5483 or www.AccessLighting.com**

14410 Myford Road, Irvine, CA 92606

The information provided is subject to change without notice. ©2018 Access Lighting Corporation. All Rights Reserved  
 Rev. 201901 Filename:: 63968LEDD-BL\_ACR.pdf

