

# Jeremiah Lighting

## ASSEMBLY & INSTALLATION INSTRUCTION FOR #22033

Please read carefully and save these instructions, as you may need them at a later date.

### CAUTION

Turn off the main power at the circuit breaker before installing the fixture, in order to prevent possible shock.

### GENERAL

All electrical connections must be in accordance with local and National Electrical Code (N.E.C.) standards. If you are unfamiliar with proper electrical wiring connections obtain the services of a qualified electrician.

Remove the fixture and the mounting package from the box and make sure that no parts are missing by referencing the illustrations on the installation instructions.

### ASSEMBLY AND INSTALLATION

1. Screw the FIXTURE MOUNTING SCREWS (13) into the MOUNTING BRACKET(2), fix with the HEX NUT(14).
2. Attach the MOUNTING BRACKET(2) assembly to the OUTLET BOX(1) using the slotted holes of the MOUNTING BRACKET(2) and the MOUNTING SCREWS(3) provided.
3. Carefully pass the power supply (6&8) wires and the SUPPLY GROUND WIRE (5) through the center hole of the BACK PLATE (2). Secure the BACK PLATE (2) to the OUTLET BOX (1) with MOUNTING SCREWS (3).
4. Attach the BLACK SUPPLY WIRE (8) to the SMOOTH (or BLACK) FIXTURE LEAD WIRE (9) by using the WIRE CONNECTOR (10). At the same manner, attach the WHITE SUPPLY WIRE (6) to the RIBBED (or WHITE) FIXTURE LEAD WIRE (7). Loop the FIXTURE GROUND WIRE (4) around the GROUND SCREW (11) of the BACK PLATE (2). (Note: Be sure to provide an extra 3" length of the FIXTURE GROUND WIRE (4) for connection to the SUPPLY GROUND WIRE (5).) Tighten the GROUND SCREW (11). Connect the remaining FIXTURE GROUND WIRE (4) to the SUPPLY GROUND WIRE (5) using a WIRE CONNECTOR (10). Place wiring and connections inside the OUTLET BOX (1).
5. Thread the column onto the CLUSTER ASSEMBLY(16). Place the COVER PLATE (12) onto the FIXTURE MOUNTING SCREWS (13), and secure it into place using the BALL NUT(15) provided.
6. Screw light bulbs into the sockets and make sure they do not exceed the maximum wattage specified on the fixture's wattage rating label, **MAXIMUM 60W.**
7. Thread the CENTER STEM(17) onto the CLUSTER ASSEMBLY(16), slide the RUBBER WASHER(18), GLASS SHADE(19), GASKET(20) over the CENTER STEM(17), secure with the HEX NUT(21).
8. Slide the BOTTOM FONT(22) over the CENTER STEM(17), secure with the FINIAL(23).

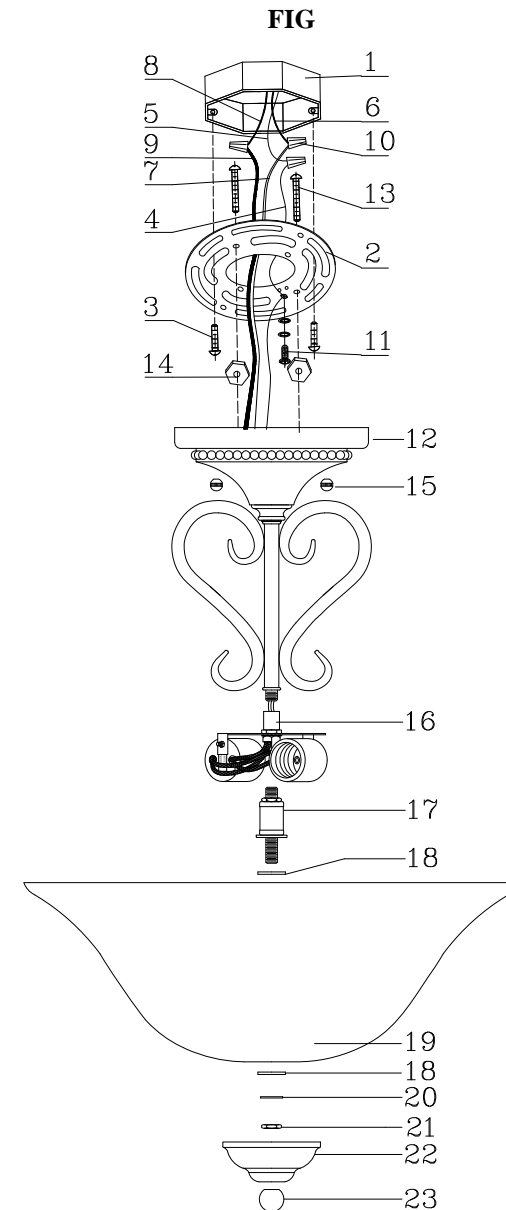

- |  |  |                   |
|--|--|-------------------|
| 1. OUTLET BOX                          | 9. SMOOTH (OR BLACK) FIXTURE LEAD WIRE | 17. CENTER STEM   |
| 2. MOUNTING BRACKET                    | 10. WIRE CONNECTOR                     | 18. RUBBER WASHER |
| 3. MOUNTING SCREW                      | 11. GROUND SCREW                       | 19. GLASS SHADE   |
| 4. FIXTURE GROUND WIRE                 | 12. COVER PLATE                        | 20. GASKET        |
| 5. SUPPLY GROUND WIRE                  | 13. FIXTURE MOUNTING SCREW             | 21. HEX NUT       |
| 6. WHITE SUPPLY WIRE                   | 14. HEX NUT                            | 22. BOTTOM FONT   |
| 7. RIBBED (OR WHITE) FIXTURE LEAD WIRE | 15. BALL NUT                           | 23. FINIAL        |
| 8. BLACK SUPPLY WIRE                   | 16. CLUSTER ASSEMBLY                   |                   |