

Family: Stowe | Item No. 4729 MC

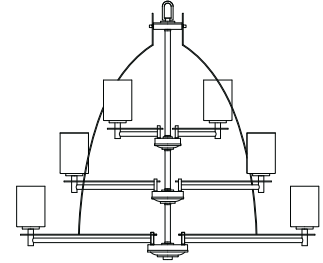

Drawing 1 - Fixture Assembly

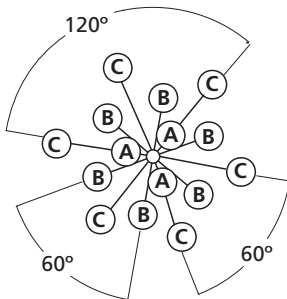

Drawing 2 - Fixture Assembly

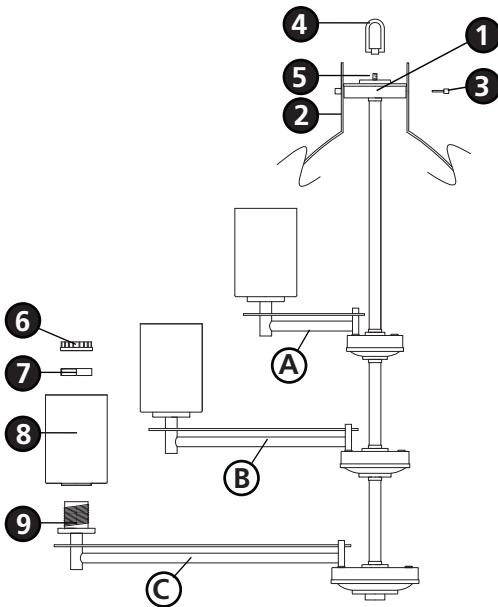

▼ start here

1

1. Find a clear area in which you can work.
2. Unpack fixture and glass from carton.
3. Carefully review instructions prior to assembly.

***** The construction of this fixture will be accomplished by first assembling the main body of the fixture, making all necessary electrical connections, hanging the fixture from the ceiling and then installing fixture glass.**

SAFETY WARNING: READ WIRING AND GROUNDING INSTRUCTIONS (I.S. 18) AND ANY ADDITIONAL DIRECTIONS. TURN POWER SUPPLY OFF DURING INSTALLATION. IF NEW WIRING IS REQUIRED, CONSULT A QUALIFIED ELECTRICIAN OR LOCAL AUTHORITIES FOR CODE REQUIREMENTS.

2

1. To assemble fixture, slip top cap (4) with loop, along wire and thread onto top of fixture (5) - see **Drawings 1 and 2**.
2. Rotate top arms (A) until they are equally spaced 120 degrees apart .
3. Rotate middle tier arms (B) until they are equally spaced 60 degrees apart, and equally spaced between the uprights (2).
4. Rotate bottom arms (C) until they are equally spaced 60 degrees apart.
5. Attach top of upright (2) to top of main body (1), using the knob and stud (3) provided.
6. Please refer to the hanging instruction sheet (I.S. 19-50) provided to hang fixture. Then refer back to this sheet to continue fixture installation.

3

1. To install glass, remove socket ring (6) and spacer (7) from socket (9) - see **Drawing 2**.
2. Slip glass (8) over socket (9).
3. Slip spacer (7) over socket (9).
4. Thread socket ring (6) onto socket (9) and hand-tighten.
5. Fixture can now be lamped accordingly.

Note: Maximum wattage for 4729 fixture is 40 watts per bulb.

12.22.08