

Family: Valley | Item No. 4704 VK

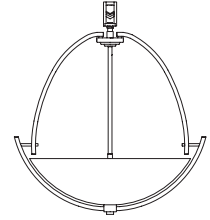

Drawing 1 - Fixture Assembly

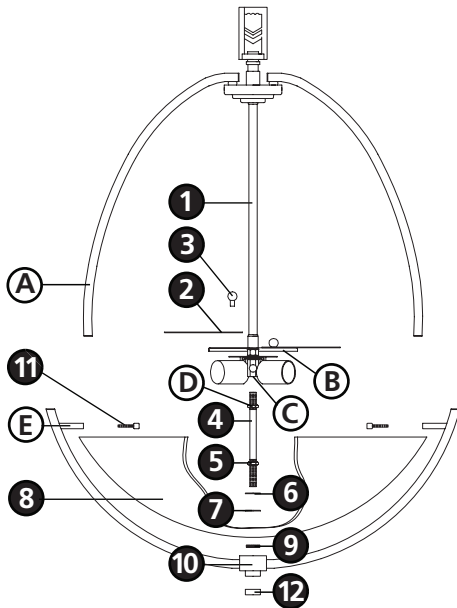

## ▼ start here

1

1. Find a clear area in which you can work.
2. Unpack fixture and glass from carton.
3. Carefully review instructions prior to assembly.

**\*\*\* The construction of this fixture will be accomplished by first assembling the main body of the fixture, installing the fixture glass, making all necessary electrical connections, and then hanging the fixture.**

**SAFETY WARNING: READ WIRING AND GROUNDING INSTRUCTIONS (I.S. 18) AND ANY ADDITIONAL DIRECTIONS. TURN POWER SUPPLY OFF DURING INSTALLATION. IF NEW WIRING IS REQUIRED, CONSULT A QUALIFIED ELECTRICIAN OR LOCAL AUTHORITIES FOR CODE REQUIREMENTS.**

2

1. To assemble main body, spread arms **(A)** of top body frame **(1)** until they are 120 degrees apart.
2. Attach bulb shield **(2)** to top of socket assembly **(B)**, using ball knob screws **(3)**.
3. Thread center stem **(4)** into coupler **(C)**, located in the center of the socket assembly, approximately 3/8".
4. Thread hex nut **(D)** up against coupler **(C)**, to lock center stem **(4)** in place.
5. Thread hex nut **(5)** onto center stem approximately 1 1/4".
6. Slip steel washer **(6)** onto center stem **(4)** and up against hex nut **(5)**.
7. Slip rubber washer **(7)** onto center stem **(4)** and up against steel washer **(6)**.
8. Fixture can now be lamped accordingly.
9. Slip glass **(8)** onto center stem **(4)** and hold in position.
10. Thread knurl nut **(9)** onto center stem **(4)** and tighten up against glass **(8)**.  
Note: hand tighten only, using a tool may cause damage to glass.
11. Slip spider assembly **(10)** over glass **(8)**.
12. Line up the holes in the bottom arms **(A)** with the hole in tab **(E)** and thread in ball knob screw **(11)** through hole and tighten to secure.
13. Repeat step 12 with remaining arms.
14. Thread finial **(12)** onto end of center stem **(4)**.
15. Please refer to the hanging instruction sheet **(I.S. 19)** provided to hang fixture.

Note: Maximum wattage for 4704 fixture is 75 watts per bulb.

2.7.08