

Family: Meridian | Item No. 3872 BN

▼ start here

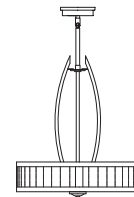

Drawing 1 - Ring Assembly

1

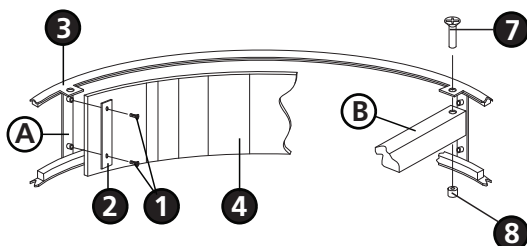

1. Find a clear area in which you can work.
2. Unpack fixture and glass from carton.
3. Carefully review instructions prior to assembly.

*** The construction of this fixture will be accomplished by first assembling the fixture's ring and glass, assembling the main body, hanging the fixture, and then installing the lens.

Drawing 2 - Fixture Assembly

2

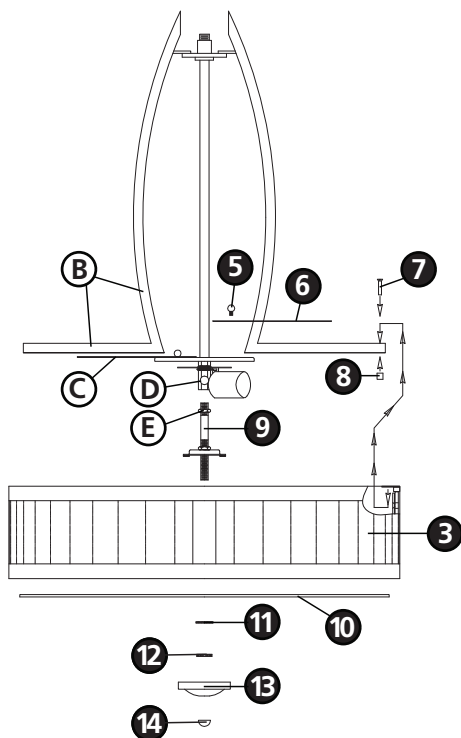

SAFETY WARNING: READ WIRING AND GROUNDING INSTRUCTIONS (I.S. 18) AND ANY ADDITIONAL DIRECTIONS. TURN POWER SUPPLY OFF DURING INSTALLATION. IF NEW WIRING IS REQUIRED, CONSULT A QUALIFIED ELECTRICIAN OR LOCAL AUTHORITIES FOR CODE REQUIREMENTS.

1. To assemble ring, remove screws (1) and mounting plate (2) from ring assembly (3) - see **Drawing 1**.
2. Take one section of glass (4) and place it between the uprights (A) of the ring assembly (3).
3. Attach mounting plate (2) loosely to the upright (A) to hold glass in position.
4. Repeat steps 2-3 for remaining pieces of glass.
5. After all glass sections (4) have been placed in the cage assembly (3) and all mounting plates (2) are in place. Screws (1) can be tightened to secure glass.

3

1. To assemble main body, rotate arms (B) until they are equally spaced 120 degrees apart - see **Drawing 2**.
2. Remove ball knob studs (5) for cluster plate (C).
3. Attach diffuser (6) to cluster plate (C) using ball knob studs (5) removed earlier.
4. Attach previously assembled ring (3) to end of arm (B) using screws (7) and barrel nuts (8) - see **Drawing 1**.
5. Thread center stem (9) into coupler (D) approximately 3/8". Thread hex nut (E) up against coupler (D) to secure center stem (9).
6. Please refer to the hanging instruction sheet (I.S. 19-90) provided to hang fixture. Then refer back to this sheet to install glass.

4

1. Fixture can now be lamped accordingly - see **Drawing 2**.
2. Slip lens (10) onto center stem (9) and hold in position.
3. Slip washer (11) onto center stem (9) and hold in position.
4. Thread knurl nut (12) onto center stem (9) and tighten to secure glass to fixture.
5. Slip cap (13) onto center stem (9).
6. Thread finial (14) onto center stem (9) and tighten to complete assembly.

Note: Maximum wattage for 3872 fixture is 100 watts per bulb.

9.30.09