

Model: EN- Q50AR

120V Track Systems Fixture Adapter

WAC LIGHTING

Responsible Lighting®



Fixture Type:

Catalog Number:

Project: _____

Location: _____

PRODUCT DESCRIPTION

The threaded male adapter used on Quick Connect™ fixtures makes inter-system compatibility a snap. Simply insert the metal fitting into the appropriate system adapter, hand tighten the threaded collar and you are done!

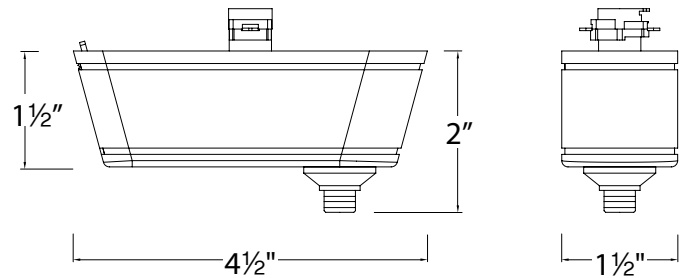

FEATURES

- Order one per Quick Connect™ fixture or pendant used.
- 1W minimum load required. 50W maximum load.
- Compatible fixtures include all the elements in the WAC Lighting Quick Connect™ series of pendants and track heads.
- Dimmable with ELV (Electronic Low Voltage) dimmer.

SPECIFICATIONS

Transformer: Electronic transformer has advanced auto-reset, soft start and short circuit protection features. The soft start delayed lamp start feature extends lamp life by delaying the abrupt inrush current to the lamp.

Materials: Polycarbonate case with metal fittings for attaching to rail. Transformer is a high frequency 12V electronic transformer.

Finishes: Brushed Nickel (BN), Black (BK), Dark Bronze - H Track only (DB), and White (WT).

Standards: UL and CUL Listed.



ORDER NUMBER

Model #	Finish
EN-HQ50AR <i>H Track</i>	BK <i>Black</i>
	BN <i>Brushed Nickel</i>
	DB <i>Dark Bronze</i>
	WT <i>White</i>
EN-LQ50AR <i>L Track</i>	BK <i>Black</i>
	BN <i>Brushed Nickel</i>
EN-JQ50AR <i>J/J2 Track</i>	WT <i>White</i>

-

Example: **EN-HQ50AR-BK**

WAC Lighting
www.waclighting.com
Phone (800) 526.2588 • Fax (800) 526.2585

Headquarters/Eastern Distribution Center
615 South Street • Garden City, NY 11530
Phone (516) 515.5000 • Fax (516) 515.5050

Western Distribution Center
168 Brea Canyon Road • City of Industry, CA 91789
Phone (800) 526.2588 • Fax (800) 526.2585