

To be specified:

Sensor Urinal Flush Valve

- Complete Set, Surface Mount, Satin Finish (14"x 12" cover plate)
 - Back Spud - TEU2LN11#SS (3/4" V.B.)
 - Back Spud - TEU2LN21#SS (1-1/4" V.B.)

Supplied with:

- Vacuum Breaker & Angle Stop Set -VB13RB-11
 - 3/4" Angle Stop - 10077t6
 - 3/4" Vacuum Breaker - 10075t6
 - Outlet Tube - TH559EDV171
 - Sweat Solder Kit - SJ1
- Vacuum Breaker & Angle Stop Set -VB13RB-21
 - 3/4" Angle Stop - 10077t6
 - 1-1/4" Vacuum Breaker - 10075t7
 - Outlet Tube - TH559EDV172
 - Sweat Solder Kit - SJ1

Meets the Americans with Disabilities Act guidelines and ANSI A117.1 requirements for people with disabilities



TEU2LN11#SS

AUTOMATIC FLUSHING SYSTEM

TOTO, the world leader in advanced plumbing systems, provides sensor operated flush valves for facilities demanding the finest sanitation equipment for busy restrooms. "Hands-free" technology effectively reduces unsanitary conditions from unflushed fixtures.

SELF-GENERATING POWER SYSTEM

TOTO's new technology of automatic generator flush valves offers easy installation without the cost and downtime required to install power supplies and wiring for each valve. A hydro-powered turbine charges the power supply during usage, eliminating the need for a battery replacement or consumption of external power for up to 10 years.

SUPERIOR PISTON VALVE

TOTO's piston valve technology is a marked improvement over traditional rubber diaphragm type valves. Longer piston travel and a self-cleaning stainless steel screen to capture debris reduces common problems such as continuous running and flooding. The piston seat itself will not warp or mis-seal, reducing repair and maintenance costs. A micro-porous cup seal keeps the piston self-lubricated upon each activation with the incoming water supply.

For optimal performance, we recommend using our 0.5 HEU flushometers in conjunction with our 0.5 HEU commercial urinals.

OPERATING PROCEDURE

A sanitary environment without using the hands.

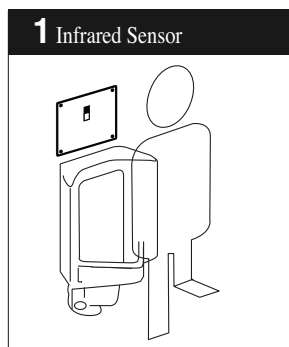

1 Infrared Sensor
The infrared sensor detects a user standing in front of the urinal within 2 ft (600mm).

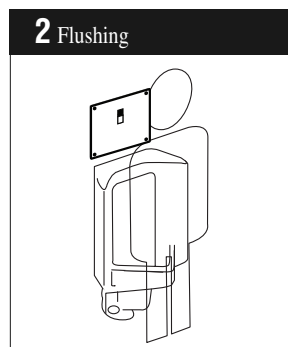

2 Flushing
When the user stays in place longer than 6 seconds then moves away, the controller sends a signal to the operating unit to automatically trip the flush valve.

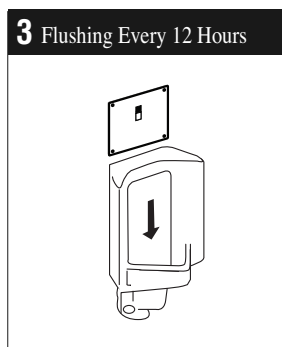

3 Flushing Every 12 Hours
If toilet is not used, the system automatically flushes every 12 hours as a maintenance and hygienic precaution. Use the manual flush switch for maintenance and/or emergencies.

ECOPOWER SYSTEM

Designed for new and retrofit installations, TOTO's new technology of EcoPower offer easy installation without required to install power supplies Flush Valve.



