

SW-NEO-DTF

**OWNERS  
MANUAL**

**CAUTION:**

Read **ALL**  
instructions  
carefully **BEFORE**  
starting your  
installation.

LIMITED **Lifetime**  
WARRANTY

*Save this manual for  
Future Reference.*

Installation procedures for

**SW-NEO-DTF**

Designed for Neo-Angle or Double-Threshold  
Shower Floor 36" c 36" to 38" x 38"

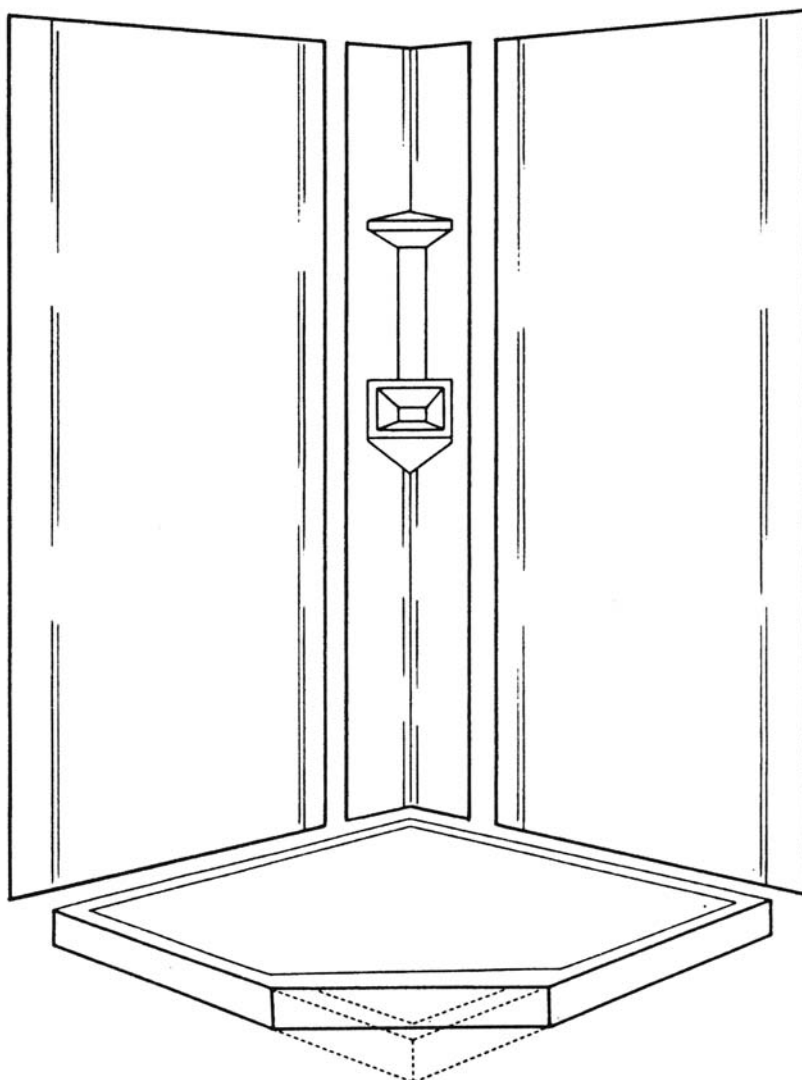

**INSTALLATION • CARE AND CLEANING • REPAIR PARTS**

# STEP-BY-STEP INSTALLATION INSTRUCTIONS:

MODEL SW-NEO-DTF

DESIGNED FOR NEO-ANGLE OR DOUBLE-THRESHOLD SHOWER FLOOR 36" X 36" TO 38" X 38"

This Fiberglass SHOWERWAL Kit system is designed to be installed over any solid dry surface around the bathtub. It can be used with most conventional tubs over existing walls as well as in new construction.

**BE SURE TO READ THE ENTIRE INSTALLATION SHEET BEFORE STARTING.**

Allow package to adjust to room temperature for at least 6 hours. (65°-90°F)

Next, turn off hot and cold water supply, remove faucet handles, escutcheons, filler spouts or fittings mounted to wall to be covered-including soap dishes, towel bars, etc.

Use hammer and chisel to remove objects cemented to walls. Old ceramic tiles, if adhered solidly to walls can be covered over with this FIBERGLASS SHOWERWAL KIT. Remove any loose tiles, sand sub wall surfaces smooth. Front edge tiles should be reset for appearance only. Be sure to remove soap film and dirt from all wall surfaces using household detergent, then wipe dry.

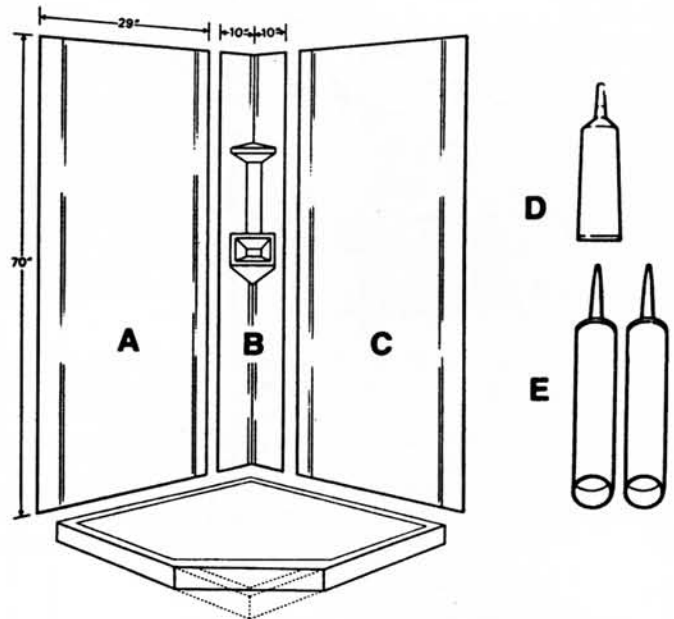

## INCLUDED IN THE CARTON

- A One left side panel
  - B One corner panel with soap dish and shampoo shelf
  - C One right side panel
  - D One tube of caulk
  - E Two tubes of adhesive
- Owners Manual

## TOOLS REQUIRED TO INSTALL

The only tools needed are a saber saw or drill, ruler, caulking gun and whatever tools needed to remove faucet handles.

Panels mount to the wall with supplied adhesive. Panels come with factory applied pressure sensitive tape affixed permanently to the outside edges.

**DO NOT NAIL PANELS TO SUBWALLS. THE HOLES IN THE PANELS ARE FOR MANUFACTURING PURPOSES ONLY!**

**Inspect all panels before installation for damage that may have occurred in handling or transit.**

### MEASURE AND TRIAL FIT BEFORE YOU START

Measure the two side walls. If either of them measure less than 35 1/2", this unit cannot be used. If over 38", extension panels are available.

After shower receptor has been installed, dry wall applied to framed in areas proceed to complete the walled sections of shower as follows.

If walls are out of plumb, it may be necessary to file bottom edge of panels to achieve a good fit across the top.

### FILLER BOARD

Measure the height of your tile from the shower floor ledge up...if tile is less than 70" then you must install a filler board. The filler board must equal the same thickness of the missing tile. Usually 1/4" masonite or similar material is adequate.

For best results run your filler board from the tile ledge to the ceiling.

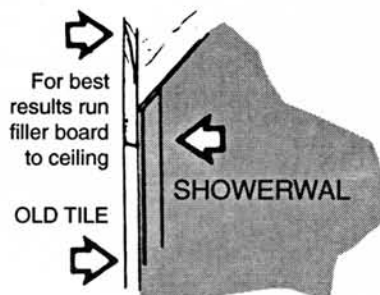

## WALL SURFACE PREPARATION RECOMMENDATIONS FOR SHOWER WALL UNITS

### When installing over SHEETROCK/GREENBOARD/WOOD:

- A.** Surface must be dry, smooth, and free of any dust, soap scum or any other contaminants. Wipe wall surface with a damp cloth.
- B.** To insure proper adhesion between the Swanstone product and Sheetrock/Greenboard/Wood, it is best to use a primer/sealer, and it is **IMPORTANT** to follow these guidelines: Oil based primer/sealers (such as Bin-Seal, or all purpose enamel paint) should **NOT** be used to cover the entire wall surface (Sheetrock/Greenboard/Wood) but only should be applied at the areas where the double-faced tape adheres to the wall surface. Water based primer/sealers (such as latex paint) **MAY** be used to cover the entire wall surface (Sheetrock/Greenboard/Wood).
- C.** After the proper primer/sealer is completely dry, complete the installation following the installation instruction sheet.

### When installing over PLASTER:

- A.** Surface must be dry, smooth and free of any dust, soap scum or any other contaminants. Wipe wall surface with a damp cloth.
- B.** The wall surface (textured/swirled finish must be sanded smooth) must be sealed with a primer (Bin-Seal or other primer/sealer).
- C.** After primer/sealer is completely dry, complete the installation following the installation sheet.

### When installing over CEMENT/CONCRETE:

- A.** Surface must be dry, smooth and free of any dust, soap scum or any other contaminants. Wipe wall surface with a damp cloth.
- B.** The complete area must be sealed with two coats of primer. (Bin-Seal or other primer/sealer).
- C.** After primer/sealer is completely dry, complete the installation following the installation sheet.

### NOTE:

- CERAMIC: LOOSE TILE MUST BE REMOVED.**
- PLASTIC: ALL TILES MUST BE REMOVED.**

### When installing over OLD TILE:

- A.** Rough up the glossy tile surface by belt sanding the wall area with 60-grit sandpaper.
- B.** Surface must be dry, smooth and free of any dust, or any other contaminants. Wipe wall surface with a damp cloth.
- C.** For proper adhesion, the wall surface must be sealed with a primer (Bin-Seal or other primer sealer).
- D.** After primer/sealer is completely dry, complete the installation following the installation sheet.

### When installing over WALL PAPER:

- A.** All wallpaper must be removed from the area to be covered. Surface must be dry, smooth and free of any dust, soap scum or any other contaminants. Wipe wall surface with a damp cloth.
- B.** The complete wall surface area to be covered by unit must be sealed with two coats of primer (Bin-Seal or other primer sealer).
- C.** After primer/sealer is completely dry, complete the installation following the installation sheet.

### When installing over MASONITE:

- A.** Surface must be dry, smooth and free of any dust, soap scum or any other contaminants. Wipe wall surface with a damp cloth.
- B.** For proper adhesion, the wall surface must be sealed with a primer (Bin-Seal or other primer sealer).
- C.** Complete the installation following the installation sheet.

## THE INSTALLATION

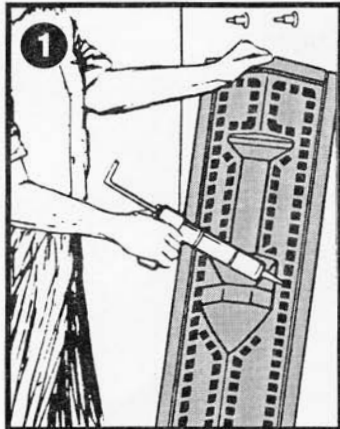

- 1**  
Trial fit the corner panel to make sure it is not obstructed by shower valve. Apply adhesive to the back of the corner panel (adding a circle of adhesive around the soap dish and shampoo shelf), keeping the adhesive 1" away from the factory applied tape.



- 2**  
Remove the backing from the pressure sensitive tape. Grasp the corner panel by edges then carefully position in corner. Press firmly into the corner from top to bottom, making sure all tape and adhesive is in good contact with the wall.

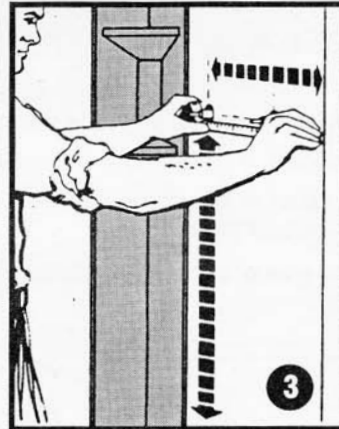

- 3**  
Note: The flat side panels are not interchangeable, but are clearly marked on the backs as to **TOP** and **RIGHT** or **LEFT** side. These panels are slightly taller than the corner panel forming an overlap and water tight seal.

- 3**  
Measure location of plumbing outlets from the front edge of shower and height above where lower edge of side panel will ultimately rest. Mark location of outlets on the appropriate right or left side panel. Be sure you are marking the correct panel.



- 4**  
Use a drill and a hole cutting bit, or a hole saw. Cut holes 1/2" larger than the diameter of the pipes. Drill or cut from finished side of the end panel. For best results place scrap wood beneath hole to be cut, this will give you a clean cut opening.

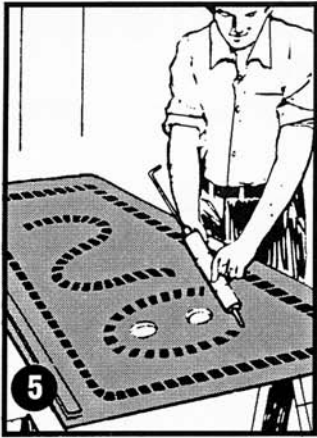

**5**  
Prepare to apply side panel to wall. Apply adhesive to back, (follow pattern shown in illustration) adding a circle of same around the drilled holes. Keep all adhesive 1" away from factory applied tape.

Side panels are slightly taller than corner panel, this allows overlap at top edge.



**6**  
Remove the backing from pressure sensitive tape. Grasp side panel by edges, carefully position by overlapping corner panel. Press firmly from top to bottom, then press the entire surface the same way to insure solid wall contact. The overlapping should be a minimum of 1".

This procedure should be used for both side panels.



**7**  
Next, prepare the other side panel. Apply adhesive in similar pattern as shown. Grasp side panel by edges, carefully position, overlapping corner panel. Press firmly into the corner from top to bottom, then press the entire surface the same way to insure solid wall contact.



**8**  
Following instructions on the caulking tube . . . apply a bead of caulking along the bottom edge of corner panel and side panels. The side panels' lapping edges and the extreme left and right front edges of end panels may also be caulked if desired, however, it is NOT necessary.

## CARE AND CLEANING

All panels in this kit are made of fiberglass reinforced polyester with a tough polyurethane coating. Finish is stain and abrasion resistant; however, the finish requires reasonable care.

Wash regularly with warm water, use soft cloth with mild detergent such as – Handy Andy, Mr. Clean, or Lestoil.

Scouring pads made of nylon, saran or polyethylene may be used but NEVER USE ABRASIVE SCOURING POWDERS, CLEANERS OR PADS...THEY DULL THE FINISH.

Protect finish with any fiberglass wax or automotive paste wax.

## CAUTION

Dry cleaning agents and solvents will damage the surface. Burning cigarettes will damage and discolor surface.