

## ANYSTREAM® HOTEL

**S-2005-H**



### GENERAL SPECIFICATION

Water conserving pressure compensating Autoflo® device reduces flow to 2.5 GPM/9.46LPM maximum, to meet existing ASME A112.18.1/CSA B125.1 standard. Brass threaded inlet with ½" NPSM inlet. There is also a dual action combination spray.

**S-2005-H**

Polished chrome plated Anystream® Hotel Showerhead. Spray adjusting T-handle. 3½" face. 5 self-cleaning plunger nozzles resist scale build-up and provide 50 spray streams for a full body coverage pattern. Center core nozzles deliver 8 pulsating-massage jets.

**S-2005-HB**



**S-2005-HB**

Polished chrome plated Anystream® Hotel Showerhead. Spray adjusting T-handle. 5 self-cleaning plunger nozzles resist scale build-up and provide 50 spray streams for a full body coverage pattern. Center core nozzles deliver 8 pulsating-massage jets.

**S-2005-HS**



**S-2005-HS**

Polished chrome plated Anystream® Hotel Showerhead. Spray adjusting T-handle. 5 self-cleaning plunger nozzles resist scale build-up and provide 50 spray streams for a full body coverage pattern. Center core nozzles deliver 8 pulsating-massage jets.

### OPTIONS

SUFFIX	DESCRIPTION
<input type="checkbox"/> E2	2.0 GPM flow rate (polished chrome finish only, not available on S-2005-HS)
<input type="checkbox"/> PB	Polished brass (S-2005-HB only)
<input type="checkbox"/> BN	Brushed nickel finish (S-2005-H & S-2005-HB only)
<input type="checkbox"/> BP	Blister pack packaging
<input type="checkbox"/> BC	Brushed chrome finish (S-2005-HB only)

\_\_\_\_\_  
 This space for Architect/Engineer approval.



# SPEAKMAN CASPIAN™

## Accessories

SPECIFICATION

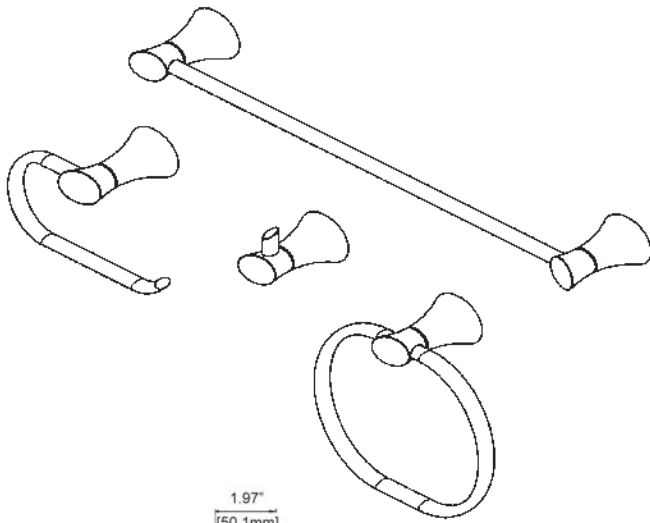

### FEATURES:

- SA-1207: 24" towel bar
- SA-1204: Towel ring
- SA-1205: Paper holder
- SA-1206: Robe hook
- Metal construction

### AVAILABLE FINISHES:

ADD SUFFIX TO MODEL #

- Polished Chrome (standard)
- Brushed Nickel  -BN
- Polished Nickel  -PN

### WARRANTY:

- 1 year limited

Robe Hook  
SA-1206

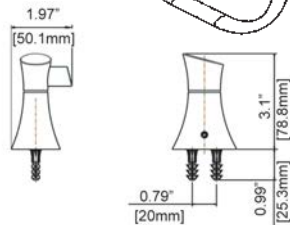

Towel Ring  
SA-1204

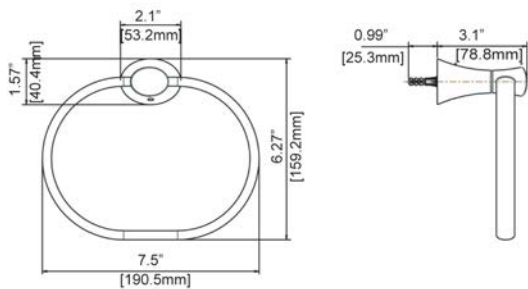

Tissue Holder  
SA-1205

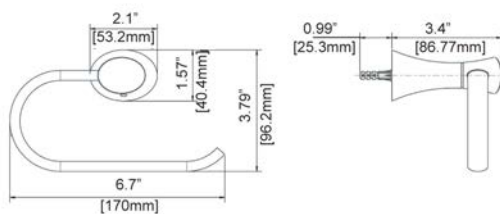

Towel Bar  
SA-1207

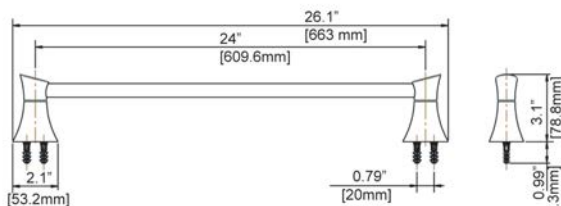

NOTE: 1. All dimensions are in inches (millimeters) unless otherwise specified and are subject to change without notice.

THIS SPACE FOR ARCHITECT/ENGINEER APPROVAL.

**SPEAKMAN®**

400 ANCHOR MILL ROAD | NEW CASTLE, DE 19720  
P: 800-537-2107 | F: 800-977-2747  
WWW.SPEAKMANCOMPANY.COM



REVISION DATE: DEC. 2012

# SPEAKMAN CASPIAN™

## 8" Widespread Faucet SB-1221

SPECIFICATION

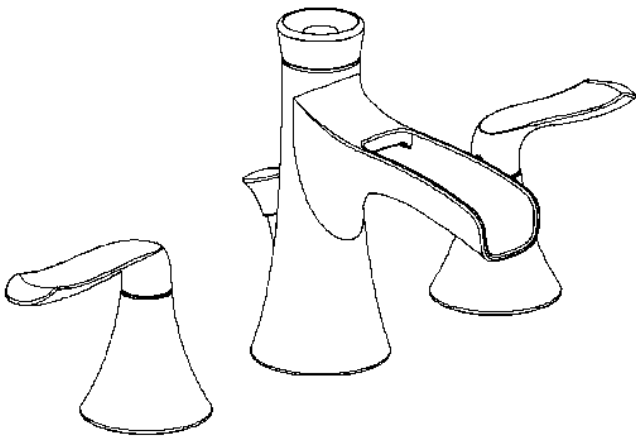

### FEATURES:

- Lead-free brass construction
- ¼ turn ceramic cartridge
- 1.5 gpm flow rate
- Contemporary style
- Includes drain assembly
- Quick connect fittings

### COMPLIANCE:

- Certified to ASME A112.18.1/CSA B125.1, NSF61 and WaterSense standards
- CA AB 1953 certified



### AVAILABLE FINISHES:

ADD SUFFIX TO MODEL #

- Polished Chrome (standard)
- Brushed Nickel  -BN
- Polished Nickel  -PN

### WARRANTY:

- 1 year limited

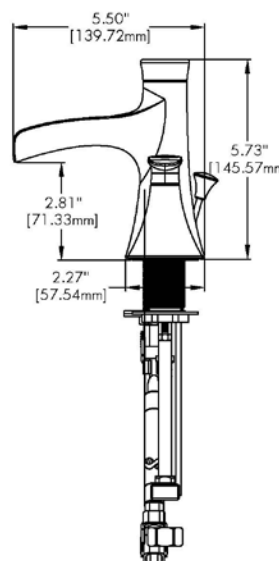
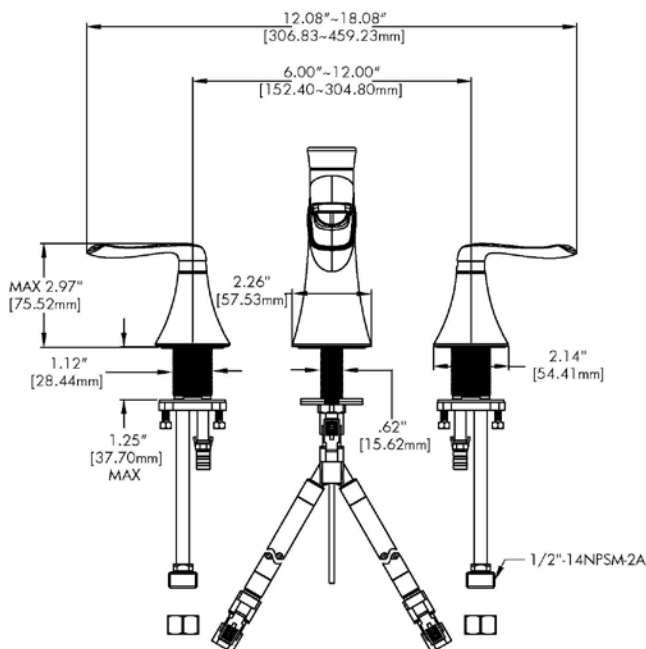

NOTE: 1. All dimensions are in inches (millimeters) unless otherwise specified and are subject to change without notice.

THIS SPACE FOR ARCHITECT/ENGINEER APPROVAL.

# SPEAKMAN®

400 ANCHOR MILL ROAD | NEW CASTLE, DE 19720  
P: 800-537-2107 | F: 800-977-2747  
WWW.SPEAKMANCOMPANY.COM

Management Systems  
Registered to ISO 9001

REVISION DATE: FEB. 2013