

Premier®

Brand Tub & Shower Faucets

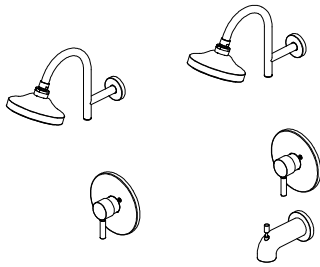

Model Number: 120091 & 120092 & 120093 & 120094

INSTALLATION

Tools:

Adjustable wrench



Pipe tape



Pipe wrench



Groove joint pliers



Basin wrench



screwdriver



Plumber's putty



Cleaning:

To maintain and protect the fine luster of all products, clean with a soft damp cloth only. DO NOT USE detergents or cleanser as they may harm the protective finish.

INSTALLATION STEPS: Tub & Shower faucets

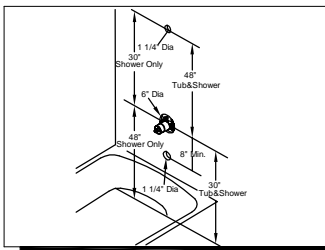

1. SHUT OFF WATER SUPPLY.

Verify that the hole sizes and positions of holes in the wall are correct.

Recommended component measurements.

A. Shower and / or spout outlet hole: 1-1/4" diameter.

B. Valve access hole: 6 inch diameter.

C. Recommended valve depth to finished wall: 2" min. to 2-1/2" max.

Be sure that the black template plate's surface is flush with the finished exterior surface of the wall. Be sure to position the valve body correctly in wall. "UP" marking up. The 8" Minimum from the valve body to the tub spout is required for proper operation.

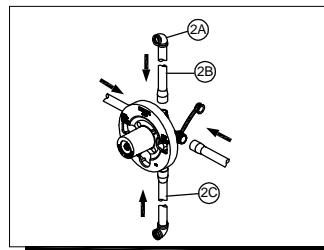

2a. SUPPLY CONNECTION LAYOUT

Wrap plumber's tape around pipe threads in a clockwise direction. Connect water supplies to left (hot) and right (cold) valve body inlets. Connect shower outlet pipe (2B) and tub outlet pipe (2C) to valve body. Connect Pipe Elbow (2A) (not included) to the end of the pipe.

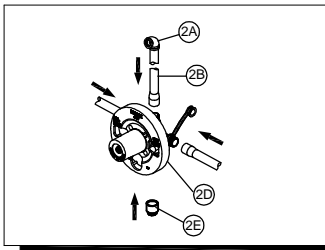

2b. SHOWER ONLY SUPPLY CONNECTION LAYOUT

Wrap plumber's tape around pipe threads in a clockwise direction.

Connect water supplies to left (hot) and right (cold) valve body inlets.

Connect Shower Outlet Pipe (2B) to valve body. Plug bottom outlet (2D) with plug (2E). Connect Pipe Elbow (2A) (not included) to the end of the pipe.

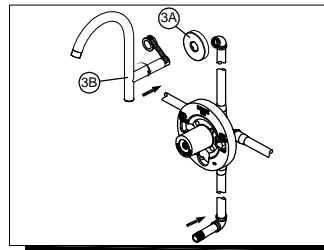

3. FOR SHOWER ARM INSTALLATION.

Insert the long end of the shower arm (3B) through the flange (3A) then wrap plumber's tape to both sides of shower arm. Screw long end of the shower arm into pipe elbow inside the wall.

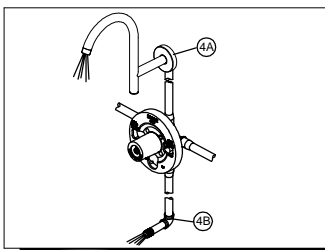

4. FLUSHING

For Tub and Shower Combinations:

Turn on Hot and Cold water supply lines allowing water to flow from tub spout outlet (4B) until all foreign matter has cleared the line.

For Shower Only Combinations:

Turn on Hot and Cold water supply lines allowing water to flow from shower outlet (4A) until all foreign matter has cleared the line. Pressure must be approximately equal on both Hot and Cold sides for valve to function properly.

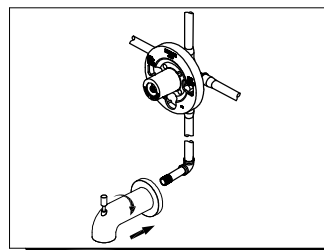

5. FOR TUB SPOUT INSTALLATION

Install tub spout. Thread spout onto threaded connection clockwise until the spout becomes flush with the finished wall. Thread sealant may be required depending on your installation method. All thread sealants may be found at your local hardware store.

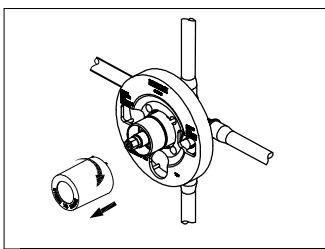

6. Before installing escutcheon, remove the plastic cap from plaster guard by twisting cap in a clockwise direction. Remove the screw from the inverter.

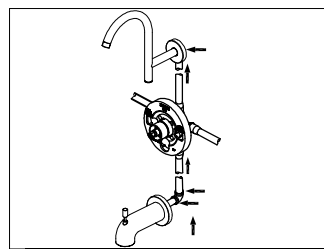

7. Place handle on valve stem and turn handle to full on mixed position. Turn on hot and cold water lines to full open for one minute each. Check for leakage. Shut off water at faucet. Remove the handle.

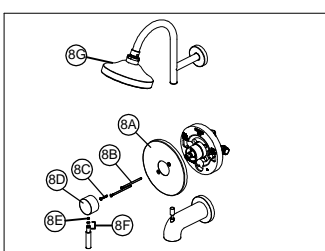

8. Install escutcheon (8A) onto valve and then insert screws (8B) to attach to valve body. Insert screw (8C) into inverter. Place handle seat (8D) onto the valve and secure with set screw (8E). Install handle assembly (8F). Attach shower (8G) to shower flange.

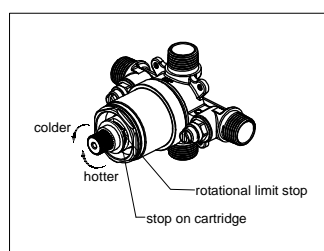

7. ADJUSTING WATER TEMPERATURE

Turn on water so that cold water is as cold as it will get and hot water is as hot as it will get. Remove the Rotational Limit Stop from the valve by sliding it off the stem. Place handle back on stem and rotate fully counterclockwise to the hottest position. Place a thermometer in a plastic tumbler and hold in the water stream. If the water temperature is above 120° F, the Rotational Limit Stop must be rotated counterclockwise to decrease temperature. Reinstall the stop by sliding it back on to the stem before reinstalling the handle. MAKE SURE COLD WATER FLOWS FROM THE VALVE FIRST. MAKE SURE WATER (AT THE HOTTEST FLOW) DOES NOT EXCEED THE TEMPERATURE LIMIT ALLOWED BY YOUR PLUMBING CODES (120° F OR 110° F).

Parts List

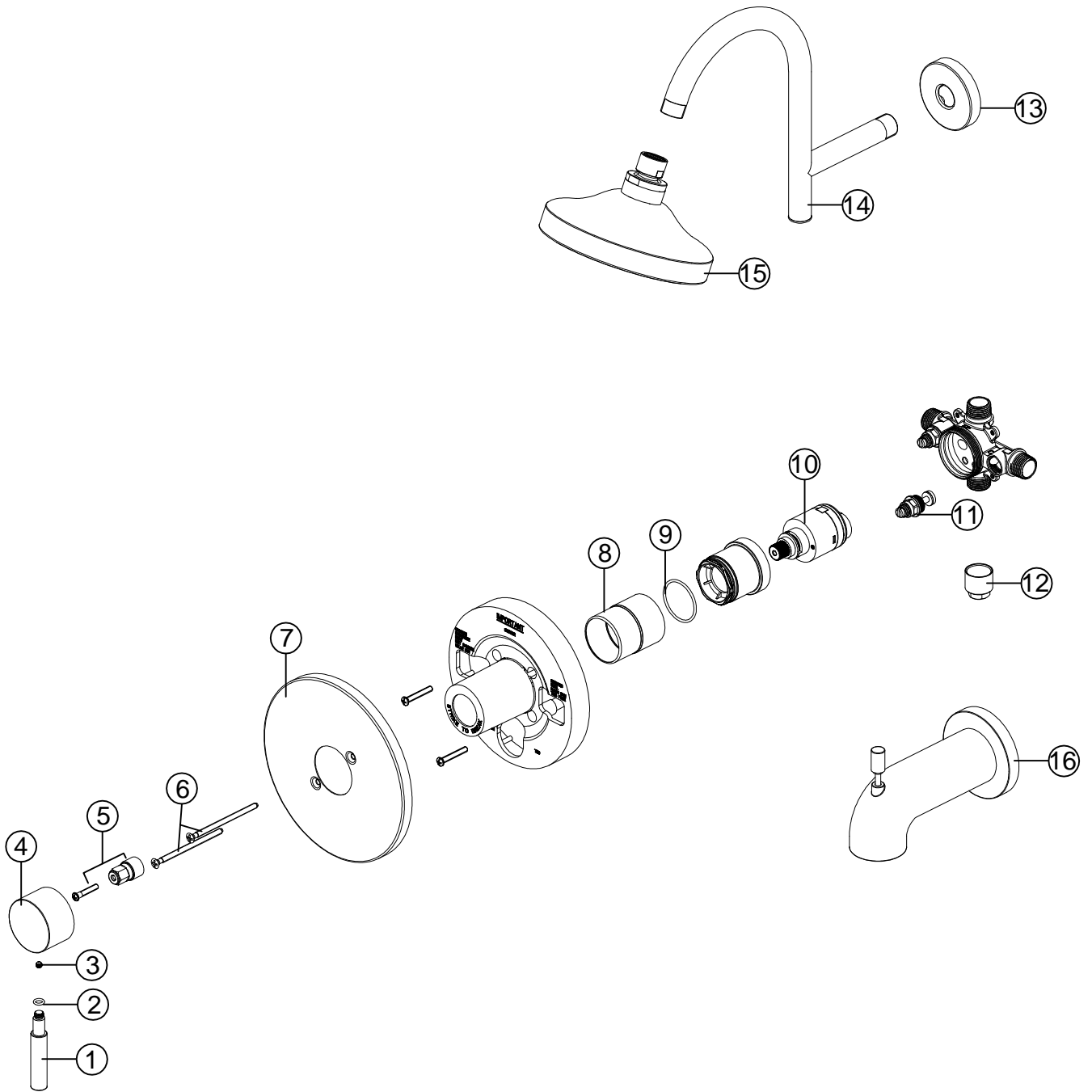

MODEL NO.120091			
NO.	PART DESCRIPTION	PART NO.	QTY.
1	Handle	247	1
2	O-ring	259	1
3	Set Screw	20	1
4	Handle Seat	280	1
5	Handle Adapter Kit	994692	1
6	Screws	994442	1
7	Escutcheon	281	1
8	Sleeve	283	1
9	O-ring	282	1
10	Cartridge	994695	1
11	Integral Stop	994722	1
12	Plug	284	1
13	Shower Flange	285	1
14	Shower Arm	286	1
15	Shower Head	287	1

MODEL NO.120092			
NO.	PART DESCRIPTION	PART NO.	QTY.
1	Handle	255	1
2	O-ring	259	1
3	Set Screw	20	1
4	Handle Seat	295	1
5	Handle Adapter Kit	994692	1
6	Screws	994442	1
7	Escutcheon	296	1
8	Sleeve	297	1
9	O-ring	282	1
10	Cartridge	994695	1
11	Integral Stop	994722	1
12	Plug	284	1
13	Shower Flange	298	1
14	Shower Arm	299	1
15	Shower Head	300	1

MODEL NO.120093			
NO.	PART DESCRIPTION	PART NO.	QTY.
1	Handle	247	1
2	O-ring	259	1
3	Set Screw	20	1
4	Handle Seat	280	1
5	Handle Adapter Kit	994692	1
6	Screws	994442	1
7	Escutcheon	281	1
8	Sleeve	283	1
9	O-ring	282	1
10	Cartridge	994695	1
11	Integral Stop	994722	1
12	Plug	284	1
13	Shower Flange	285	1
14	Shower Arm	286	1
15	Shower Head	287	1
16	Spout	288	1

MODEL NO.120094			
NO.	PART DESCRIPTION	PART NO.	QTY.
1	Handle	255	1
2	O-ring	259	1
3	Set Screw	20	1
4	Handle Seat	295	1
5	Handle Adapter Kit	994692	1
6	Screws	994442	1
7	Escutcheon	296	1
8	Sleeve	297	1
9	O-ring	282	1
10	Cartridge	994695	1
11	Integral Stop	994722	1
12	Plug	284	1
13	Shower Flange	298	1
14	Shower Arm	299	1
15	Shower Head	300	1
16	Spout	301	1