

NEWPORT BRASS.

Flawless Beauty. From Faucet to Finish.™

**INSTALLATION INSTRUCTIONS
POT FILLER
MODEL NO. 948, 949**

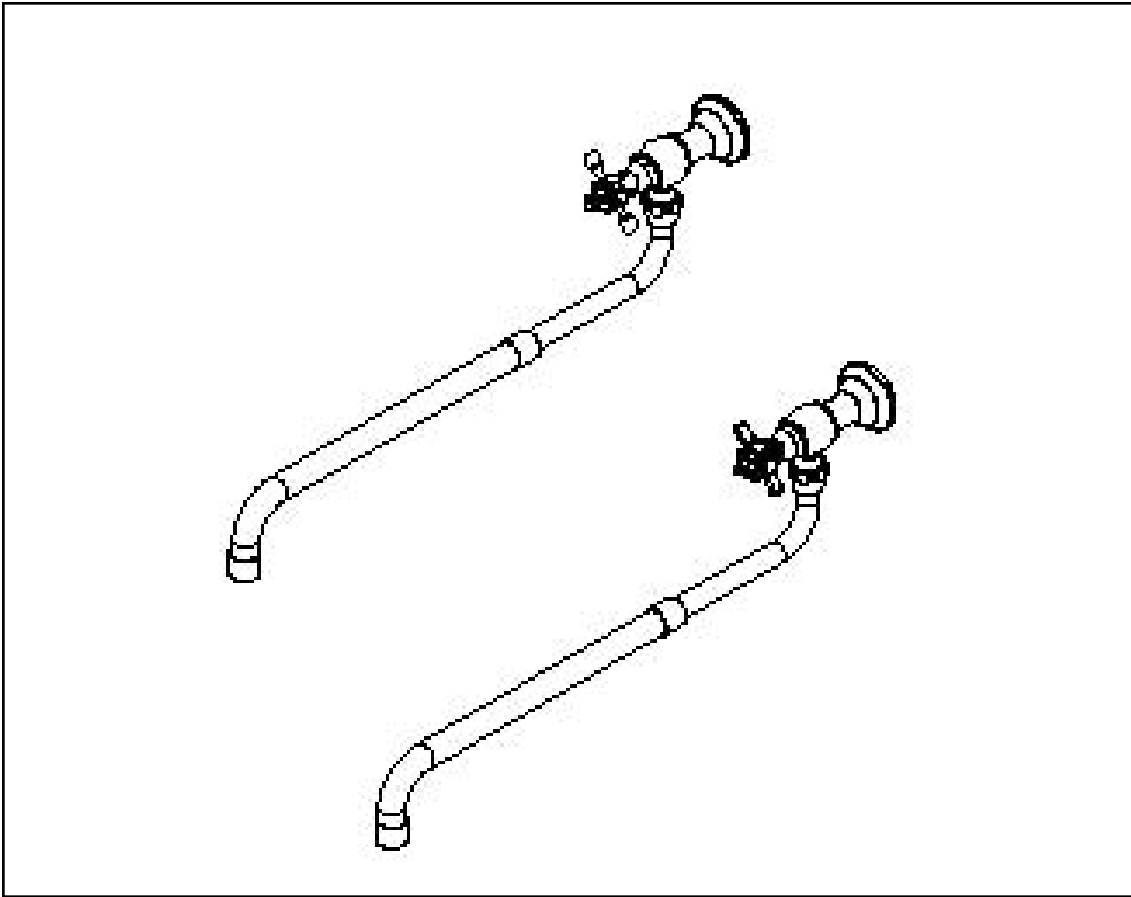

**Congratulations on the purchase
of your Newport Brass product,
an excellent choice, that will give you
years of quality service and enhance
the look and style of your home.**

Recommended Installation by a Professional Plumbing Contractor

Note: The use of petroleum base plumbers putty on our products will nullify the warranty. We recommend the use of clear silicone sealing materials.

1. Shut off water supply. Tap into existing cold water supply and run to desired location on the wall for 1/2-14 NPT connection.
2. Remove telescoping SPOUT (1) from BODY (2). See Figure 1.
3. Attach BODY (2) to water supply (3). See Figure 2.
4. Reattach telescoping SPOUT (1) to BODY (2).
5. Turn on water supply, and flush valve until water is clear. Check for leaks and make any final adjustments required.

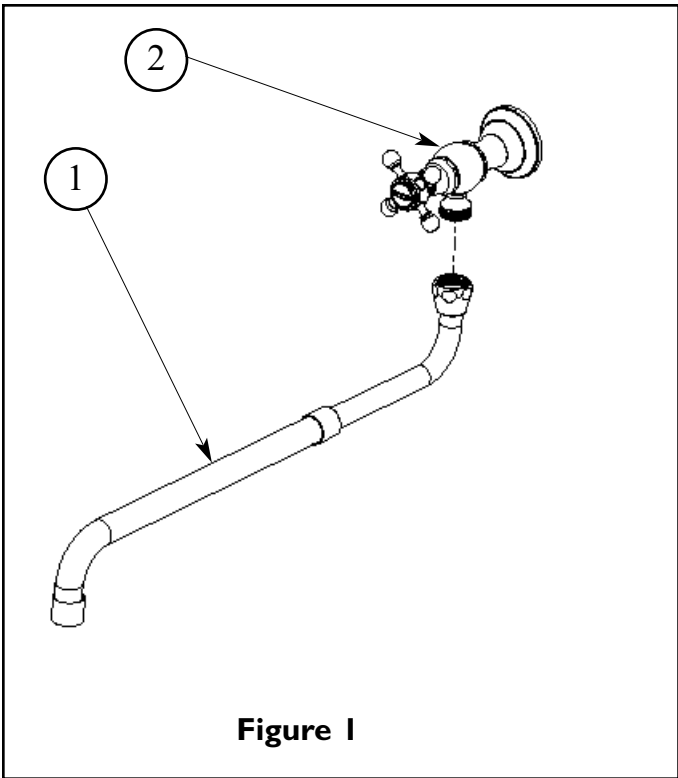

Figure 1

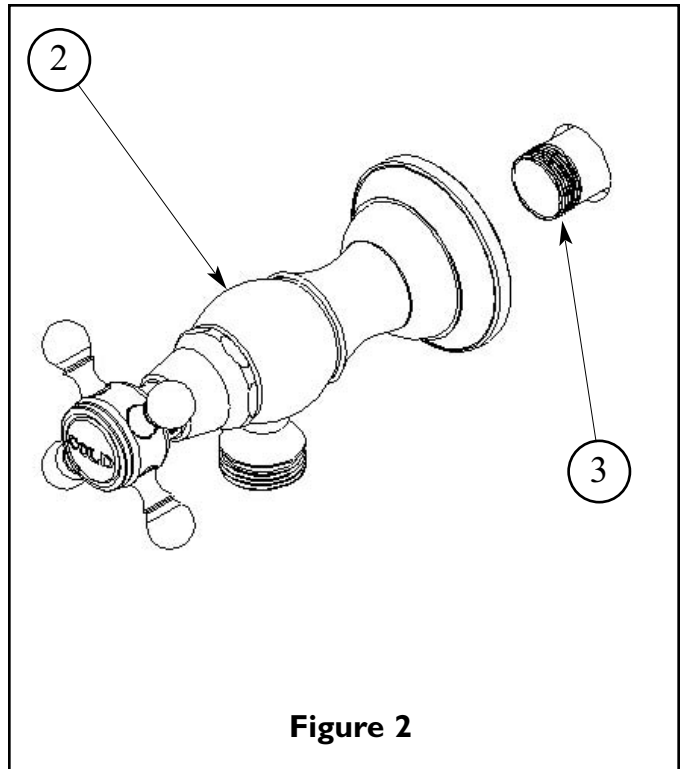

Figure 2