

**FEATURES**

- Brass construction
- Available with blade handle
- Push button diverter

**BATH AND SHOWER FAUCET TRIM**

**K-T948**

**ALSO K-T949, K-T950, K-951, K-952, K-304, K-305**

**ADA**

**CODES/STANDARDS APPLICABLE**

Specified model meets or exceeds the following:

- ASME/ANSI A112.18.1M
- ASSE/ANSI 1016
- CSA B125 (K-T16115, K-T6116)
- IAPMO/UPC (K-T16115, K-T6116)

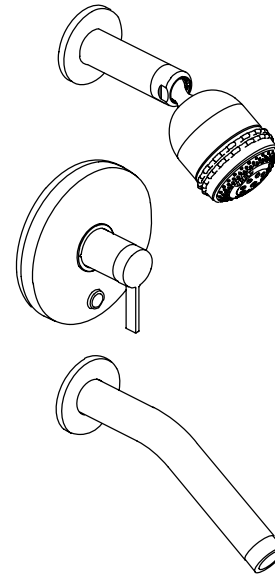

**COLORS/FINISHES**

- CP Polished Chrome
- Other Refer to Faucets Price Book for additional finishes

**SPECIFIED MODEL:** For complete faucet, both faucet trim and Rite-Temp valve must be specified.



Model	Description	<input type="checkbox"/> CP	<input type="checkbox"/> Other_____
K-T948-4	Bath and Shower Trim, Blade Handle	<input type="checkbox"/> CP	<input type="checkbox"/> Other_____
K-T949-4	Shower Only Trim, Blade Handle	<input type="checkbox"/> CP	<input type="checkbox"/> Other_____
K-T950-4	Valve Only Trim, Blade Handle	<input type="checkbox"/> CP	<input type="checkbox"/> Other_____
K-951	Shower Head, Arm and Flange	<input type="checkbox"/> CP	<input type="checkbox"/> Other_____
K-952	Bath Spout	<input type="checkbox"/> CP	<input type="checkbox"/> Other_____

**Required Accessory on Page 2.**

**PRODUCT SPECIFICATION:**

Rite-Temp pressure-balancing single-control bath and shower faucet trim shall be of brass construction. Bath and shower trim shall include showerhead with arm and flange, 8-3/4" (22.2cm) non-diverter spout with N.P.T. connection, and faceplate with handle and push-button diverter. Shower only trim shall include showerhead with arm and flange, and faceplate with handle. Valve only trim shall include faceplate with handle. Faucet trim shall be K-T\_\_\_\_\_ - \_\_\_\_\_ - \_\_\_\_\_ and Rite-Temp valve shall be K-\_\_\_\_\_ - \_\_\_\_\_ -NA.

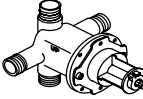
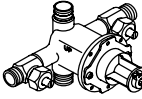
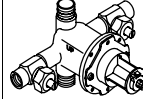
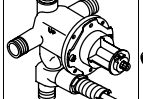
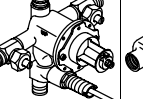
# STILLNESS™

Required Accessory							
K-304-K	Rite-Temp Valve Without Stops	<input type="checkbox"/> NA					
K-304-KS	Rite-Temp Valve With Stops		<input type="checkbox"/> NA				
K-304-KP	Rite-Temp Valve With PVC Connections			<input type="checkbox"/> NA			
K-305-K	Rite-Temp Valve Without Stops				<input type="checkbox"/> NA		
K-305-KS	Rite-Temp Valve With Stops					<input type="checkbox"/> NA	
K-306-KS	HiFlow Rite-Temp Valve With Stops						<input type="checkbox"/> NA

## PRODUCT INFORMATION



**WARNING: Risk of damage to the K-306-KS valve assembly.** When using the K-306-KS valve in a fiberglass or acrylic installation, use the thin wall installation kit (88526).

## INSTALLATION NOTES

Avoid cross-flow conditions. Do not install shut-off device on either valve outlet.

Cap shower outlet if deck-mount spout, diverter, or handshower is connected to spout outlet.

Install straight pipe or tube drop of 7" (17.8cm) to 18" (45.7cm) with single elbow between valve and wall-mount spout.

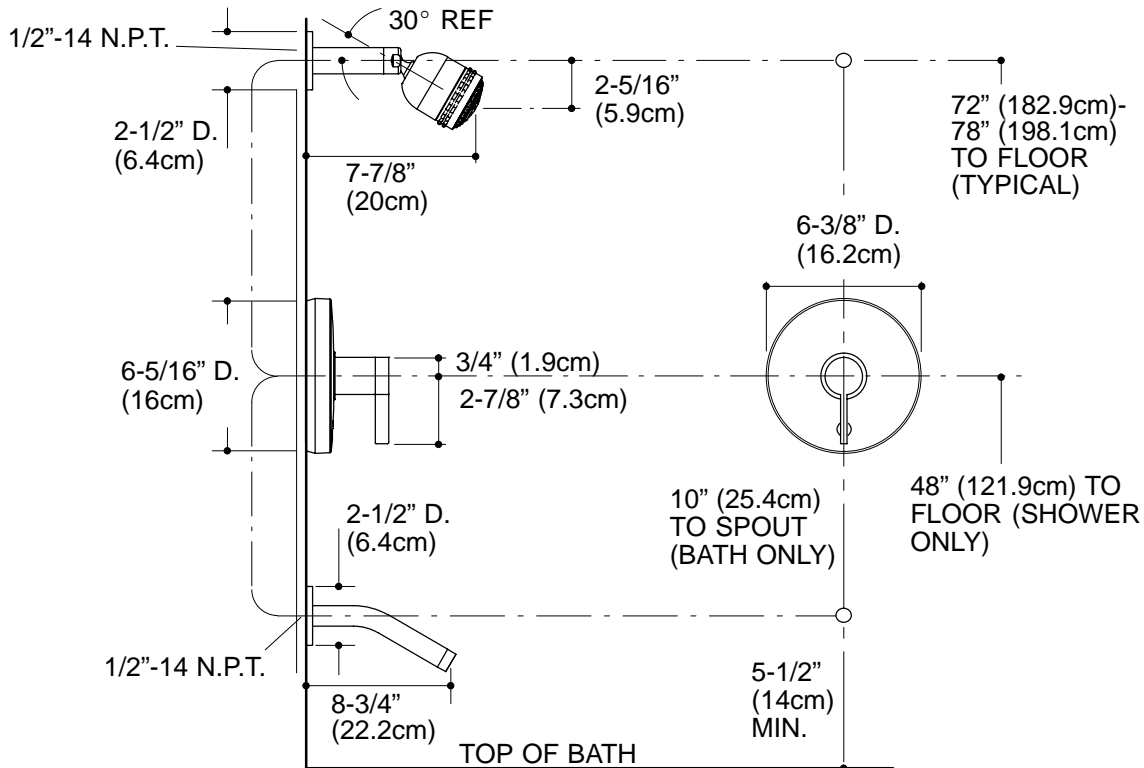

## PRODUCT DIAGRAM