

INSTALLATION

G U I D E

ANTIQUÉ™  
BATH AND SHOWER  
FAUCET TRIM

THE BOLD LOOK  
OF **KOHLER**®

## IMPORTANT INSTRUCTIONS

---

### READ AND SAVE FOR THE CONSUMER

 **WARNING: Risk of scalding or other severe injury.**

- Before completing installation, the installer must set the maximum water temperature setting of this valve to minimize the risks associated with scalding hazards according to ASTM F 444.
- Do not install a shut-off device on either outlet of this valve. The installation of any such device may create a cross-flow condition at the valve and affect the water temperature.
- Factors that change the temperature of the water supplied to the valve, such as seasonal water temperature changes, and water heater replacement or servicing, will change the maximum water temperature supplied by the valve and may create a scalding hazard.

**The installer is responsible for installing the valve and adjusting the maximum water temperature of this valve according to instructions.**

**This valve meets or exceeds ANSI A112.18.1M (all valves) and ASSE 1016 (pressure-balanced valves only).**

If you do not understand any of the installation or temperature adjustment instructions in this document, in the United States please contact our Customer Service Department at **1-800-4-KOHLER**. Outside the U.S. please contact your distributor.

**IMPORTANT:** Please fill in the blanks below and on the valve label. Then insert these instructions into the plastic bag included with the valve package, and attach the plastic bag to the valve handle for the owner's reference.

**This device has been preset by \_\_\_\_\_  
of \_\_\_\_\_ to ensure a safe maximum  
temperature. Any change in the setting may raise the  
discharge temperature above the limit considered  
safe, and lead to scalds. Date: \_\_\_\_\_**

### PRESSURE-BALANCED VALVES ONLY

- Pressure-balanced valves may not provide protection against scalding if there is a failure of other temperature-limiting devices elsewhere in the plumbing system.
- The pressure-balanced valve **will not** compensate for changes in the water supply temperature; adjust the maximum water temperature setting of this pressure-balanced valve when such changes occur.

## RECOMMENDED TOOLS AND MATERIALS

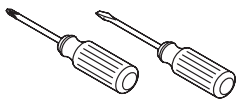

Assorted  
Screwdrivers

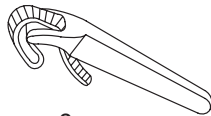

Strap  
Wrench



Plumbers  
Putty



Thread  
Sealant  
Tape

## BEFORE YOU BEGIN



**WARNING: Risk of damage to the K-306-KS valve assembly.**

When using the K-306-KS HiFlow Valve in a fiberglass or acrylic installation, use the Thin Wall Installation Kit (88526).

- Observe all local plumbing codes.
- Finished wall or bath/shower unit must be installed prior to installing this trim.
- We recommend that you determine if the maximum water temperature is acceptable prior to installing this trim. If temperature adjustment is needed, refer to the “Adjustments” section.
- The valve shuts off by water pressure. Do not force the handle in any direction. To turn the valve off, gently turn it to the “Off” position.

**IF THE VALVE AND FINISHED WALL ARE NOT INSTALLED, INSTALL AT THIS TIME. BE SURE TO FOLLOW ALL INSTRUCTIONS PACKED WITH THE VALVE.**

## 1. INSTALL SPOUT

Remove the temporary nipple from the bath elbow.

Apply thread sealant, and install a 1/2" nipple to the bath elbow so it extends:

- 7/16" beyond the finished wall for the 4-7/8" diverter spout,
- 1/2" beyond the finished wall for the Antique diverter spout,
- 6-1/4" beyond the finished wall for the Antique non-diverter spout.

Apply plumbers putty or other sealant to the inlet end of the spout according to the putty manufacturer's instructions. Apply thread sealant to the nipple, and install the spout to the nipple. Carefully tighten with a clean strap wrench.

Remove any excess putty.

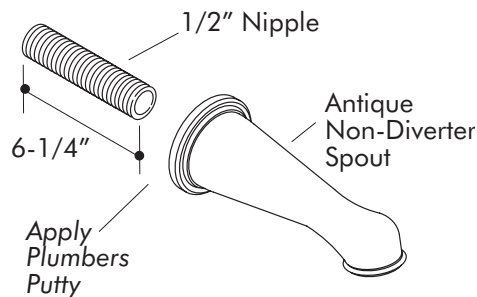
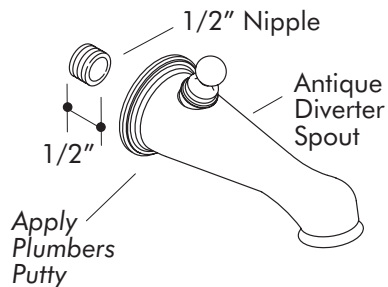
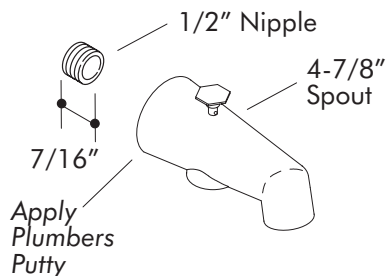

## 2. INSTALL SHOWER ARM AND SHOWERHEAD



**CAUTION: Risk of product damage.** To avoid plugging the showerhead spray outlets, use thread sealant tape on shower arm threads. Do not use thread sealant (pipe dope).

Remove the temporary nipple from the shower elbow.

Apply plumbers putty or other sealant to the back of the escutcheon according to the putty manufacturer's instructions. Slide the escutcheon onto the shower arm.

Apply thread sealant tape to the shower arm and install the shower arm to the shower elbow. Carefully tighten with a clean strap wrench.

Press the escutcheon against the finished wall, and secure to the shower arm by tightening the setscrew. Remove any excess putty.

With the showerhead off, flush out the system.

Apply thread sealant tape to the shower arm and install the showerhead to the shower arm.

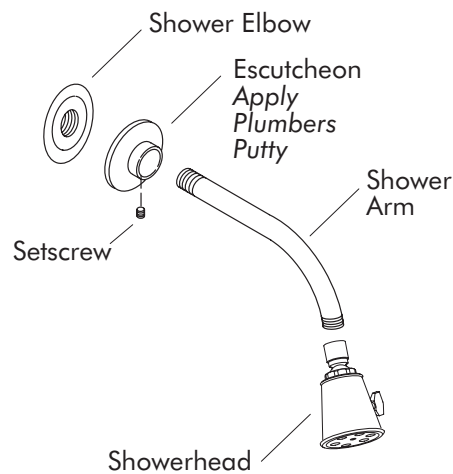

### 3. ADJUSTMENTS

#### MAXIMUM WATER TEMPERATURE ADJUSTMENT

**NOTE:** Do not remove the O-ring and collar at this time. Removing the O-ring and collar will change the factory setting for the maximum water temperature.

**For minor water temperature changes,** adjust the setscrew.

To check for significant water temperature changes, turn the valve clockwise to the full open position and let the hot water run for several minutes. Position a thermometer in the water stream. The water temperature should never be set above 120° F.

**For major water temperature changes,** remove the O-ring and collar from the valve stem. Slowly rotate the valve stem until the water temperature is as desired. Reinstall the collar on the valve stem so the setscrew is against the side of the tab. Reinstall the O-ring, and rotate the valve stem counterclockwise to shut the water off. Recheck water temperature to ensure desired water temperature.

**NOTE:** After installation, complete the required information on the valve label.

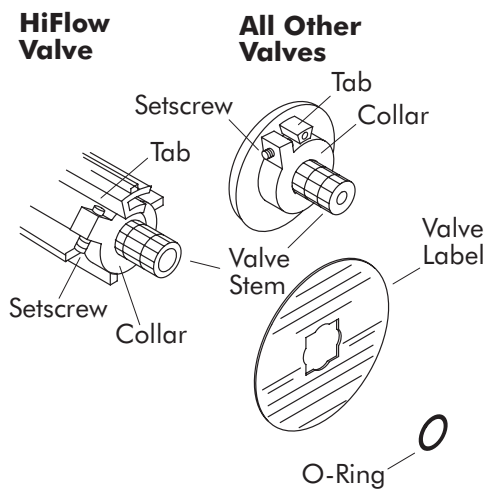

## 4. INSTALL FACE PLATE AND HANDLE



**WARNING: Risk of damage to the K-306-KS valve assembly.** When using the K-306-KS HiFlow Valve in a fiberglass or acrylic installation, use the Thin Wall Installation Kit (88526).

Remove and discard the plaster guard and/or dome, if installed.

Fit the face plate and centering washer over the valve, and secure with two screws.

Rotate the valve stem fully counterclockwise.

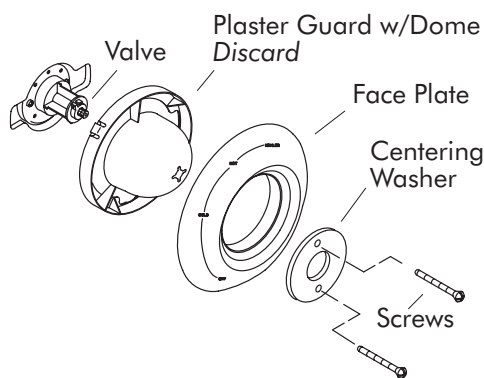

### LEVER HANDLE

Slide an O-ring fully onto the handle, and slide the insert over the handle shank. Fit the second O-ring over the handle shank. Secure with the washer and nut. Hand tighten the end cap to the handle.

Install the sleeve and bonnet to the valve stem. Align the handle assembly, and secure to the valve stem with the screw.

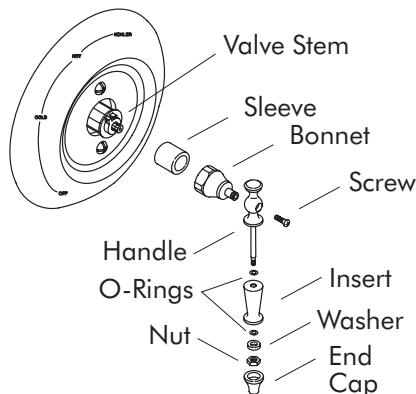

### SIX-PRONG HANDLE

Install the sleeve and bonnet to the valve stem, and secure with the screw. Press the handle onto the bonnet, and secure in place with the setscrew.

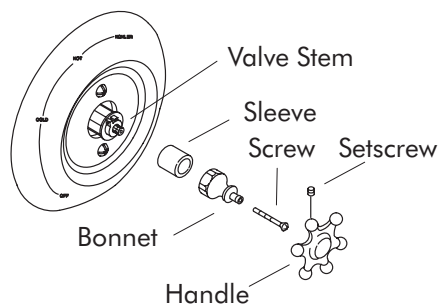

## OVAL HANDLE

Install the sleeve and bonnet to the valve stem. Align the handle, and secure to the valve stem with the screw.

Press the cap onto the handle, and secure with the small screw.

Align the handle on the bonnet, and secure in place with the setscrew.

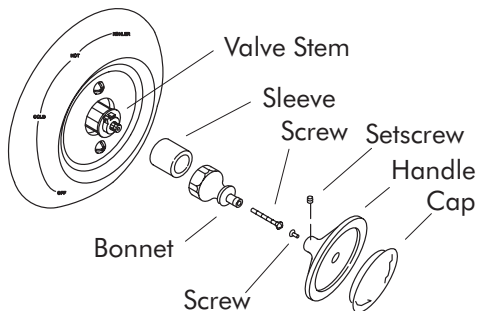

## CALL US FOR HELP

Questions? Problems? First review the installation instructions to ensure correct installation. For additional assistance in the USA, call our Customer Service Department for direct help. You may also contact us at our web site listed below.

**1-800-4-KOHLER**

THE BOLD LOOK  
OF **KOHLER**<sup>®</sup>  
[www.kohlerco.com](http://www.kohlerco.com)