

**Features**

- Metal construction
- Brass valve bodies
- High-temperature limit setting for added safety
- Rite-Temp® pressure-balancing diaphragm design valve
- Mixing valve cycles from "cold" to "hot"
- Intended for use with Rite-Temp® or HiFlow Rite-Temp® valves
- Pressure-balancing mechanism of one-piece diaphragm cartridge design for ease of maintenance
- Oblong handle

**BATH/SHOWER VALVE TRIM**  
**K-T10055-9**  
**ALSO K-T10056-9, K-T10057-9**

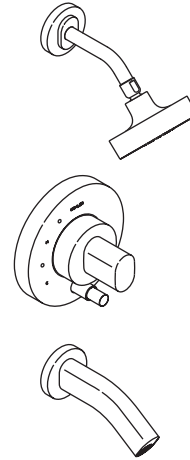

**Codes/Standards Applicable**

Specified model meets or exceeds the following:

- ASME A112.18.1/CSA B125.1
- IAPMO/cUPC
- ASSE 1016

**Colors/Finishes**



- CP: Polished Chrome
- Other: Refer to Price Book for additional colors/finishes

**Accessories**

- NA: None applicable

**Specified Model**

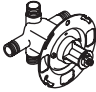
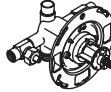
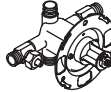
Model	Description	Colors/Finishes	
K-T10055-9	Bath/shower valve trim with 1/2" IPS threaded spout	<input type="checkbox"/> CP	<input type="checkbox"/> Other _____
K-T10056-9	Shower valve trim, less diverter spout	<input type="checkbox"/> CP	<input type="checkbox"/> Other _____
K-T10057-9	Mixing valve trim	<input type="checkbox"/> CP	<input type="checkbox"/> Other _____

Required Rite-Temp Valve					
K-304-K	Without stops, NPT connections <b>OR</b>	<input type="checkbox"/> NA			
K-304-KP	With stops, CPVC connections <b>OR</b>		<input type="checkbox"/> NA		
K-304-KS	With stops, NPT connections <b>OR</b>			<input type="checkbox"/> NA	
K-305-K	Pressure-balancing valve, push-button diverter <b>OR</b>				<input type="checkbox"/> NA

**Product Specification**

The bath/shower valve trim shall be made of metal construction with brass valve bodies. Product shall have a Rite-Temp pressure-balancing diaphragm design valve and pressure-balancing mechanism of one-piece diaphragm cartridge design for ease of maintenance. Product shall feature mixing valve cycles from "cold" to "hot," a high-temperature limit stop for added safety, and an oblong handle. Product is intended for use with Rite-Temp or HiFlow Rite-Temp valves. Bath/shower valve trim shall be Kohler Model K-T-\_\_\_\_-9-\_\_\_\_ and required Rite-Temp valve shall be K-\_\_\_\_-\_\_\_\_-NA.

# OBLO™ RITE-TEMP®

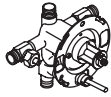
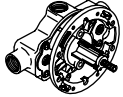
<b>Required Rite-Temp Valve (continued)</b>			
K-305-KS	Pressure-balancing valve, push-button diverter and screwdriver stops <b>OR</b>	<input type="checkbox"/> NA	
K-306-KS	HiFlow with stops, NPT connections		<input type="checkbox"/> NA
<b>Optional Accessories</b>			
1073881	Deep rough-in kit – for use with K-304-K, K-304-KP, K-304-KS and K-306-KS		<input type="checkbox"/> NA
1092535	Deep rough-in kit for valves with push button diverter – for use with K-305-K and K-305-KS	<input type="checkbox"/> CP	<input type="checkbox"/> BN <input type="checkbox"/> SN

## Installation Notes

Install this product according to the installation guide.

Install the Rite-Temp valve according to the installation guide.

**NOTICE: If installing with the K-306-KS valve:** Use 1-5/8" (4.1 cm) screws when attaching the seal plate to the valve. Do not use 2-3/8" (6 cm) screws, which will damage the valve.

Avoid cross-flow conditions. Do not install a shut-off device on either valve outlet.

Cap the shower outlet if the deck-mounted spout, diverter, or handshower is connected to the spout outlet.

Install a 7" (17.8 cm) to 18" (45.7 cm) straight pipe or straight tube with single bath elbow between the valve and the wall-mount spout.

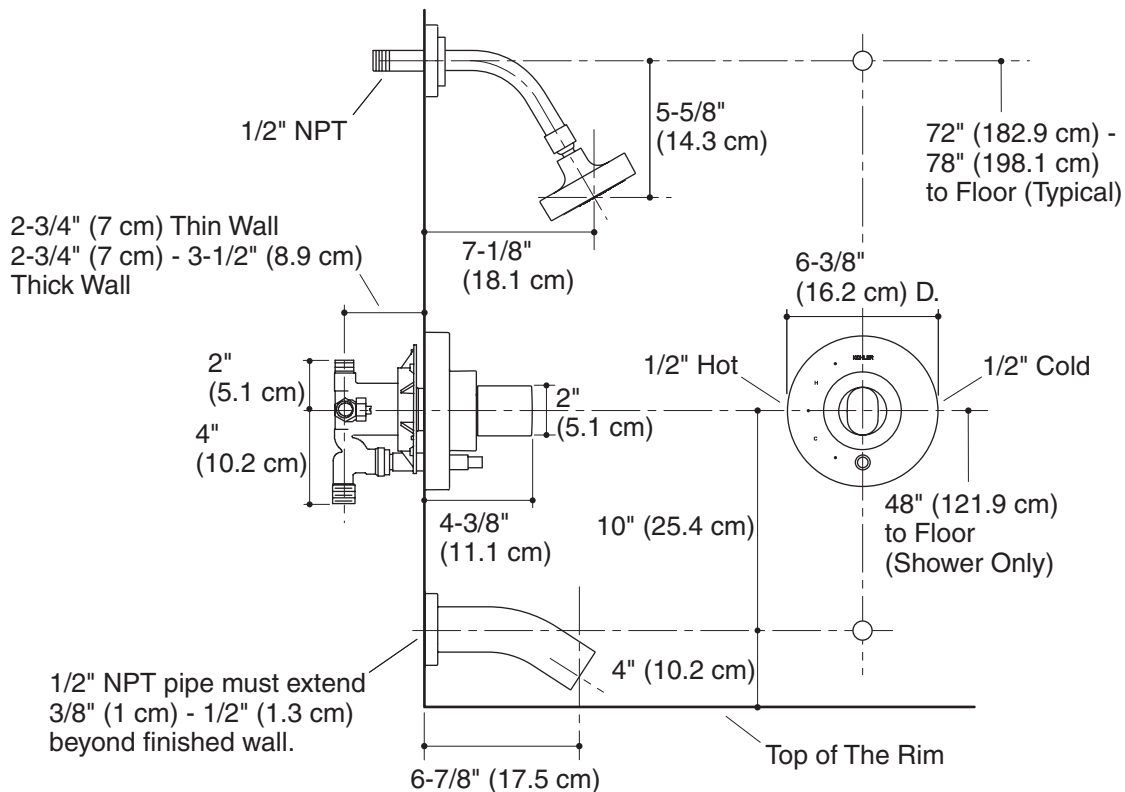

## Product Diagram