

KOHLER®

Roughing-In

K-1114-GLA, K-1114-GRA
WINDWARD™

BATH WITH AIRJETS, INTEGRAL APRON

Product Information

| | | |
|------------------------------------|------------|-----------|
| Applicable product: | | |
| Bath – integral apron, left drain | K-1114-GLA | not shown |
| Bath – integral apron, right drain | K-1114-GRA | shown |

| | |
|-------------------------------------------------|------------------------------------|
| Fixture*: | |
| Bathing well | |
| Basin area bottom | 55" (139.7 cm) x 23-1/4" (59.1 cm) |
| Basin area top | 64" (162.6 cm) x 32" (81.3 cm) |
| Weight | 132 lbs (60 kg) |
| To overflow | |
| Water depth | 15" (38.1 cm) |
| Capacity | 78.5 gal (297 L) |
| * Approximate measurements for comparison only. | |

| | | | | |
|------------------------------------|--------|----------|----|---|
| Blower motor | Heater | V | Hz | A |
| | 300 W | 120 | 60 | 5 |
| Minimum access panel blower motor: | | | | |
| 20" (50.8 cm) W x 15" (38.1 cm) H | | required | | |

No change in measurements if connected with drain illustrated. (K-11677 or K-11677M)

Recommended faucet area

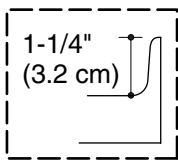

Tile Flange Detail

Blower/Control Access
20" (50.8 cm) W x
15" (38.1 cm) H Min

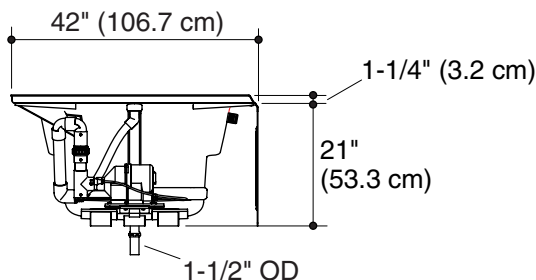

Required Electrical Service

Dedicated circuit required, protected with a Class A Ground-Fault Circuit-Interrupter (GFCI):

Pump/control 120 V, 5 A, 60 Hz

Locate the outlet behind the bath and within 24" (61 cm) of the pump.

Installation Notes

Install this product according to the installation guide.

Floor support under this product must provide for a minimum of 39 lbs/square foot (190 kg/square meter) loading.

If installing a rim-mount faucet, make sure there is no interference with the drain overflow and circulating system before drilling any holes. Consult local and national codes for minimum air gap requirements if installing a spout on the faucet deck.

Fixture conforms to ANSI Standard Z124.1.2. All dimensions are nominal.

