

Family: Montreal | Item No. 1735 AI

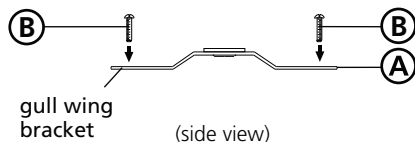

**Drawing 1 - Strap Detail**



**Drawing 2 - Fixture Mounting**

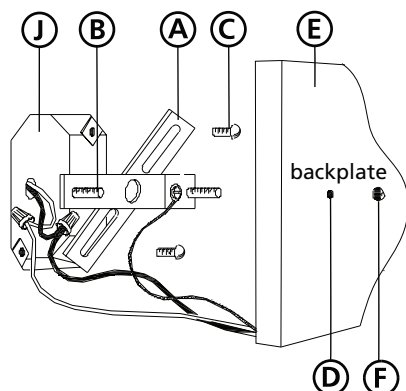

**Drawing 3 - Fixture Assembly**

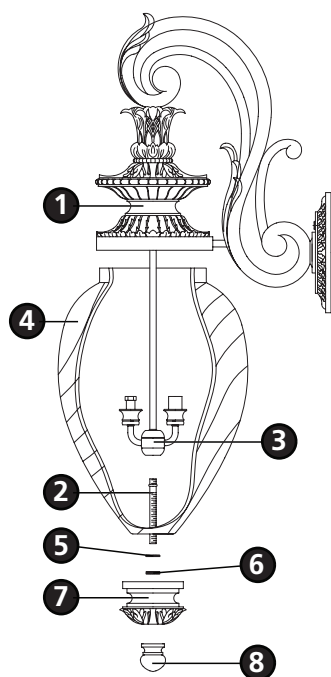

▼ start here

**1**

1. Find a clear area in which you can work.
2. Unpack fixture and glass from carton.
3. Carefully review instructions prior to assembly.

**\*\*\* The construction of this fixture will be accomplished by first installing the mounting hardware to the junction box, making all necessary electrical connections, mounting the fixture to the wall and then installing the fixture glass.**

**2**

1. Prepare mounting strap (A) by threading the two long mounting screws (B) into the back of the gull wing bracket - see **Drawing 1**.
  - Be sure the holes into which the screws are threaded match the spacing of holes (D) located in the back plate (E) - see **Drawings 1 and 2**.
2. Attach mounting strap (A) to junction box (J) using two 1" screws (C) provided - see **Drawing 2**.
3. Slide backplate (E) over screws (B) and secure with ball knobs (F).

**SAFETY WARNING: READ WIRING AND GROUNDING INSTRUCTIONS (I.S. 18) AND ANY ADDITIONAL DIRECTIONS. TURN POWER SUPPLY OFF DURING INSTALLATION. IF NEW WIRING IS REQUIRED, CONSULT A QUALIFIED ELECTRICIAN OR LOCAL AUTHORITIES FOR CODE REQUIREMENTS.**

**3**

Make electrical connections from supply wire to fixture lead wires. Refer to instruction sheet (I.S. 18) and follow all instructions to make all necessary wiring connections. Then refer back to this sheet to continue installation of this fixture.

**4**

1. Fixture can now be lamped accordingly.
2. Thread center stem (2) into bottom of cluster assembly (3) located on the main fixture assembly (1) - see **Drawing 3**.
3. Slip glass (4) over cluster assembly (3) and onto center stem (2) and hold in position.
4. Slip rubber washer (5) onto center stem (2), followed by knurl nut (6) and tighten to secure glass (4).
5. Slip decorative finial (7) onto center stem (2) and hold in position.
6. Thread ball knob (8) onto end of center stem (2) and tighten.

Note: Maximum wattage for 1735 fixture is 60 watts per bulb.

3.16.09