

3 Port, 2 and 3 Setting, Non-Shared Diverter

Desviador No-Compartido de 3-Puertos o Entradas, de 2 y 3 Ajustes

Cartouche sans position partagée, 3 orifices, 2 et 3 Réglages

Models/Modelos/Modèles RP71717 & RP71718 Series/Series/Seria

Non-Shared
Diverter Cartridge

RP71717

Non-Shared 2 Function Cartridge Assembly
Cartucho del desviador no-compartido de 2 funciones
Cartouche d'inverseur sans position partagée à 2 fonctions

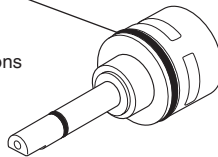

RP71718

Non-Shared 3 Function Cartridge Assembly
Cartucho desviador no-compartido de 3 funciones
Cartouche non partagée pour inverseur à 3 fonctions

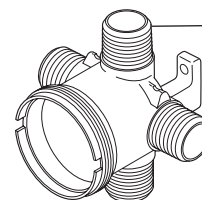
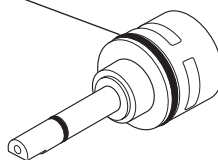

R11000

Rough Body - 3 Port
Tubería interna - 3 Tomas
Corps de plomberie brute -
3 Orifices



RP20032

Plug
Tapón
Bouchon

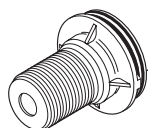

RP51916

Sleeve/Manga/Manchon



RP46078

Test Cap & O-ring
Casquillo de Prueba y Anillo "O"
Bouchon d'essai et Joint Torique

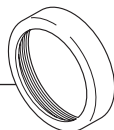

RP22734

Bonnet/Bonete/Chapeau