

591T Series – Electronic Faucet Trim

For Recess Mounted Control Box and Single Inlet Supply

TECK[®]
COMMERCIAL



Specification: (example)

- Supplied as trim parts only – requires separate order of ELAVT0001RI rough-in to have complete product
- **H₂Optics[®]** technology – no external adjustments required
- Chrome-plated **CAST** 102 mm (4") spout with integral sensor
- Adjustable sensing range and timeout
- **Battery** (4 "C" cell) or **Hardwire** (24VAC) infrared electronic handwash
- Serviceable filter screen upstream of the solenoid valve
- Metal hold-down package

and...
with... (specify battery or hardwire)
with... (add outlet required)
with... (transformer for hardwire operation – specify separately – See Next Page)

591T SERIES



Engineer/Architect Approval

Model Specified:

Approval:







Date:

DESCRIPTION	PRODUCT NO. (FOR TRIM ONLY)				
Trim Only for Hardwire	591T0	2		1	TR
Trim Only for Battery Operated	591T1	2		1	TR
Trim Only for Hardwire with Battery Backup	591T0	2		1	TR

Rough-In
Product Number
ELAVT0001RI –
Order separately



-BB

SPOUT & SENSOR		OUTLET		CONTROL BOX	
0	<input type="checkbox"/>	0	<input type="checkbox"/>	0	<input type="checkbox"/>
1	<input type="checkbox"/>	1	<input type="checkbox"/>	1	12" S/S Cover, Driver Board, Solenoid for ELAVT0001RI* <input checked="" type="checkbox"/>
2	4" CAST Lavatory Spout  <input checked="" type="checkbox"/>	2	Vandal Resistant 1.5 gpm (5.7 L/min.) Laminar w/Agion [®] Antimicrobial  <input type="checkbox"/>	2	<input type="checkbox"/>
3	<input type="checkbox"/>	3	Vandal Resistant 1.5 gpm (5.7 L/min.) Flow Control Aerator  <input type="checkbox"/>	3	<input type="checkbox"/>
4	<input type="checkbox"/>	4	<input type="checkbox"/>	4	<input type="checkbox"/>
5	<input type="checkbox"/>	5	Vandal Resistant 0.5 gpm (1.9 L/min) Laminar Outlet  <input type="checkbox"/>	5	<input type="checkbox"/>
6	<input type="checkbox"/>	6	Vandal Resistant 1.0 gpm (3.8 L/min) Laminar Outlet  <input type="checkbox"/>	6	<input type="checkbox"/>
7	<input type="checkbox"/>	7	<input type="checkbox"/>	7	<input type="checkbox"/>
8	<input type="checkbox"/>	8	<input type="checkbox"/>	8	<input type="checkbox"/>
9	<input type="checkbox"/>	9	Vandal Resistant 0.35 gpm (1.32 L/min) Non-Aerating Spray Outlet  <input type="checkbox"/>	9	<input type="checkbox"/>

*Mixing valve (order separately).
Refer to www.specselect.com for individual models.

Flow Rates are at 60 PSI.
Note: Use these pages as product submittal sheets.

Delta reserves the right (1) to make changes in specifications and materials, and (2) to change or discontinue models, both without notice or obligation. Dimensions are for reference only. See current full-line price book or www.specselect.com for finish options and product availability.

DSP-591TCB1 Rev. A



TECK[®]
COMMERCIAL

591T Series – Electronic Faucet Trim

For Recess Mounted Control Box and Single Inlet Supply

Approvals:

- CSA certified
- Complies to ASME A112.18.1/CSA B125.1
- Indicates compliance to ICC/ANSI A117.1
- Outlet options 2, 3 and 6 are EPA WaterSense listed
- Verified compliant with 0.25% weighted average Pb content regulations

(Contact Delta Representative for State and/or Local Approvals.)

Patented

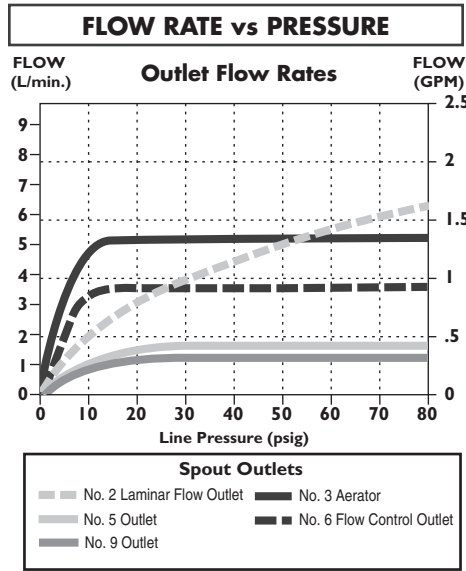

FRONT VIEW

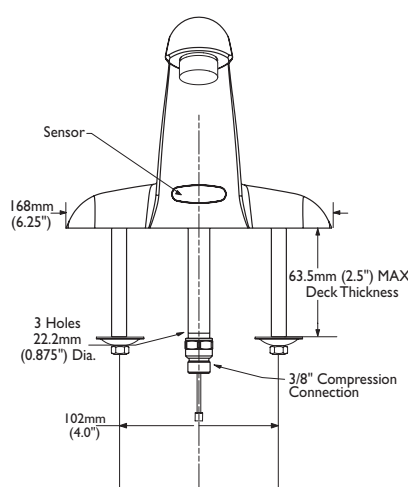

SIDE VIEW

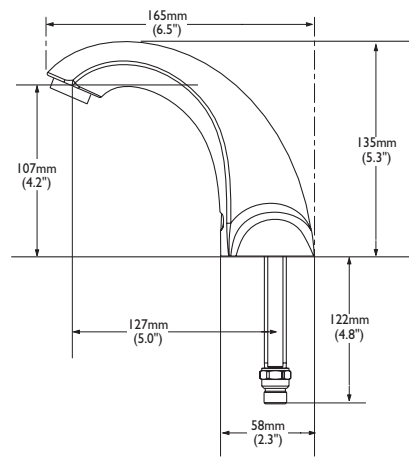

TYPICAL INSTALLATION

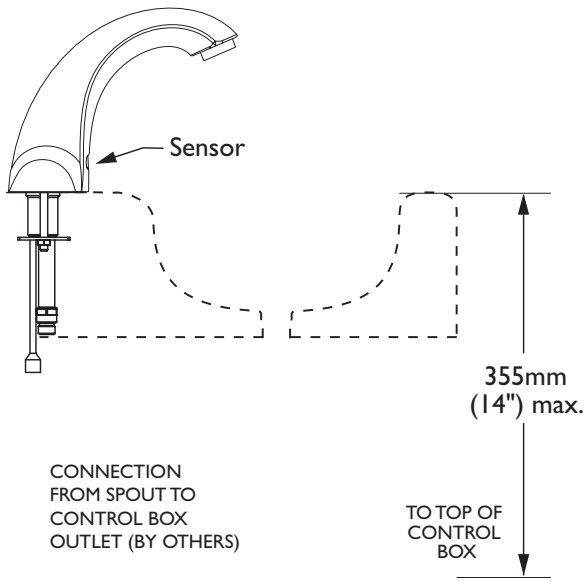

Available Option for Field Conversion

060651A
3 Position Switch
See DSP-ELACC for detailed specification.

HARDWIRE WITH BATTERY BACKUP

Add suffix “-BB” to Product Number. See DSP-BB for detailed specification.

OPERATION:

- Hands free (touchless) operation.
- Water flows when sensor is activated.
- Water flow stops upon de-activation of sensor.
- Adjustable auto shut-off feature. Factory set to 45 seconds. Will reset once obstruction is removed.
- Adjustable sensing distance 76 to 381 mm (3" to 15") factory set to 229mm (9") (± 3.0")
- Low battery audible beep (for battery models only) will activate after faucet shuts off when approximately 1500 cycles remain.
- Metering mode with selectable flow times of 7 seconds to 4 minutes, factory set off.
- Periodic Rinse feature, time adjustable in 6 hour increments up to 2 days. Selectable rinsing lengths from 10 to 180 seconds. Factory set off.

NOTE 1: For optimum performance of this product, we recommend a system pressure between 20 and 80 PSI static. This product will operate up to a maximum of 125 PSI static per ANSI and CSA requirements. However, we do not recommend pressures above 80 PSI. Thermal expansion or leaking pressure reducing valves may require use of expansion tanks or relief valves to ensure your system never exceeds its maximum intended pressure setting.

NOTE 2: Designed for routine 171°F (77°C) disinfection cycles up to 30 minutes.

Note: Measurements may vary ± 6mm (0.25")

591T ELECTRONIC FAUCET OPTIONAL ACCESSORIES:

✓ TRANSFORMERS:	
060704A	110 to 24VAC Class II 20VA (Up to 5 Electronic Valves)
060771A	110 to 24VAC Class II 40VA (Up to 10 Electronic Valves)
060772A	110 to 24VAC Class II 100VA (Up to 25 Electronic Valves)
✓ CORDS:	
061256A	36" Cable Extension

Refer to www.specselect.com for individual models.
Product supplied as shown by solid lines. All items shown by dotted lines supplied by others.