



Z5582

Dual Flush 1.6/1.0 gpf Pressure Assist
Elongated Floor Mounted, Back Outlet
Water Closet

TAG _____

Z5582 Series

- 1.6 gpf [6Lpf] or 1.0 gpf [4 Lpf] Flow Rate
- High Efficiency Toilet (HET) reduces potable water usage over 30%.
- Vitreous china
- Pressure assisted tank
- High performance EcoFlush™ technology
- Easy touch handle actuation
- Ultra quiet flush
- Siphon jet flush action
- 4-1/8" back outlet rough-in
- 2-1/8" fully glazed trapway
- Operating pressure range 20-125 psi
- Elongated front rim
- Chrome plated handle
- Large water surface area
- Includes bolt caps
- Shipping weight: 92 lbs.

Z5582

Suffix Options:

____ -RH Vitreous China right-hand lever tank

Please Note: HET 1.0 gpf HET pressure assist tank also available.
See Model Z5581.

Recommended Trim:

☐ **Z5958SS-EL**

Elongated, white, closed front toilet seat
with cover & stainless steel check hinge.

☐ **Z8800-CR**

Standard stop with flexible closet riser.

Engineering Specification:

☐ **Z5582** Vitreous china, High Efficiency Dual
Flush 1.6 gpf [6Lpf], or 1.0 gpf [4 Lpf], Pressure
Assisted, Elongated Two Piece Toilet with 4-1/8"
back outlet Rough-in.

*These dimensions and specifications are subject to change without
notice.*

*Fixture dimensions meet ANSI/ASME standard A112.19.2-2003 and
CAN/CSA B45 requirements.*

This space is for Architectural/engineering Approval

See Zurn One Systems for suggested packages.

Zurn Plumbing Products Group Commercial Brass and Fixtures Operation
2640 South Work Street · Falconer, NY 14733 · Phone: 716-665-1132 · Fax: 716-665-1135 · www.zurn.com



Z5582

Dual Flush 1.6/1.0 gpf Pressure Assist
Elongated Floor Mounted, Back Outlet
Water Closet

TAG _____

Rough-in dimensions for Z5582

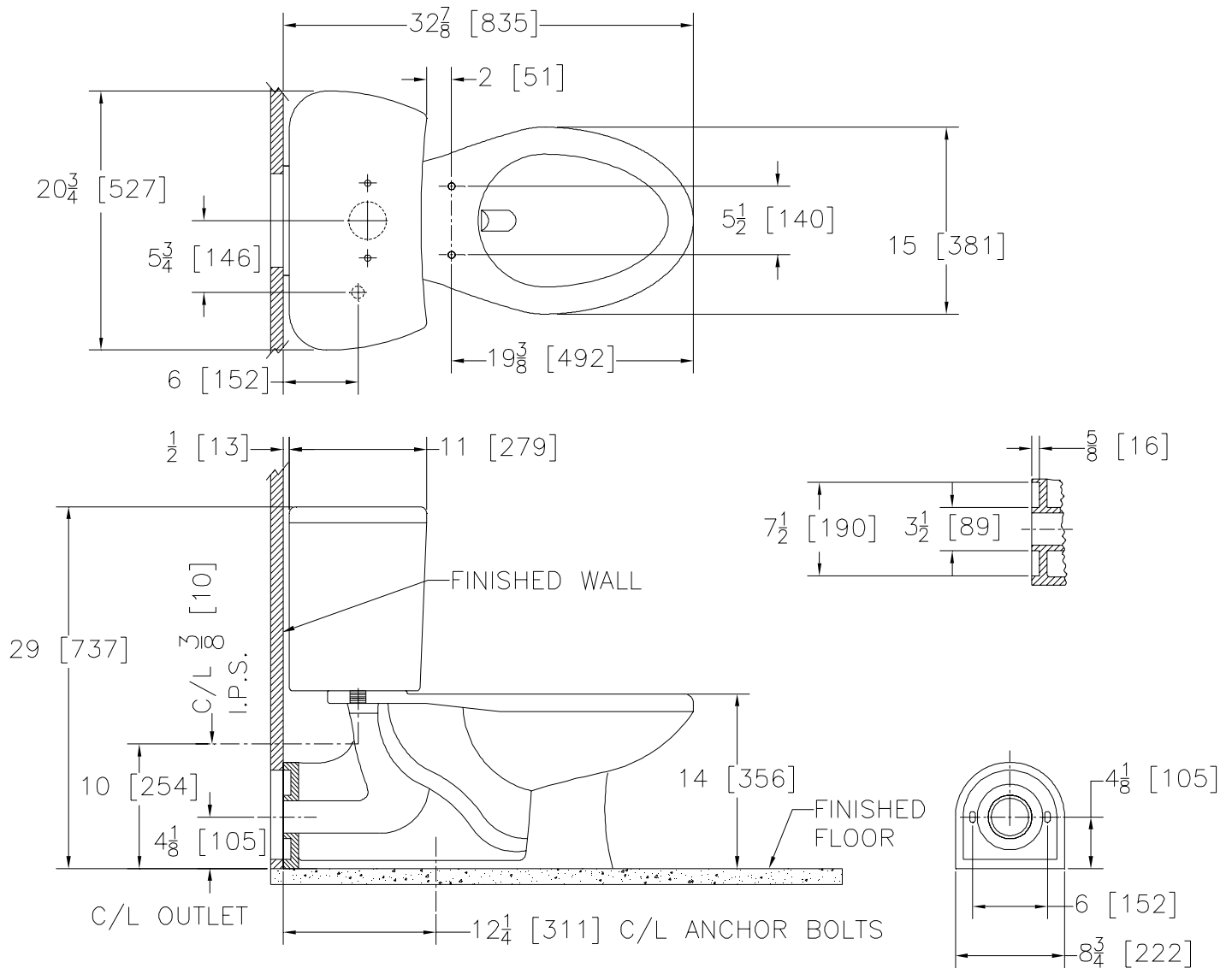

These dimensions and specifications are subject to change without notice.

Fixture dimensions meet ANSI/ASME standard A112.19.2-2003 and CAN/CSA B45 requirements.

Zurn Plumbing Products Group Commercial Brass and Fixtures Operation

2640 South Work Street • Falconer, NY 14733 • Phone: 716-665-1132 • Fax: 716-665-1135 • www.zurn.com

REV. A

DWG. NO. 82750

DATE: 3/6/07

C.N. NO. 96286

PRODUCT NO. Z5582